



---

**Corporate Office**

1775 Sherman Street, #3000  
Denver, Colorado 80203  
303.860.5800  
www.pdce.com

February 14, 2019

State of Colorado, Oil & Gas Conservation Commission  
Attn: Director  
1120 Lincoln Street, Suite 801  
Denver, CO 80203

Re: **30 Day Certification Letter – Rule 318Ae**  
Wayne 22Y-302  
NESE Section 22, T5N-R64W, 6th PM  
Weld County, Colorado

Dear Director,

PDC Energy, Inc. ("PDC") hereby certifies to the Director that a thirty (30-day) notice has been given by certified mail to all owners in the proposed wellbore spacing unit consisting of T5N-R63W Section 19: S2S2, Section 30: N2N2; T5N-R64W Section 22: SESE, Section 23: S2S2, Section 24: S2S2, Section 25: N2N2, Section 26: N2N2, Section 27: NENE, 1,040 acres. We have not received any objections to such well location or proposed spacing unit, therefore, PDC hereby requests the Director to approve the well.

If you should have any questions or concerns regarding this permit, please contact the undersigned at (303) 831-3931.

Sincerely,

A handwritten signature in black ink, appearing to read "Ally Ota".

Ally Ota  
Regulatory Technician  
PDC Energy, Inc.

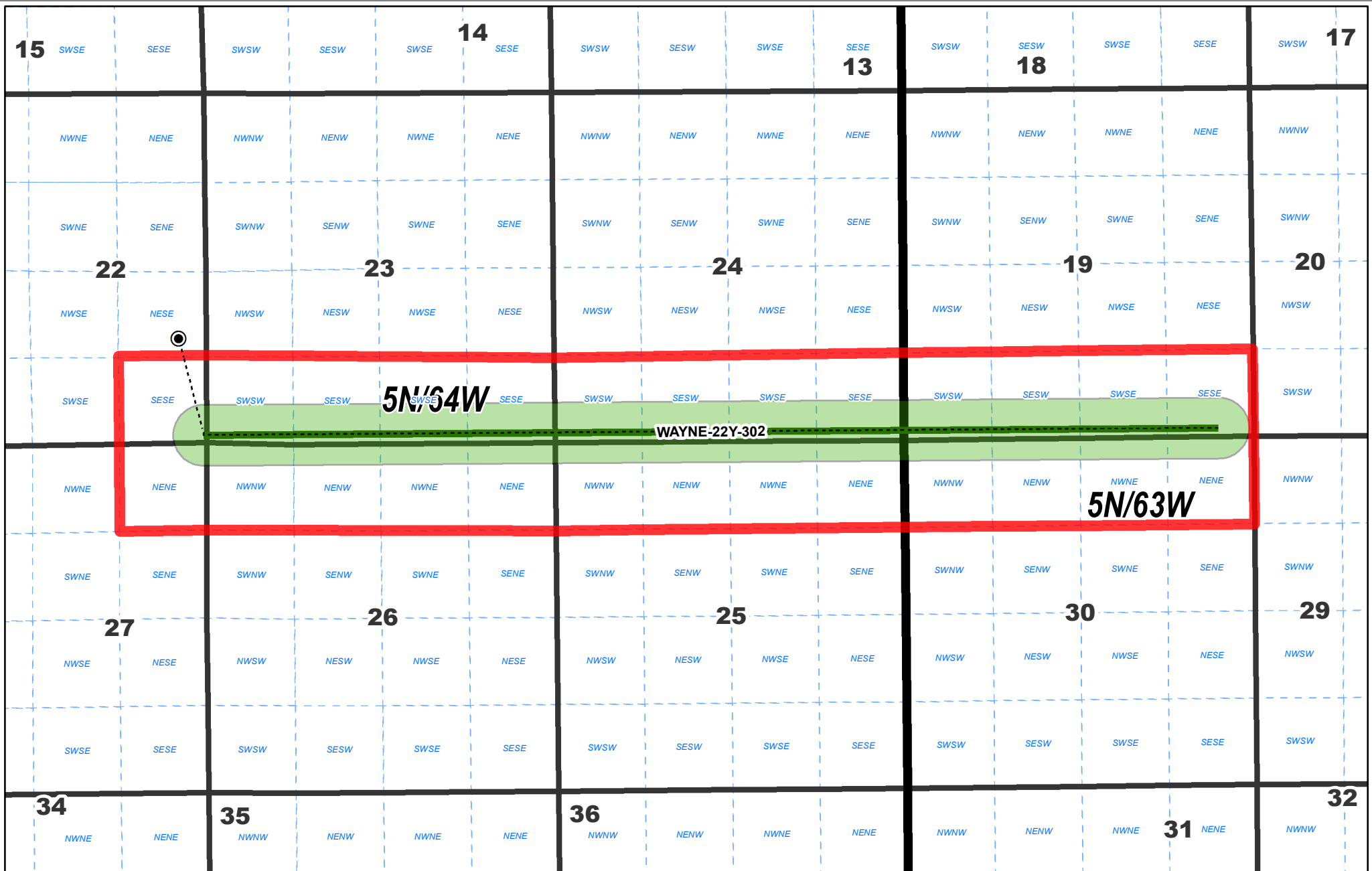

**DJ Preliminary Proposed Spacing Unit**  
**WAYNE 22Y-302**

**Date: 1/10/2019**

**Legend**



Townships

Sections

Qtr Qtr (Weld Cty)



Preliminary Proposed Spacing Unit



460' Foot Wellbore Buffer



Spaced Wellbore

Disclaimer:  
PDC Energy, Inc. makes no representation or warranty regarding the accuracy or completeness of this map, which is being provided as a courtesy only. PDC Energy, Inc. expressly disclaims all liability and responsibility for any representation, warranty, statement or depiction in this map, whether express, statutory or implied, as to the content, character or nature of any information contained in this map, including, but not limited to, the leasehold acreage positions, well locations and statuses or any other information depicted. Any conclusions derived from this map are at the sole cost, risk and expense of the user.  
© 2014 PDC Energy, Inc. All Rights Reserved.

