

D23-14 PAD & D23-15 PAD  
LOCATION DRAWING

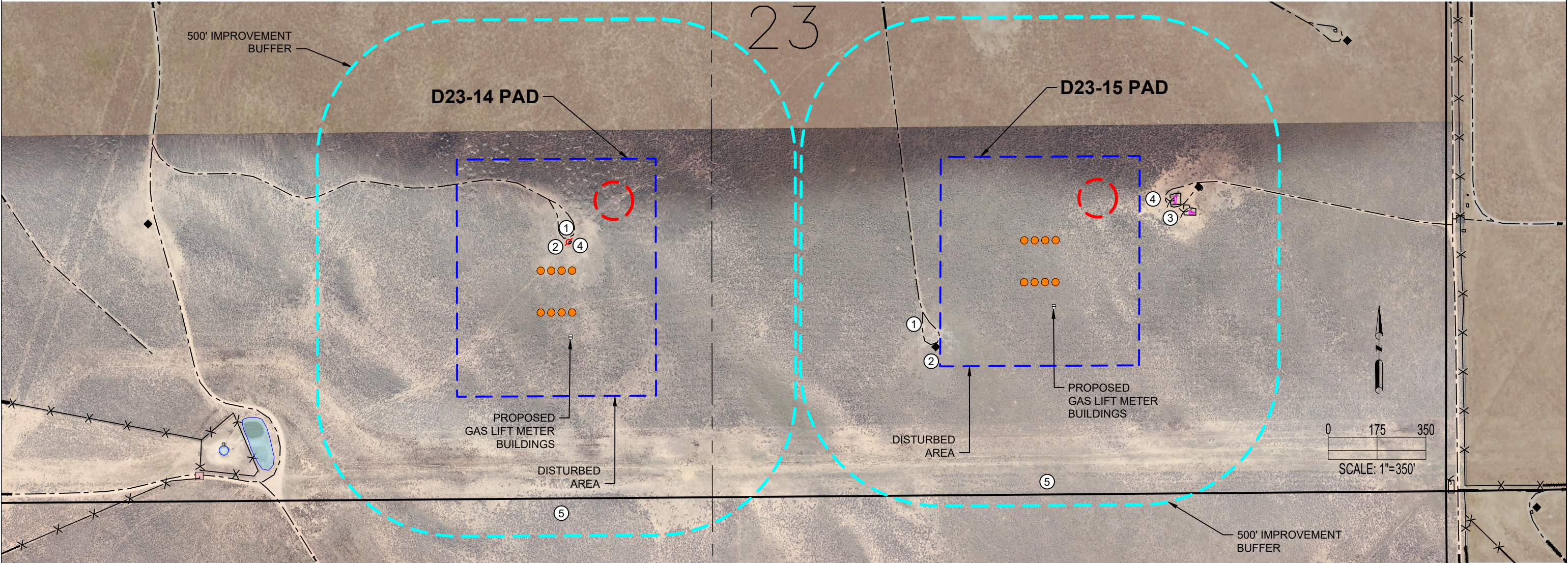

D23-14 PAD

D23-15 PAD

IMPROVEMENTS: (AS MEASURED FROM THE PROPOSED EDGE OF DISTURBANCE)	
1. PRIVATE ROAD:	0'
2. OIL/GAS WELL:	0'
3. EXISTING PRODUCTION EQUIPMENT:	N/A
4. FENCE:	0'
5. PROPERTY LINE	±366' S, ±442' SE

IMPROVEMENTS: (AS MEASURED FROM THE PROPOSED EDGE OF DISTURBANCE)	
1. PRIVATE ROAD:	±3' W, ±93' E
2. OIL/GAS WELL:	±16' W, ±212' E
3. EXISTING PRODUCTION EQUIPMENT:	±121' E, ±178' E
4. FENCE:	±8' W, ±109' E, ±158' E, ±213' E
5. PROPERTY LINE	±460' S

DISCLAIMER:  
THIS PLOT DOES NOT REPRESENT A MONUMENTED LAND SURVEY AND SHOULD NOT BE RELIED UPON TO DETERMINE BOUNDARY LINES, PROPERTY OWNERSHIP OR OTHER PROPERTY INTERESTS. PARCEL LINES, IF DEPICTED HAVE NOT BEEN FIELD VERIFIED AND MAY BE BASED UPON PUBLICLY AVAILABLE DATA THAT ALSO HAS NOT BEEN INDEPENDENTLY VERIFIED.

CURRENT SURFACE USE: RANGELAND  
FUTURE SURFACE USE: RANGELAND



7535 Hilltop Circle  
Denver, CO 80221  
(303) 928-7128  
www.ascentgeomatics.com

FIELD DATE: 08-02-18	DRAWING DATE: 12-18-18
DRAWN BY: JAG	CHECKED BY: VQD

SITE NAME: D23-14 PAD, D23-15 PAD	DATA SOURCE: AERIAL IMAGERY: NAIP 2017, ASCENT 11/2017 WATER WELLS: COLORADO DWR NHD: USGS
SURFACE LOCATION: SEC. 23, T3N, R64W, 6TH P.M. WELD COUNTY, COLORADO	PUBLICLY AVAILABLE DATA SOURCES HAVE NOT BEEN INDEPENDENTLY VERIFIED BY ASCENT.

LEGEND:

●

= PROPOSED WELL

◆

= EXISTING WELL

⛔

= ABANDONED WELL

—

= SECTION LINE

- - -

= CENTER SECTION LINE

✕ ✕

= FENCE

- . - .

= EXISTING ROAD

▭

= DISTURBANCE AREA

⬤

= 500' RADIUS

▭

= EXISTING FACILITY

▭

= GATE

▭

= POND

▭

= PROPOSED MLVT

