

CANVASBACK PAD REFERENCE AREA MAP

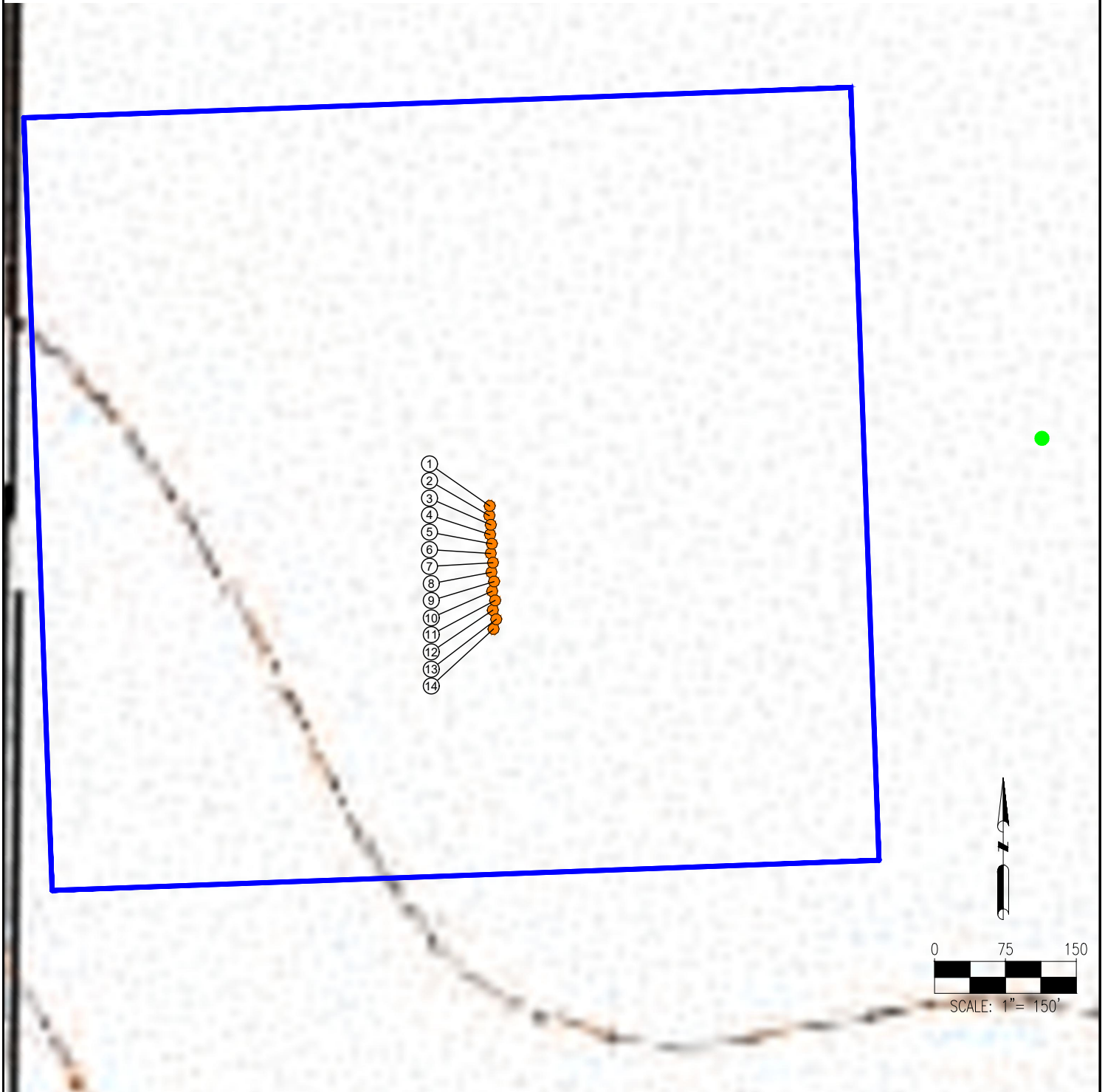

1. CB1
2. CANVASBACK 32-1HC
3. CB2
4. CANVASBACK 32-2HN
5. CB3
6. CANVASBACK 32-3HN
7. CB4
8. CANVASBACK 32-4HN

9. CB5
10. CANVASBACK 32-5HN
11. CB6
12. CANVASBACK 32-6HN
13. CB7
14. CANVASBACK 32-7HC

REFERENCE LOCATION

****REFERENCE PHOTO POINT****

LAT: 40.705865° N
LONG: 104.121572° W
ELEVATION: 4946'

DISCLAIMER:
THIS PLOT DOES NOT REPRESENT A MONUMENTED LAND SURVEY AND SHOULD NOT BE RELIED UPON TO DETERMINE BOUNDARY LINES. PROPERTY OWNERSHIP OR OTHER PROPERTY INTERESTS. PARCEL LINES, IF DEPICTED HAVE NOT BEEN FIELD VERIFIED AND MAY BE BASED UPON PUBLICLY AVAILABLE DATA THAT ALSO HAS NOT BEEN INDEPENDENTLY VERIFIED.

DATA SOURCE:
TOPO MAP: USGS

PUBLICLY AVAILABLE DATA SOURCES HAVE NOT BEEN INDEPENDENTLY VERIFIED BY ASCENT.

LEGEND:



= PROPOSED WELL



= REFERENCE PHOTO POINT



= PROPOSED DISTURBANCE AREA



7535 Hilltop Circle
Denver, CO 80221
(303) 928-7128
www.ascentgeomatics.com

FIELD DATE:
10-19-18

DRAWING DATE:
11-07-18

BY:
IIC

CHECKED:
MMP

SITE NAME:
CANVASBACK PAD

SURFACE LOCATION:

NW 1/4 SW 1/4 SEC. 32, T9N, R60W, 6TH P.M.
WELD COUNTY, COLORADO

PREPARED FOR:

