

CANVASBACK PAD LOCATION DRAWING

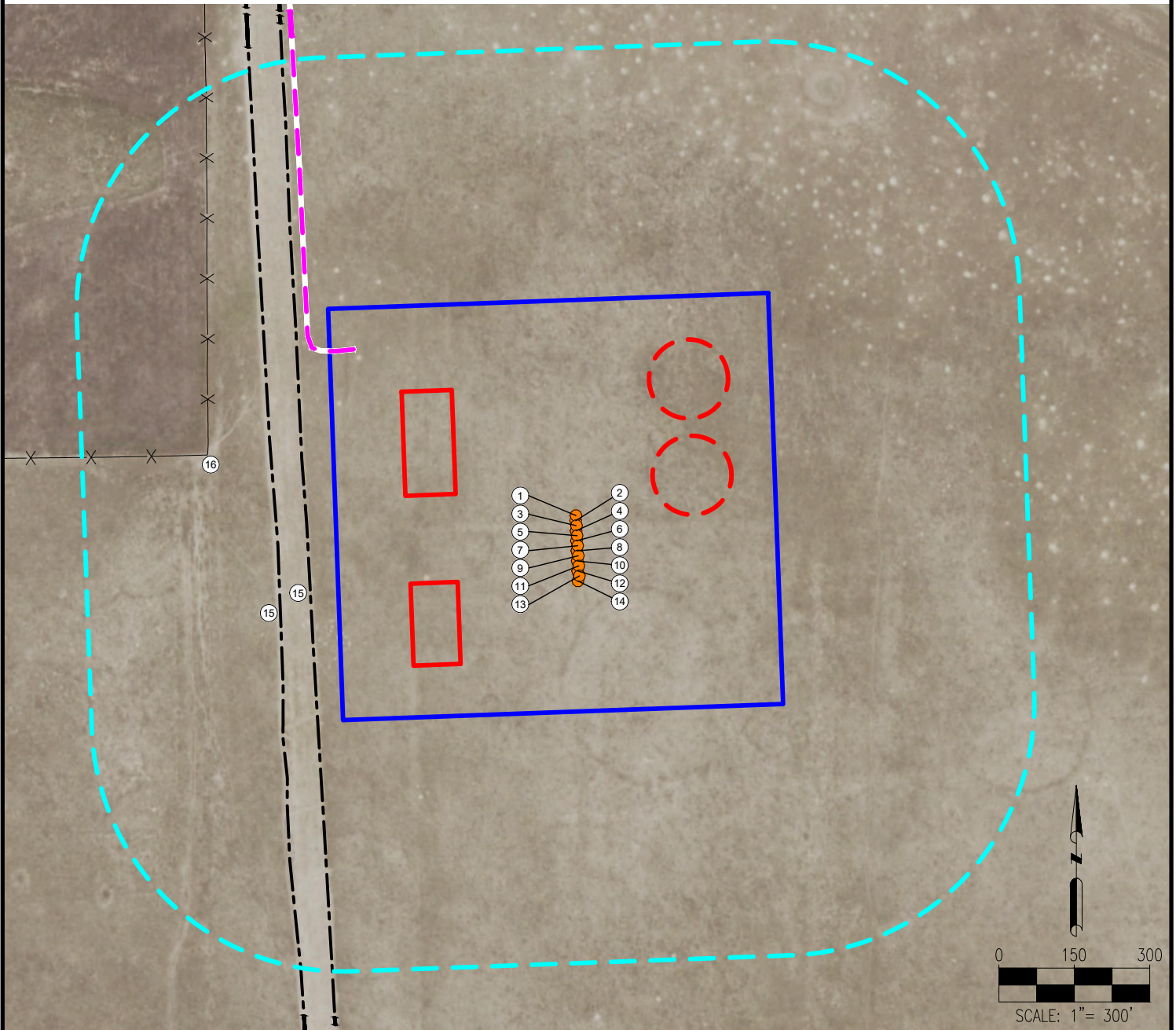

- | | | |
|----------------------|-----------------------|--|
| 1. CB1 | 8. CANVASBACK 32-4HN | 15. PRIVATE ROADS ARE $\pm 534'$ W, $\pm 594'$ W |
| 2. CANVASBACK 32-1HC | 9. CB5 | 16. FENCES IS $\pm 760'$ NW |
| 3. CB2 | 10. CANVASBACK 32-5HN | |
| 4. CANVASBACK 32-2HN | 11. CB6 | |
| 5. CB3 | 12. CANVASBACK 32-6HN | |
| 6. CANVASBACK 32-3HN | 13. CB7 | |
| 7. CB4 | 14. CANVASBACK 32-7HC | |

LEGEND:

- | | |
|------------------------|-----------------------------|
| = PROPOSED WELL | = PROPOSED DISTURBANCE AREA |
| = PROPOSED ACCESS ROAD | = PROPOSED FACILITY |
| = FENCE | = 500' RADIUS |
| = EXISTING ROAD | = PROPOSED MLVT |

DISCLAIMER:
THIS PLOT DOES NOT REPRESENT A MONUMENTED LAND SURVEY AND SHOULD NOT BE RELIED UPON TO DETERMINE BOUNDARY LINES, PROPERTY OWNERSHIP OR OTHER PROPERTY INTERESTS. PARCEL LINES, IF DEPICTED HAVE NOT BEEN FIELD VERIFIED AND MAY BE BASED UPON PUBLICLY AVAILABLE DATA THAT ALSO HAS NOT BEEN INDEPENDENTLY VERIFIED.

DATA SOURCE:
AERIAL IMAGERY: NAIP 2017
WATER WELLS: COLORADO DWR
NHD: USGS

PUBLICLY AVAILABLE DATA SOURCES HAVE NOT BEEN INDEPENDENTLY VERIFIED BY ASCENT.

MEASURED FROM NEAREST WELL OR FACILITY:

BUILDING	$\pm 5280'$ S
BUILDING UNIT	$\pm 5280'$ S
PUBLIC ROAD (WELD COUNTY ROAD 100)	$\pm 2370'$ N
PROPERTY LINE (USA)	$\pm 203'$ W
UTILITY (WINDMILL)	$\pm 2904'$ N
RAILROAD	$\pm 5280'$ S

MEASURED FROM NEAREST EDGE OF DISTURBANCE:
SURFACE WATER (POND) $\pm 1382'$ W

MEASURED FROM NEAREST EDGE OF DISTURBANCE:
WATER WELL $\pm 2683'$ N SWL = 73'
PERMIT: 271773 RECEIPT: 3609808

REFERENCE LOCATION

****CANVASBACK 32-4HN****

LAT: 40.705475° N
LONG: 104.123672° W
ELEVATION: 4945'
2481' FSL & 629' FWL
PDOP: 1.3

GPS OPERATOR: BRIAN HOPKINSON

DISTURBANCE ACREAGE:
16.4 ACRES DRILLING OPERATIONS
8.5 ACRES INTERIM RECLAIM

CURRENT SURFACE USE: RANGELAND
FUTURE SURFACE USE: RANGELAND

PREPARED FOR:



7535 Hilltop Circle
Denver, CO 80221
(303) 928-7128
www.ascentgeomatics.com

FIELD DATE:
10-19-18

DRAWING DATE:
11-06-18

BY:
IIC

CHECKED:
MMP

SITE NAME:
CANVASBACK PAD

SURFACE LOCATION:

NW 1/4 SW 1/4 SEC. 32, T9N, R60W, 6TH P.M.
WELD COUNTY, COLORADO

