

Location:	COLORADO	Slot:	SLOT#07 KTC FARMS EA-35-36HN (342°FNL & 473°FWL, SEC.3)
Field:	WELD COUNTY (NAD83/TRUE NORTH)	Well:	KTC FARMS EA-35-36HN
Facility:	SEC.35-T07N-R66W	Wellbore:	KTC FARMS EA-35-36HN PWB

<b>Plot reference wellpath is KTC FARMS EA-35-36HN (REV-D.0) PWP</b>	Grid System: NAD83 / Lambert Colorado SP, Northern Zone (501), US feet
True vertical depths are referenced to TRUE 38 (4861'GL+25KB@4886RKB) (RKB)	North Reference: True north
Measured depths are referenced to TRUE 38 (4861'GL+25KB@4886RKB) (RKB)	Scale: True distance
TRUE 38 (4861'GL+25KB@4886RKB) (RKB) to Mean Sea Level: 4886 feet	Depths are in feet
Mean Sea Level to Ground level (At Slot: SLOT#07 KTC FARMS EA-35-36HN (342FNL & 473FWL,SEC.35)): 0 feet	Created by: bushjmh on 2018-11-28
Coordinates are in feet referenced to Slot	Database: Denver

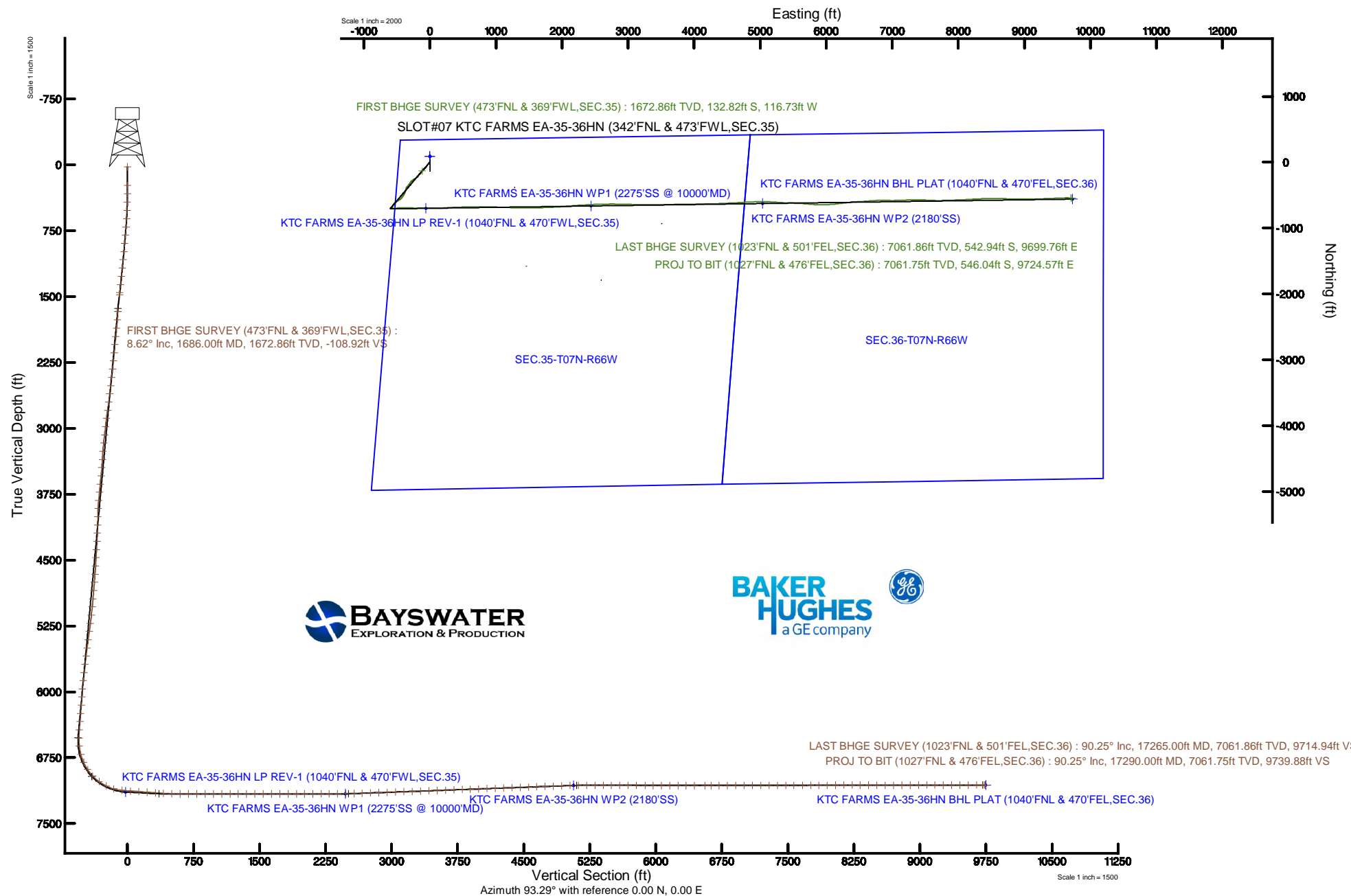

# Actual Wellpath Report

KTC FARMS EA-35-36HN AWP

Page 1 of 10

## REFERENCE WELLPATH IDENTIFICATION

Operator	BAYSWATER E & P LLC	Slot	SLOT#07 KTC FARMS EA-35-36HN (342'FNL & 473'FWL,SEC.35)
Area	COLORADO	Well	KTC FARMS EA-35-36HN
Field	WELD COUNTY (NAD83/TRUE NORTH)	Wellbore	KTC FARMS EA-35-36HN AWB
Facility	SEC.35-T07N-R66W		

## REPORT SETUP INFORMATION

Projection System	NAD83 / Lambert Colorado SP, Northern Zone (501), US feet	Software System	WellArchitect® 5.1
North Reference	True	User	Bushjamh
Scale	0.999969	Report Generated	11/28/2018 at 4:02:52 AM
Convergence at slot	0.48° East	Database/Source file	Denver/KTC_FARMS_EA-35-36HN_AWP.xml

## WELLPATH LOCATION

	Local coordinates		Grid coordinates		Geographic coordinates	
	North[ft]	East[ft]	Easting[US ft]	Northing[US ft]	Latitude	Longitude
Slot Location	-89.99	1.11	3207745.14	1439655.07	40°32'16.260"N	104°45'09.202"W
Facility Reference Pt			3207743.27	1439745.05	40°32'17.149"N	104°45'09.216"W
Field Reference Pt			3174587.00	1430859.71	40°30'51.890"N	104°52'19.470"W

## WELLPATH DATUM

Calculation method	Minimum curvature	TRUE 38 (4861'GL+25'KB@4886'RKB) (RKB) to Facility Vertical Datum	4886.00ft
Horizontal Reference Pt	Slot	TRUE 38 (4861'GL+25'KB@4886'RKB) (RKB) to Mean Sea Level	4886.00ft
Vertical Reference Pt	TRUE 38 (4861'GL+25'KB@4886'RKB) (RKB)	TRUE 38 (4861'GL+25'KB@4886'RKB) (RKB) to Ground Level at Slot (SLOT#07 KTC FARMS EA-35-36HN (342'FNL & 473'FWL,SEC.35))	4886.00ft
MD Reference Pt	TRUE 38 (4861'GL+25'KB@4886'RKB) (RKB)	Section Origin	N 0.00, E 0.00 ft
Field Vertical Reference	Mean Sea Level	Section Azimuth	93.29°

# Actual Wellpath Report

KTC FARMS EA-35-36HN AWP

Page 2 of 10

## REFERENCE WELLPATH IDENTIFICATION

Operator	BAYSWATER E & P LLC	Slot	SLOT#07 KTC FARMS EA-35-36HN (342'FNL & 473'FWL,SEC.35)
Area	COLORADO	Well	KTC FARMS EA-35-36HN
Field	WELD COUNTY (NAD83/TRUE NORTH)	Wellbore	KTC FARMS EA-35-36HN AWP
Facility	SEC.35-T07N-R66W		

## WELLPATH DATA (184 stations) † = interpolated/extrapolated station

MD [ft]	Inclination [°]	Azimuth [°]	TVD [ft]	Vert Sect [ft]	North [ft]	East [ft]	Latitude	Longitude	DLS [°/100ft]	Comments
0.00†	0.000	74.340	0.00	0.00	0.00	0.00	40°32'16.260"N	104°45'09.202"W	0.00	
25.00	0.000	74.340	25.00	0.00	0.00	0.00	40°32'16.260"N	104°45'09.202"W	0.00	
236.00	0.220	74.340	236.00	0.38	0.11	0.39	40°32'16.261"N	104°45'09.197"W	0.10	
330.00	1.200	225.700	329.99	-0.11	-0.53	-0.14	40°32'16.255"N	104°45'09.203"W	1.49	
425.00	1.890	238.230	424.96	-2.06	-2.05	-2.18	40°32'16.240"N	104°45'09.230"W	0.80	
520.00	3.180	229.980	519.86	-5.26	-4.57	-5.53	40°32'16.215"N	104°45'09.273"W	1.41	
614.00	4.860	228.920	613.63	-10.01	-8.86	-10.53	40°32'16.172"N	104°45'09.338"W	1.79	
709.00	6.540	225.850	708.16	-16.54	-15.28	-17.45	40°32'16.109"N	104°45'09.428"W	1.80	
804.00	8.570	217.120	802.33	-24.15	-24.69	-25.60	40°32'16.016"N	104°45'09.533"W	2.45	
898.00	9.390	217.100	895.18	-32.31	-36.39	-34.46	40°32'15.900"N	104°45'09.648"W	0.87	
993.00	9.310	217.400	988.91	-40.93	-48.68	-43.80	40°32'15.779"N	104°45'09.769"W	0.10	
1088.00	9.020	215.860	1082.70	-49.25	-60.82	-52.83	40°32'15.659"N	104°45'09.886"W	0.40	
1182.00	9.440	222.990	1175.49	-58.14	-72.43	-62.40	40°32'15.544"N	104°45'10.010"W	1.30	
1277.00	9.460	224.890	1269.20	-68.30	-83.66	-73.22	40°32'15.433"N	104°45'10.150"W	0.33	
1372.00	8.830	224.490	1362.99	-78.29	-94.39	-83.84	40°32'15.327"N	104°45'10.288"W	0.67	
1467.00	9.450	223.850	1456.78	-88.16	-105.21	-94.36	40°32'15.220"N	104°45'10.424"W	0.66	
1490.00	10.100	224.790	1479.45	-90.73	-108.01	-97.08	40°32'15.193"N	104°45'10.459"W	2.91	
1686.00	8.620	210.850	1672.86	-108.92	-132.82	-116.73	40°32'14.948"N	104°45'10.713"W	1.38	FIRST BHGE SURVEY (473'FNL & 369'FWL,SEC.35)
1780.00	9.030	213.170	1765.75	-115.85	-145.04	-124.38	40°32'14.827"N	104°45'10.812"W	0.58	
1875.00	8.980	218.090	1859.58	-123.80	-157.12	-133.03	40°32'14.707"N	104°45'10.925"W	0.81	
1970.00	8.960	223.100	1953.42	-132.77	-168.35	-142.66	40°32'14.596"N	104°45'11.049"W	0.82	
2064.00	9.110	220.820	2046.25	-141.99	-179.33	-152.52	40°32'14.488"N	104°45'11.177"W	0.41	
2159.00	9.020	222.860	2140.07	-151.31	-190.48	-162.51	40°32'14.378"N	104°45'11.306"W	0.35	
2253.00	8.980	221.780	2232.91	-160.57	-201.35	-172.41	40°32'14.270"N	104°45'11.435"W	0.18	
2347.00	8.970	221.980	2325.76	-169.72	-212.27	-182.19	40°32'14.162"N	104°45'11.561"W	0.03	
2442.00	8.840	223.820	2419.61	-179.09	-223.04	-192.20	40°32'14.056"N	104°45'11.691"W	0.33	
2537.00	9.020	231.440	2513.46	-189.38	-232.95	-203.08	40°32'13.958"N	104°45'11.832"W	1.26	
2631.00	8.850	238.570	2606.33	-200.82	-241.32	-215.01	40°32'13.875"N	104°45'11.986"W	1.19	
2726.00	8.980	240.630	2700.18	-213.06	-248.76	-227.71	40°32'13.802"N	104°45'12.151"W	0.36	
2821.00	9.090	239.730	2794.00	-225.56	-256.18	-240.65	40°32'13.729"N	104°45'12.318"W	0.19	

# Actual Wellpath Report

KTC FARMS EA-35-36HN AWP

Page 3 of 10

## REFERENCE WELLPATH IDENTIFICATION

Operator	BAYSWATER E & P LLC	Slot	SLOT#07 KTC FARMS EA-35-36HN (342'FNL & 473'FWL,SEC.35)
Area	COLORADO	Well	KTC FARMS EA-35-36HN
Field	WELD COUNTY (NAD83/TRUE NORTH)	Wellbore	KTC FARMS EA-35-36HN AWP
Facility	SEC.35-T07N-R66W		

## WELLPATH DATA (184 stations)

MD [ft]	Inclination [°]	Azimuth [°]	TVD [ft]	Vert Sect [ft]	North [ft]	East [ft]	Latitude	Longitude	DLS [°/100ft]	Comments
2915.00	8.990	236.530	2886.83	-237.63	-263.98	-253.19	40°32'13.652"N	104°45'12.481"W	0.55	
3010.00	9.000	230.910	2980.67	-249.07	-272.76	-265.15	40°32'13.565"N	104°45'12.636"W	0.92	
3105.00	9.030	232.000	3074.49	-260.16	-282.03	-276.79	40°32'13.473"N	104°45'12.787"W	0.18	
3199.00	8.870	222.710	3167.35	-270.30	-291.90	-287.52	40°32'13.376"N	104°45'12.925"W	1.55	
3294.00	8.970	214.660	3261.21	-278.81	-303.37	-296.70	40°32'13.262"N	104°45'13.044"W	1.32	
3388.00	8.660	205.440	3354.10	-285.29	-315.79	-303.91	40°32'13.140"N	104°45'13.138"W	1.54	
3483.00	8.840	212.700	3448.00	-291.58	-328.39	-310.93	40°32'13.015"N	104°45'13.229"W	1.18	
3578.00	8.900	219.980	3541.87	-299.55	-340.17	-319.59	40°32'12.899"N	104°45'13.341"W	1.18	
3672.00	8.900	222.910	3634.74	-308.53	-351.06	-329.21	40°32'12.791"N	104°45'13.465"W	0.48	
3767.00	8.910	221.520	3728.59	-317.77	-361.95	-339.09	40°32'12.683"N	104°45'13.593"W	0.23	
3861.00	8.990	221.280	3821.45	-326.80	-372.92	-348.77	40°32'12.575"N	104°45'13.719"W	0.09	
3954.00	9.040	201.110	3913.32	-333.51	-385.20	-356.19	40°32'12.454"N	104°45'13.815"W	3.38	
4049.00	8.900	191.800	4007.16	-336.88	-399.36	-360.38	40°32'12.314"N	104°45'13.869"W	1.53	
4143.00	8.610	189.780	4100.07	-338.75	-413.41	-363.07	40°32'12.175"N	104°45'13.904"W	0.45	
4238.00	9.120	197.850	4193.94	-341.45	-427.59	-366.58	40°32'12.035"N	104°45'13.949"W	1.41	
4332.00	9.100	205.690	4286.75	-346.16	-441.38	-372.09	40°32'11.899"N	104°45'14.021"W	1.32	
4426.00	9.110	203.400	4379.57	-351.55	-454.91	-378.27	40°32'11.765"N	104°45'14.101"W	0.39	
4521.00	9.280	205.090	4473.35	-356.98	-468.74	-384.50	40°32'11.628"N	104°45'14.181"W	0.34	
4616.00	9.050	206.330	4567.14	-362.75	-482.38	-391.06	40°32'11.493"N	104°45'14.266"W	0.32	
4710.00	9.220	210.090	4659.95	-369.04	-495.52	-398.12	40°32'11.364"N	104°45'14.358"W	0.66	
4805.00	9.130	212.750	4753.73	-376.18	-508.44	-406.01	40°32'11.236"N	104°45'14.460"W	0.46	
4900.00	9.120	212.690	4847.53	-383.58	-521.12	-414.15	40°32'11.111"N	104°45'14.566"W	0.01	
4995.00	9.110	218.470	4941.33	-391.61	-533.34	-422.90	40°32'10.990"N	104°45'14.679"W	0.96	
5089.00	9.100	222.050	5034.15	-400.55	-544.69	-432.51	40°32'10.878"N	104°45'14.803"W	0.60	
5184.00	9.090	229.300	5127.96	-410.65	-555.16	-443.23	40°32'10.774"N	104°45'14.942"W	1.21	
5279.00	9.060	236.260	5221.77	-422.02	-564.21	-455.14	40°32'10.685"N	104°45'15.096"W	1.16	
5372.00	9.000	240.580	5313.62	-433.99	-571.85	-467.56	40°32'10.609"N	104°45'15.257"W	0.73	
5467.00	8.900	238.930	5407.46	-446.31	-579.29	-480.33	40°32'10.536"N	104°45'15.423"W	0.29	
5561.00	9.080	236.940	5500.31	-458.29	-587.09	-492.78	40°32'10.459"N	104°45'15.584"W	0.38	
5655.00	9.010	233.410	5593.14	-469.91	-595.53	-504.90	40°32'10.375"N	104°45'15.741"W	0.59	

# Actual Wellpath Report

KTC FARMS EA-35-36HN AWP

Page 4 of 10

## REFERENCE WELLPATH IDENTIFICATION

Operator	BAYSWATER E & P LLC	Slot	SLOT#07 KTC FARMS EA-35-36HN (342'FNL & 473'FWL,SEC.35)
Area	COLORADO	Well	KTC FARMS EA-35-36HN
Field	WELD COUNTY (NAD83/TRUE NORTH)	Wellbore	KTC FARMS EA-35-36HN AWP
Facility	SEC.35-T07N-R66W		

## WELLPATH DATA (184 stations)

MD [ft]	Inclination [°]	Azimuth [°]	TVD [ft]	Vert Sect [ft]	North [ft]	East [ft]	Latitude	Longitude	DLS [°/100ft]	Comments
5749.00	8.940	232.370	5685.99	-481.08	-604.37	-516.60	40°32'10.288"N	104°45'15.892"W	0.19	
5844.00	8.900	230.560	5779.84	-492.05	-613.55	-528.12	40°32'10.197"N	104°45'16.042"W	0.30	
5938.00	9.080	223.900	5872.69	-502.22	-623.51	-538.88	40°32'10.099"N	104°45'16.181"W	1.12	
6033.00	9.090	216.050	5966.50	-511.16	-634.98	-548.49	40°32'09.985"N	104°45'16.305"W	1.30	
6127.00	9.180	208.780	6059.31	-518.41	-647.56	-556.47	40°32'09.861"N	104°45'16.409"W	1.23	
6221.00	9.000	212.250	6152.13	-525.20	-660.35	-564.00	40°32'09.735"N	104°45'16.506"W	0.61	
6315.00	8.770	212.990	6245.00	-532.31	-672.58	-571.83	40°32'09.614"N	104°45'16.608"W	0.27	
6410.00	8.890	212.470	6338.88	-539.47	-684.84	-579.71	40°32'09.493"N	104°45'16.710"W	0.15	
6504.00	8.920	212.810	6431.74	-546.61	-697.10	-587.56	40°32'09.372"N	104°45'16.811"W	0.06	
6599.00	3.240	196.120	6526.18	-550.84	-705.87	-592.30	40°32'09.285"N	104°45'16.873"W	6.20	
6693.00	6.750	69.880	6619.97	-546.35	-706.53	-587.84	40°32'09.278"N	104°45'16.815"W	9.63	
6788.00	15.000	79.560	6713.19	-529.25	-702.37	-570.48	40°32'09.320"N	104°45'16.590"W	8.86	
6883.00	24.600	83.190	6802.47	-497.76	-697.79	-538.68	40°32'09.365"N	104°45'16.178"W	10.18	
6977.00	33.330	86.950	6884.64	-452.75	-694.09	-493.37	40°32'09.401"N	104°45'15.592"W	9.48	
7072.00	43.430	89.510	6959.02	-394.07	-692.41	-434.50	40°32'09.418"N	104°45'14.829"W	10.76	
7167.00	53.880	90.440	7021.69	-322.96	-692.43	-363.28	40°32'09.418"N	104°45'13.907"W	11.02	
7261.00	63.460	90.940	7070.51	-242.84	-693.41	-283.09	40°32'09.408"N	104°45'12.868"W	10.20	
7356.00	74.290	91.600	7104.70	-154.41	-695.39	-194.63	40°32'09.389"N	104°45'11.722"W	11.42	
7451.00	84.510	91.260	7122.15	-61.21	-697.72	-101.40	40°32'09.366"N	104°45'10.515"W	10.76	
7546.00	86.150	90.290	7129.89	33.38	-699.00	-6.73	40°32'09.353"N	104°45'09.289"W	2.00	
7640.00	86.150	88.590	7136.20	126.95	-698.08	87.05	40°32'09.362"N	104°45'08.074"W	1.80	
7735.00	85.900	87.880	7142.78	221.36	-695.16	181.78	40°32'09.391"N	104°45'06.847"W	0.79	
7830.00	86.120	87.280	7149.39	315.65	-691.16	276.46	40°32'09.430"N	104°45'05.621"W	0.67	
7924.00	85.690	86.780	7156.11	408.86	-686.30	370.10	40°32'09.478"N	104°45'04.408"W	0.70	
8019.00	87.850	87.040	7161.46	503.11	-681.19	464.80	40°32'09.529"N	104°45'03.182"W	2.29	
8114.00	90.060	88.220	7163.19	597.63	-677.26	559.70	40°32'09.568"N	104°45'01.953"W	2.64	
8209.00	90.030	89.100	7163.12	692.31	-675.04	654.67	40°32'09.590"N	104°45'00.723"W	0.93	
8303.00	90.060	90.160	7163.04	786.12	-674.43	748.67	40°32'09.596"N	104°44'59.505"W	1.13	
8398.00	90.120	91.180	7162.89	881.02	-675.54	843.66	40°32'09.585"N	104°44'58.275"W	1.08	
8493.00	89.970	91.670	7162.82	975.97	-677.91	938.63	40°32'09.561"N	104°44'57.045"W	0.54	

# Actual Wellpath Report

KTC FARMS EA-35-36HN AWP

Page 5 of 10

## REFERENCE WELLPATH IDENTIFICATION

Operator	BAYSWATER E & P LLC	Slot	SLOT#07 KTC FARMS EA-35-36HN (342'FNL & 473'FWL,SEC.35)
Area	COLORADO	Well	KTC FARMS EA-35-36HN
Field	WELD COUNTY (NAD83/TRUE NORTH)	Wellbore	KTC FARMS EA-35-36HN AWP
Facility	SEC.35-T07N-R66W		

## WELLPATH DATA (184 stations)

MD [ft]	Inclination [°]	Azimuth [°]	TVD [ft]	Vert Sect [ft]	North [ft]	East [ft]	Latitude	Longitude	DLS [°/100ft]	Comments
8588.00	89.940	92.330	7162.89	1070.95	-681.22	1033.57	40°32'09.528"N	104°44'55.815"W	0.70	
8682.00	90.000	91.860	7162.94	1164.93	-684.66	1127.51	40°32'09.494"N	104°44'54.599"W	0.50	
8776.00	90.060	91.560	7162.89	1258.89	-687.46	1221.47	40°32'09.467"N	104°44'53.382"W	0.33	
8871.00	90.060	91.310	7162.79	1353.84	-689.84	1316.44	40°32'09.443"N	104°44'52.152"W	0.26	
8965.00	89.850	90.840	7162.87	1447.77	-691.61	1410.42	40°32'09.426"N	104°44'50.935"W	0.55	
9060.00	90.090	89.710	7162.92	1542.64	-692.06	1505.42	40°32'09.421"N	104°44'49.704"W	1.22	
9154.00	89.910	88.800	7162.92	1636.40	-690.84	1599.41	40°32'09.433"N	104°44'48.487"W	0.99	
9249.00	90.000	88.130	7162.99	1731.07	-688.29	1694.37	40°32'09.458"N	104°44'47.257"W	0.71	
9343.00	90.060	87.600	7162.94	1824.64	-684.79	1788.31	40°32'09.493"N	104°44'46.040"W	0.57	
9437.00	89.940	86.820	7162.94	1918.12	-680.22	1882.19	40°32'09.538"N	104°44'44.824"W	0.84	
9532.00	89.910	85.730	7163.07	2012.40	-674.05	1976.99	40°32'09.599"N	104°44'43.597"W	1.15	
9627.00	90.280	85.730	7162.91	2106.58	-666.97	2071.73	40°32'09.669"N	104°44'42.370"W	0.39	
9720.00	90.460	85.300	7162.31	2198.72	-659.70	2164.44	40°32'09.740"N	104°44'41.169"W	0.50	
9814.00	90.580	86.840	7161.46	2291.97	-653.26	2258.21	40°32'09.804"N	104°44'39.954"W	1.64	
9908.00	90.280	86.830	7160.75	2385.37	-648.07	2352.07	40°32'09.855"N	104°44'38.739"W	0.32	
10003.00	90.310	86.680	7160.26	2479.75	-642.69	2446.91	40°32'09.908"N	104°44'37.510"W	0.16	
10097.00	92.310	87.620	7158.11	2573.18	-638.02	2540.77	40°32'09.954"N	104°44'36.295"W	2.35	
10191.00	92.120	88.940	7154.48	2666.75	-635.20	2634.65	40°32'09.982"N	104°44'35.079"W	1.42	
10286.00	92.060	89.440	7151.02	2761.45	-633.86	2729.58	40°32'09.995"N	104°44'33.849"W	0.53	
10381.00	92.060	91.150	7147.60	2856.25	-634.35	2824.51	40°32'09.990"N	104°44'32.620"W	1.80	
10476.00	92.150	91.950	7144.11	2951.14	-636.91	2919.41	40°32'09.965"N	104°44'31.391"W	0.85	
10570.00	92.150	91.470	7140.58	3045.04	-639.72	3013.31	40°32'09.937"N	104°44'30.175"W	0.51	
10665.00	92.090	90.750	7137.07	3139.91	-641.56	3108.22	40°32'09.919"N	104°44'28.945"W	0.76	
10760.00	92.060	90.630	7133.63	3234.75	-642.70	3203.15	40°32'09.907"N	104°44'27.716"W	0.13	
10854.00	92.120	90.200	7130.20	3328.57	-643.38	3297.09	40°32'09.900"N	104°44'26.499"W	0.46	
10949.00	92.250	89.780	7126.58	3423.34	-643.36	3392.02	40°32'09.900"N	104°44'25.270"W	0.46	
11044.00	92.190	90.180	7122.90	3518.11	-643.33	3486.95	40°32'09.901"N	104°44'24.040"W	0.43	
11138.00	92.340	89.250	7119.19	3611.85	-642.86	3580.87	40°32'09.905"N	104°44'22.824"W	1.00	
11233.00	92.120	88.640	7115.49	3706.51	-641.11	3675.78	40°32'09.922"N	104°44'21.595"W	0.68	
11327.00	92.000	89.240	7112.11	3800.18	-639.38	3769.71	40°32'09.939"N	104°44'20.378"W	0.65	



# Actual Wellpath Report

KTC FARMS EA-35-36HN AWP

Page 6 of 10

## REFERENCE WELLPATH IDENTIFICATION

Operator	BAYSWATER E & P LLC	Slot	SLOT#07 KTC FARMS EA-35-36HN (342'FNL & 473'FWL,SEC.35)
Area	COLORADO	Well	KTC FARMS EA-35-36HN
Field	WELD COUNTY (NAD83/TRUE NORTH)	Wellbore	KTC FARMS EA-35-36HN AWP
Facility	SEC.35-T07N-R66W		

## WELLPATH DATA (184 stations)

MD [ft]	Inclination [°]	Azimuth [°]	TVD [ft]	Vert Sect [ft]	North [ft]	East [ft]	Latitude	Longitude	DLS [°/100ft]	Comments
11422.00	92.090	89.270	7108.72	3894.88	-638.14	3864.64	40°32'09.951"N	104°44'19.149"W	0.10	
11516.00	92.090	89.520	7105.29	3988.60	-637.15	3958.57	40°32'09.961"N	104°44'17.932"W	0.27	
11611.00	92.150	89.130	7101.78	4083.31	-636.03	4053.50	40°32'09.972"N	104°44'16.703"W	0.42	
11705.00	92.090	88.780	7098.30	4176.97	-634.32	4147.42	40°32'09.989"N	104°44'15.486"W	0.38	
11800.00	92.180	88.560	7094.76	4271.60	-632.12	4242.33	40°32'10.010"N	104°44'14.257"W	0.25	
11895.00	92.090	87.820	7091.22	4366.16	-629.12	4337.21	40°32'10.040"N	104°44'13.028"W	0.78	
11989.00	92.310	87.200	7087.61	4459.61	-625.04	4431.05	40°32'10.080"N	104°44'11.813"W	0.70	
12084.00	92.280	87.040	7083.81	4553.99	-620.27	4525.86	40°32'10.127"N	104°44'10.585"W	0.17	
12179.00	91.970	87.160	7080.29	4648.37	-615.46	4620.67	40°32'10.174"N	104°44'09.357"W	0.35	
12273.00	91.940	85.980	7077.08	4741.67	-609.84	4714.45	40°32'10.229"N	104°44'08.142"W	1.25	
12368.00	92.090	87.320	7073.74	4835.97	-604.30	4809.22	40°32'10.284"N	104°44'06.915"W	1.42	
12463.00	91.910	88.570	7070.42	4930.50	-600.89	4904.10	40°32'10.318"N	104°44'05.686"W	1.33	
12557.00	91.750	89.100	7067.42	5024.16	-598.98	4998.03	40°32'10.336"N	104°44'04.470"W	0.59	
12652.00	90.890	90.940	7065.23	5118.98	-599.01	5093.00	40°32'10.336"N	104°44'03.240"W	2.14	
12746.00	89.720	93.150	7064.73	5212.95	-602.37	5186.93	40°32'10.302"N	104°44'02.023"W	2.66	
12841.00	91.050	94.910	7064.09	5307.93	-609.04	5281.69	40°32'10.236"N	104°44'00.796"W	2.32	
12936.00	89.880	93.020	7063.32	5402.92	-615.61	5376.46	40°32'10.171"N	104°43'59.568"W	2.34	
13030.00	89.780	91.720	7063.60	5496.90	-619.50	5470.37	40°32'10.132"N	104°43'58.352"W	1.39	
13125.00	89.720	91.620	7064.02	5591.86	-622.27	5565.33	40°32'10.105"N	104°43'57.122"W	0.12	
13220.00	89.570	95.120	7064.61	5686.85	-627.85	5660.15	40°32'10.050"N	104°43'55.894"W	3.69	
13315.00	89.230	94.640	7065.60	5781.80	-635.93	5754.80	40°32'09.969"N	104°43'54.668"W	0.62	
13410.00	89.260	93.040	7066.85	5876.79	-642.29	5849.58	40°32'09.906"N	104°43'53.441"W	1.68	
13504.00	89.720	89.590	7067.69	5970.71	-644.45	5943.53	40°32'09.885"N	104°43'52.224"W	3.70	
13599.00	89.910	86.940	7068.00	6065.34	-641.57	6038.48	40°32'09.913"N	104°43'50.994"W	2.80	
13694.00	90.060	83.920	7068.02	6159.44	-634.01	6133.17	40°32'09.988"N	104°43'49.768"W	3.18	
13789.00	89.910	83.460	7068.05	6253.11	-623.56	6227.59	40°32'10.091"N	104°43'48.545"W	0.51	
13883.00	90.060	84.500	7068.07	6345.87	-613.71	6321.07	40°32'10.188"N	104°43'47.334"W	1.12	
13978.00	90.000	85.300	7068.02	6439.85	-605.26	6415.69	40°32'10.271"N	104°43'46.109"W	0.84	
14097.00	90.150	85.930	7067.86	6557.78	-596.16	6534.35	40°32'10.361"N	104°43'44.572"W	0.54	
14166.00	90.000	85.330	7067.77	6626.17	-590.91	6603.14	40°32'10.412"N	104°43'43.681"W	0.90	

# Actual Wellpath Report

KTC FARMS EA-35-36HN AWP

Page 7 of 10

## REFERENCE WELLPATH IDENTIFICATION

Operator	BAYSWATER E & P LLC	Slot	SLOT#07 KTC FARMS EA-35-36HN (342'FNL & 473'FWL,SEC.35)
Area	COLORADO	Well	KTC FARMS EA-35-36HN
Field	WELD COUNTY (NAD83/TRUE NORTH)	Wellbore	KTC FARMS EA-35-36HN AWP
Facility	SEC.35-T07N-R66W		

## WELLPATH DATA (184 stations)

MD [ft]	Inclination [°]	Azimuth [°]	TVD [ft]	Vert Sect [ft]	North [ft]	East [ft]	Latitude	Longitude	DLS [°/100ft]	Comments
14260.00	89.940	86.050	7067.82	6719.34	-583.84	6696.88	40°32'10.482"N	104°43'42.467"W	0.77	
14355.00	90.310	89.150	7067.62	6813.86	-579.86	6791.78	40°32'10.521"N	104°43'41.238"W	3.29	
14449.00	90.090	90.730	7067.29	6907.70	-579.77	6885.78	40°32'10.522"N	104°43'40.020"W	1.70	
14544.00	90.030	90.550	7067.19	7002.60	-580.83	6980.77	40°32'10.511"N	104°43'38.790"W	0.20	
14639.00	90.030	88.280	7067.14	7097.37	-579.86	7075.76	40°32'10.520"N	104°43'37.560"W	2.39	
14734.00	90.030	87.050	7067.09	7191.91	-575.99	7170.68	40°32'10.558"N	104°43'36.330"W	1.29	
14828.00	90.030	87.390	7067.04	7285.39	-571.43	7264.57	40°32'10.603"N	104°43'35.114"W	0.36	
14923.00	89.970	89.500	7067.04	7380.04	-568.85	7359.53	40°32'10.628"N	104°43'33.884"W	2.22	
15018.00	90.250	92.470	7066.86	7474.96	-570.48	7454.51	40°32'10.612"N	104°43'32.654"W	3.14	
15112.00	90.680	94.100	7066.09	7568.95	-575.87	7548.34	40°32'10.558"N	104°43'31.439"W	1.79	
15207.00	90.060	91.460	7065.48	7663.93	-580.47	7643.22	40°32'10.512"N	104°43'30.210"W	2.85	
15302.00	90.220	88.880	7065.25	7758.79	-580.76	7738.21	40°32'10.509"N	104°43'28.980"W	2.72	
15396.00	90.310	87.620	7064.81	7852.42	-577.89	7832.17	40°32'10.537"N	104°43'27.763"W	1.34	
15490.00	90.860	88.630	7063.85	7946.03	-574.81	7926.11	40°32'10.567"N	104°43'26.546"W	1.22	
15585.00	90.650	87.590	7062.60	8040.63	-571.68	8021.05	40°32'10.598"N	104°43'25.317"W	1.12	
15680.00	90.030	86.800	7062.04	8135.09	-567.03	8115.93	40°32'10.644"N	104°43'24.088"W	1.06	
15775.00	89.780	86.070	7062.20	8229.41	-561.12	8210.75	40°32'10.702"N	104°43'22.860"W	0.81	
15869.00	89.780	87.320	7062.56	8322.79	-555.70	8304.59	40°32'10.755"N	104°43'21.644"W	1.33	
15963.00	89.690	87.310	7062.99	8416.28	-551.30	8398.48	40°32'10.798"N	104°43'20.428"W	0.10	
16057.00	89.910	89.300	7063.32	8509.92	-548.52	8492.44	40°32'10.825"N	104°43'19.211"W	2.13	
16152.00	89.690	91.040	7063.65	8604.77	-548.80	8587.43	40°32'10.822"N	104°43'17.981"W	1.85	
16247.00	90.520	92.370	7063.48	8699.73	-551.63	8682.39	40°32'10.794"N	104°43'16.751"W	1.65	
16342.00	90.370	92.420	7062.74	8794.72	-555.60	8777.30	40°32'10.754"N	104°43'15.522"W	0.17	
16435.00	89.910	88.500	7062.51	8887.59	-556.34	8870.28	40°32'10.747"N	104°43'14.318"W	4.24	
16530.00	90.030	89.080	7062.56	8982.29	-554.34	8965.26	40°32'10.766"N	104°43'13.088"W	0.62	
16625.00	90.180	91.390	7062.39	9077.15	-554.73	9060.25	40°32'10.762"N	104°43'11.857"W	2.44	
16719.00	89.820	90.400	7062.39	9171.07	-556.20	9154.24	40°32'10.747"N	104°43'10.640"W	1.12	
16813.00	89.850	88.630	7062.66	9264.86	-555.40	9248.23	40°32'10.755"N	104°43'09.423"W	1.88	
16908.00	89.880	87.480	7062.88	9359.46	-552.18	9343.17	40°32'10.786"N	104°43'08.193"W	1.21	
17002.00	89.850	87.070	7063.10	9452.95	-547.71	9437.07	40°32'10.830"N	104°43'06.977"W	0.44	



# Actual Wellpath Report

KTC FARMS EA-35-36HN AWP

Page 8 of 10

## REFERENCE WELLPATH IDENTIFICATION

Operator	BAYSWATER E & P LLC	Slot	SLOT#07 KTC FARMS EA-35-36HN (342'FNL & 473'FWL,SEC.35)
Area	COLORADO	Well	KTC FARMS EA-35-36HN
Field	WELD COUNTY (NAD83/TRUE NORTH)	Wellbore	KTC FARMS EA-35-36HN AWP
Facility	SEC.35-T07N-R66W		

## WELLPATH DATA (184 stations)

MD [ft]	Inclination [°]	Azimuth [°]	TVD [ft]	Vert Sect [ft]	North [ft]	East [ft]	Latitude	Longitude	DLS [°/100ft]	Comments
17097.00	90.680	88.270	7062.66	9547.49	-543.84	9531.99	40°32'10.868"N	104°43'05.748"W	1.54	
17191.00	90.060	87.210	7062.06	9641.04	-540.14	9625.91	40°32'10.904"N	104°43'04.531"W	1.31	
17265.00	90.250	97.130	7061.86	9714.94	-542.94	9699.76	40°32'10.876"N	104°43'03.575"W	13.41	LAST BHGE SURVEY (1023'FNL & 501'FEL,SEC.36)
17290.00	90.250	97.130	7061.75	9739.88	-546.04	9724.57	40°32'10.845"N	104°43'03.253"W	0.00	PROJ TO BIT (1027'FNL & 476'FEL,SEC.36)

## TARGETS

Name	TVD [ft]	North [ft]	East [ft]	Grid East [US ft]	Grid North [US ft]	Latitude	Longitude	Shape
KTC FARMS EA-35-36HN BHL PLAT (1040'FNL & 470'FEL,SEC.36)	7061.00	-559.13	9731.08	3217480.27	1439178.00	40°32'10.716"N	104°43'03.169"W	point
KTC FARMS EA-35-36HN WP2 (2180'SS)	7066.00	-626.05	5038.18	3212788.25	1439071.53	40°32'10.069"N	104°44'03.950"W	point
KTC FARMS EA-35-36HN LP REV-1 (1040'FNL & 470'FWL,SEC.35)	7141.00	-698.79	-61.18	3207689.85	1438955.82	40°32'09.355"N	104°45'09.994"W	point
KTC FARMS EA-35-36HN WP1 (2275'SS @ 10000'MD)	7161.00	-663.12	2438.52	3210189.08	1439012.55	40°32'09.706"N	104°44'37.619"W	point
SEC.35-T07N-R66W	12000.00	89.99	-1.11	3207743.27	1439745.05	40°32'17.149"N	104°45'09.216"W	polygon
SEC.36-T07N-R66W	12000.00	89.99	-1.11	3207743.27	1439745.05	40°32'17.149"N	104°45'09.216"W	polygon

# Actual Wellpath Report

KTC FARMS EA-35-36HN AWP

Page 9 of 10

## REFERENCE WELLPATH IDENTIFICATION

Operator	BAYSWATER E & P LLC	Slot	SLOT#07 KTC FARMS EA-35-36HN (342'FNL & 473'FWL,SEC.35)
Area	COLORADO	Well	KTC FARMS EA-35-36HN
Field	WELD COUNTY (NAD83/TRUE NORTH)	Wellbore	KTC FARMS EA-35-36HN AWB
Facility	SEC.35-T07N-R66W		

## WELLPATH COMPOSITION - Ref Wellbore: KTC FARMS EA-35-36HN AWB Ref Wellpath: KTC FARMS EA-35-36HN AWP

Start MD [ft]	End MD [ft]	Positional Uncertainty Model	Log Name/Comment	Wellbore
25.00	1490.00	BHI NaviTrak (Standard)	BHI NAVITRAK (STANDARD) <236-1490>	KTC FARMS EA-35-36HN AWB
1490.00	17265.00	BHI AutoTrak Curve (Short)	BHI AUTOTRAK CURVE (SHORT) <1591-17265>	KTC FARMS EA-35-36HN AWB
17265.00	17290.00	Blind Drilling (std)	Projection to bit	KTC FARMS EA-35-36HN AWB

# Actual Wellpath Report

KTC FARMS EA-35-36HN AWP

Page 10 of 10

REFERENCE WELLPATH IDENTIFICATION			
Operator	BAYSWATER E & P LLC	Slot	SLOT#07 KTC FARMS EA-35-36HN (342'FNL & 473'FWL,SEC.35)
Area	COLORADO	Well	KTC FARMS EA-35-36HN
Field	WELD COUNTY (NAD83/TRUE NORTH)	Wellbore	KTC FARMS EA-35-36HN AWP
Facility	SEC.35-T07N-R66W		

WELLPATH COMMENTS				
MD [ft]	Inclination [°]	Azimuth [°]	TVD [ft]	Comment
1686.00	8.620	210.850	1672.86	FIRST BHGE SURVEY (473'FNL & 369'FWL,SEC.35)
17265.00	90.250	97.130	7061.86	LAST BHGE SURVEY (1023'FNL & 501'FEL,SEC.36)
17290.00	90.250	97.130	7061.75	PROJ TO BIT (1027'FNL & 476'FEL,SEC.36)