

BAYSWATER E & P LLC

Location: COLORADO
Field: WELD COUNTY (NAD83/TRUE NORTH)
Facility: SEC.35-T07N-R66W

Slot: SLOT#03 KTC FARMS BA-35-36HN (282'FNL & 467'FWL,SEC.35)
Well: KTC FARMS BA-35-36HN
Wellbore: KTC FARMS BA-35-36HN.PWB

Plot reference wellpath is KTC FARMS BA-35-36HN (REV-F.0) PWB

True vertical depths are referenced to TRUE 38 (4861'GL+25'KB@4886'RKB) (RKB)

Measured depths are referenced to TRUE 38 (4861'GL+25'KB@4886'RKB) (RKB)

TRUE 38 (4861'GL+25'KB@4886'RKB) (RKB) to Mean Sea Level: 4886 feet

Mean Sea Level to Ground level (At Slot: SLOT#03 KTC FARMS BA-35-36HN (282'FNL & 467'FWL,SEC.35)): 0 feet

Coordinates are in feet referenced to Slot

Grid System: NAD83 / Lambert Colorado SP, Northern Zone (501), US feet

North Reference: True north

Scale: True distance

Depths are in feet

Created by: bushjamh on 2018-11-28

Database: Denver

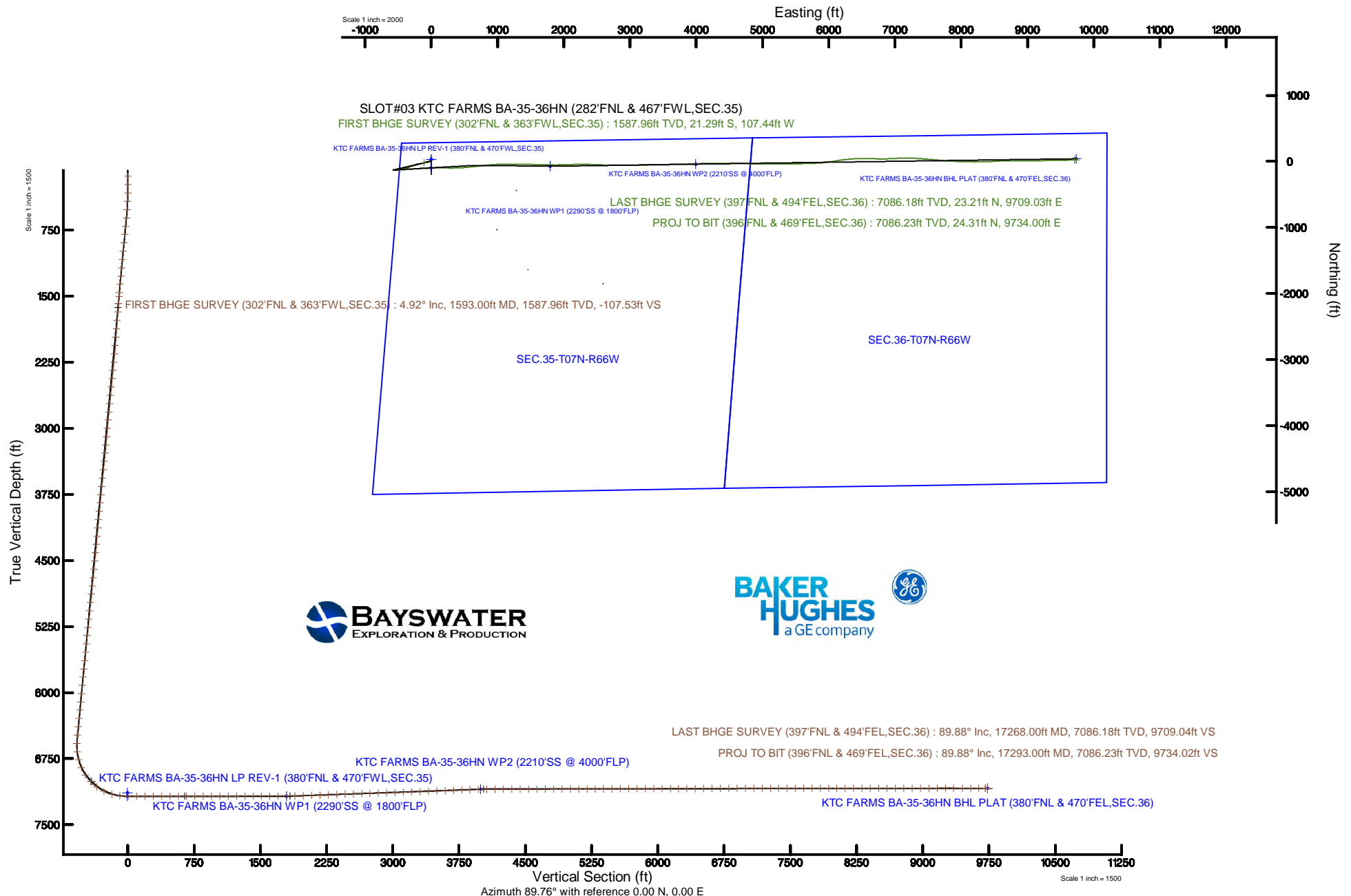

Actual Wellpath Report

KTC FARMS BA-35-36HN AWP

Page 1 of 10

REFERENCE WELLPATH IDENTIFICATION

Operator	BAYSWATER E & P LLC	Slot	SLOT#03 KTC FARMS BA-35-36HN (282'FNL & 467'FWL,SEC.35)
Area	COLORADO	Well	KTC FARMS BA-35-36HN
Field	WELD COUNTY (NAD83/TRUE NORTH)	Wellbore	KTC FARMS BA-35-36HN AWB
Facility	SEC.35-T07N-R66W		

REPORT SETUP INFORMATION

Projection System	NAD83 / Lambert Colorado SP, Northern Zone (501), US feet	Software System	WellArchitect® 5.1
North Reference	True	User	Bushjamh
Scale	0.999969	Report Generated	11/28/2018 at 4:06:05 AM
Convergence at slot	0.48° East	Database/Source file	Denver/KTC_FARMS_BA-35-36HN_AWP.xml

WELLPATH LOCATION

	Local coordinates		Grid coordinates		Geographic coordinates	
	North[ft]	East[ft]	Easting[US ft]	Northing[US ft]	Latitude	Longitude
Slot Location	-29.87	0.28	3207743.80	1439715.18	40°32'16.854"N	104°45'09.212"W
Facility Reference Pt			3207743.27	1439745.05	40°32'17.149"N	104°45'09.216"W
Field Reference Pt			3174587.00	1430859.71	40°30'51.890"N	104°52'19.470"W

WELLPATH DATUM

Calculation method	Minimum curvature	TRUE 38 (4861'GL+25'KB@4886'RKB) (RKB) to Facility Vertical Datum	4886.00ft
Horizontal Reference Pt	Slot	TRUE 38 (4861'GL+25'KB@4886'RKB) (RKB) to Mean Sea Level	4886.00ft
Vertical Reference Pt	TRUE 38 (4861'GL+25'KB@4886'RKB) (RKB)	TRUE 38 (4861'GL+25'KB@4886'RKB) (RKB) to Ground Level at Slot (SLOT#03 KTC FARMS BA-35-36HN (282'FNL & 467'FWL,SEC.35))	4886.00ft
MD Reference Pt	TRUE 38 (4861'GL+25'KB@4886'RKB) (RKB)	Section Origin	N 0.00, E 0.00 ft
Field Vertical Reference	Mean Sea Level	Section Azimuth	89.76°

Actual Wellpath Report

KTC FARMS BA-35-36HN AWP

Page 2 of 10

REFERENCE WELLPATH IDENTIFICATION

Operator	BAYSWATER E & P LLC	Slot	SLOT#03 KTC FARMS BA-35-36HN (282'FNL & 467'FWL,SEC.35)
Area	COLORADO	Well	KTC FARMS BA-35-36HN
Field	WELD COUNTY (NAD83/TRUE NORTH)	Wellbore	KTC FARMS BA-35-36HN AWP
Facility	SEC.35-T07N-R66W		

WELLPATH DATA (186 stations) † = interpolated/extrapolated station

MD [ft]	Inclination [°]	Azimuth [°]	TVD [ft]	Vert Sect [ft]	North [ft]	East [ft]	Latitude	Longitude	DLS [°/100ft]	Comments
0.00†	0.000	140.380	0.00	0.00	0.00	0.00	40°32'16.854"N	104°45'09.212"W	0.00	
25.00	0.000	140.380	25.00	0.00	0.00	0.00	40°32'16.854"N	104°45'09.212"W	0.00	
141.00	0.150	140.380	141.00	0.10	-0.12	0.10	40°32'16.853"N	104°45'09.211"W	0.13	
236.00	0.160	297.500	236.00	0.06	-0.15	0.06	40°32'16.853"N	104°45'09.212"W	0.32	
330.00	1.180	281.600	329.99	-1.01	0.10	-1.01	40°32'16.855"N	104°45'09.225"W	1.09	
425.00	1.950	277.910	424.96	-3.56	0.52	-3.57	40°32'16.859"N	104°45'09.259"W	0.82	
520.00	3.760	272.980	519.83	-8.27	0.91	-8.28	40°32'16.863"N	104°45'09.320"W	1.92	
614.00	5.670	264.550	613.51	-15.98	0.63	-15.98	40°32'16.860"N	104°45'09.419"W	2.16	
709.00	5.800	260.110	708.04	-25.38	-0.64	-25.38	40°32'16.848"N	104°45'09.541"W	0.49	
804.00	5.740	255.950	802.56	-34.73	-2.62	-34.72	40°32'16.828"N	104°45'09.662"W	0.44	
898.00	5.810	258.350	896.08	-43.96	-4.72	-43.94	40°32'16.807"N	104°45'09.781"W	0.27	
993.00	5.640	259.420	990.61	-53.26	-6.55	-53.23	40°32'16.789"N	104°45'09.902"W	0.21	
1088.00	5.360	258.980	1085.17	-62.21	-8.26	-62.18	40°32'16.772"N	104°45'10.018"W	0.30	
1182.00	5.680	252.960	1178.73	-70.98	-10.46	-70.94	40°32'16.751"N	104°45'10.131"W	0.70	
1277.00	5.410	253.440	1273.29	-79.78	-13.11	-79.72	40°32'16.724"N	104°45'10.245"W	0.29	
1372.00	5.120	248.960	1367.89	-88.04	-15.91	-87.97	40°32'16.697"N	104°45'10.352"W	0.53	
1467.00	5.360	254.510	1462.49	-96.28	-18.62	-96.20	40°32'16.670"N	104°45'10.458"W	0.59	
1509.00	5.460	255.310	1504.30	-100.11	-19.65	-100.03	40°32'16.660"N	104°45'10.508"W	0.30	
1593.00	4.920	259.980	1587.96	-107.53	-21.29	-107.44	40°32'16.644"N	104°45'10.604"W	0.82	FIRST BHGE SURVEY (302'FNL & 363'FWL,SEC.35)
1688.00	4.410	259.360	1682.65	-115.14	-22.67	-115.04	40°32'16.630"N	104°45'10.702"W	0.54	
1782.00	4.460	259.810	1776.36	-122.29	-23.99	-122.19	40°32'16.617"N	104°45'10.795"W	0.06	
1877.00	4.200	254.630	1871.09	-129.29	-25.56	-129.18	40°32'16.601"N	104°45'10.886"W	0.49	
1972.00	4.310	253.820	1965.83	-136.08	-27.48	-135.96	40°32'16.582"N	104°45'10.973"W	0.13	
2066.00	5.060	257.870	2059.52	-143.53	-29.33	-143.41	40°32'16.564"N	104°45'11.070"W	0.87	
2161.00	5.000	256.040	2154.15	-151.65	-31.21	-151.52	40°32'16.546"N	104°45'11.175"W	0.18	
2256.00	5.620	257.720	2248.74	-160.22	-33.20	-160.09	40°32'16.526"N	104°45'11.286"W	0.67	
2351.00	5.730	258.530	2343.28	-169.42	-35.13	-169.28	40°32'16.507"N	104°45'11.405"W	0.14	
2446.00	5.650	262.800	2437.81	-178.72	-36.66	-178.57	40°32'16.492"N	104°45'11.525"W	0.45	
2541.00	5.580	264.810	2532.35	-187.96	-37.67	-187.81	40°32'16.482"N	104°45'11.645"W	0.22	
2635.00	5.680	261.860	2625.90	-197.12	-38.74	-196.96	40°32'16.471"N	104°45'11.763"W	0.33	

Actual Wellpath Report

KTC FARMS BA-35-36HN AWP

Page 3 of 10

REFERENCE WELLPATH IDENTIFICATION

Operator	BAYSWATER E & P LLC	Slot	SLOT#03 KTC FARMS BA-35-36HN (282'FNL & 467'FWL,SEC.35)
Area	COLORADO	Well	KTC FARMS BA-35-36HN
Field	WELD COUNTY (NAD83/TRUE NORTH)	Wellbore	KTC FARMS BA-35-36HN AWP
Facility	SEC.35-T07N-R66W		

WELLPATH DATA (186 stations)

MD [ft]	Inclination [°]	Azimuth [°]	TVD [ft]	Vert Sect [ft]	North [ft]	East [ft]	Latitude	Longitude	DLS [°/100ft]	Comments
2730.00	5.660	258.450	2720.44	-206.37	-40.34	-206.21	40°32'16.455"N	104°45'11.883"W	0.36	
2825.00	5.610	256.400	2814.98	-215.48	-42.37	-215.31	40°32'16.435"N	104°45'12.001"W	0.22	
2919.00	5.730	250.720	2908.52	-224.39	-45.00	-224.20	40°32'16.409"N	104°45'12.116"W	0.61	
3014.00	5.510	242.260	3003.06	-232.92	-48.69	-232.72	40°32'16.373"N	104°45'12.227"W	0.90	
3108.00	5.750	237.070	3096.61	-240.88	-53.35	-240.66	40°32'16.327"N	104°45'12.329"W	0.60	
3202.00	5.960	247.360	3190.12	-249.36	-57.79	-249.12	40°32'16.283"N	104°45'12.439"W	1.14	
3296.00	5.990	253.580	3283.61	-258.58	-61.06	-258.33	40°32'16.251"N	104°45'12.558"W	0.69	
3391.00	5.860	260.730	3378.11	-268.13	-63.24	-267.87	40°32'16.229"N	104°45'12.682"W	0.79	
3486.00	5.740	261.910	3472.62	-277.63	-64.69	-277.36	40°32'16.215"N	104°45'12.805"W	0.18	
3581.00	5.930	260.200	3567.13	-287.17	-66.19	-286.90	40°32'16.200"N	104°45'12.928"W	0.27	
3675.00	5.850	254.790	3660.63	-296.59	-68.27	-296.31	40°32'16.179"N	104°45'13.050"W	0.60	
3770.00	5.800	248.340	3755.14	-305.73	-71.32	-305.44	40°32'16.149"N	104°45'13.168"W	0.69	
3864.00	5.900	243.620	3848.65	-314.49	-75.22	-314.18	40°32'16.111"N	104°45'13.282"W	0.52	
3958.00	5.940	248.950	3942.15	-323.38	-79.11	-323.05	40°32'16.072"N	104°45'13.396"W	0.59	
4053.00	5.840	247.580	4036.65	-332.45	-82.72	-332.11	40°32'16.037"N	104°45'13.514"W	0.18	
4147.00	5.660	245.880	4130.18	-341.11	-86.44	-340.76	40°32'16.000"N	104°45'13.626"W	0.26	
4242.00	5.740	244.690	4224.71	-349.70	-90.38	-349.33	40°32'15.961"N	104°45'13.737"W	0.15	
4336.00	5.650	243.380	4318.25	-358.10	-94.47	-357.71	40°32'15.921"N	104°45'13.845"W	0.17	
4431.00	5.560	247.710	4412.79	-366.56	-98.31	-366.15	40°32'15.883"N	104°45'13.955"W	0.46	
4526.00	5.770	257.250	4507.33	-375.49	-101.11	-375.07	40°32'15.855"N	104°45'14.070"W	1.01	
4620.00	5.760	260.890	4600.85	-384.76	-102.90	-384.33	40°32'15.837"N	104°45'14.190"W	0.39	
4715.00	5.700	264.220	4695.38	-394.17	-104.13	-393.74	40°32'15.825"N	104°45'14.312"W	0.36	
4810.00	5.940	259.980	4789.89	-403.71	-105.46	-403.27	40°32'15.812"N	104°45'14.435"W	0.52	
4904.00	5.920	254.790	4883.39	-413.18	-107.57	-412.74	40°32'15.791"N	104°45'14.558"W	0.57	
4999.00	5.950	255.510	4977.88	-422.69	-110.09	-422.23	40°32'15.766"N	104°45'14.681"W	0.08	
5094.00	5.750	258.300	5072.38	-432.12	-112.29	-431.66	40°32'15.744"N	104°45'14.803"W	0.37	
5188.00	5.920	259.730	5165.90	-441.51	-114.11	-441.04	40°32'15.726"N	104°45'14.925"W	0.24	
5283.00	5.910	256.790	5260.39	-451.10	-116.10	-450.62	40°32'15.707"N	104°45'15.049"W	0.32	
5377.00	5.910	254.640	5353.89	-460.49	-118.49	-460.00	40°32'15.683"N	104°45'15.170"W	0.24	
5472.00	5.910	253.600	5448.39	-469.91	-121.16	-469.41	40°32'15.657"N	104°45'15.292"W	0.11	

Actual Wellpath Report

KTC FARMS BA-35-36HN AWP

Page 4 of 10

REFERENCE WELLPATH IDENTIFICATION

Operator	BAYSWATER E & P LLC	Slot	SLOT#03 KTC FARMS BA-35-36HN (282'FNL & 467'FWL,SEC.35)
Area	COLORADO	Well	KTC FARMS BA-35-36HN
Field	WELD COUNTY (NAD83/TRUE NORTH)	Wellbore	KTC FARMS BA-35-36HN AWP
Facility	SEC.35-T07N-R66W		

WELLPATH DATA (186 stations)

MD [ft]	Inclination [°]	Azimuth [°]	TVD [ft]	Vert Sect [ft]	North [ft]	East [ft]	Latitude	Longitude	DLS [°/100ft]	Comments
5566.00	6.000	251.430	5541.88	-479.22	-124.09	-478.71	40°32'15.628"N	104°45'15.413"W	0.26	
5661.00	5.900	254.350	5636.37	-488.64	-126.99	-488.12	40°32'15.599"N	104°45'15.534"W	0.34	
5755.00	5.890	265.830	5729.87	-498.11	-128.65	-497.58	40°32'15.583"N	104°45'15.657"W	1.25	
5849.00	5.550	272.770	5823.41	-507.46	-128.78	-506.93	40°32'15.581"N	104°45'15.778"W	0.82	
5944.00	5.580	271.900	5917.96	-516.67	-128.40	-516.13	40°32'15.585"N	104°45'15.897"W	0.09	
6038.00	5.500	270.900	6011.52	-525.74	-128.18	-525.21	40°32'15.587"N	104°45'16.015"W	0.13	
6133.00	5.480	269.990	6106.09	-534.82	-128.11	-534.29	40°32'15.588"N	104°45'16.132"W	0.09	
6227.00	5.420	268.330	6199.66	-543.75	-128.24	-543.22	40°32'15.587"N	104°45'16.248"W	0.18	
6322.00	5.300	270.410	6294.25	-552.62	-128.34	-552.09	40°32'15.586"N	104°45'16.363"W	0.24	
6417.00	5.730	269.780	6388.81	-561.75	-128.33	-561.22	40°32'15.586"N	104°45'16.481"W	0.46	
6511.00	5.700	262.350	6482.34	-571.07	-128.96	-570.54	40°32'15.580"N	104°45'16.602"W	0.79	
6606.00	2.700	240.590	6577.08	-577.71	-130.69	-577.17	40°32'15.563"N	104°45'16.688"W	3.52	
6700.00	6.420	84.450	6670.92	-574.40	-131.27	-573.86	40°32'15.557"N	104°45'16.645"W	9.53	
6794.00	14.590	82.540	6763.27	-557.39	-129.22	-556.86	40°32'15.577"N	104°45'16.425"W	8.70	
6889.00	23.010	87.960	6853.13	-526.91	-127.00	-526.38	40°32'15.599"N	104°45'16.030"W	9.04	
6983.00	33.540	87.820	6935.79	-482.47	-125.36	-481.95	40°32'15.615"N	104°45'15.455"W	11.20	
7078.00	44.180	86.690	7009.66	-423.01	-122.44	-422.50	40°32'15.644"N	104°45'14.685"W	11.22	
7173.00	54.340	86.060	7071.58	-351.25	-117.86	-350.77	40°32'15.689"N	104°45'13.755"W	10.71	
7267.00	63.810	86.410	7119.84	-270.86	-112.59	-270.39	40°32'15.741"N	104°45'12.714"W	10.08	
7361.00	73.620	86.520	7153.92	-183.52	-107.20	-183.08	40°32'15.795"N	104°45'11.584"W	10.44	
7455.00	83.560	87.000	7172.49	-91.62	-102.00	-91.20	40°32'15.846"N	104°45'10.394"W	10.59	
7550.00	89.880	87.690	7177.92	3.09	-97.61	3.50	40°32'15.889"N	104°45'09.167"W	6.69	
7644.00	91.170	91.010	7177.06	97.07	-96.55	97.47	40°32'15.900"N	104°45'07.950"W	3.79	
7739.00	90.060	91.780	7176.04	192.02	-98.86	192.43	40°32'15.877"N	104°45'06.720"W	1.42	
7834.00	90.030	90.350	7175.97	286.99	-100.63	287.42	40°32'15.860"N	104°45'05.490"W	1.51	
7928.00	90.000	87.820	7175.94	380.98	-99.12	381.40	40°32'15.874"N	104°45'04.273"W	2.69	
8023.00	90.030	86.030	7175.92	475.86	-94.03	476.25	40°32'15.925"N	104°45'03.044"W	1.88	
8118.00	90.000	84.230	7175.89	570.55	-85.96	570.91	40°32'16.004"N	104°45'01.818"W	1.89	
8212.00	89.940	83.710	7175.94	664.07	-76.09	664.39	40°32'16.102"N	104°45'00.607"W	0.56	
8307.00	90.120	83.740	7175.89	758.54	-65.71	758.82	40°32'16.205"N	104°44'59.384"W	0.19	

Actual Wellpath Report

KTC FARMS BA-35-36HN AWP

Page 5 of 10

REFERENCE WELLPATH IDENTIFICATION

Operator	BAYSWATER E & P LLC	Slot	SLOT#03 KTC FARMS BA-35-36HN (282'FNL & 467'FWL,SEC.35)
Area	COLORADO	Well	KTC FARMS BA-35-36HN
Field	WELD COUNTY (NAD83/TRUE NORTH)	Wellbore	KTC FARMS BA-35-36HN AWP
Facility	SEC.35-T07N-R66W		

WELLPATH DATA (186 stations)

MD [ft]	Inclination [°]	Azimuth [°]	TVD [ft]	Vert Sect [ft]	North [ft]	East [ft]	Latitude	Longitude	DLS [°/100ft]	Comments
8400.00	90.120	84.780	7175.70	851.11	-56.40	851.35	40°32'16.297"N	104°44'58.186"W	1.12	
8495.00	90.000	86.500	7175.60	945.86	-49.18	946.07	40°32'16.368"N	104°44'56.959"W	1.81	
8589.00	90.030	87.440	7175.57	1039.75	-44.21	1039.94	40°32'16.417"N	104°44'55.743"W	1.00	
8684.00	90.030	89.200	7175.52	1134.71	-41.43	1134.90	40°32'16.444"N	104°44'54.513"W	1.85	
8779.00	90.090	90.190	7175.42	1229.71	-40.92	1229.89	40°32'16.449"N	104°44'53.283"W	1.04	
8874.00	90.060	91.540	7175.30	1324.69	-42.36	1324.88	40°32'16.435"N	104°44'52.053"W	1.42	
8969.00	90.030	91.370	7175.22	1419.65	-44.77	1419.85	40°32'16.411"N	104°44'50.823"W	0.18	
9063.00	90.120	91.390	7175.10	1513.61	-47.03	1513.82	40°32'16.389"N	104°44'49.606"W	0.10	
9157.00	89.970	91.360	7175.03	1607.57	-49.29	1607.79	40°32'16.366"N	104°44'48.389"W	0.16	
9252.00	90.060	91.150	7175.00	1702.54	-51.37	1702.77	40°32'16.346"N	104°44'47.158"W	0.24	
9347.00	90.340	91.040	7174.67	1797.52	-53.18	1797.75	40°32'16.328"N	104°44'45.928"W	0.32	
9441.00	91.910	89.720	7172.83	1891.49	-53.81	1891.73	40°32'16.322"N	104°44'44.711"W	2.18	
9536.00	92.030	88.670	7169.56	1986.43	-52.47	1986.66	40°32'16.335"N	104°44'43.482"W	1.11	
9631.00	91.820	87.510	7166.37	2081.33	-49.31	2081.55	40°32'16.366"N	104°44'42.252"W	1.24	
9725.00	91.820	88.550	7163.38	2175.24	-46.08	2175.45	40°32'16.398"N	104°44'41.036"W	1.11	
9820.00	91.780	89.530	7160.40	2270.18	-44.49	2270.39	40°32'16.413"N	104°44'39.807"W	1.03	
9914.00	92.740	91.750	7156.69	2364.09	-45.54	2364.30	40°32'16.403"N	104°44'38.590"W	2.57	
10009.00	91.850	92.930	7152.89	2458.92	-49.41	2459.14	40°32'16.365"N	104°44'37.362"W	1.55	
10103.00	91.880	91.470	7149.83	2552.78	-53.02	2553.02	40°32'16.329"N	104°44'36.146"W	1.55	
10198.00	91.850	91.550	7146.74	2647.68	-55.52	2647.94	40°32'16.304"N	104°44'34.917"W	0.09	
10292.00	92.030	91.320	7143.55	2741.59	-57.88	2741.86	40°32'16.281"N	104°44'33.700"W	0.31	
10386.00	91.970	90.450	7140.27	2835.51	-59.33	2835.79	40°32'16.266"N	104°44'32.484"W	0.93	
10481.00	92.030	89.310	7136.96	2930.45	-59.13	2930.73	40°32'16.268"N	104°44'31.254"W	1.20	
10575.00	91.970	89.450	7133.68	3024.40	-58.11	3024.66	40°32'16.278"N	104°44'30.037"W	0.16	
10670.00	91.970	89.080	7130.41	3119.34	-56.89	3119.60	40°32'16.290"N	104°44'28.808"W	0.39	
10765.00	92.000	88.810	7127.12	3214.27	-55.14	3214.53	40°32'16.307"N	104°44'27.578"W	0.29	
10860.00	92.000	88.970	7123.81	3309.20	-53.31	3309.45	40°32'16.325"N	104°44'26.349"W	0.17	
10953.00	92.030	88.980	7120.54	3402.13	-51.64	3402.38	40°32'16.341"N	104°44'25.145"W	0.03	
11048.00	92.030	88.720	7117.17	3497.06	-49.74	3497.30	40°32'16.360"N	104°44'23.916"W	0.27	
11142.00	92.150	88.400	7113.74	3590.98	-47.38	3591.21	40°32'16.383"N	104°44'22.700"W	0.36	

Actual Wellpath Report

KTC FARMS BA-35-36HN AWP

Page 6 of 10

REFERENCE WELLPATH IDENTIFICATION

Operator	BAYSWATER E & P LLC	Slot	SLOT#03 KTC FARMS BA-35-36HN (282'FNL & 467'FWL,SEC.35)
Area	COLORADO	Well	KTC FARMS BA-35-36HN
Field	WELD COUNTY (NAD83/TRUE NORTH)	Wellbore	KTC FARMS BA-35-36HN AWP
Facility	SEC.35-T07N-R66W		

WELLPATH DATA (186 stations)

MD [ft]	Inclination [°]	Azimuth [°]	TVD [ft]	Vert Sect [ft]	North [ft]	East [ft]	Latitude	Longitude	DLS [°/100ft]	Comments
11237.00	92.190	88.440	7110.15	3685.88	-44.76	3686.10	40°32'16.409"N	104°44'21.471"W	0.06	
11332.00	92.120	88.620	7106.57	3780.80	-42.32	3781.00	40°32'16.433"N	104°44'20.241"W	0.20	
11426.00	92.120	88.370	7103.10	3874.71	-39.86	3874.91	40°32'16.457"N	104°44'19.025"W	0.27	
11521.00	92.180	87.830	7099.53	3969.60	-36.71	3969.79	40°32'16.488"N	104°44'17.796"W	0.57	
11615.00	90.000	88.610	7097.74	4063.54	-33.79	4063.72	40°32'16.517"N	104°44'16.580"W	2.46	
11710.00	90.090	88.670	7097.67	4158.52	-31.54	4158.69	40°32'16.539"N	104°44'15.350"W	0.11	
11805.00	90.180	88.400	7097.44	4253.50	-29.11	4253.66	40°32'16.563"N	104°44'14.120"W	0.30	
11900.00	90.220	90.120	7097.11	4348.50	-27.88	4348.65	40°32'16.575"N	104°44'12.889"W	1.81	
11994.00	90.220	91.330	7096.75	4442.48	-29.07	4442.64	40°32'16.563"N	104°44'11.672"W	1.29	
12089.00	90.340	90.200	7096.29	4537.46	-30.34	4537.63	40°32'16.550"N	104°44'10.442"W	1.20	
12183.00	90.180	90.690	7095.86	4631.45	-31.07	4631.62	40°32'16.543"N	104°44'09.224"W	0.55	
12278.00	90.220	90.940	7095.53	4726.44	-32.42	4726.61	40°32'16.529"N	104°44'07.994"W	0.27	
12373.00	90.180	91.500	7095.20	4821.41	-34.44	4821.59	40°32'16.509"N	104°44'06.764"W	0.59	
12468.00	90.280	90.850	7094.82	4916.38	-36.39	4916.57	40°32'16.490"N	104°44'05.534"W	0.69	
12562.00	90.280	90.530	7094.36	5010.36	-37.52	5010.56	40°32'16.478"N	104°44'04.316"W	0.34	
12656.00	90.180	89.850	7093.98	5104.36	-37.83	5104.56	40°32'16.475"N	104°44'03.099"W	0.73	
12750.00	90.180	89.950	7093.68	5198.36	-37.67	5198.56	40°32'16.476"N	104°44'01.882"W	0.11	
12844.00	90.250	89.610	7093.33	5292.36	-37.31	5292.56	40°32'16.480"N	104°44'00.664"W	0.37	
12939.00	90.310	90.030	7092.87	5387.35	-37.01	5387.56	40°32'16.482"N	104°43'59.434"W	0.45	
13033.00	90.090	89.370	7092.54	5481.35	-36.52	5481.55	40°32'16.487"N	104°43'58.216"W	0.74	
13128.00	90.370	88.210	7092.16	5576.34	-34.51	5576.53	40°32'16.507"N	104°43'56.986"W	1.26	
13223.00	90.280	87.350	7091.62	5671.28	-30.83	5671.46	40°32'16.543"N	104°43'55.757"W	0.91	
13318.00	90.090	89.180	7091.31	5766.24	-27.96	5766.41	40°32'16.571"N	104°43'54.527"W	1.94	
13412.00	90.280	85.640	7091.01	5860.15	-23.71	5860.30	40°32'16.613"N	104°43'53.311"W	3.77	
13507.00	90.340	83.330	7090.50	5954.74	-14.58	5954.85	40°32'16.703"N	104°43'52.086"W	2.43	
13601.00	90.220	80.230	7090.04	6047.81	-1.14	6047.87	40°32'16.835"N	104°43'50.881"W	3.30	
13696.00	90.220	80.870	7089.67	6141.59	14.46	6141.58	40°32'16.989"N	104°43'49.667"W	0.67	
13791.00	90.310	84.570	7089.23	6235.85	26.49	6235.80	40°32'17.108"N	104°43'48.447"W	3.90	
13885.00	90.250	84.090	7088.77	6329.43	35.78	6329.34	40°32'17.200"N	104°43'47.236"W	0.51	
13980.00	90.250	87.020	7088.36	6424.16	43.14	6424.04	40°32'17.272"N	104°43'46.009"W	3.08	

Actual Wellpath Report

KTC FARMS BA-35-36HN AWP

Page 7 of 10

REFERENCE WELLPATH IDENTIFICATION

Operator	BAYSWATER E & P LLC	Slot	SLOT#03 KTC FARMS BA-35-36HN (282'FNL & 467'FWL,SEC.35)
Area	COLORADO	Well	KTC FARMS BA-35-36HN
Field	WELD COUNTY (NAD83/TRUE NORTH)	Wellbore	KTC FARMS BA-35-36HN AWP
Facility	SEC.35-T07N-R66W		

WELLPATH DATA (186 stations)

MD [ft]	Inclination [°]	Azimuth [°]	TVD [ft]	Vert Sect [ft]	North [ft]	East [ft]	Latitude	Longitude	DLS [°/100ft]	Comments
14075.00	90.250	90.460	7087.94	6519.13	45.23	6519.00	40°32'17.292"N	104°43'44.779"W	3.62	
14169.00	90.250	91.900	7087.53	6613.10	43.29	6612.98	40°32'17.273"N	104°43'43.562"W	1.53	
14263.00	90.180	91.890	7087.18	6707.03	40.19	6706.93	40°32'17.242"N	104°43'42.345"W	0.08	
14358.00	90.280	90.210	7086.80	6802.01	38.44	6801.91	40°32'17.225"N	104°43'41.115"W	1.77	
14452.00	90.060	88.200	7086.52	6896.00	39.75	6895.89	40°32'17.237"N	104°43'39.898"W	2.15	
14547.00	89.970	86.610	7086.49	6990.91	44.05	6990.79	40°32'17.279"N	104°43'38.669"W	1.68	
14641.00	90.000	90.310	7086.52	7084.87	46.58	7084.74	40°32'17.304"N	104°43'37.452"W	3.94	
14736.00	89.970	88.740	7086.54	7179.87	47.36	7179.73	40°32'17.312"N	104°43'36.221"W	1.65	
14831.00	90.030	91.260	7086.54	7274.86	47.36	7274.73	40°32'17.311"N	104°43'34.991"W	2.65	
14925.00	90.060	93.640	7086.47	7368.75	43.35	7368.63	40°32'17.271"N	104°43'33.775"W	2.53	
15020.00	89.970	94.810	7086.45	7463.46	36.35	7463.37	40°32'17.202"N	104°43'32.548"W	1.24	
15115.00	89.940	95.210	7086.52	7558.06	28.05	7558.01	40°32'17.120"N	104°43'31.322"W	0.42	
15209.00	89.940	94.810	7086.62	7651.67	19.84	7651.65	40°32'17.038"N	104°43'30.109"W	0.43	
15303.00	90.060	94.590	7086.62	7745.32	12.14	7745.33	40°32'16.962"N	104°43'28.896"W	0.27	
15398.00	89.970	93.510	7086.59	7840.05	5.43	7840.10	40°32'16.895"N	104°43'27.669"W	1.14	
15492.00	89.970	92.870	7086.64	7933.88	0.20	7933.95	40°32'16.843"N	104°43'26.453"W	0.68	
15586.00	90.030	91.910	7086.64	8027.78	-3.72	8027.87	40°32'16.804"N	104°43'25.237"W	1.02	
15681.00	90.000	91.190	7086.62	8122.74	-6.29	8122.83	40°32'16.779"N	104°43'24.007"W	0.76	
15775.00	89.970	89.720	7086.64	8216.73	-7.04	8216.83	40°32'16.771"N	104°43'22.789"W	1.56	
15869.00	89.970	89.390	7086.69	8310.72	-6.31	8310.82	40°32'16.778"N	104°43'21.572"W	0.35	
15964.00	89.940	88.230	7086.77	8405.71	-4.33	8405.80	40°32'16.797"N	104°43'20.342"W	1.22	
16059.00	90.000	85.630	7086.82	8500.59	0.75	8500.66	40°32'16.847"N	104°43'19.113"W	2.74	
16153.00	90.120	86.330	7086.72	8594.38	7.34	8594.42	40°32'16.912"N	104°43'17.899"W	0.76	
16247.00	90.180	89.020	7086.47	8688.31	11.16	8688.34	40°32'16.949"N	104°43'16.682"W	2.86	
16342.00	90.180	90.250	7086.17	8783.31	11.76	8783.33	40°32'16.955"N	104°43'15.452"W	1.29	
16437.00	90.090	91.770	7085.95	8878.28	10.09	8878.32	40°32'16.938"N	104°43'14.222"W	1.60	
16532.00	90.150	91.710	7085.75	8973.22	7.20	8973.27	40°32'16.909"N	104°43'12.992"W	0.09	
16627.00	90.120	88.150	7085.53	9068.21	7.32	9068.26	40°32'16.910"N	104°43'11.762"W	3.75	
16722.00	90.090	88.030	7085.35	9163.17	10.48	9163.20	40°32'16.941"N	104°43'10.532"W	0.13	
16816.00	90.030	88.750	7085.25	9257.14	13.13	9257.17	40°32'16.967"N	104°43'09.315"W	0.77	

Actual Wellpath Report

KTC FARMS BA-35-36HN AWP

Page 8 of 10

REFERENCE WELLPATH IDENTIFICATION

Operator	BAYSWATER E & P LLC	Slot	SLOT#03 KTC FARMS BA-35-36HN (282'FNL & 467'FWL,SEC.35)
Area	COLORADO	Well	KTC FARMS BA-35-36HN
Field	WELD COUNTY (NAD83/TRUE NORTH)	Wellbore	KTC FARMS BA-35-36HN AWP
Facility	SEC.35-T07N-R66W		

WELLPATH DATA (186 stations)

MD [ft]	Inclination [°]	Azimuth [°]	TVD [ft]	Vert Sect [ft]	North [ft]	East [ft]	Latitude	Longitude	DLS [°/100ft]	Comments
16910.00	89.880	89.610	7085.33	9351.13	14.47	9351.16	40°32'16.979"N	104°43'08.098"W	0.93	
17005.00	89.820	89.110	7085.58	9446.13	15.53	9446.15	40°32'16.990"N	104°43'06.867"W	0.53	
17100.00	89.880	88.640	7085.83	9541.12	17.40	9541.13	40°32'17.008"N	104°43'05.637"W	0.50	
17194.00	89.880	87.900	7086.02	9635.09	20.23	9635.09	40°32'17.035"N	104°43'04.420"W	0.79	
17268.00	89.880	87.490	7086.18	9709.04	23.21	9709.03	40°32'17.064"N	104°43'03.462"W	0.55	LAST BHGE SURVEY (397'FNL & 494'FEL,SEC.36)
17293.00	89.880	87.490	7086.23	9734.02	24.31	9734.00	40°32'17.075"N	104°43'03.139"W	0.00	PROJ TO BIT (396'FNL & 469'FEL,SEC.36)

TARGETS

Name	TVD [ft]	North [ft]	East [ft]	Grid East [US ft]	Grid North [US ft]	Latitude	Longitude	Shape
KTC FARMS BA-35-36HN BHL PLAT (380'FNL & 470'FEL,SEC.36)	7086.00	40.54	9734.16	3217476.95	1439837.76	40°32'17.236"N	104°43'03.137"W	point
KTC FARMS BA-35-36HN WP2 (2210'SS @ 4000'FLP)	7096.00	-41.12	3993.74	3211737.61	1439707.72	40°32'16.445"N	104°44'17.486"W	point
KTC FARMS BA-35-36HN LP PLAT (380'FNL & 470'FWL,SEC.35)	7136.00	-98.00	-5.28	3207739.34	1439617.14	40°32'15.886"N	104°45'09.281"W	point
KTC FARMS BA-35-36HN WP1 (2290'SS @ 1800'FLP)	7176.00	-72.40	1794.54	3209538.82	1439657.91	40°32'16.138"N	104°44'45.970"W	point
KTC FARMS BA-35-36HN LP REV-1 (380'FNL & 470'FWL,SEC.35)	7176.00	-97.96	-5.30	3207739.32	1439617.18	40°32'15.886"N	104°45'09.281"W	point
SEC.35-T07N-R66W	12000.00	29.87	-0.28	3207743.27	1439745.05	40°32'17.149"N	104°45'09.216"W	polygon
SEC.36-T07N-R66W	12000.00	29.87	-0.28	3207743.27	1439745.05	40°32'17.149"N	104°45'09.216"W	polygon

Actual Wellpath Report

KTC FARMS BA-35-36HN AWP

Page 9 of 10

REFERENCE WELLPATH IDENTIFICATION

Operator	BAYSWATER E & P LLC	Slot	SLOT#03 KTC FARMS BA-35-36HN (282'FNL & 467'FWL,SEC.35)
Area	COLORADO	Well	KTC FARMS BA-35-36HN
Field	WELD COUNTY (NAD83/TRUE NORTH)	Wellbore	KTC FARMS BA-35-36HN AWB
Facility	SEC.35-T07N-R66W		

WELLPATH COMPOSITION - Ref Wellbore: KTC FARMS BA-35-36HN AWB Ref Wellpath: KTC FARMS BA-35-36HN AWP

Start MD [ft]	End MD [ft]	Positional Uncertainty Model	Log Name/Comment	Wellbore
25.00	1509.00	BHI NaviTrak (Standard)	BHI NAVITRAK (STANDARD) <141-1509>	KTC FARMS BA-35-36HN AWB
1509.00	17268.00	BHI AutoTrak Curve (Short)	BHI AUTOTRAK CURVE (SHORT) <1593-17268>	KTC FARMS BA-35-36HN AWB
17268.00	17293.00	Blind Drilling (std)	Projection to bit	KTC FARMS BA-35-36HN AWB

Actual Wellpath Report

KTC FARMS BA-35-36HN AWP

Page 10 of 10

REFERENCE WELLPATH IDENTIFICATION			
Operator	BAYSWATER E & P LLC	Slot	SLOT#03 KTC FARMS BA-35-36HN (282'FNL & 467'FWL,SEC.35)
Area	COLORADO	Well	KTC FARMS BA-35-36HN
Field	WELD COUNTY (NAD83/TRUE NORTH)	Wellbore	KTC FARMS BA-35-36HN AWB
Facility	SEC.35-T07N-R66W		

WELLPATH COMMENTS				
MD [ft]	Inclination [°]	Azimuth [°]	TVD [ft]	Comment
1593.00	4.920	259.980	1587.96	FIRST BHGE SURVEY (302'FNL & 363'FWL,SEC.35)
17268.00	89.880	87.490	7086.18	LAST BHGE SURVEY (397'FNL & 494'FEL,SEC.36)
17293.00	89.880	87.490	7086.23	PROJ TO BIT (396'FNL & 469'FEL,SEC.36)