

D23-14 PAD & D23-15 PAD
LOCATION DRAWING

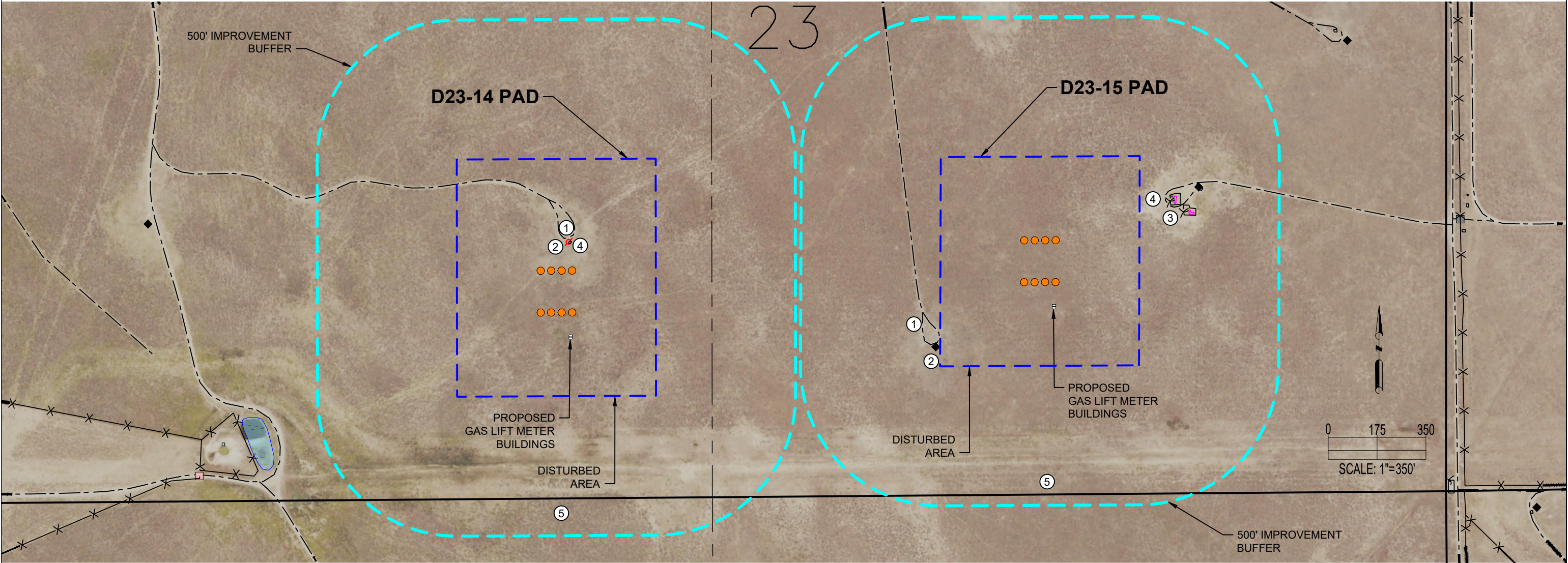

D23-14 PAD

D23-15 PAD

IMPROVEMENTS: (AS MEASURED FROM THE PROPOSED EDGE OF DISTURBANCE)	
1. PRIVATE ROAD:	0'
2. OIL/GAS WELL:	0'
3. EXISTING PRODUCTION EQUIPMENT:	N/A
4. FENCE:	0'
5. PROPERTY LINE	±366' S, ±442' SE

IMPROVEMENTS: (AS MEASURED FROM THE PROPOSED EDGE OF DISTURBANCE)	
1. PRIVATE ROAD:	±3' W, ±93' E
2. OIL/GAS WELL:	±16' W, ±212' E
3. EXISTING PRODUCTION EQUIPMENT:	±121' E, ±178' E
4. FENCE:	±8' W, ±109' E, ±158' E, ±213' E
5. PROPERTY LINE	±460' S

DISCLAIMER:
THIS PLOT DOES NOT REPRESENT A MONUMENTED LAND SURVEY AND SHOULD NOT BE RELIED UPON TO DETERMINE BOUNDARY LINES, PROPERTY OWNERSHIP OR OTHER PROPERTY INTERESTS. PARCEL LINES, IF DEPICTED HAVE NOT BEEN FIELD VERIFIED AND MAY BE BASED UPON PUBLICLY AVAILABLE DATA THAT ALSO HAS NOT BEEN INDEPENDENTLY VERIFIED.

CURRENT SURFACE USE: RANGELAND
FUTURE SURFACE USE: RANGELAND



7535 Hilltop Circle
Denver, CO 80221
(303) 928-7128
www.ascentgeomatics.com

FIELD DATE: 08-02-18	DRAWING DATE: 10-19-18
DRAWN BY: MJE	CHECKED BY: CLP

SITE NAME: D23-14 PAD, D23-15 PAD	DATA SOURCE: AERIAL IMAGERY: NAIP 2017, ASCENT 11/2017 WATER WELLS: COLORADO DWR NHD: USGS
SURFACE LOCATION: SEC. 23, T3N, R64W, 6TH P.M. WELD COUNTY, COLORADO	PUBLICLY AVAILABLE DATA SOURCES HAVE NOT BEEN INDEPENDENTLY VERIFIED BY ASCENT.

LEGEND:

● = PROPOSED WELL	— = SECTION LINE	□ = DISTURBANCE AREA	□ = POND
◆ = EXISTING WELL	- - - = CENTER SECTION LINE	○ = 500' RADIUS	
⛶ = ABANDONED WELL	✕ ✕ = FENCE	□ = EXISTING FACILITY	
	- - - = EXISTING ROAD	□ = GATE	

