



Planned Section Details									
Sec	MD	Inc	Azi	TVD	+N/-S	+E/-W	Dleg	TFace	VSect
1	1554.00	17.13	97.22	1538.26	-42.64	142.90	0.00	0.00	-20.50
2	1654.00	17.13	97.22	1633.82	-46.34	172.12	0.00	0.00	-19.73
3	1732.98	18.30	100.72	1709.06	-50.11	195.84	2.00	44.11	-19.86
4	5565.59	18.30	100.72	5347.91	-274.00	1378.00	0.00	0.00	-62.05
5	6480.40	0.00	0.00	6247.26	-300.95	1520.30	2.00	-180.00	-67.13
6	6982.23	0.00	0.00	6749.09	-300.95	1520.30	0.00	0.00	-67.13
7	7889.87	90.76	0.03	7322.00	279.65	1520.64	10.00	0.03	506.82
8	17568.76	90.76	0.03	7193.00	9957.67	1526.35	0.00	0.00	10073.97

WELL DETAILS: Rinn Valley East N17-20-14N

Ground Elevation:: 4938.80
RKB Elevation: KB=25 @ 4963.80ft (Patterson #346)
Rig Name: Patterson #346

Northing	Easting	Latitude	Longitude
1291282.89	3128991.31	40.13204	-105.03867

Extraction Oil & Gas
Project: Weld County, CO (NAD83)
Site: Rinn Valley East Pad (Sec.18-T2N-R68W)
Well: Rinn Valley East N17-20-14N
Wellbore: Wellbore #1
Plan: Plan #3 (Rinn Valley East N17-20-14N/Wellbore #1)
Patterson #346

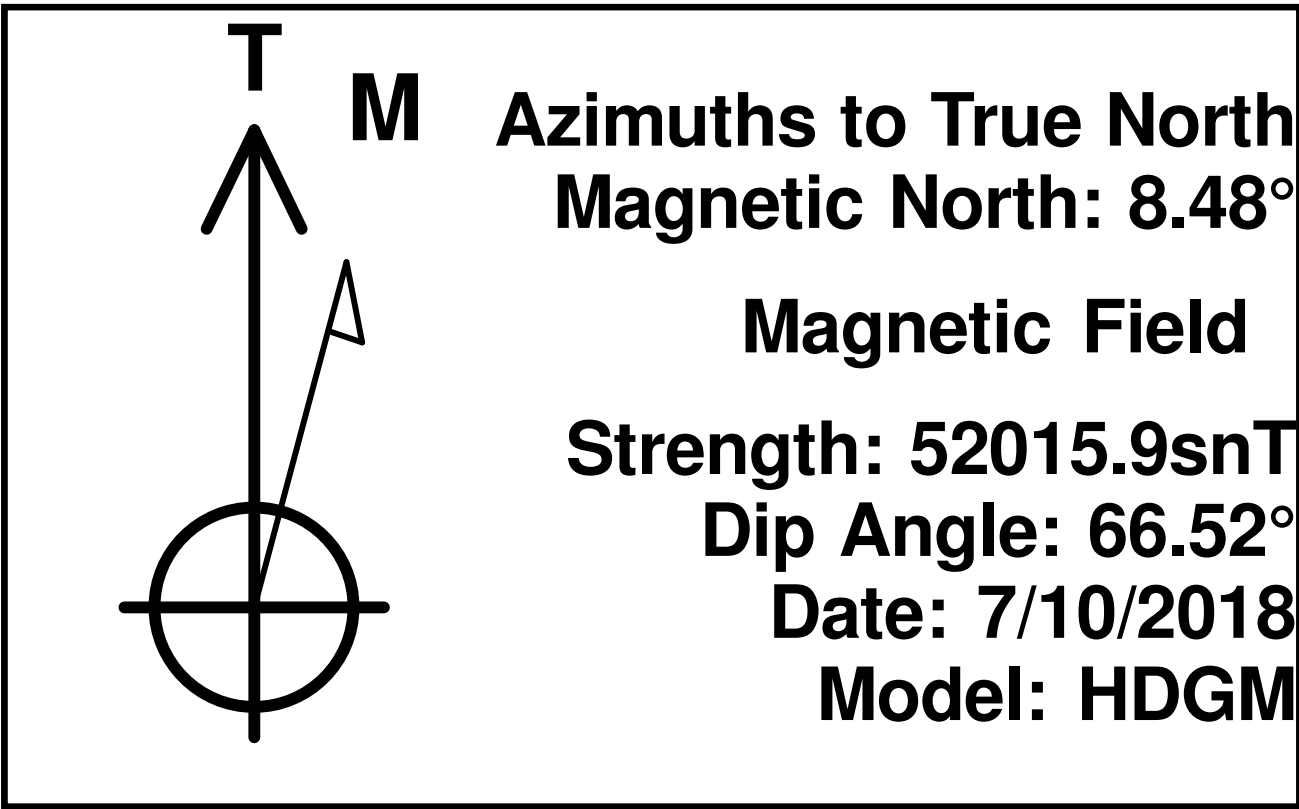
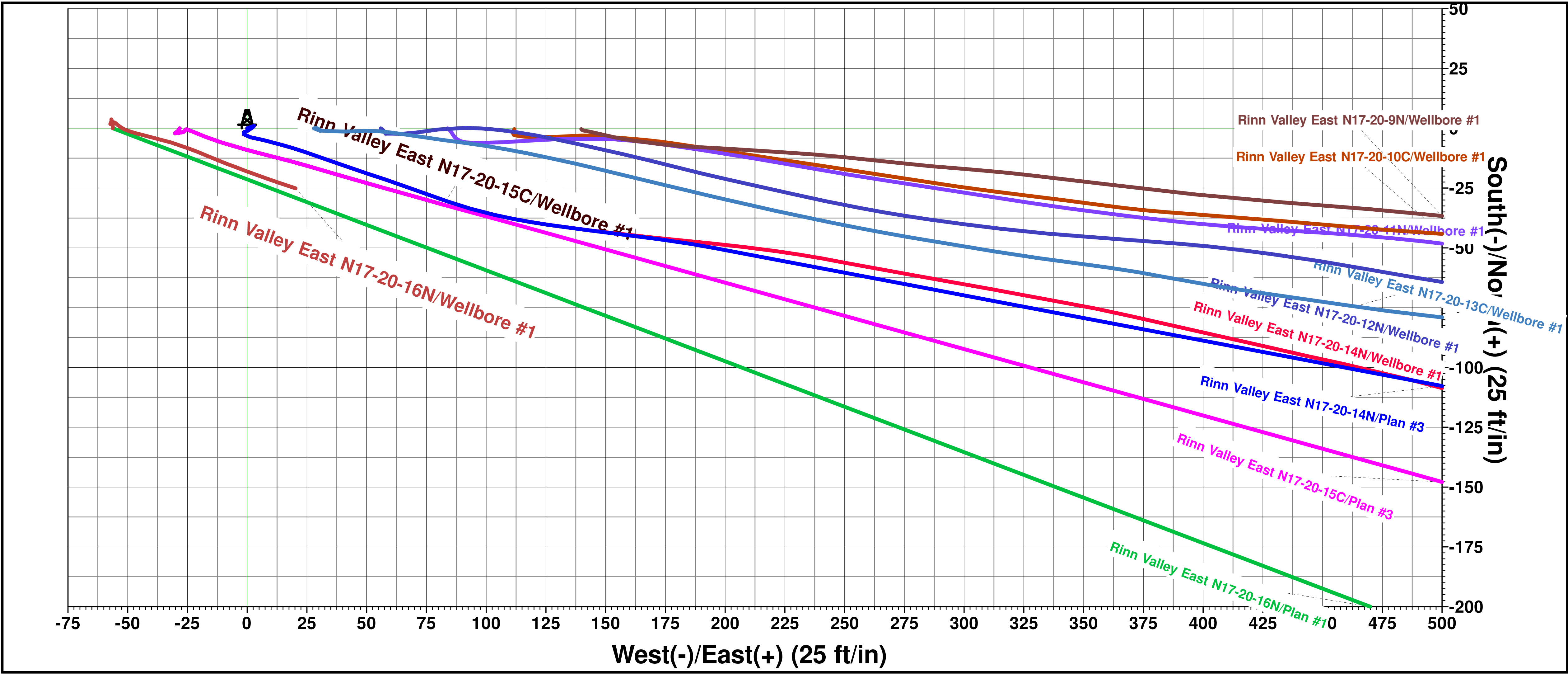

PROJECT DETAILS: Weld County, CO (NAD83)
Geodetic System: US State Plane 1983
Datum: North American Datum 1983
Ellipsoid: GRS 1980
Zone: Colorado Northern Zone
System Datum: Ground Level
Local North: True

