

BAYSWATER E & P LLC

Location: COLORADO Slot: SLOT#12 G & D HANKS U-27-28HN (1183°FSL & 1575°FEL, SEC.27)
Field: WELD COUNTY (NAD83/TRUE NORTH) Well: G & D HANKS U-27-28HN
Facility: SEC.27-T07N-R66W Wellbore: G & D HANKS U-27-28HN PWB

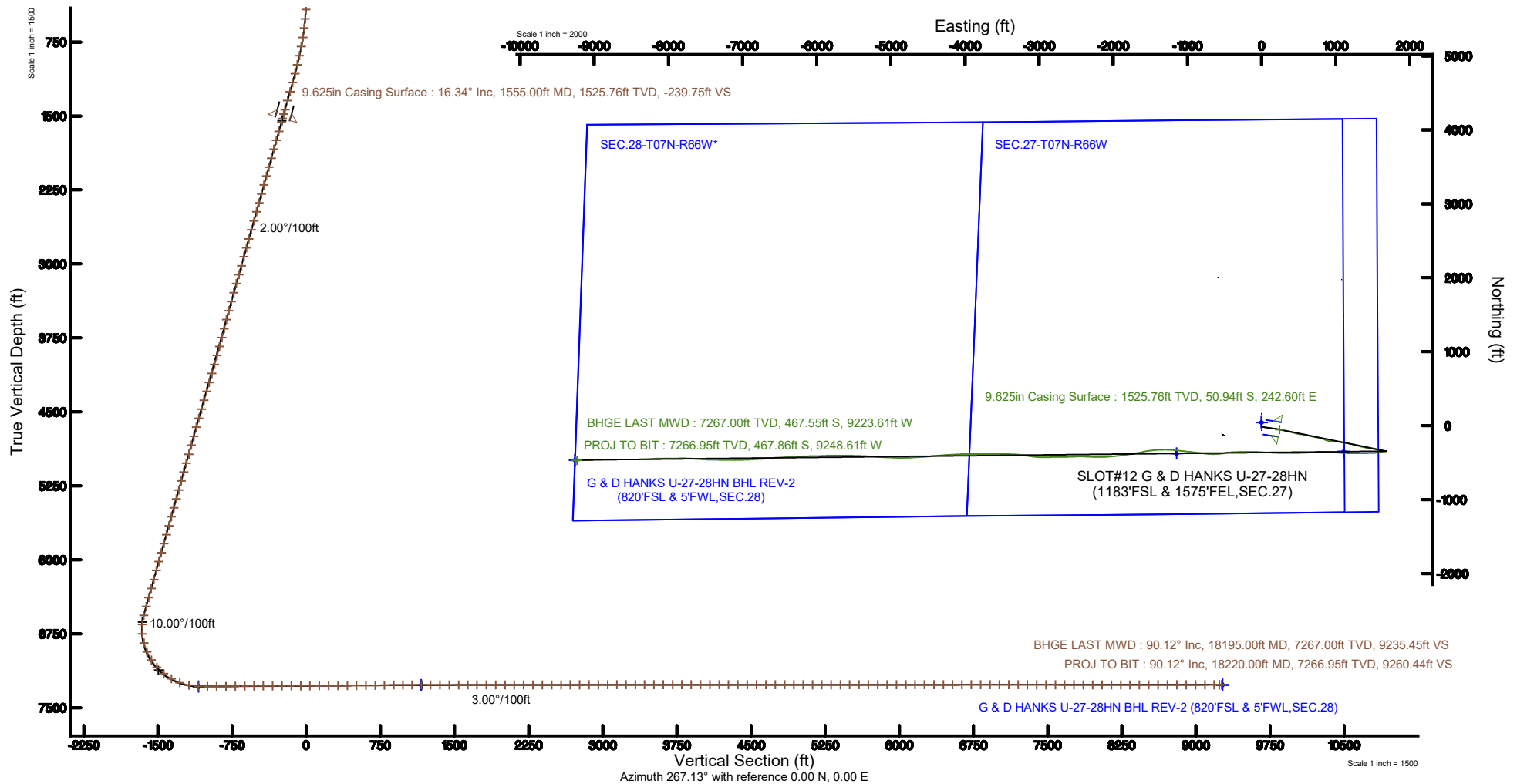

Plot reference wellpath is G & D HANKS U-27-28HN PWP (REV-D.0)	Grid System: NAD83 / Lambert Colorado SP, Northern Zone (501), US feet
True vertical depths are referenced to TRUE 38 (4876'GL + 25'KB @ 4901'RKB) (RKB)	North Reference: True north
Measured depths are referenced to TRUE 38 (4876'GL + 25'KB @ 4901'RKB) (RKB)	Scale: True distance
TRUE 38 (4876'GL + 25'KB @ 4901'RKB) to Mean Sea Level: 4901 feet	Depths are in feet
Mean Sea Level to Ground level (At Slot: SLOT#12 G & D HANKS U-27-28HN (1183°FSL & 1575°FEL, SEC.27)): 0 feet	Created by: amuntime on 2018-06-20
Coordinates are in feet referenced to Slot	Database: WA DENVER



Actual Wellpath Report

G & D HANKS U-27-28HN AWP

Page n of nn



REFERENCE WELLPATH IDENTIFICATION			
Operator	BAYSWATER E & P LLC	Slot	SLOT#12 G & D HANKS U-27-28HN (1183'FSL & 1575'FEL,SEC.27)
Area	COLORADO	Well	G & D HANKS U-27-28HN
Field	WELD COUNTY (NAD83/TRUE NORTH)	Wellbore	G & D HANKS U-27-28HN AWB
Facility	SEC.27-T07N-R66W		

REPORT SETUP INFORMATION			
Projection System	NAD83 / Lambert Colorado SP, Northern Zone (501), US feet	Software System	WellArchitect® 5.1
North Reference	True	User	Amuntime
Scale	0.999970	Report Generated	6/20/2018 at 11:14:33 AM
Convergence at slot	0.48° East	Database/Source file	WA DENVER/G__D_HANKS_U-27-28HN_AWP.xml

WELLPATH LOCATION						
	Local coordinates		Grid coordinates		Geographic coordinates	
	North[ft]	East[ft]	Easting[US ft]	Northing[US ft]	Latitude	Longitude
Slot Location	-165.04	-0.28	3205704.26	1441137.50	40°32'31.078"N	104°45'35.474"W
Facility Reference Pt			3205703.16	1441302.53	40°32'32.708"N	104°45'35.471"W
Field Reference Pt			3174587.00	1430859.71	40°30'51.890"N	104°52'19.470"W

WELLPATH DATUM			
Calculation method	Minimum curvature	TRUE 38 (4876'GL + 25'KB @ 4901'RKB) (RKB) to Facility Vertical Datum	4901.00ft
Horizontal Reference Pt	Slot	TRUE 38 (4876'GL + 25'KB @ 4901'RKB) (RKB) to Mean Sea Level	4901.00ft
Vertical Reference Pt	TRUE 38 (4876'GL + 25'KB @ 4901'RKB) (RKB)	TRUE 38 (4876'GL + 25'KB @ 4901'RKB) (RKB) to Ground Level at Slot (SLOT#12 G & D HANKS U-27-28HN (1183'FSL & 1575'FEL,SEC.27))	4901.00ft
MD Reference Pt	TRUE 38 (4876'GL + 25'KB @ 4901'RKB) (RKB)	Section Origin	N 0.00, E 0.00 ft
Field Vertical Reference	Mean Sea Level	Section Azimuth	267.10°

Actual Wellpath Report

G & D HANKS U-27-28HN AWP

Page n of nn



REFERENCE WELLPATH IDENTIFICATION

Operator	BAYSWATER E & P LLC	Slot	SLOT#12 G & D HANKS U-27-28HN (1183'FSL & 1575'FEL,SEC.27)
Area	COLORADO	Well	G & D HANKS U-27-28HN
Field	WELD COUNTY (NAD83/TRUE NORTH)	Wellbore	G & D HANKS U-27-28HN AWB
Facility	SEC.27-T07N-R66W		

WELLPATH DATA (196 stations) † = interpolated/extrapolated station

MD [ft]	Inclination [°]	Azimuth [°]	TVD [ft]	Vert Sect [ft]	North [ft]	East [ft]	Latitude	Longitude	DLS [°/100ft]	Comments
0.00†	0.000	182.170	0.00	0.00	0.00	0.00	40°32'31.078"N	104°45'35.474"W	0.00	
25.00	0.000	182.170	25.00	0.00	0.00	0.00	40°32'31.078"N	104°45'35.474"W	0.00	
137.00	1.380	182.170	136.99	0.12	-1.35	-0.05	40°32'31.064"N	104°45'35.475"W	1.23	
232.00	1.620	181.120	231.96	0.31	-3.83	-0.12	40°32'31.040"N	104°45'35.476"W	0.25	
327.00	2.030	139.980	326.91	-0.61	-6.46	0.94	40°32'31.014"N	104°45'35.462"W	1.41	
421.00	3.290	117.980	420.81	-3.93	-9.01	4.39	40°32'30.989"N	104°45'35.418"W	1.70	
516.00	5.090	109.550	515.55	-10.16	-11.69	10.77	40°32'30.962"N	104°45'35.335"W	2.00	
610.00	7.400	106.910	608.99	-19.71	-14.85	20.49	40°32'30.931"N	104°45'35.209"W	2.48	
705.00	9.600	104.400	702.94	-33.03	-18.60	34.02	40°32'30.894"N	104°45'35.034"W	2.35	
799.00	11.020	99.880	795.42	-49.28	-22.09	50.46	40°32'30.859"N	104°45'34.821"W	1.74	
894.00	12.600	96.780	888.41	-68.35	-24.87	69.70	40°32'30.832"N	104°45'34.572"W	1.79	
988.00	13.950	98.980	979.90	-89.55	-27.85	91.07	40°32'30.802"N	104°45'34.295"W	1.53	
1083.00	15.410	98.210	1071.79	-113.14	-31.44	114.88	40°32'30.767"N	104°45'33.986"W	1.55	
1177.00	16.240	97.950	1162.23	-138.31	-35.04	140.25	40°32'30.731"N	104°45'33.658"W	0.89	
1272.00	15.760	97.970	1253.55	-164.02	-38.67	166.19	40°32'30.695"N	104°45'33.322"W	0.51	
1366.00	15.590	98.340	1344.05	-188.95	-42.27	191.33	40°32'30.660"N	104°45'32.996"W	0.21	
1461.00	15.930	100.210	1435.48	-214.17	-46.44	216.79	40°32'30.619"N	104°45'32.666"W	0.64	
1508.00	16.240	99.310	1480.64	-226.87	-48.64	229.62	40°32'30.597"N	104°45'32.500"W	0.85	
1595.00	16.430	101.940	1564.13	-250.66	-53.16	253.67	40°32'30.552"N	104°45'32.189"W	0.88	
1690.00	16.570	102.930	1655.22	-276.68	-58.97	280.01	40°32'30.495"N	104°45'31.848"W	0.33	
1784.00	16.160	102.870	1745.41	-302.16	-64.88	305.83	40°32'30.436"N	104°45'31.513"W	0.44	
1879.00	16.050	103.390	1836.68	-327.49	-70.86	331.49	40°32'30.377"N	104°45'31.181"W	0.19	
1974.00	16.120	103.770	1927.96	-352.73	-77.05	357.08	40°32'30.316"N	104°45'30.849"W	0.13	
2069.00	16.060	102.700	2019.24	-378.02	-83.07	382.71	40°32'30.257"N	104°45'30.517"W	0.32	
2163.00	15.980	103.990	2109.59	-402.93	-89.06	407.95	40°32'30.198"N	104°45'30.190"W	0.39	
2257.00	15.950	103.720	2199.97	-427.68	-95.25	433.05	40°32'30.136"N	104°45'29.865"W	0.09	
2352.00	15.980	105.390	2291.30	-452.61	-101.82	458.34	40°32'30.071"N	104°45'29.538"W	0.48	
2446.00	15.980	101.820	2381.67	-477.41	-107.90	483.48	40°32'30.011"N	104°45'29.212"W	1.05	
2540.00	15.990	98.920	2472.04	-502.60	-112.56	508.93	40°32'29.965"N	104°45'28.882"W	0.85	
2635.00	16.100	96.470	2563.34	-528.40	-116.07	534.95	40°32'29.931"N	104°45'28.545"W	0.72	

Actual Wellpath Report

G & D HANKS U-27-28HN AWP

Page n of nn



REFERENCE WELLPATH IDENTIFICATION

Operator	BAYSWATER E & P LLC	Slot	SLOT#12 G & D HANKS U-27-28HN (1183'FSL & 1575'FEL,SEC.27)
Area	COLORADO	Well	G & D HANKS U-27-28HN
Field	WELD COUNTY (NAD83/TRUE NORTH)	Wellbore	G & D HANKS U-27-28HN AWB
Facility	SEC.27-T07N-R66W		

WELLPATH DATA (196 stations)

MD [ft]	Inclination [°]	Azimuth [°]	TVD [ft]	Vert Sect [ft]	North [ft]	East [ft]	Latitude	Longitude	DLS [°/100ft]	Comments
2730.00	16.040	94.440	2654.63	-554.42	-118.57	561.12	40°32'29.906"N	104°45'28.206"W	0.59	
2825.00	15.960	99.200	2745.95	-580.20	-121.68	587.10	40°32'29.875"N	104°45'27.870"W	1.38	
2919.00	16.230	106.410	2836.28	-605.24	-127.46	612.46	40°32'29.818"N	104°45'27.541"W	2.14	
3014.00	16.100	105.180	2927.52	-630.29	-134.66	637.91	40°32'29.747"N	104°45'27.212"W	0.39	
3109.00	16.000	102.890	3018.82	-655.41	-141.03	663.39	40°32'29.684"N	104°45'26.882"W	0.67	
3204.00	16.130	102.810	3110.11	-680.72	-146.87	689.02	40°32'29.626"N	104°45'26.550"W	0.14	
3298.00	16.080	101.120	3200.42	-705.92	-152.28	714.52	40°32'29.573"N	104°45'26.220"W	0.50	
3393.00	16.080	98.400	3291.71	-731.58	-156.74	740.45	40°32'29.529"N	104°45'25.884"W	0.79	
3487.00	15.810	97.770	3382.09	-756.93	-160.37	766.02	40°32'29.493"N	104°45'25.553"W	0.34	
3582.00	15.770	105.480	3473.51	-781.91	-165.57	791.28	40°32'29.441"N	104°45'25.225"W	2.21	
3677.00	15.780	113.090	3564.95	-805.77	-174.08	815.61	40°32'29.357"N	104°45'24.910"W	2.18	
3772.00	15.900	112.090	3656.34	-829.18	-184.04	839.55	40°32'29.259"N	104°45'24.600"W	0.31	
3866.00	15.820	110.130	3746.76	-852.64	-193.29	863.51	40°32'29.167"N	104°45'24.290"W	0.58	
3960.00	16.240	109.240	3837.11	-876.61	-202.03	887.95	40°32'29.081"N	104°45'23.973"W	0.52	
4055.00	16.180	102.570	3928.34	-901.67	-209.29	913.41	40°32'29.009"N	104°45'23.643"W	1.96	
4150.00	16.340	97.150	4019.54	-927.59	-213.83	939.59	40°32'28.964"N	104°45'23.304"W	1.61	
4245.00	16.400	92.080	4110.70	-954.11	-215.98	966.26	40°32'28.943"N	104°45'22.959"W	1.51	
4340.00	16.350	89.460	4201.84	-980.83	-216.34	993.03	40°32'28.940"N	104°45'22.612"W	0.78	
4434.00	16.190	92.980	4292.08	-1007.09	-216.90	1019.35	40°32'28.934"N	104°45'22.271"W	1.06	
4529.00	16.240	95.340	4383.30	-1033.41	-218.83	1045.80	40°32'28.915"N	104°45'21.929"W	0.70	
4623.00	16.370	97.720	4473.52	-1059.44	-221.83	1072.01	40°32'28.885"N	104°45'21.589"W	0.72	
4718.00	16.150	97.840	4564.72	-1085.58	-225.43	1098.37	40°32'28.850"N	104°45'21.248"W	0.23	
4813.00	16.020	99.920	4656.01	-1111.34	-229.49	1124.37	40°32'28.810"N	104°45'20.911"W	0.62	
4907.00	16.050	101.590	4746.35	-1136.57	-234.34	1149.88	40°32'28.762"N	104°45'20.581"W	0.49	
5002.00	16.180	102.760	4837.62	-1162.03	-239.90	1175.65	40°32'28.707"N	104°45'20.247"W	0.37	
5097.00	16.240	104.370	4928.84	-1187.46	-246.12	1201.43	40°32'28.645"N	104°45'19.913"W	0.48	
5192.00	16.130	105.530	5020.08	-1212.67	-252.95	1227.01	40°32'28.578"N	104°45'19.582"W	0.36	
5286.00	16.220	104.420	5110.35	-1237.59	-259.71	1252.31	40°32'28.511"N	104°45'19.254"W	0.34	
5380.00	16.290	103.390	5200.60	-1262.77	-266.04	1277.85	40°32'28.448"N	104°45'18.923"W	0.32	
5475.00	16.060	103.450	5291.84	-1288.17	-272.18	1303.59	40°32'28.388"N	104°45'18.590"W	0.24	

Actual Wellpath Report

G & D HANKS U-27-28HN AWP

Page n of nn



REFERENCE WELLPATH IDENTIFICATION

Operator	BAYSWATER E & P LLC	Slot	SLOT#12 G & D HANKS U-27-28HN (1183'FSL & 1575'FEL,SEC.27)
Area	COLORADO	Well	G & D HANKS U-27-28HN
Field	WELD COUNTY (NAD83/TRUE NORTH)	Wellbore	G & D HANKS U-27-28HN AWB
Facility	SEC.27-T07N-R66W		

WELLPATH DATA (196 stations)

MD [ft]	Inclination [°]	Azimuth [°]	TVD [ft]	Vert Sect [ft]	North [ft]	East [ft]	Latitude	Longitude	DLS [°/100ft]	Comments
5569.00	16.180	104.810	5382.14	-1313.13	-278.55	1328.90	40°32'28.325"N	104°45'18.262"W	0.42	
5663.00	16.110	103.300	5472.43	-1338.13	-284.90	1354.25	40°32'28.262"N	104°45'17.934"W	0.45	
5758.00	15.900	102.610	5563.75	-1363.32	-290.77	1379.78	40°32'28.204"N	104°45'17.603"W	0.30	
5853.00	16.070	100.980	5655.08	-1388.63	-296.12	1405.38	40°32'28.151"N	104°45'17.271"W	0.51	
5947.00	15.760	97.730	5745.48	-1413.81	-300.31	1430.81	40°32'28.110"N	104°45'16.942"W	1.00	
6041.00	16.100	99.200	5835.87	-1439.10	-304.11	1456.32	40°32'28.072"N	104°45'16.611"W	0.56	
6136.00	16.070	100.250	5927.15	-1464.78	-308.56	1482.26	40°32'28.028"N	104°45'16.275"W	0.31	
6230.00	16.170	100.720	6017.45	-1490.17	-313.31	1507.93	40°32'27.981"N	104°45'15.943"W	0.17	
6325.00	16.180	100.410	6108.69	-1515.91	-318.16	1533.94	40°32'27.933"N	104°45'15.606"W	0.09	
6420.00	16.080	101.330	6199.95	-1541.54	-323.14	1559.86	40°32'27.884"N	104°45'15.270"W	0.29	
6515.00	16.120	100.920	6291.23	-1567.10	-328.22	1585.71	40°32'27.834"N	104°45'14.936"W	0.13	
6610.00	16.660	101.740	6382.37	-1593.09	-333.49	1611.99	40°32'27.782"N	104°45'14.595"W	0.62	
6704.00	16.160	100.680	6472.54	-1618.84	-338.65	1638.04	40°32'27.731"N	104°45'14.258"W	0.62	
6798.00	13.960	97.410	6563.31	-1642.71	-342.54	1662.14	40°32'27.692"N	104°45'13.946"W	2.51	
6893.00	5.670	90.640	6656.84	-1658.70	-344.07	1678.23	40°32'27.677"N	104°45'13.737"W	8.80	
6987.00	6.130	263.200	6750.67	-1658.33	-344.72	1677.89	40°32'27.671"N	104°45'13.742"W	12.53	
7081.00	15.020	261.270	6842.98	-1641.17	-347.17	1660.83	40°32'27.647"N	104°45'13.963"W	9.46	
7176.00	23.050	255.990	6932.72	-1610.62	-353.55	1630.56	40°32'27.583"N	104°45'14.355"W	8.64	
7270.00	33.330	260.060	7015.46	-1566.81	-362.49	1587.15	40°32'27.495"N	104°45'14.917"W	11.12	
7364.00	41.320	267.370	7090.19	-1510.03	-368.38	1530.60	40°32'27.437"N	104°45'15.649"W	9.71	
7458.00	51.800	269.160	7154.74	-1441.89	-370.36	1462.47	40°32'27.418"N	104°45'16.532"W	11.23	
7552.00	61.010	268.210	7206.69	-1363.71	-372.18	1384.28	40°32'27.400"N	104°45'17.545"W	9.83	
7646.00	69.790	269.500	7245.79	-1278.37	-373.86	1298.91	40°32'27.383"N	104°45'18.650"W	9.42	
7741.00	78.320	271.420	7271.86	-1187.27	-373.09	1207.66	40°32'27.391"N	104°45'19.832"W	9.19	
7836.00	88.180	272.750	7283.02	-1093.40	-369.65	1113.50	40°32'27.425"N	104°45'21.052"W	10.47	
7931.00	90.220	274.440	7284.34	-999.03	-363.70	1018.71	40°32'27.484"N	104°45'22.280"W	2.79	
8025.00	90.120	272.860	7284.06	-905.65	-357.71	924.90	40°32'27.543"N	104°45'23.495"W	1.68	
8120.00	90.890	271.540	7283.23	-811.03	-354.07	829.98	40°32'27.579"N	104°45'24.724"W	1.61	
8215.00	90.770	266.060	7281.85	-716.12	-356.05	735.04	40°32'27.559"N	104°45'25.954"W	5.77	
8309.00	90.830	266.210	7280.54	-622.14	-362.39	641.27	40°32'27.497"N	104°45'27.168"W	0.17	

Actual Wellpath Report

G & D HANKS U-27-28HN AWP

Page n of nn



REFERENCE WELLPATH IDENTIFICATION

Operator	BAYSWATER E & P LLC	Slot	SLOT#12 G & D HANKS U-27-28HN (1183'FSL & 1575'FEL,SEC.27)
Area	COLORADO	Well	G & D HANKS U-27-28HN
Field	WELD COUNTY (NAD83/TRUE NORTH)	Wellbore	G & D HANKS U-27-28HN AWB
Facility	SEC.27-T07N-R66W		

WELLPATH DATA (196 stations)

MD [ft]	Inclination [°]	Azimuth [°]	TVD [ft]	Vert Sect [ft]	North [ft]	East [ft]	Latitude	Longitude	DLS [°/100ft]	Comments
8403.00	90.490	268.320	7279.45	-528.15	-366.87	547.39	40°32'27.452"N	104°45'28.384"W	2.27	
8497.00	90.150	269.160	7278.93	-434.19	-368.94	453.41	40°32'27.432"N	104°45'29.602"W	0.96	
8592.00	90.220	269.290	7278.62	-339.26	-370.23	358.42	40°32'27.419"N	104°45'30.832"W	0.16	
8687.00	90.340	271.530	7278.16	-244.42	-369.55	263.43	40°32'27.426"N	104°45'32.062"W	2.36	
8781.00	90.280	272.750	7277.65	-150.79	-366.04	169.50	40°32'27.461"N	104°45'33.279"W	1.30	
8876.00	90.150	273.740	7277.29	-56.34	-360.66	74.65	40°32'27.514"N	104°45'34.507"W	1.05	
8970.00	90.250	272.510	7276.96	37.14	-355.54	-19.21	40°32'27.564"N	104°45'35.723"W	1.31	
9065.00	90.370	270.150	7276.45	131.88	-353.33	-114.17	40°32'27.586"N	104°45'36.953"W	2.49	
9160.00	90.370	269.350	7275.84	226.77	-353.75	-209.17	40°32'27.582"N	104°45'38.184"W	0.84	
9254.00	90.220	270.190	7275.35	320.67	-354.12	-303.17	40°32'27.578"N	104°45'39.401"W	0.91	
9349.00	90.250	265.470	7274.96	415.63	-357.72	-398.07	40°32'27.543"N	104°45'40.630"W	4.97	
9443.00	90.220	259.830	7274.58	509.31	-369.74	-491.26	40°32'27.424"N	104°45'41.837"W	6.00	
9538.00	90.400	265.440	7274.06	603.98	-381.91	-585.44	40°32'27.304"N	104°45'43.057"W	5.91	
9633.00	90.890	272.280	7272.99	698.88	-383.80	-680.35	40°32'27.285"N	104°45'44.287"W	7.22	
9727.00	91.200	278.120	7271.28	791.88	-375.29	-773.91	40°32'27.369"N	104°45'45.498"W	6.22	
9822.00	91.140	276.460	7269.34	885.36	-363.24	-868.12	40°32'27.488"N	104°45'46.719"W	1.75	
9916.00	90.120	275.900	7268.30	978.18	-353.12	-961.57	40°32'27.588"N	104°45'47.929"W	1.24	
10010.00	89.970	276.090	7268.23	1071.05	-343.30	-1055.05	40°32'27.685"N	104°45'49.140"W	0.26	
10105.00	90.090	276.940	7268.18	1164.77	-332.52	-1149.44	40°32'27.792"N	104°45'50.362"W	0.90	
10199.00	90.000	272.080	7268.10	1257.96	-325.13	-1243.12	40°32'27.865"N	104°45'51.576"W	5.17	
10294.00	89.850	268.490	7268.23	1352.80	-324.66	-1338.10	40°32'27.869"N	104°45'52.806"W	3.78	
10388.00	89.970	266.100	7268.38	1446.79	-329.09	-1431.99	40°32'27.825"N	104°45'54.022"W	2.55	
10483.00	90.030	260.780	7268.38	1541.56	-339.94	-1526.33	40°32'27.718"N	104°45'55.244"W	5.60	
10576.00	90.180	258.020	7268.21	1633.71	-357.05	-1617.74	40°32'27.549"N	104°45'56.428"W	2.97	
10671.00	90.090	259.780	7267.98	1727.74	-375.34	-1710.96	40°32'27.368"N	104°45'57.635"W	1.86	
10766.00	89.850	261.530	7268.03	1822.13	-390.76	-1804.69	40°32'27.216"N	104°45'58.850"W	1.86	
10861.00	89.850	264.260	7268.28	1916.87	-402.51	-1898.95	40°32'27.099"N	104°46'00.070"W	2.87	
10955.00	89.720	263.940	7268.63	2010.74	-412.18	-1992.46	40°32'27.004"N	104°46'01.281"W	0.37	
11049.00	89.910	265.810	7268.94	2104.66	-420.57	-2086.08	40°32'26.921"N	104°46'02.494"W	2.00	
11144.00	89.970	270.230	7269.04	2199.62	-423.85	-2180.99	40°32'26.888"N	104°46'03.724"W	4.65	

Actual Wellpath Report

G & D HANKS U-27-28HN AWP

Page n of nn



REFERENCE WELLPATH IDENTIFICATION

Operator	BAYSWATER E & P LLC	Slot	SLOT#12 G & D HANKS U-27-28HN (1183'FSL & 1575'FEL,SEC.27)
Area	COLORADO	Well	G & D HANKS U-27-28HN
Field	WELD COUNTY (NAD83/TRUE NORTH)	Wellbore	G & D HANKS U-27-28HN AWB
Facility	SEC.27-T07N-R66W		

WELLPATH DATA (196 stations)

MD [ft]	Inclination [°]	Azimuth [°]	TVD [ft]	Vert Sect [ft]	North [ft]	East [ft]	Latitude	Longitude	DLS [°/100ft]	Comments
11238.00	90.220	271.970	7268.88	2293.39	-422.05	-2274.97	40°32'26.906"N	104°46'04.941"W	1.87	
11333.00	90.310	272.980	7268.44	2387.97	-417.95	-2369.88	40°32'26.947"N	104°46'06.170"W	1.07	
11428.00	90.090	268.520	7268.11	2482.76	-416.70	-2464.85	40°32'26.959"N	104°46'07.400"W	4.70	
11523.00	90.280	267.920	7267.80	2577.74	-419.65	-2559.80	40°32'26.930"N	104°46'08.630"W	0.66	
11617.00	90.120	268.940	7267.47	2671.71	-422.23	-2653.77	40°32'26.904"N	104°46'09.847"W	1.10	
11712.00	90.060	270.790	7267.33	2766.59	-422.45	-2748.76	40°32'26.902"N	104°46'11.077"W	1.95	
11806.00	90.030	266.750	7267.25	2860.54	-424.47	-2842.72	40°32'26.882"N	104°46'12.294"W	4.30	
11900.00	90.180	269.950	7267.08	2954.50	-427.18	-2936.67	40°32'26.855"N	104°46'13.511"W	3.41	
11995.00	90.400	275.120	7266.60	3049.04	-422.98	-3031.54	40°32'26.896"N	104°46'14.740"W	5.45	
12089.00	90.000	277.760	7266.27	3141.79	-412.43	-3124.94	40°32'27.000"N	104°46'15.950"W	2.84	
12183.00	89.940	279.290	7266.32	3233.92	-398.50	-3217.90	40°32'27.138"N	104°46'17.154"W	1.63	
12279.00	89.880	273.640	7266.47	3328.61	-387.70	-3313.25	40°32'27.244"N	104°46'18.389"W	5.89	
12373.00	90.030	271.370	7266.54	3422.18	-383.59	-3407.15	40°32'27.285"N	104°46'19.605"W	2.42	
12468.00	90.000	270.160	7266.52	3516.99	-382.32	-3502.14	40°32'27.297"N	104°46'20.836"W	1.27	
12562.00	89.970	269.110	7266.54	3610.89	-382.92	-3596.14	40°32'27.291"N	104°46'22.053"W	1.12	
12657.00	89.970	270.090	7266.59	3705.80	-383.58	-3691.14	40°32'27.285"N	104°46'23.284"W	1.03	
12751.00	90.220	270.430	7266.44	3799.66	-383.15	-3785.14	40°32'27.289"N	104°46'24.501"W	0.45	
12846.00	90.280	270.180	7266.02	3894.51	-382.65	-3880.13	40°32'27.293"N	104°46'25.732"W	0.27	
12940.00	90.220	269.950	7265.61	3988.38	-382.54	-3974.13	40°32'27.294"N	104°46'26.949"W	0.25	
13035.00	90.090	267.720	7265.36	4083.33	-384.47	-4069.11	40°32'27.275"N	104°46'28.179"W	2.35	
13129.00	89.850	266.630	7265.40	4177.33	-389.11	-4162.99	40°32'27.229"N	104°46'29.395"W	1.19	
13223.00	89.780	265.650	7265.71	4271.32	-395.43	-4256.78	40°32'27.167"N	104°46'30.610"W	1.05	
13318.00	89.880	264.660	7265.99	4366.26	-403.46	-4351.43	40°32'27.087"N	104°46'31.836"W	1.05	
13413.00	89.940	265.060	7266.14	4461.19	-411.97	-4446.05	40°32'27.003"N	104°46'33.061"W	0.43	
13508.00	89.880	265.490	7266.29	4556.14	-419.79	-4540.73	40°32'26.925"N	104°46'34.288"W	0.46	
13602.00	89.880	266.540	7266.49	4650.12	-426.33	-4634.50	40°32'26.861"N	104°46'35.502"W	1.12	
13696.00	89.940	267.270	7266.63	4744.12	-431.40	-4728.36	40°32'26.810"N	104°46'36.718"W	0.78	
13791.00	89.940	268.890	7266.73	4839.10	-434.58	-4823.31	40°32'26.779"N	104°46'37.948"W	1.71	
13885.00	89.850	271.720	7266.91	4932.95	-434.08	-4917.29	40°32'26.783"N	104°46'39.165"W	3.01	
13980.00	89.970	272.980	7267.05	5027.55	-430.19	-5012.21	40°32'26.822"N	104°46'40.395"W	1.33	

Actual Wellpath Report

G & D HANKS U-27-28HN AWP

Page n of nn



REFERENCE WELLPATH IDENTIFICATION

Operator	BAYSWATER E & P LLC	Slot	SLOT#12 G & D HANKS U-27-28HN (1183'FSL & 1575'FEL,SEC.27)
Area	COLORADO	Well	G & D HANKS U-27-28HN
Field	WELD COUNTY (NAD83/TRUE NORTH)	Wellbore	G & D HANKS U-27-28HN AWB
Facility	SEC.27-T07N-R66W		

WELLPATH DATA (196 stations)

MD [ft]	Inclination [°]	Azimuth [°]	TVD [ft]	Vert Sect [ft]	North [ft]	East [ft]	Latitude	Longitude	DLS [°/100ft]	Comments
14074.00	89.970	273.380	7267.10	5121.02	-424.97	-5106.07	40°32'26.873"N	104°46'41.610"W	0.43	
14169.00	90.030	274.080	7267.10	5215.38	-418.79	-5200.87	40°32'26.934"N	104°46'42.838"W	0.74	
14264.00	90.060	273.520	7267.03	5309.73	-412.50	-5295.66	40°32'26.996"N	104°46'44.066"W	0.59	
14358.00	90.000	271.520	7266.98	5403.31	-408.37	-5389.56	40°32'27.037"N	104°46'45.282"W	2.13	
14452.00	90.150	271.980	7266.86	5497.00	-405.49	-5483.52	40°32'27.065"N	104°46'46.499"W	0.51	
14547.00	90.060	271.440	7266.68	5591.69	-402.66	-5578.47	40°32'27.093"N	104°46'47.729"W	0.58	
14642.00	90.060	269.820	7266.58	5686.51	-401.62	-5673.46	40°32'27.103"N	104°46'48.959"W	1.71	
14737.00	89.970	270.340	7266.56	5781.38	-401.48	-5768.46	40°32'27.104"N	104°46'50.190"W	0.56	
14832.00	90.000	266.750	7266.58	5876.34	-403.89	-5863.42	40°32'27.080"N	104°46'51.420"W	3.78	
14926.00	90.180	268.520	7266.44	5970.33	-407.77	-5957.33	40°32'27.041"N	104°46'52.636"W	1.89	
15021.00	90.120	268.840	7266.19	6065.29	-409.96	-6052.31	40°32'27.019"N	104°46'53.866"W	0.34	
15115.00	90.090	268.130	7266.01	6159.26	-412.45	-6146.28	40°32'26.994"N	104°46'55.083"W	0.76	
15210.00	90.150	266.890	7265.82	6254.26	-416.57	-6241.18	40°32'26.953"N	104°46'56.313"W	1.31	
15305.00	89.940	267.370	7265.74	6349.26	-421.33	-6336.06	40°32'26.906"N	104°46'57.542"W	0.55	
15400.00	90.030	266.380	7265.77	6444.26	-426.51	-6430.92	40°32'26.855"N	104°46'58.770"W	1.05	
15494.00	89.880	264.850	7265.84	6538.22	-433.70	-6524.64	40°32'26.784"N	104°46'59.984"W	1.64	
15588.00	90.000	266.290	7265.94	6632.19	-440.96	-6618.36	40°32'26.712"N	104°47'01.198"W	1.54	
15683.00	89.850	266.570	7266.06	6727.18	-446.87	-6713.18	40°32'26.653"N	104°47'02.426"W	0.33	
15778.00	89.940	266.710	7266.24	6822.18	-452.44	-6808.01	40°32'26.598"N	104°47'03.654"W	0.18	
15872.00	89.780	267.080	7266.47	6916.17	-457.53	-6901.87	40°32'26.547"N	104°47'04.870"W	0.43	
15967.00	89.940	268.480	7266.70	7011.17	-461.21	-6996.80	40°32'26.510"N	104°47'06.100"W	1.48	
16062.00	89.970	269.920	7266.77	7106.10	-462.54	-7091.79	40°32'26.497"N	104°47'07.330"W	1.52	
16157.00	89.940	270.270	7266.85	7200.97	-462.38	-7186.79	40°32'26.498"N	104°47'08.560"W	0.37	
16251.00	89.940	270.740	7266.95	7294.80	-461.55	-7280.78	40°32'26.506"N	104°47'09.778"W	0.50	
16346.00	89.910	270.600	7267.07	7389.62	-460.44	-7375.78	40°32'26.517"N	104°47'11.008"W	0.15	
16440.00	90.000	271.690	7267.14	7483.38	-458.56	-7469.76	40°32'26.535"N	104°47'12.226"W	1.16	
16535.00	89.850	274.540	7267.27	7577.85	-453.40	-7564.61	40°32'26.586"N	104°47'13.454"W	3.00	
16630.00	89.910	274.120	7267.47	7672.10	-446.23	-7659.33	40°32'26.656"N	104°47'14.681"W	0.45	
16724.00	89.880	271.570	7267.64	7765.62	-441.56	-7753.21	40°32'26.702"N	104°47'15.897"W	2.71	
16819.00	89.910	269.310	7267.81	7860.45	-440.83	-7848.20	40°32'26.709"N	104°47'17.127"W	2.38	

Actual Wellpath Report

G & D HANKS U-27-28HN AWP

Page n of nn



REFERENCE WELLPATH IDENTIFICATION

Operator	BAYSWATER E & P LLC	Slot	SLOT#12 G & D HANKS U-27-28HN (1183'FSL & 1575'FEL,SEC.27)
Area	COLORADO	Well	G & D HANKS U-27-28HN
Field	WELD COUNTY (NAD83/TRUE NORTH)	Wellbore	G & D HANKS U-27-28HN AWB
Facility	SEC.27-T07N-R66W		

WELLPATH DATA (196 stations)

MD [ft]	Inclination [°]	Azimuth [°]	TVD [ft]	Vert Sect [ft]	North [ft]	East [ft]	Latitude	Longitude	DLS [°/100ft]	Comments
16913.00	89.970	270.020	7267.91	7954.36	-441.38	-7942.20	40°32'26.703"N	104°47'18.345"W	0.76	
17008.00	90.120	269.580	7267.84	8049.25	-441.72	-8037.20	40°32'26.700"N	104°47'19.575"W	0.49	
17103.00	90.060	269.050	7267.69	8144.18	-442.85	-8132.19	40°32'26.688"N	104°47'20.806"W	0.56	
17198.00	89.940	264.840	7267.69	8239.16	-447.91	-8227.04	40°32'26.638"N	104°47'22.034"W	4.43	
17292.00	89.940	267.700	7267.79	8333.14	-454.03	-8320.83	40°32'26.577"N	104°47'23.249"W	3.04	
17387.00	90.030	268.880	7267.81	8428.12	-456.86	-8415.78	40°32'26.549"N	104°47'24.479"W	1.25	
17481.00	90.060	270.080	7267.74	8522.03	-457.72	-8509.78	40°32'26.540"N	104°47'25.696"W	1.28	
17576.00	90.060	270.180	7267.64	8616.90	-457.50	-8604.78	40°32'26.542"N	104°47'26.927"W	0.11	
17671.00	90.030	270.330	7267.56	8711.76	-457.08	-8699.78	40°32'26.546"N	104°47'28.157"W	0.16	
17766.00	89.970	270.030	7267.56	8806.62	-456.78	-8794.77	40°32'26.548"N	104°47'29.388"W	0.32	
17860.00	90.060	268.700	7267.54	8900.55	-457.82	-8888.77	40°32'26.538"N	104°47'30.605"W	1.42	
17955.00	90.060	267.910	7267.44	8995.52	-460.63	-8983.72	40°32'26.510"N	104°47'31.835"W	0.83	
18050.00	90.090	267.740	7267.32	9090.52	-464.24	-9078.66	40°32'26.474"N	104°47'33.065"W	0.18	
18144.00	90.150	269.100	7267.12	9184.49	-466.83	-9172.62	40°32'26.448"N	104°47'34.282"W	1.45	
18195.00	90.120	269.280	7267.00	9235.45	-467.55	-9223.61	40°32'26.441"N	104°47'34.942"W	0.36	BHGE LAST MWD
18220.00	90.120	269.280	7266.95	9260.44	-467.86	-9248.61	40°32'26.437"N	104°47'35.266"W	0.00	PROJ TO BIT

HOLE & CASING SECTIONS

- Ref Wellbore: G & D HANKS U-27-28HN AWB Ref Wellpath: G & D HANKS U-27-28HN AWP

String/Diameter	Start MD [ft]	End MD [ft]	Interval [ft]	Start TVD [ft]	End TVD [ft]	Start N/S [ft]	Start E/W [ft]	End N/S [ft]	End E/W [ft]
13.5in Open Hole	25.00	1555.00	1530.00	25.00	1525.76	0.00	0.00	-50.94	242.60
9.625in Casing Surface	25.00	1555.00	1530.00	25.00	1525.76	0.00	0.00	-50.94	242.60
8.5in Open Hole	1555.00	18220.00	16665.00	1525.76	7266.95	-50.94	242.60	-467.86	-9248.61

Actual Wellpath Report

G & D HANKS U-27-28HN AWP

Page n of nn



REFERENCE WELLPATH IDENTIFICATION			
Operator	BAYSWATER E & P LLC	Slot	SLOT#12 G & D HANKS U-27-28HN (1183'FSL & 1575'FEL,SEC.27)
Area	COLORADO	Well	G & D HANKS U-27-28HN
Field	WELD COUNTY (NAD83/TRUE NORTH)	Wellbore	G & D HANKS U-27-28HN AWB
Facility	SEC.27-T07N-R66W		

TARGETS								
Name	TVD [ft]	North [ft]	East [ft]	Grid East [US ft]	Grid North [US ft]	Latitude	Longitude	Shape
G & D HANKS U-27-28HN LP PLAT (820'FSL & 470'FEL,SEC.27)	7211.00	-350.09	1106.76	3206813.86	1440796.68	40°32'27.618"N	104°45'21.139"W	point
G & D HANKS U-27-28HN BHL REV-1 (820'FSL & 5'FWL,SEC.28)	7231.00	-463.86	-9257.39	3196451.36	1440596.41	40°32'26.477"N	104°47'35.380"W	point
G & D HANKS U-27-28HN BHL REV-2 (820'FSL & 5'FWL,SEC.28)	7266.00	-463.84	-9257.42	3196451.33	1440596.43	40°32'26.477"N	104°47'35.380"W	point
G & D HANKS U-27-28HN WP1 (-2369 SSTVD @ 10100'MD)	7270.00	-374.79	-1145.06	3204562.40	1440753.18	40°32'27.374"N	104°45'50.306"W	point
G & D HANKS U-27-28HN BHL PLAT (820'FSL & 5'FWL,SEC.28)	7271.00	-463.86	-9257.39	3196451.36	1440596.41	40°32'26.477"N	104°47'35.380"W	point
G & D HANKS U-27-28HN LP REV-1 (820'FSL & 470'FEL,SEC.27)	7285.00	-350.09	1106.76	3206813.86	1440796.68	40°32'27.618"N	104°45'21.139"W	point
SEC.27,28-T07N-R66W HDL (460'FEL & 5'FWL)	9999.00	44.81	0.00	3205703.88	1441182.31	40°32'31.520"N	104°45'35.474"W	polygon
SEC.27-T07N-R66W	9999.00	44.81	0.00	3205703.88	1441182.31	40°32'31.520"N	104°45'35.474"W	polygon
SEC.28-T07N-R66W*	9999.00	44.81	0.00	3205703.88	1441182.31	40°32'31.520"N	104°45'35.474"W	polygon

WELLPATH COMPOSITION - Ref Wellbore: G & D HANKS U-27-28HN AWB					Ref Wellpath: G & D HANKS U-27-28HN AWP
Start MD [ft]	End MD [ft]	Positional Uncertainty Model	Log Name/Comment		Wellbore
25.00	1508.00	BHI NaviTrak (Standard)	13.5" Surface NaviTrak (Standard) <137-1508>		G & D HANKS U-27-28HN AWB
1508.00	18195.00	BHI AutoTrak Curve (Short)	BHI AutoTrak Curve (Short) <1595-18195>		G & D HANKS U-27-28HN AWB
18195.00	18220.00	Blind Drilling (std)	Projection to bit		G & D HANKS U-27-28HN AWB