

LEGEND:

PROPOSED LOCATION



UELS, LLC
Corporate Office * 85 South 200 East
Vernal, UT 84078 * (435) 789-1017



HIGHPOINT OPERATING CORPORATION

CRITTER CREEK 17 SW PAD
SW 1/4 SW 1/4, SECTION 17, T11N, R63W, 6th P.M.
WELD COUNTY, COLORADO

SURVEYED BY	J.C., O.R.	04-18-18	SCALE
DRAWN BY	J.L.G.	04-25-18	1 : 100,000
ACCESS ROAD MAP			TOPO A

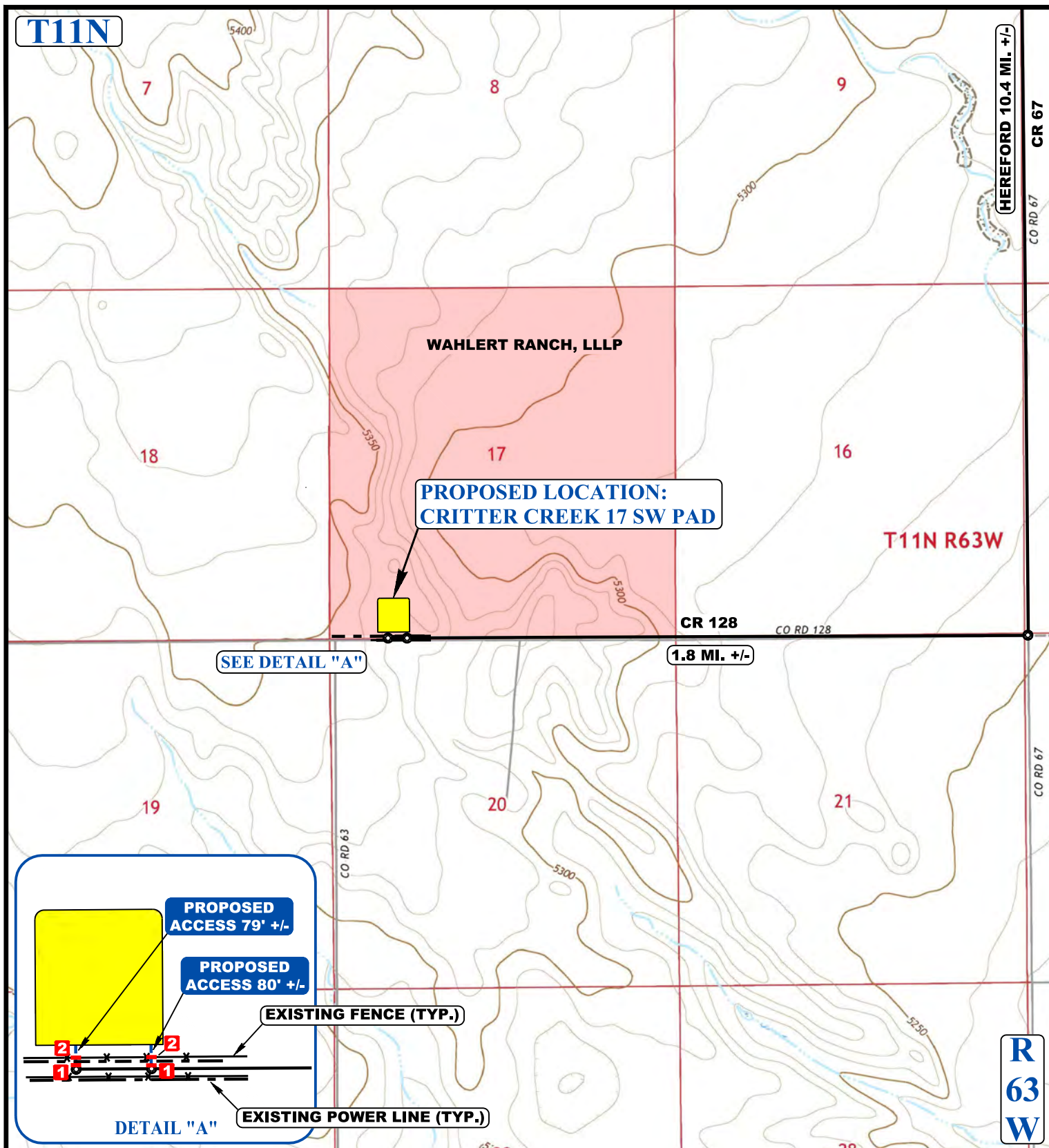

NOTE: PARCEL DATA SHOWN HAS BEEN OBTAINED FROM VARIOUS SOURCES AND SHOULD BE USED FOR MAPPING, GRAPHIC AND PLANNING PURPOSES ONLY. NO WARRANTY IS MADE BY UTAH ENGINEERING AND LAND SURVEYING (UELS) FOR ACCURACY OF THE PARCEL DATA.

LEGEND:

- EXISTING ROAD
- PROPOSED ROAD
- EXISTING FENCE
- EXISTING POWER LINE
- 1 INSTALL 18" CULVERT
- 2 INSTALL CATTLE GUARD



HIGHPOINT OPERATING CORPORATION

CRITTER CREEK 17 SW PAD
SW 1/4 SW 1/4, SECTION 17, T11N, R63W, 6th P.M.
WELD COUNTY, COLORADO

SURVEYED BY	J.C., O.R.	04-18-18	SCALE
DRAWN BY	J.L.G.	04-25-18	1 : 24,000
ACCESS ROAD MAP			TOPO B



UELS, LLC
Corporate Office * 85 South 200 East
Vernal, UT 84078 * (435) 789-1017