

# **LEGEND:**

 **PROPOSED LOCATION**



**UELS, LLC**  
Corporate Office \* 85 South 200 East  
Vernal, UT 84078 \* (435) 789-1017



**Caerus Oil & Gas LLC**

**G09 596 FRAC PAD**  
SW 1/4 NW 1/4, SECTION 9, T5S, R96W, 6th P.M.  
GARFIELD COUNTY, COLORADO

SURVEYED BY	BART HUNTING, D.P.	11-29-17	SCALE
DRAWN BY	Z.T.	12-01-17	1 : 100,000
<b>ACCESS ROAD MAP</b>			<b>TOPO A</b>



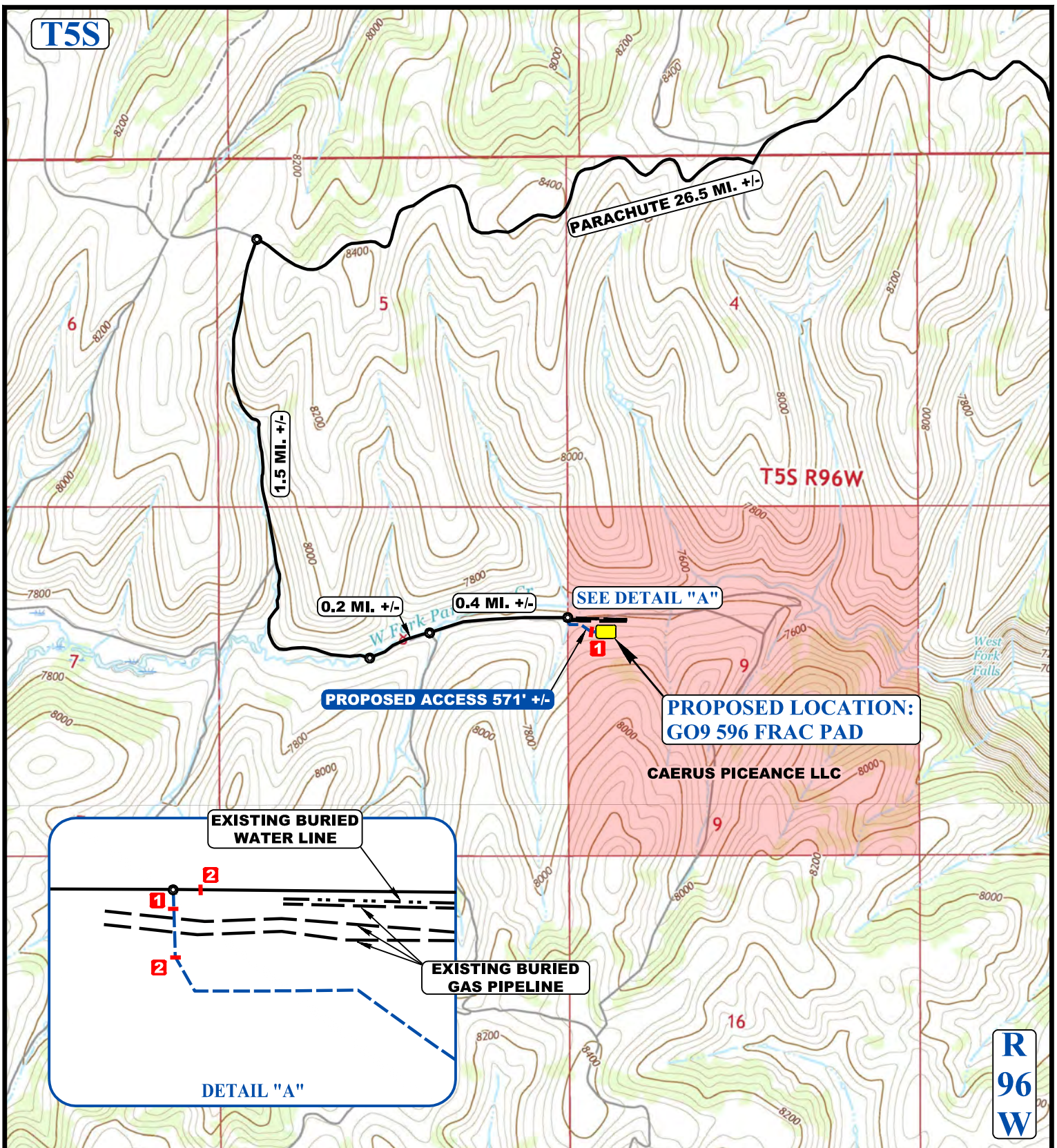

NOTE: PARCEL DATA SHOWN HAS BEEN OBTAINED FROM VARIOUS SOURCES AND SHOULD BE USED FOR MAPPING, GRAPHIC AND PLANNING PURPOSES ONLY. NO WARRANTY IS MADE BY UINTAH ENGINEERING AND LAND SURVEYING (UELS) FOR ACCURACY OF THE PARCEL DATA.

#### LEGEND:

	EXISTING ROAD		INSTALL 18" CULVERT
	PROPOSED ROAD		INSTALL 24" CULVERT
	EXISTING BURIED GAS PIPELINE		
	EXISTING BURIED WATER LINE		



**Caerus Oil & Gas LLC**

**G09 596 FRAC PAD**  
SW 1/4 NW 1/4, SECTION 9, T5S, R96W, 6th P.M.  
GARFIELD COUNTY, COLORADO

SURVEYED BY	BART HUNTING, D.P.	11-29-17	SCALE
DRAWN BY	Z.T.	12-01-17	1 : 24,000
<b>ACCESS ROAD MAP</b>			<b>TOPO B</b>



**UELS, LLC**  
Corporate Office \* 85 South 200 East  
Vernal, UT 84078 \* (435) 789-1017