



Lat40°, Inc. 6250 W. 10th Street, Unit 2, Greeley, CO 970-515-5294

PROPOSED SCALED FACILITY DRAWING

THISTLE DOWN 5N64W31H PAD

SECTION: 31
TOWNSHIP: 5N
RANGE: 64W
6TH. P.M.
WELD COUNTY, CO

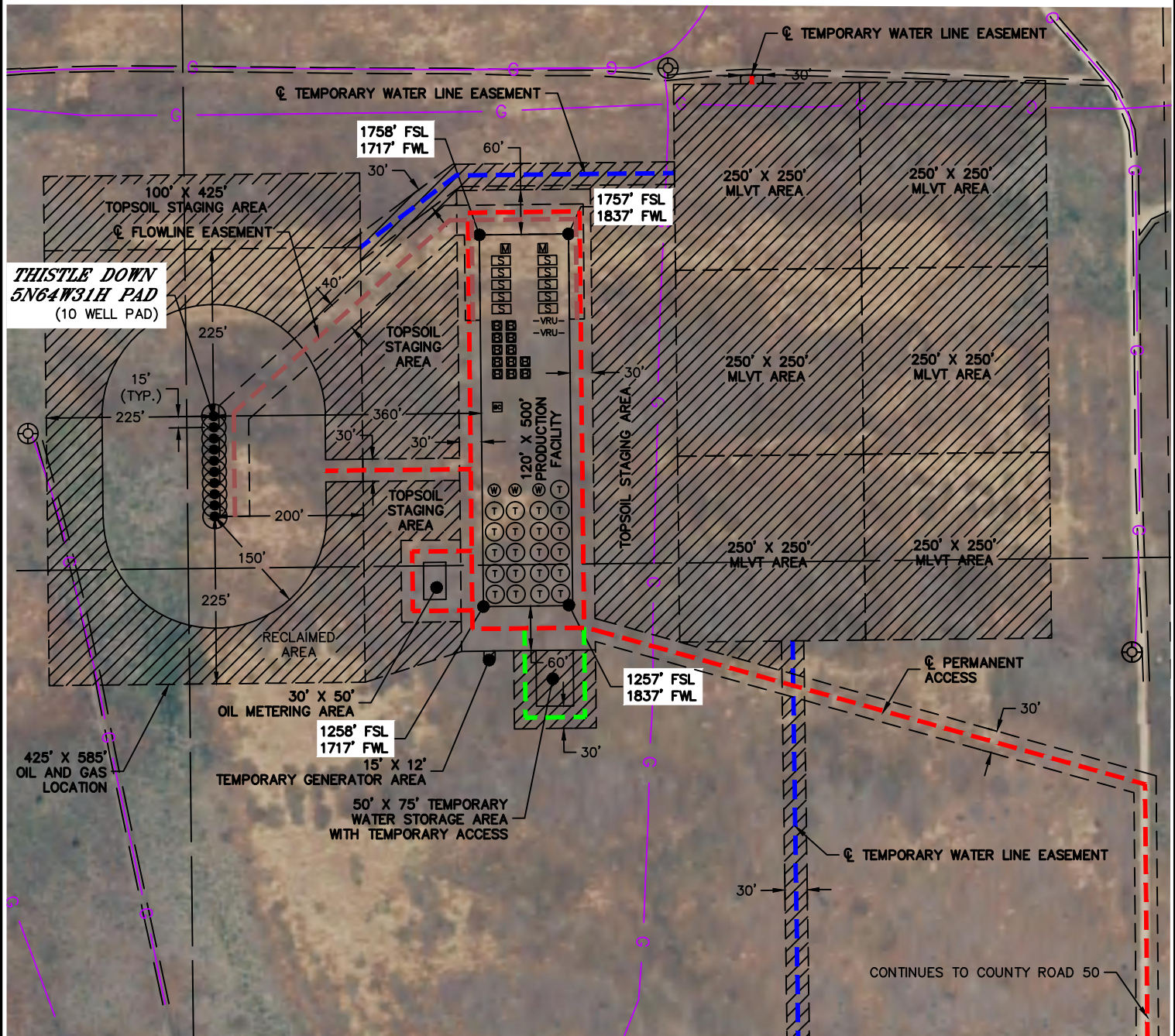

LEGEND

- PROPOSED WELL HEAD
- (T) TANK BATTERY
- (W) WATER TANK
- (W) WATER VAULT
- [S] SEPARATOR
- [B] ECD
- [BC] BLOWCASE
- [M] METER
- VRU- VAPOR RECOVERY UNIT

TOTAL DISTURBED AREA OF LOCATION: ±23.0 ACRES
TOTAL SIZE OF LOCATION AFTER RECLAMATION: ±6.5 ACRES

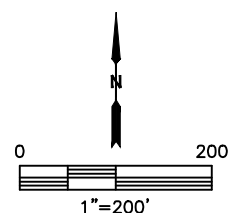

DATE: 5/25/2018
PROJECT#: 2016074