

LEGEND:

 **PROPOSED LOCATION**



UELS, LLC
Corporate Office * 85 South 200 East
Vernal, UT 84078 * (435) 789-1017



ConocoPhillips Company

STATE BIERSTADT 4-65 35-34 2AH, 2BH, 2CH, 2DH,
SE 1/4 NE 1/4, SECTION 35, T4S, R65W, 6th P.M.
ARAPAHOE COUNTY, COLORADO

SURVEYED BY	G.W. O.R.	02-27-18	SCALE
DRAWN BY	J.L.G.	03-05-18	1 : 100,000
ACCESS ROAD MAP			TOPO A

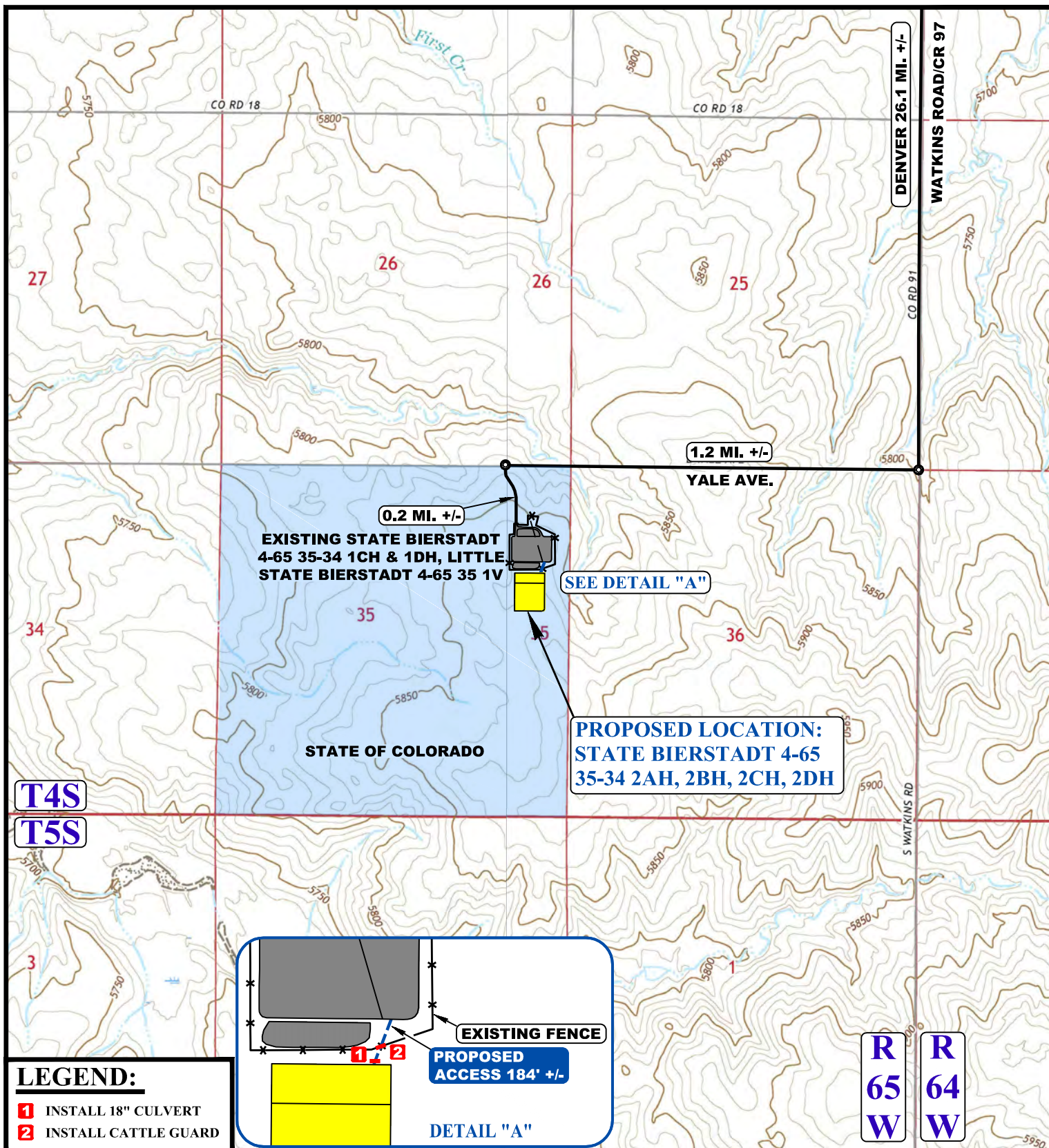

LEGEND:

- 1 INSTALL 18" CULVERT
- 2 INSTALL CATTLE GUARD

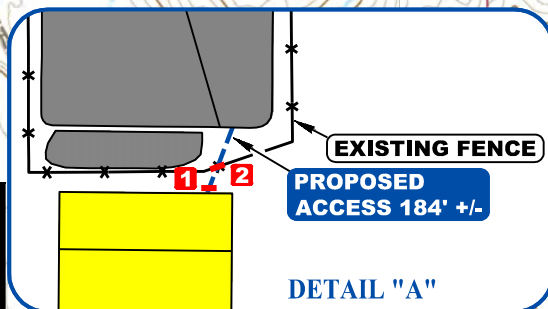

NOTE: PARCEL DATA SHOWN HAS BEEN OBTAINED FROM VARIOUS SOURCES AND SHOULD BE USED FOR MAPPING, GRAPHIC AND PLANNING PURPOSES ONLY. NO WARRANTY IS MADE BY UINTAH ENGINEERING AND LAND SURVEYING (UELS) FOR ACCURACY OF THE PARCEL DATA.

LEGEND:

- EXISTING ROAD
- PROPOSED ROAD
- ** EXISTING FENCE



ConocoPhillips Company

STATE BIERSTADT 4-65 35-34 2AH, 2BH, 2CH, 2DH,
SE 1/4 NE 1/4, SECTION 35, T4S, R65W, 6th P.M.
ARAPAHOE COUNTY, COLORADO

SURVEYED BY	G.W. O.R.	02-27-18	SCALE
DRAWN BY	J.L.G.	03-05-18	1 : 24,000
ACCESS ROAD MAP			TOPO B



UELS, LLC
Corporate Office * 85 South 200 East
Vernal, UT 84078 * (435) 789-1017