

BAYSWATER E & P, LLC

Location	Weld County, CO	Slot	EAST AULT U-18-19HN
Field	WATTENBERG	Well	W EAST AULT U-18-19HN
Installation	East Ault Pad	Wellbore	W EAST AULT U-18-19HN (PWB)

WELL PROFILE DATA

Point	MD	Inc	Azi	TVD	North	East	deg/100ft	V. Sect
Tie on	25.00	0.00	0.00	25.00	S 0.00	W 0.00		0.00
KOP	1025.00	0.00	73.30	1025.00	S 0.00	W 0.00	0.00	0.00
End of Build	1712.68	13.75	73.30	1706.10	N 23.61	E 78.68	2.00	-12.19
End of Hold	6790.86	13.75	73.30	6638.67	N 370.60	E 1235.06	0.00	-191.42
Target EAST A...N - EP	7731.59	90.21	179.79	7234.00	S 202.56	E 1377.41	10.00	396.15
T.D. & Target EAS...BHL	17375.03	90.21	179.79	7199.00	S 9845.88	E 1412.79	0.00	9946.72

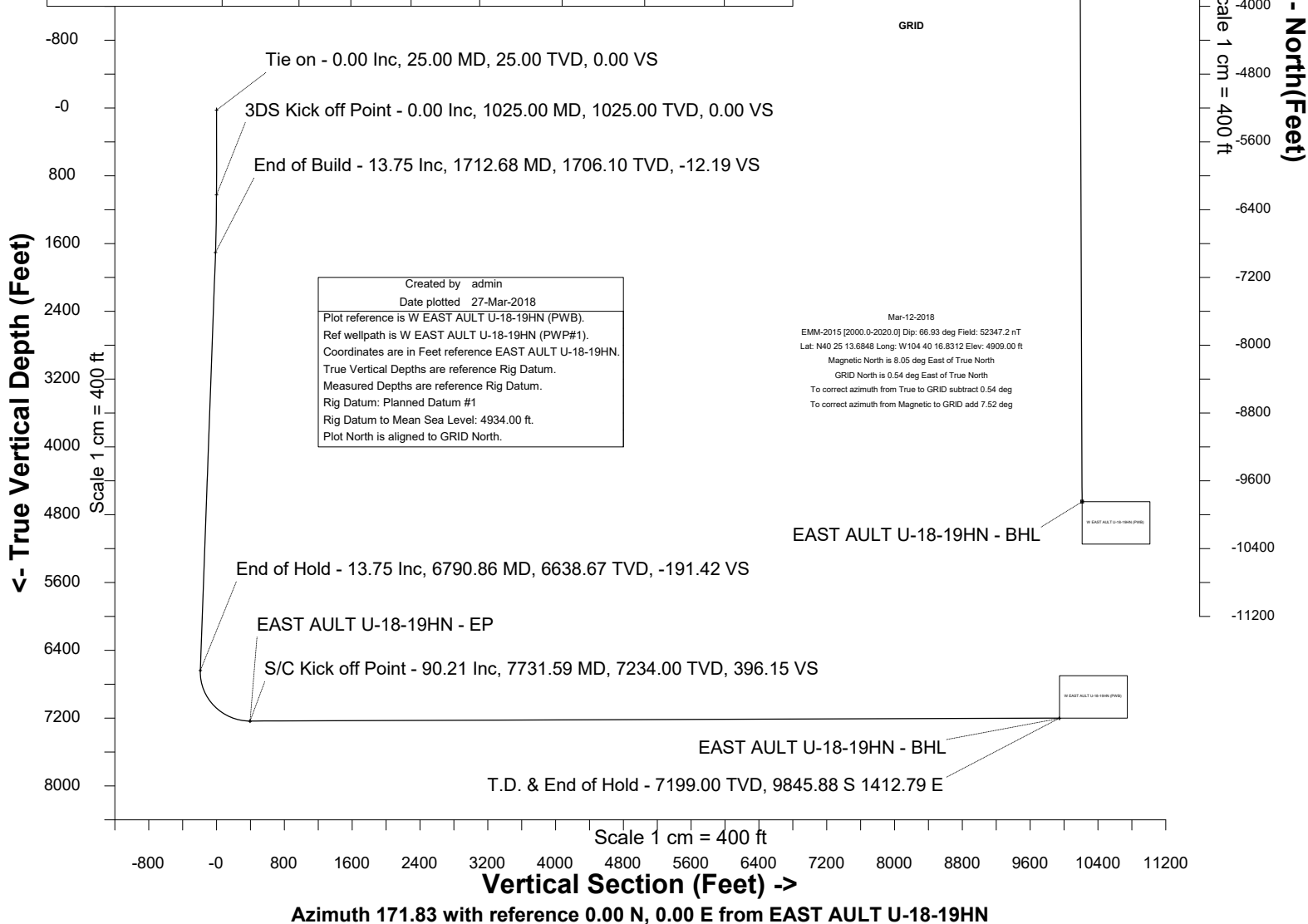



SYSDRILL
Well Design Combined Report
Wellbore: W EAST AULT U-18-19HN (PWB)



Wellhead Details

Name	Latitude	Longitude	Northing	Easting	North	East	Slot Elevation Above Ground
EAST AULT U-18-19HN	40.58167100	-104.70433900	1455735.5104	3221003.0112	58643.04N	9714.18W	0.00

Declination

Date	Source	Time
Mar-12-2018	EMM-2015 [2000.0-2020.0]	20:03

Installation Details

Name	Installation Position (Latitude)	Installation Position (Longitude)	Northing	Easting	Coord System Name	North Alignment
East Ault Pad	40.42046800	-104.67134200	1397094.8569	3230716.7970	CO83-NF on NORTH AMERICAN DATUM 1983 datum	Grid

Summary Wellpath

MD[ft]	Inc[deg]	Azi[deg]	TVD[ft]	North[ft]	East[ft]	Dogleg [deg/100ft]	Vertical Section[ft]	Northing	Easting
25.00	0.00	0.000	25.00	0.00N	0.00E		0.00	1455735.51	3221003.01
1025.00	0.00	73.300	1025.00	0.00N	0.00E	==>	0.00	1455735.51	3221003.01
1712.68	13.75	73.300	1706.10	23.61N	78.68E	2.00	-12.19	1455759.12	3221081.69
6790.86	13.75	73.300	6638.67	370.60N	1235.06E	==>	-191.42	1456106.10	3222238.04
7731.59	90.21	179.790	7234.00	202.56S	1377.41E	10.00	396.15	1455532.95	3222380.38
17375.03	90.21	179.790	7199.00	9845.88S	1412.79E	==>	9946.72	1445889.91	3222415.76

Interpolated Wellpath

MD[ft]	Inc[deg]	Azi[deg]	TVD[ft]	North[ft]	East[ft]	Dogleg [deg/100ft]	Vertical Section[ft]	All Station Comments
0.00	0.00	0.000	0.00	0.00N	0.00E		0.00	Rig Datum
25.00	0.00	0.000	25.00	0.00N	0.00E	==>	0.00	Slot Datum
100.00	0.00	0.000	100.00	0.00N	0.00E	==>	0.00	
200.00	0.00	0.000	200.00	0.00N	0.00E	==>	0.00	
300.00	0.00	0.000	300.00	0.00N	0.00E	==>	0.00	
400.00	0.00	0.000	400.00	0.00N	0.00E	==>	0.00	
500.00	0.00	0.000	500.00	0.00N	0.00E	==>	0.00	
600.00	0.00	0.000	600.00	0.00N	0.00E	==>	0.00	
700.00	0.00	0.000	700.00	0.00N	0.00E	==>	0.00	
800.00	0.00	0.000	800.00	0.00N	0.00E	==>	0.00	
900.00	0.00	0.000	900.00	0.00N	0.00E	==>	0.00	
1000.00	0.00	0.000	1000.00	0.00N	0.00E	==>	0.00	
1100.00	1.50	73.300	1099.99	0.28N	0.94E	2.00	-0.15	
1200.00	3.50	73.300	1199.89	1.54N	5.12E	2.00	-0.79	
1300.00	5.50	73.300	1299.58	3.79N	12.63E	2.00	-1.96	
1400.00	7.50	73.300	1398.93	7.04N	23.47E	2.00	-3.64	
1500.00	9.50	73.300	1497.83	11.29N	37.63E	2.00	-5.83	
1600.00	11.50	73.300	1596.15	16.53N	55.09E	2.00	-8.54	
1700.00	13.50	73.300	1693.77	22.75N	75.81E	2.00	-11.75	
1800.00	13.75	73.300	1790.91	29.57N	98.56E	==>	-15.28	
1900.00	13.75	73.300	1888.04	36.41N	121.33E	==>	-18.80	
2000.00	13.75	73.300	1985.18	43.24N	144.10E	==>	-22.33	
2100.00	13.75	73.300	2082.31	50.07N	166.88E	==>	-25.86	
2200.00	13.75	73.300	2179.44	56.91N	189.65E	==>	-29.39	
2300.00	13.75	73.300	2276.57	63.74N	212.42E	==>	-32.92	
2400.00	13.75	73.300	2373.71	70.57N	235.19E	==>	-36.45	
2500.00	13.75	73.300	2470.84	77.40N	257.96E	==>	-39.98	
2600.00	13.75	73.300	2567.97	84.24N	280.73E	==>	-43.51	
2700.00	13.75	73.300	2665.11	91.07N	303.51E	==>	-47.04	
2800.00	13.75	73.300	2762.24	97.90N	326.28E	==>	-50.57	
2900.00	13.75	73.300	2859.37	104.74N	349.05E	==>	-54.10	
3000.00	13.75	73.300	2956.50	111.57N	371.82E	==>	-57.63	

All data is in Feet unless otherwise stated
Coordinates are from Slot MD's are from Rig and TVD's are from Rig (Planned Datum #1 4934.0ft above Mean Sea Level)
Vertical Section is from 0.00N 0.00E on azimuth 171.830 degrees
Bottom hole distance is 9946.72 Feet on azimuth 171.83 degrees from Wellhead
Calculation method uses Minimum Curvature method
Prepared by Microsoft
Date Printed: 27-Mar-2018



SYS DRILL
Well Design Combined Report
Wellbore: W EAST AULT U-18-19HN (PWB)



Interpolated Wellpath								
MD[ft]	Inc[deg]	Azi[deg]	TVD[ft]	North[ft]	East[ft]	Dogleg [deg/100ft]	Vertical Section[ft]	All Station Comments
3100.00	13.75	73.300	3053.64	118.40N	394.59E	==>	-61.16	
3200.00	13.75	73.300	3150.77	125.24N	417.36E	==>	-64.68	
3300.00	13.75	73.300	3247.90	132.07N	440.14E	==>	-68.21	
3400.00	13.75	73.300	3345.03	138.90N	462.91E	==>	-71.74	
3500.00	13.75	73.300	3442.17	145.73N	485.68E	==>	-75.27	
3600.00	13.75	73.300	3539.30	152.57N	508.45E	==>	-78.80	
3700.00	13.75	73.300	3636.43	159.40N	531.22E	==>	-82.33	
3800.00	13.75	73.300	3733.57	166.23N	553.99E	==>	-85.86	
3900.00	13.75	73.300	3830.70	173.07N	576.77E	==>	-89.39	
4000.00	13.75	73.300	3927.83	179.90N	599.54E	==>	-92.92	
4100.00	13.75	73.300	4024.96	186.73N	622.31E	==>	-96.45	
4200.00	13.75	73.300	4122.10	193.56N	645.08E	==>	-99.98	
4300.00	13.75	73.300	4219.23	200.40N	667.85E	==>	-103.51	
4400.00	13.75	73.300	4316.36	207.23N	690.62E	==>	-107.04	
4500.00	13.75	73.300	4413.49	214.06N	713.40E	==>	-110.56	
4600.00	13.75	73.300	4510.63	220.90N	736.17E	==>	-114.09	
4700.00	13.75	73.300	4607.76	227.73N	758.94E	==>	-117.62	
4800.00	13.75	73.300	4704.89	234.56N	781.71E	==>	-121.15	
4900.00	13.75	73.300	4802.02	241.39N	804.48E	==>	-124.68	
5000.00	13.75	73.300	4899.16	248.23N	827.25E	==>	-128.21	
5100.00	13.75	73.300	4996.29	255.06N	850.03E	==>	-131.74	
5200.00	13.75	73.300	5093.42	261.89N	872.80E	==>	-135.27	
5300.00	13.75	73.300	5190.56	268.73N	895.57E	==>	-138.80	
5400.00	13.75	73.300	5287.69	275.56N	918.34E	==>	-142.33	
5500.00	13.75	73.300	5384.82	282.39N	941.11E	==>	-145.86	
5600.00	13.75	73.300	5481.95	289.22N	963.88E	==>	-149.39	
5700.00	13.75	73.300	5579.09	296.06N	986.66E	==>	-152.92	
5800.00	13.75	73.300	5676.22	302.89N	1009.43E	==>	-156.45	
5900.00	13.75	73.300	5773.35	309.72N	1032.20E	==>	-159.97	
6000.00	13.75	73.300	5870.48	316.56N	1054.97E	==>	-163.50	
6100.00	13.75	73.300	5967.62	323.39N	1077.74E	==>	-167.03	
6200.00	13.75	73.300	6064.75	330.22N	1100.51E	==>	-170.56	
6300.00	13.75	73.300	6161.88	337.06N	1123.29E	==>	-174.09	
6400.00	13.75	73.300	6259.02	343.89N	1146.06E	==>	-177.62	
6500.00	13.75	73.300	6356.15	350.72N	1168.83E	==>	-181.15	
6600.00	13.75	73.300	6453.28	357.55N	1191.60E	==>	-184.68	
6700.00	13.75	73.300	6550.41	364.39N	1214.37E	==>	-188.21	
6800.00	13.53	77.050	6647.55	371.15N	1237.14E	10.00	-191.67	
6900.00	14.95	118.180	6744.72	367.67N	1259.97E	10.00	-184.98	
7000.00	21.45	143.060	6839.80	346.91N	1282.39E	10.00	-161.25	
7100.00	29.89	155.630	6929.92	309.51N	1303.71E	10.00	-121.19	
7200.00	39.02	162.900	7012.33	256.59N	1323.30E	10.00	-66.03	
7300.00	48.45	167.730	7084.52	189.77N	1340.55E	10.00	2.56	
7400.00	58.03	171.320	7144.31	111.07N	1354.94E	10.00	82.50	
7500.00	67.70	174.210	7189.87	22.89N	1366.03E	10.00	171.37	
7600.00	77.40	176.730	7219.83	72.09S	1373.49E	10.00	266.44	
7700.00	87.13	179.070	7233.27	170.99S	1377.10E	10.00	364.85	
7800.00	90.21	179.790	7233.75	270.97S	1377.66E	==>	463.90	
7900.00	90.21	179.790	7233.39	370.97S	1378.03E	==>	562.94	
8000.00	90.21	179.790	7233.03	470.97S	1378.40E	==>	661.98	
8100.00	90.21	179.790	7232.66	570.97S	1378.76E	==>	761.01	
8200.00	90.21	179.790	7232.30	670.97S	1379.13E	==>	860.05	
8300.00	90.21	179.790	7231.94	770.97S	1379.50E	==>	959.09	
8400.00	90.21	179.790	7231.57	870.97S	1379.86E	==>	1058.13	
8500.00	90.21	179.790	7231.21	970.96S	1380.23E	==>	1157.16	
8600.00	90.21	179.790	7230.85	1070.96S	1380.60E	==>	1256.20	
8700.00	90.21	179.790	7230.49	1170.96S	1380.96E	==>	1355.24	
8800.00	90.21	179.790	7230.12	1270.96S	1381.33E	==>	1454.27	
8900.00	90.21	179.790	7229.76	1370.96S	1381.70E	==>	1553.31	

All data is in Feet unless otherwise stated
Coordinates are from Slot MD's are from Rig and TVD's are from Rig (Planned Datum #1 4934.0ft above Mean Sea Level)
Vertical Section is from 0.00N 0.00E on azimuth 171.830 degrees
Bottom hole distance is 9946.72 Feet on azimuth 171.83 degrees from Wellhead
Calculation method uses Minimum Curvature method
Prepared by Microsoft
Date Printed: 27-Mar-2018



SYSDRILL
Well Design Combined Report
Wellbore: W EAST AULT U-18-19HN (PWB)



Interpolated Wellpath								
MD[ft]	Inc[deg]	Azi[deg]	TVD[ft]	North[ft]	East[ft]	Dogleg [deg/100ft]	Vertical Section[ft]	All Station Comments
9000.00	90.21	179.790	7229.40	1470.96S	1382.07E	==>	1652.35	
9100.00	90.21	179.790	7229.03	1570.96S	1382.43E	==>	1751.38	
9200.00	90.21	179.790	7228.67	1670.95S	1382.80E	==>	1850.42	
9300.00	90.21	179.790	7228.31	1770.95S	1383.17E	==>	1949.46	
9400.00	90.21	179.790	7227.94	1870.95S	1383.53E	==>	2048.49	
9500.00	90.21	179.790	7227.58	1970.95S	1383.90E	==>	2147.53	
9600.00	90.21	179.790	7227.22	2070.95S	1384.27E	==>	2246.57	
9700.00	90.21	179.790	7226.86	2170.95S	1384.63E	==>	2345.61	
9800.00	90.21	179.790	7226.49	2270.95S	1385.00E	==>	2444.64	
9900.00	90.21	179.790	7226.13	2370.95S	1385.37E	==>	2543.68	
10000.00	90.21	179.790	7225.77	2470.94S	1385.73E	==>	2642.72	
10100.00	90.21	179.790	7225.40	2570.94S	1386.10E	==>	2741.75	
10200.00	90.21	179.790	7225.04	2670.94S	1386.47E	==>	2840.79	
10300.00	90.21	179.790	7224.68	2770.94S	1386.83E	==>	2939.83	
10400.00	90.21	179.790	7224.32	2870.94S	1387.20E	==>	3038.86	
10500.00	90.21	179.790	7223.95	2970.94S	1387.57E	==>	3137.90	
10600.00	90.21	179.790	7223.59	3070.94S	1387.94E	==>	3236.94	
10700.00	90.21	179.790	7223.23	3170.93S	1388.30E	==>	3335.98	
10800.00	90.21	179.790	7222.86	3270.93S	1388.67E	==>	3435.01	
10900.00	90.21	179.790	7222.50	3370.93S	1389.04E	==>	3534.05	
11000.00	90.21	179.790	7222.14	3470.93S	1389.40E	==>	3633.09	
11100.00	90.21	179.790	7221.77	3570.93S	1389.77E	==>	3732.12	
11200.00	90.21	179.790	7221.41	3670.93S	1390.14E	==>	3831.16	
11300.00	90.21	179.790	7221.05	3770.93S	1390.50E	==>	3930.20	
11400.00	90.21	179.790	7220.69	3870.93S	1390.87E	==>	4029.23	
11500.00	90.21	179.790	7220.32	3970.92S	1391.24E	==>	4128.27	
11600.00	90.21	179.790	7219.96	4070.92S	1391.60E	==>	4227.31	
11700.00	90.21	179.790	7219.60	4170.92S	1391.97E	==>	4326.34	
11800.00	90.21	179.790	7219.23	4270.92S	1392.34E	==>	4425.38	
11900.00	90.21	179.790	7218.87	4370.92S	1392.70E	==>	4524.42	
12000.00	90.21	179.790	7218.51	4470.92S	1393.07E	==>	4623.46	
12100.00	90.21	179.790	7218.15	4570.92S	1393.44E	==>	4722.49	
12200.00	90.21	179.790	7217.78	4670.91S	1393.81E	==>	4821.53	
12300.00	90.21	179.790	7217.42	4770.91S	1394.17E	==>	4920.57	
12400.00	90.21	179.790	7217.06	4870.91S	1394.54E	==>	5019.60	
12500.00	90.21	179.790	7216.69	4970.91S	1394.91E	==>	5118.64	
12600.00	90.21	179.790	7216.33	5070.91S	1395.27E	==>	5217.68	
12700.00	90.21	179.790	7215.97	5170.91S	1395.64E	==>	5316.71	
12800.00	90.21	179.790	7215.60	5270.91S	1396.01E	==>	5415.75	
12900.00	90.21	179.790	7215.24	5370.91S	1396.37E	==>	5514.79	
13000.00	90.21	179.790	7214.88	5470.90S	1396.74E	==>	5613.82	
13100.00	90.21	179.790	7214.52	5570.90S	1397.11E	==>	5712.86	
13200.00	90.21	179.790	7214.15	5670.90S	1397.47E	==>	5811.90	
13300.00	90.21	179.790	7213.79	5770.90S	1397.84E	==>	5910.94	
13400.00	90.21	179.790	7213.43	5870.90S	1398.21E	==>	6009.97	
13500.00	90.21	179.790	7213.06	5970.90S	1398.57E	==>	6109.01	
13600.00	90.21	179.790	7212.70	6070.90S	1398.94E	==>	6208.05	
13700.00	90.21	179.790	7212.34	6170.89S	1399.31E	==>	6307.08	
13800.00	90.21	179.790	7211.98	6270.89S	1399.68E	==>	6406.12	
13900.00	90.21	179.790	7211.61	6370.89S	1400.04E	==>	6505.16	
14000.00	90.21	179.790	7211.25	6470.89S	1400.41E	==>	6604.19	
14100.00	90.21	179.790	7210.89	6570.89S	1400.78E	==>	6703.23	
14200.00	90.21	179.790	7210.52	6670.89S	1401.14E	==>	6802.27	
14300.00	90.21	179.790	7210.16	6770.89S	1401.51E	==>	6901.30	
14400.00	90.21	179.790	7209.80	6870.89S	1401.88E	==>	7000.34	
14500.00	90.21	179.790	7209.43	6970.88S	1402.24E	==>	7099.38	
14600.00	90.21	179.790	7209.07	7070.88S	1402.61E	==>	7198.42	
14700.00	90.21	179.790	7208.71	7170.88S	1402.98E	==>	7297.45	
14800.00	90.21	179.790	7208.35	7270.88S	1403.34E	==>	7396.49	

All data is in Feet unless otherwise stated
Coordinates are from Slot MD's are from Rig and TVD's are from Rig (Planned Datum #1 4934.0ft above Mean Sea Level)
Vertical Section is from 0.00N 0.00E on azimuth 171.830 degrees
Bottom hole distance is 9946.72 Feet on azimuth 171.83 degrees from Wellhead
Calculation method uses Minimum Curvature method
Prepared by Microsoft
Date Printed: 27-Mar-2018



SYS DRILL
Well Design Combined Report
Wellbore: W EAST AULT U-18-19HN (PWB)



Interpolated Wellpath								
MD[ft]	Inc[deg]	Azi[deg]	TVD[ft]	North[ft]	East[ft]	Dogleg [deg/100ft]	Vertical Section[ft]	All Station Comments
14900.00	90.21	179.790	7207.98	7370.88S	1403.71E	==>	7495.53	
15000.00	90.21	179.790	7207.62	7470.88S	1404.08E	==>	7594.56	
15100.00	90.21	179.790	7207.26	7570.88S	1404.44E	==>	7693.60	
15200.00	90.21	179.790	7206.89	7670.87S	1404.81E	==>	7792.64	
15300.00	90.21	179.790	7206.53	7770.87S	1405.18E	==>	7891.67	
15400.00	90.21	179.790	7206.17	7870.87S	1405.55E	==>	7990.71	
15500.00	90.21	179.790	7205.81	7970.87S	1405.91E	==>	8089.75	
15600.00	90.21	179.790	7205.44	8070.87S	1406.28E	==>	8188.79	
15700.00	90.21	179.790	7205.08	8170.87S	1406.65E	==>	8287.82	
15800.00	90.21	179.790	7204.72	8270.87S	1407.01E	==>	8386.86	
15900.00	90.21	179.790	7204.35	8370.87S	1407.38E	==>	8485.90	
16000.00	90.21	179.790	7203.99	8470.86S	1407.75E	==>	8584.93	
16100.00	90.21	179.790	7203.63	8570.86S	1408.11E	==>	8683.97	
16200.00	90.21	179.790	7203.26	8670.86S	1408.48E	==>	8783.01	
16300.00	90.21	179.790	7202.90	8770.86S	1408.85E	==>	8882.04	
16400.00	90.21	179.790	7202.54	8870.86S	1409.21E	==>	8981.08	
16500.00	90.21	179.790	7202.18	8970.86S	1409.58E	==>	9080.12	
16600.00	90.21	179.790	7201.81	9070.86S	1409.95E	==>	9179.15	
16700.00	90.21	179.790	7201.45	9170.85S	1410.31E	==>	9278.19	
16800.00	90.21	179.790	7201.09	9270.85S	1410.68E	==>	9377.23	
16900.00	90.21	179.790	7200.72	9370.85S	1411.05E	==>	9476.27	
17000.00	90.21	179.790	7200.36	9470.85S	1411.42E	==>	9575.30	
17100.00	90.21	179.790	7200.00	9570.85S	1411.78E	==>	9674.34	
17200.00	90.21	179.790	7199.64	9670.85S	1412.15E	==>	9773.38	
17300.00	90.21	179.790	7199.27	9770.85S	1412.52E	==>	9872.41	
17375.03	90.21	179.790	7199.00	9845.88S	1412.79E	==>	9946.72	

All data is in Feet unless otherwise stated
Coordinates are from Slot MD's are from Rig and TVD's are from Rig (Planned Datum #1 4934.0ft above Mean Sea Level)
Vertical Section is from 0.00N 0.00E on azimuth 171.830 degrees
Bottom hole distance is 9946.72 Feet on azimuth 171.83 degrees from Wellhead
Calculation method uses Minimum Curvature method
Prepared by Microsoft
Date Printed: 27-Mar-2018



SYSDRILL
Well Design Combined Report
Wellbore: W EAST AULT U-18-19HN (PWB)



Targets							
Name	North[ft]	East[ft]	TVD[ft]	Latitude	Longitude	Northing	Easting
EAST AULT U-18-19HN - BHL	9845.88S	1412.79E	7199.00	40.55461200	-104.69957300	1445889.91	3222415.76
EAST AULT U-18-19HN - EP	202.56S	1377.41E	7234.00	40.58108100	-104.69938700	1455532.95	3222380.38

Survey Tool Program					
Reference	Survey Name	MD[ft]	TVD[ft]	Survey Tool	Error Model
620345	Planned	1500.00	1497.83	WdW Rate Gyro	Standard
620344	Planned	17375.03	7199.00	ISCWSA MWD	Rev 4 + SAG + FLT

Notes