

Extraction Oil & Gas
Project: Weld County, CO (NAD83)
Site: Sec 32-T6N-R65W
Well: WS-SUNRISE C1-5-5
Wellbore: Wellbore #1
Plan: Plan #1 (WS-SUNRISE C1-5-5/Wellbore #1)
P346



WELL DETAILS: WS-SUNRISE C1-5-5

Ground Elevation:: 4641.00
RKB Elevation: KB=25 @ 4666.00ft (P346)
Rig Name: P346

Northing	Easting	Latitude	Longitude
1403154.39	3227208.94	40.437190	-104.683740

Planned Section Details									
Sec	MD	Inc	Azi	TVD	+N/-S	+E/-W	Dleg	TFace	Vsect
1	1519.00	3.99	123.28	1517.69	-10.26	37.39	0.00	0.00	12.32
2	1619.00	3.99	123.28	1617.45	-14.08	43.20	0.00	0.00	16.46
3	1676.08	4.95	115.32	1674.35	-16.22	47.09	2.00	-36.84	18.82
4	5723.34	4.95	115.32	5706.51	-165.63	362.82	0.00	0.00	185.56
5	5970.89	0.00	0.00	5953.76	-170.20	372.48	2.00	-180.00	190.67
6	6483.95	0.00	0.00	6466.82	-170.20	372.48	0.00	0.00	190.67
7	7383.92	90.00	180.79	7039.77	-743.08	364.61	10.00	180.79	762.22
8	12036.56	90.00	180.79	7040.00	-5395.28	300.69	0.00	0.00	5403.65

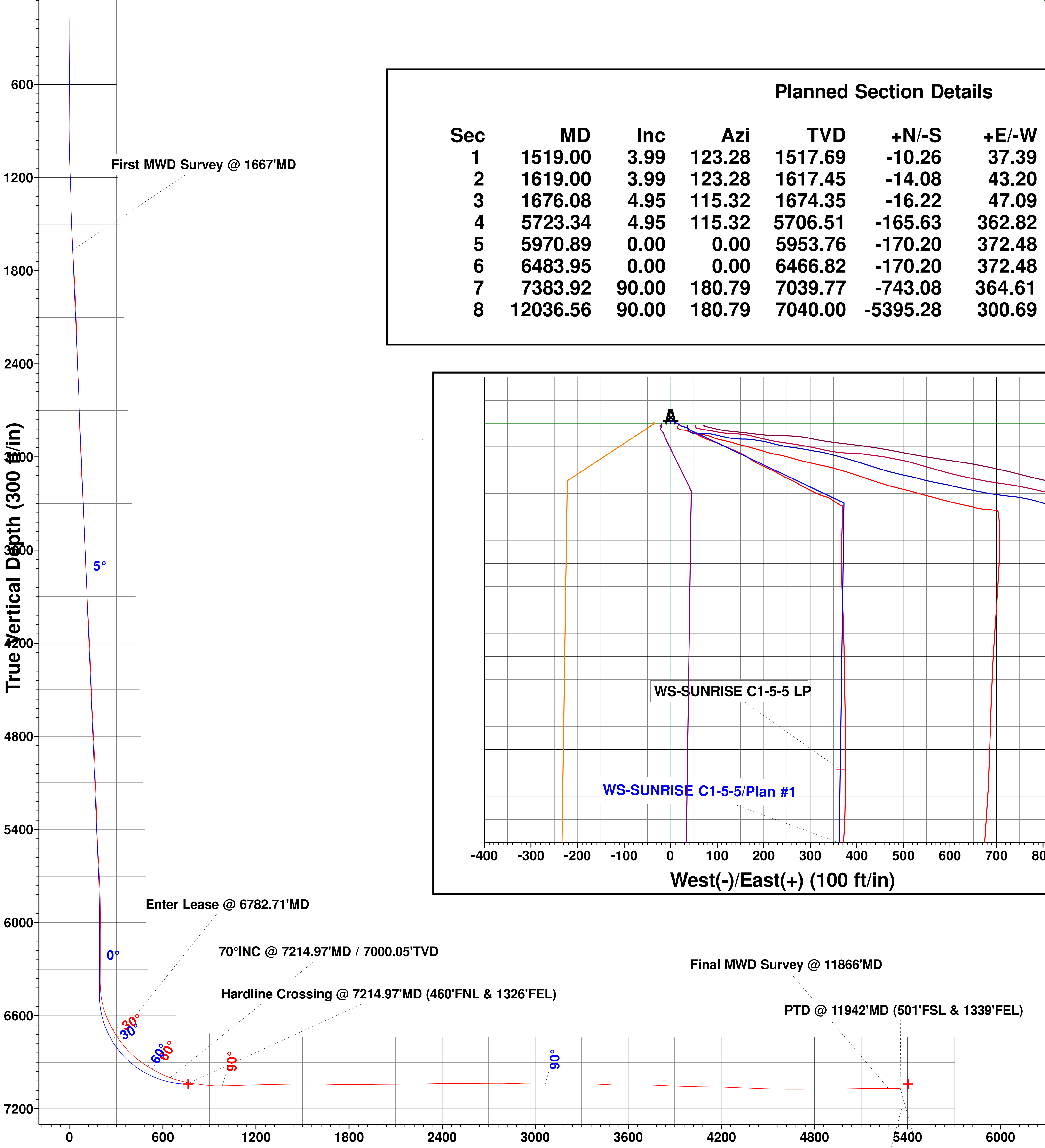

Vertical Section at 176.81° (300 ft/in)

WS-SUNRISE C1-5-5/Plan #1
WS-SUNRISE C1-5-5/Wellbore #1

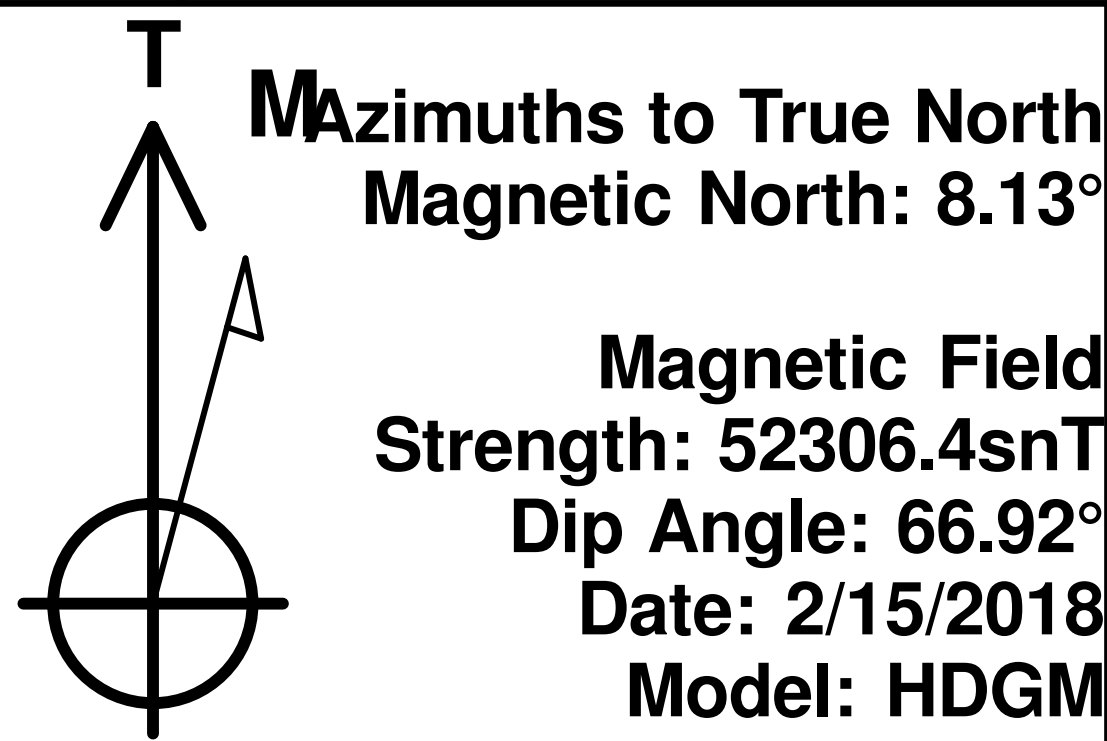

PROJECT DETAILS: Weld County, CO (NAD83)
Geodetic System: US State Plane 1983
Datum: North American Datum 1983
Ellipsoid: GRS 1980
Zone: Colorado Northern Zone
System Datum: Ground Level
Local North: True

