

Location:	COLORADO	Slot:	SLOT#14 STATE PRONGHORN W42-29-30XRLNB (1378'FNL & 547'FWL, SEC.28)
Field:	WELD COUNTY	Well:	STATE PRONGHORN W42-29-30XRLNB
Facility:	SEC.28-T05N-R61W	Wellbore:	STATE PRONGHORN W42-29-30XRLNB PWB

Plot reference wellpath is STATE PRONGHORN W42-29-30XRLNB PWP (REV-B.0)	Grid System: NAD83 / Lambert Colorado SP, Northern Zone (501), US feet
True vertical depths are referenced to RIG (17KB) (RKB)	* = Wellpath was transformed from a different geodetic datum
Measured depths are referenced to RIG (17KB) (RKB)	North Reference: True north
RIG (17KB) (RKB) to Mean Sea Level: 4635 feet	Scale: True distance
Mean Sea Level to Mud line (At Slot: SLOTF14 STATE PRONGHORN W42-29-30XRLNB (1378 FNL & 547FWL, SEC.28)): 0 feet	Depths are in feet
Coordinates are in feet referenced to Slot	Created by: ingnjamr on 2018-05-03
	Database: Denver

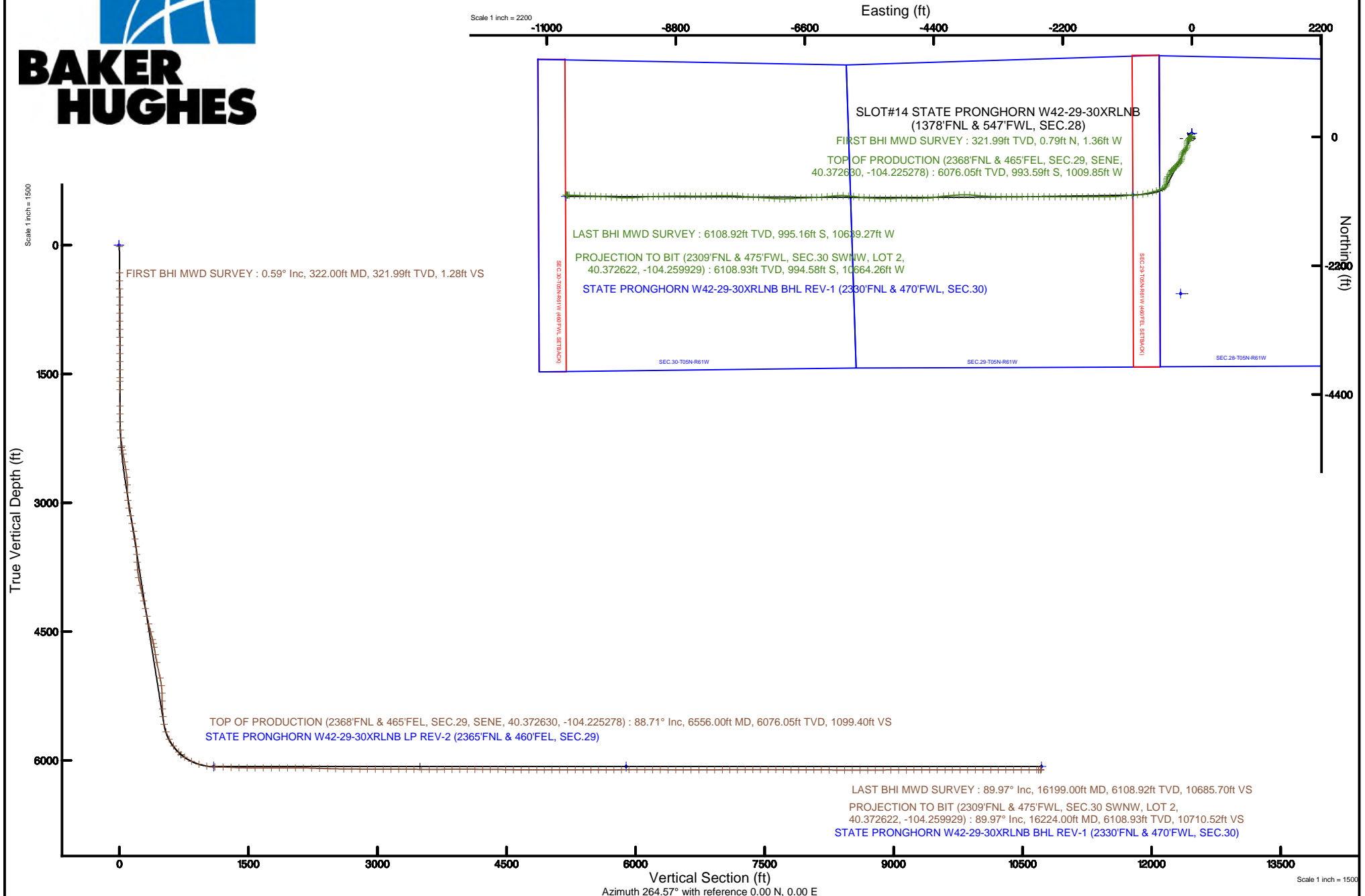



Actual Wellpath Report

STATE PRONGHORN W42-29-30XRLNB AWP

Page 1 of 8



REFERENCE WELLPATH IDENTIFICATION

Operator	BONANZA CREEK OIL COMPANY	Slot	SLOT#14 STATE PRONGHORN W42-29-30XRLNB (1378'FNL & 547'FWL, SEC.28)
Area	COLORADO	Well	STATE PRONGHORN W42-29-30XRLNB
Field	WELD COUNTY	Wellbore	STATE PRONGHORN W42-29-30XRLNB AWB
Facility	SEC.28-T05N-R61W		

REPORT SETUP INFORMATION

Projection System	NAD83 / Lambert Colorado SP, Northern Zone (501), US feet	Software System	WellArchitect® 5.0
North Reference	True	User	Ingmjmr
Scale	0.999959	Report Generated	5/3/2018 at 12:57:03 PM
Convergence at slot	0.83° East	Database/Source file	Denver/STATE_PRONGHORN_W42-29-30XRLNB_AWP.xml

WELLPATH LOCATION

	Local coordinates		Grid coordinates		Geographic coordinates	
	North[ft]	East[ft]	Easting[US ft]	Northing[US ft]	Latitude	Longitude
Slot Location	28.05	157.70	3356149.68	1382150.24	40°22'31.285"N	104°13'17.954"W
Facility Reference Pt			3355992.41	1382119.92	40°22'31.008"N	104°13'19.992"W
Field Reference Pt			3224525.77	1254425.87	40°01'44.400"N	104°41'53.556"W

WELLPATH DATUM

Calculation method	Minimum curvature	RIG (17'KB) (RKB) to Facility Vertical Datum	4635.00ft
Horizontal Reference Pt	Slot	RIG (17'KB) (RKB) to Mean Sea Level	4635.00ft
Vertical Reference Pt	RIG (17'KB) (RKB)	RIG (17'KB) (RKB) to Mud Line at Slot (SLOT#14 STATE PRONGHORN W42-29-30XRLNB (1378'FNL & 547'FWL, SEC.28))	4635.00ft
MD Reference Pt	RIG (17'KB) (RKB)	Section Origin	N 0.00, E 0.00 ft
Field Vertical Reference	Mean Sea Level	Section Azimuth	264.57°



Actual Wellpath Report

STATE PRONGHORN W42-29-30XRLNB AWP

Page 2 of 8



REFERENCE WELLPATH IDENTIFICATION

Operator	BONANZA CREEK OIL COMPANY	Slot	SLOT#14 STATE PRONGHORN W42-29-30XRLNB (1378'FNL & 547'FWL, SEC.28)
Area	COLORADO	Well	STATE PRONGHORN W42-29-30XRLNB
Field	WELD COUNTY	Wellbore	STATE PRONGHORN W42-29-30XRLNB AWP
Facility	SEC.28-T05N-R61W		

WELLPATH DATA (179 stations) † = interpolated/extrapolated station

MD [ft]	Inclination [°]	Azimuth [°]	TVD [ft]	Vert Sect [ft]	North [ft]	East [ft]	Latitude	Longitude	DLS [°/100ft]	Comments
0.00†	0.000	300.000	0.00	0.00	0.00	0.00	40°22'31.285°N	104°13'17.954°W	0.00	
17.00	0.000	300.000	17.00	0.00	0.00	0.00	40°22'31.285°N	104°13'17.954°W	0.00	
322.00	0.590	300.000	321.99	1.28	0.79	-1.36	40°22'31.293°N	104°13'17.972°W	0.19	FIRST BHI MWD SURVEY
416.00	0.360	286.750	415.99	1.95	1.11	-2.06	40°22'31.296°N	104°13'17.981°W	0.27	
510.00	0.430	288.420	509.99	2.54	1.31	-2.68	40°22'31.298°N	104°13'17.989°W	0.08	
604.00	0.660	184.310	603.99	2.96	0.88	-3.05	40°22'31.294°N	104°13'17.994°W	0.93	
698.00	0.690	199.990	697.98	3.29	-0.19	-3.29	40°22'31.283°N	104°13'17.997°W	0.20	
792.00	0.500	214.030	791.97	3.80	-1.06	-3.71	40°22'31.275°N	104°13'18.002°W	0.25	
886.00	0.530	219.270	885.97	4.36	-1.74	-4.22	40°22'31.268°N	104°13'18.009°W	0.06	
980.00	0.410	202.280	979.97	4.82	-2.39	-4.62	40°22'31.262°N	104°13'18.014°W	0.19	
1074.00	0.570	180.750	1073.96	5.03	-3.17	-4.75	40°22'31.254°N	104°13'18.016°W	0.26	
1168.00	0.460	170.970	1167.96	5.06	-4.01	-4.70	40°22'31.246°N	104°13'18.015°W	0.15	
1262.00	0.460	230.560	1261.96	5.35	-4.62	-4.93	40°22'31.240°N	104°13'18.018°W	0.49	
1356.00	0.310	301.800	1355.96	5.86	-4.72	-5.44	40°22'31.239°N	104°13'18.025°W	0.49	
1450.00	0.500	308.600	1449.95	6.36	-4.33	-5.98	40°22'31.242°N	104°13'18.032°W	0.21	
1544.00	0.160	172.550	1543.95	6.65	-4.21	-6.28	40°22'31.244°N	104°13'18.036°W	0.67	
1585.00	0.200	168.460	1584.95	6.64	-4.34	-6.26	40°22'31.242°N	104°13'18.035°W	0.10	
1684.00	0.140	107.980	1683.95	6.51	-4.54	-6.11	40°22'31.240°N	104°13'18.033°W	0.18	
1872.00	0.870	192.560	1871.95	6.74	-6.01	-6.20	40°22'31.226°N	104°13'18.035°W	0.46	
1965.00	0.960	156.900	1964.93	6.72	-7.41	-6.05	40°22'31.212°N	104°13'18.033°W	0.61	
2059.00	1.350	211.510	2058.92	7.15	-9.08	-6.32	40°22'31.195°N	104°13'18.036°W	1.19	
2153.00	3.250	248.670	2152.84	10.38	-10.99	-9.38	40°22'31.177°N	104°13'18.076°W	2.47	
2247.00	5.930	250.460	2246.53	17.65	-13.59	-16.44	40°22'31.151°N	104°13'18.167°W	2.85	
2340.00	7.470	249.880	2338.89	28.16	-17.27	-26.64	40°22'31.115°N	104°13'18.299°W	1.66	
2387.00	9.360	243.860	2385.39	34.69	-20.01	-32.94	40°22'31.087°N	104°13'18.380°W	4.43	
2434.00	11.280	232.000	2431.63	42.14	-24.52	-40.00	40°22'31.043°N	104°13'18.471°W	6.07	
2528.00	14.740	219.430	2523.22	58.33	-39.43	-54.85	40°22'30.896°N	104°13'18.663°W	4.73	
2623.00	17.480	206.090	2614.51	74.33	-61.59	-68.80	40°22'30.677°N	104°13'18.843°W	4.83	
2717.00	19.550	192.300	2703.69	86.51	-89.65	-78.37	40°22'30.399°N	104°13'18.967°W	5.14	
2810.00	17.620	171.810	2791.93	90.57	-118.82	-79.68	40°22'30.111°N	104°13'18.984°W	7.28	



Actual Wellpath Report

STATE PRONGHORN W42-29-30XRLNB AWP

Page 3 of 8



REFERENCE WELLPATH IDENTIFICATION			
Operator	BONANZA CREEK OIL COMPANY	Slot	SLOT#14 STATE PRONGHORN W42-29-30XRLNB (1378'FNL & 547'FWL, SEC.28)
Area	COLORADO	Well	STATE PRONGHORN W42-29-30XRLNB
Field	WELD COUNTY	Wellbore	STATE PRONGHORN W42-29-30XRLNB AWP
Facility	SEC.28-T05N-R61W		

WELLPATH DATA (179 stations)										
MD [ft]	Inclination [°]	Azimuth [°]	TVD [ft]	Vert Sect [ft]	North [ft]	East [ft]	Latitude	Longitude	DLS [°/100ft]	Comments
2904.00	16.330	181.270	2881.85	91.43	-146.12	-77.95	40°22'29.841"N	104°13'18.961"W	3.24	
2998.00	16.580	196.020	2972.04	97.88	-172.23	-81.94	40°22'29.583"N	104°13'19.013"W	4.44	
3091.00	15.840	210.490	3061.37	110.19	-195.94	-92.05	40°22'29.349"N	104°13'19.144"W	4.40	
3185.00	15.960	224.360	3151.81	127.59	-216.24	-107.60	40°22'29.148"N	104°13'19.345"W	4.04	
3279.00	16.530	223.930	3242.06	147.61	-235.11	-125.91	40°22'28.962"N	104°13'19.581"W	0.62	
3373.00	16.530	212.440	3332.20	165.97	-256.03	-142.37	40°22'28.755"N	104°13'19.794"W	3.47	
3467.00	16.640	208.050	3422.29	181.61	-279.19	-155.87	40°22'28.526"N	104°13'19.968"W	1.34	
3561.00	17.330	197.120	3512.21	194.41	-304.46	-166.32	40°22'28.277"N	104°13'20.103"W	3.47	
3655.00	16.950	182.940	3602.08	201.78	-331.53	-171.15	40°22'28.009"N	104°13'20.166"W	4.45	
3749.00	16.710	182.920	3692.05	205.73	-358.72	-172.54	40°22'27.740"N	104°13'20.184"W	0.26	
3843.00	16.490	194.140	3782.16	212.17	-385.15	-176.49	40°22'27.479"N	104°13'20.235"W	3.41	
3937.00	16.360	210.220	3872.37	224.36	-409.54	-186.41	40°22'27.238"N	104°13'20.363"W	4.82	
4030.00	16.560	222.420	3961.58	241.83	-430.65	-201.95	40°22'27.030"N	104°13'20.564"W	3.72	
4124.00	16.650	221.490	4051.66	261.60	-450.63	-219.91	40°22'26.832"N	104°13'20.796"W	0.30	
4218.00	16.730	221.420	4141.70	281.30	-470.86	-237.78	40°22'26.632"N	104°13'21.027"W	0.09	
4312.00	16.580	219.760	4231.76	300.69	-491.32	-255.31	40°22'26.430"N	104°13'21.253"W	0.53	
4406.00	16.150	219.600	4321.95	319.46	-511.70	-272.22	40°22'26.229"N	104°13'21.472"W	0.46	
4499.00	15.800	231.940	4411.39	339.28	-529.48	-290.44	40°22'26.053"N	104°13'21.707"W	3.66	
4593.00	16.770	231.060	4501.61	361.36	-545.89	-311.06	40°22'25.891"N	104°13'21.973"W	1.06	
4687.00	17.890	224.890	4591.35	383.79	-564.64	-331.80	40°22'25.706"N	104°13'22.241"W	2.29	
4738.00	17.800	217.080	4639.91	395.08	-576.41	-342.03	40°22'25.589"N	104°13'22.374"W	4.69	
4781.00	18.000	211.230	4680.83	403.49	-587.34	-349.44	40°22'25.481"N	104°13'22.469"W	4.21	
4875.00	17.540	202.340	4770.36	418.77	-612.86	-362.36	40°22'25.229"N	104°13'22.636"W	2.92	
4969.00	17.550	215.620	4860.02	434.68	-637.50	-376.00	40°22'24.986"N	104°13'22.812"W	4.25	
5157.00	17.790	216.490	5039.15	472.49	-683.63	-409.59	40°22'24.530"N	104°13'23.246"W	0.19	
5251.00	17.130	201.470	5128.87	488.36	-708.07	-423.20	40°22'24.288"N	104°13'23.422"W	4.83	
5344.00	16.490	176.950	5218.01	495.11	-734.03	-427.52	40°22'24.032"N	104°13'23.478"W	7.60	
5438.00	16.340	177.720	5308.18	496.39	-760.56	-426.28	40°22'23.770"N	104°13'23.462"W	0.28	
5532.00	16.450	185.940	5398.37	499.75	-787.02	-427.14	40°22'23.508"N	104°13'23.473"W	2.47	
5626.00	16.560	195.040	5488.51	507.06	-813.19	-431.99	40°22'23.249"N	104°13'23.536"W	2.75	



Actual Wellpath Report

STATE PRONGHORN W42-29-30XRLNB AWP

Page 4 of 8



REFERENCE WELLPATH IDENTIFICATION			
Operator	BONANZA CREEK OIL COMPANY	Slot	SLOT#14 STATE PRONGHORN W42-29-30XRLNB (1378'FNL & 547'FWL, SEC.28)
Area	COLORADO	Well	STATE PRONGHORN W42-29-30XRLNB
Field	WELD COUNTY	Wellbore	STATE PRONGHORN W42-29-30XRLNB AWP
Facility	SEC.28-T05N-R61W		

WELLPATH DATA (179 stations) † = interpolated/extrapolated station										
MD (ft)	Inclination [°]	Azimuth [°]	TVD (ft)	Vert Sect (ft)	North (ft)	East (ft)	Latitude	Longitude	DLS [°/100ft]	Comments
5720.00	17.010	207.810	5578.53	519.29	-838.30	-441.88	40°22'23.001"N	104°13'23.664"W	3.94	
5814.00	21.810	237.150	5667.37	542.39	-860.00	-463.03	40°22'22.787"N	104°13'23.937"W	11.40	
5908.00	28.600	242.950	5752.39	578.86	-879.73	-497.78	40°22'22.592"N	104°13'24.386"W	7.68	
6002.00	37.540	246.940	5831.09	627.17	-901.22	-544.27	40°22'22.380"N	104°13'24.986"W	9.78	
6096.00	45.950	251.400	5901.18	687.48	-923.26	-602.75	40°22'22.162"N	104°13'25.742"W	9.48	
6190.00	54.600	255.920	5961.21	758.40	-943.40	-672.08	40°22'21.963"N	104°13'26.638"W	9.91	
6284.00	64.200	255.830	6009.01	838.29	-963.12	-750.45	40°22'21.768"N	104°13'27.650"W	10.21	
6378.00	71.920	262.600	6044.14	924.98	-979.28	-836.00	40°22'21.608"N	104°13'28.756"W	10.58	
6472.00	79.430	266.230	6067.38	1015.98	-988.09	-926.57	40°22'21.521"N	104°13'29.926"W	8.82	
6556.00†	88.715	266.212	6076.05	1099.40	-993.59	-1009.85	40°22'21.467"N	104°13'31.002"W	11.05	TOP OF PRODUCTION (2368'FNL & 465'FEL, SEC.29, SENE, 40.372630, -104.225278)
6566.00	89.820	266.210	6076.18	1109.40	-994.25	-1019.83	40°22'21.460"N	104°13'31.131"W	11.05	
6660.00	88.090	263.670	6077.89	1203.37	-1002.53	-1113.43	40°22'21.378"N	104°13'32.340"W	3.27	
6754.00	88.030	265.030	6081.07	1297.31	-1011.78	-1206.92	40°22'21.287"N	104°13'33.548"W	1.45	
6847.00	88.060	266.530	6084.25	1390.24	-1018.62	-1299.61	40°22'21.219"N	104°13'34.746"W	1.61	
6941.00	89.480	269.030	6086.27	1484.06	-1022.26	-1393.51	40°22'21.183"N	104°13'35.959"W	3.06	
7035.00	90.000	270.790	6086.69	1577.64	-1022.41	-1487.50	40°22'21.182"N	104°13'37.173"W	1.95	
7129.00	89.940	269.470	6086.74	1671.20	-1022.20	-1581.50	40°22'21.184"N	104°13'38.388"W	1.41	
7224.00	90.060	268.950	6086.74	1765.89	-1023.51	-1676.49	40°22'21.171"N	104°13'39.615"W	0.56	
7318.00	90.030	269.280	6086.67	1859.59	-1024.96	-1770.48	40°22'21.156"N	104°13'40.829"W	0.35	
7412.00	89.940	270.460	6086.69	1953.19	-1025.17	-1864.48	40°22'21.154"N	104°13'42.044"W	1.26	
7505.00	90.310	271.030	6086.49	2045.64	-1023.96	-1957.47	40°22'21.166"N	104°13'43.245"W	0.73	
7599.00	89.110	270.450	6086.97	2139.10	-1022.75	-2051.46	40°22'21.178"N	104°13'44.460"W	1.42	
7693.00	88.120	269.680	6089.24	2232.63	-1022.64	-2145.43	40°22'21.179"N	104°13'45.674"W	1.33	
7787.00	88.190	270.620	6092.26	2326.14	-1022.40	-2239.38	40°22'21.181"N	104°13'46.887"W	1.00	
7881.00	87.820	268.360	6095.54	2419.73	-1023.23	-2333.31	40°22'21.173"N	104°13'48.101"W	2.43	
7975.00	89.110	271.730	6098.06	2513.25	-1023.16	-2427.26	40°22'21.174"N	104°13'49.315"W	3.84	
8069.00	88.890	270.220	6099.70	2606.65	-1021.56	-2521.23	40°22'21.189"N	104°13'50.529"W	1.62	
8163.00	89.820	269.710	6100.75	2700.22	-1021.62	-2615.23	40°22'21.189"N	104°13'51.743"W	1.13	
8257.00	89.720	270.090	6101.13	2793.81	-1021.78	-2709.22	40°22'21.187"N	104°13'52.958"W	0.42	
8347.00	90.000	270.290	6101.35	2883.38	-1021.48	-2799.22	40°22'21.190"N	104°13'54.121"W	0.38	



Actual Wellpath Report

STATE PRONGHORN W42-29-30XRLNB AWP

Page 5 of 8



REFERENCE WELLPATH IDENTIFICATION			
Operator	BONANZA CREEK OIL COMPANY	Slot	SLOT#14 STATE PRONGHORN W42-29-30XRLNB (1378'FNL & 547'FWL, SEC.28)
Area	COLORADO	Well	STATE PRONGHORN W42-29-30XRLNB
Field	WELD COUNTY	Wellbore	STATE PRONGHORN W42-29-30XRLNB AWP
Facility	SEC.28-T05N-R61W		

WELLPATH DATA (179 stations)										
MD [ft]	Inclination [°]	Azimuth [°]	TVD [ft]	Vert Sect [ft]	North [ft]	East [ft]	Latitude	Longitude	DLS [°/100ft]	Comments
8439.00	89.970	269.310	6101.38	2974.99	-1021.80	-2891.22	40°22'21.186"N	104°13'55.309"W	1.07	
8531.00	89.970	270.270	6101.42	3066.61	-1022.14	-2983.22	40°22'21.183"N	104°13'56.498"W	1.04	
8621.00	89.540	269.500	6101.81	3156.22	-1022.32	-3073.22	40°22'21.181"N	104°13'57.661"W	0.98	
8711.00	89.540	270.430	6102.53	3245.82	-1022.37	-3163.21	40°22'21.180"N	104°13'58.824"W	1.03	
8801.00	89.690	271.060	6103.14	3335.29	-1021.20	-3253.20	40°22'21.192"N	104°13'59.986"W	0.72	
8890.00	89.850	272.170	6103.49	3423.62	-1018.70	-3342.17	40°22'21.217"N	104°14'01.136"W	1.26	
8979.00	89.690	271.480	6103.85	3511.90	-1015.86	-3431.12	40°22'21.244"N	104°14'02.285"W	0.80	
9070.00	90.060	272.600	6104.05	3602.13	-1012.62	-3522.06	40°22'21.276"N	104°14'03.460"W	1.30	
9160.00	90.180	275.350	6103.86	3690.91	-1006.38	-3611.84	40°22'21.338"N	104°14'04.620"W	3.06	
9250.00	90.180	276.030	6103.58	3779.22	-997.46	-3701.39	40°22'21.426"N	104°14'05.777"W	0.76	
9337.00	89.910	272.860	6103.51	3864.92	-990.72	-3788.12	40°22'21.492"N	104°14'06.897"W	3.66	
9428.00	90.150	269.010	6103.46	3955.34	-989.23	-3879.09	40°22'21.507"N	104°14'08.073"W	4.24	
9517.00	89.910	267.250	6103.42	4044.16	-992.14	-3968.04	40°22'21.478"N	104°14'09.222"W	2.00	
9605.00	89.880	265.320	6103.58	4132.12	-997.84	-4055.85	40°22'21.422"N	104°14'10.357"W	2.19	
9695.00	90.060	264.420	6103.62	4222.12	-1005.89	-4145.49	40°22'21.342"N	104°14'11.515"W	1.02	
9784.00	89.880	265.490	6103.67	4311.11	-1013.71	-4234.14	40°22'21.264"N	104°14'12.660"W	1.22	
9873.00	88.680	261.620	6104.79	4400.07	-1023.70	-4322.55	40°22'21.166"N	104°14'13.802"W	4.55	
9963.00	88.980	263.530	6106.63	4490.00	-1035.33	-4411.78	40°22'21.051"N	104°14'14.955"W	2.15	
10052.00	88.890	266.700	6108.28	4578.96	-1042.91	-4500.43	40°22'20.975"N	104°14'16.100"W	3.56	
10144.00	89.630	268.150	6109.47	4670.84	-1047.04	-4592.32	40°22'20.934"N	104°14'17.288"W	1.77	
10234.00	89.970	268.650	6109.78	4760.64	-1049.55	-4682.29	40°22'20.909"N	104°14'18.450"W	0.67	
10325.00	89.970	271.170	6109.83	4851.23	-1049.69	-4773.28	40°22'20.908"N	104°14'19.626"W	2.77	
10415.00	90.000	272.300	6109.85	4940.53	-1046.97	-4863.24	40°22'20.935"N	104°14'20.788"W	1.26	
10503.00	90.030	269.480	6109.83	5027.98	-1045.60	-4951.22	40°22'20.948"N	104°14'21.925"W	3.20	
10593.00	89.290	267.200	6110.37	5117.78	-1048.21	-5041.17	40°22'20.922"N	104°14'23.087"W	2.66	
10684.00	90.280	267.490	6110.71	5208.67	-1052.42	-5132.07	40°22'20.880"N	104°14'24.261"W	1.13	
10775.00	90.180	269.720	6110.34	5299.44	-1054.64	-5223.04	40°22'20.858"N	104°14'25.437"W	2.45	
10867.00	89.720	271.870	6110.42	5390.89	-1053.36	-5315.02	40°22'20.871"N	104°14'26.625"W	2.39	
10958.00	90.150	273.470	6110.53	5480.98	-1049.12	-5405.92	40°22'20.912"N	104°14'27.800"W	1.82	
11047.00	90.060	273.660	6110.36	5568.88	-1043.59	-5494.75	40°22'20.967"N	104°14'28.947"W	0.24	



Actual Wellpath Report

STATE PRONGHORN W42-29-30XRLNB AWP

Page 6 of 8



REFERENCE WELLPATH IDENTIFICATION

Operator	BONANZA CREEK OIL COMPANY	Slot	SLOT#14 STATE PRONGHORN W42-29-30XRLNB (1378'FNL & 547'FWL, SEC.28)
Area	COLORADO	Well	STATE PRONGHORN W42-29-30XRLNB
Field	WELD COUNTY	Wellbore	STATE PRONGHORN W42-29-30XRLNB AWB
Facility	SEC.28-T05N-R61W		

WELLPATH DATA (179 stations)

MD [ft]	Inclination [°]	Azimuth [°]	TVD [ft]	Vert Sect [ft]	North [ft]	East [ft]	Latitude	Longitude	DLS [°/100ft]	Comments
11139.00	90.280	274.640	6110.09	5659.60	-1036.93	-5586.51	40°22'21.032"N	104°14'30.133"W	1.09	
11229.00	90.370	276.560	6109.58	5747.93	-1028.15	-5676.07	40°22'21.119"N	104°14'31.290"W	2.14	
11319.00	91.170	276.750	6108.37	5835.92	-1017.72	-5765.46	40°22'21.222"N	104°14'32.445"W	0.91	
11409.00	89.850	275.400	6107.57	5924.11	-1008.20	-5854.94	40°22'21.316"N	104°14'33.601"W	2.10	
11501.00	89.820	270.920	6107.83	6015.05	-1003.13	-5946.78	40°22'21.366"N	104°14'34.788"W	4.87	
11593.00	89.880	267.480	6108.07	6106.74	-1004.41	-6038.76	40°22'21.353"N	104°14'35.976"W	3.74	
11683.00	89.850	263.660	6108.29	6196.70	-1011.36	-6128.47	40°22'21.284"N	104°14'37.135"W	4.24	
11773.00	89.910	263.990	6108.48	6286.70	-1021.04	-6217.95	40°22'21.188"N	104°14'38.291"W	0.37	
11864.00	89.850	267.070	6108.67	6377.67	-1028.13	-6308.66	40°22'21.118"N	104°14'39.463"W	3.39	
11954.00	89.850	267.380	6108.90	6467.58	-1032.49	-6398.55	40°22'21.074"N	104°14'40.624"W	0.34	
12042.00	89.750	267.340	6109.21	6555.47	-1036.54	-6486.46	40°22'21.034"N	104°14'41.760"W	0.12	
12132.00	90.000	267.290	6109.40	6645.37	-1040.76	-6576.36	40°22'20.992"N	104°14'42.922"W	0.28	
12224.00	90.310	267.110	6109.16	6737.27	-1045.25	-6668.25	40°22'20.947"N	104°14'44.109"W	0.39	
12315.00	90.090	266.730	6108.84	6828.19	-1050.14	-6759.12	40°22'20.899"N	104°14'45.283"W	0.48	
12406.00	90.000	266.680	6108.77	6919.13	-1055.37	-6849.97	40°22'20.847"N	104°14'46.457"W	0.11	
12495.00	90.220	269.160	6108.60	7007.97	-1058.60	-6938.90	40°22'20.815"N	104°14'47.606"W	2.80	
12583.00	90.000	271.580	6108.43	7095.51	-1058.04	-7026.89	40°22'20.820"N	104°14'48.743"W	2.76	
12673.00	90.150	274.430	6108.31	7184.53	-1053.32	-7116.76	40°22'20.867"N	104°14'49.904"W	3.17	
12763.00	90.030	274.070	6108.17	7273.24	-1046.65	-7206.51	40°22'20.932"N	104°14'51.063"W	0.42	
12854.00	90.120	274.130	6108.05	7362.99	-1040.14	-7297.28	40°22'20.996"N	104°14'52.236"W	0.12	
12943.00	90.090	273.560	6107.89	7450.82	-1034.17	-7386.08	40°22'21.055"N	104°14'53.383"W	0.64	
13034.00	90.150	273.710	6107.70	7540.68	-1028.41	-7476.90	40°22'21.112"N	104°14'54.557"W	0.18	
13124.00	89.630	273.760	6107.87	7629.53	-1022.54	-7566.70	40°22'21.169"N	104°14'55.717"W	0.58	
13213.00	89.750	273.920	6108.35	7717.37	-1016.58	-7655.50	40°22'21.228"N	104°14'56.864"W	0.22	
13304.00	89.720	273.500	6108.77	7807.21	-1010.69	-7746.31	40°22'21.286"N	104°14'58.038"W	0.46	
13393.00	89.750	272.280	6109.18	7895.27	-1006.21	-7835.19	40°22'21.330"N	104°14'59.186"W	1.37	
13480.00	89.690	270.590	6109.61	7981.64	-1004.03	-7922.16	40°22'21.351"N	104°15'00.310"W	1.94	
13570.00	89.690	268.720	6110.09	8071.28	-1004.57	-8012.16	40°22'21.346"N	104°15'01.473"W	2.08	
13660.00	89.780	268.770	6110.51	8161.04	-1006.54	-8102.13	40°22'21.326"N	104°15'02.635"W	0.11	
13750.00	89.690	268.470	6110.93	8250.82	-1008.71	-8192.11	40°22'21.304"N	104°15'03.798"W	0.35	



Actual Wellpath Report

STATE PRONGHORN W42-29-30XRLNB AWP

Page 7 of 8



REFERENCE WELLPATH IDENTIFICATION			
Operator	BONANZA CREEK OIL COMPANY	Slot	SLOT#14 STATE PRONGHORN W42-29-30XRLNB (1378'FNL & 547'FWL, SEC.28)
Area	COLORADO	Well	STATE PRONGHORN W42-29-30XRLNB
Field	WELD COUNTY	Wellbore	STATE PRONGHORN W42-29-30XRLNB AWP
Facility	SEC.28-T05N-R61W		

WELLPATH DATA (179 stations)										
MD [ft]	Inclination [°]	Azimuth [°]	TVD [ft]	Vert Sect [ft]	North [ft]	East [ft]	Latitude	Longitude	DLS [°/100ft]	Comments
13840.00	89.940	268.570	6111.22	8340.60	-1011.03	-8282.08	40°22'21.281"N	104°15'04.960"W	0.30	
13930.00	90.000	268.970	6111.26	8430.36	-1012.97	-8372.05	40°22'21.261"N	104°15'06.122"W	0.45	
14020.00	89.690	270.580	6111.51	8519.98	-1013.32	-8462.05	40°22'21.258"N	104°15'07.285"W	1.82	
14109.00	89.880	271.020	6111.84	8608.46	-1012.08	-8551.04	40°22'21.270"N	104°15'08.435"W	0.54	
14199.00	90.150	271.290	6111.82	8697.86	-1010.26	-8641.02	40°22'21.287"N	104°15'09.598"W	0.42	
14289.00	90.250	269.730	6111.50	8787.37	-1009.46	-8731.02	40°22'21.295"N	104°15'10.760"W	1.74	
14380.00	90.150	268.270	6111.19	8878.10	-1011.05	-8822.00	40°22'21.279"N	104°15'11.936"W	1.61	
14471.00	90.060	269.010	6111.02	8968.87	-1013.21	-8912.97	40°22'21.257"N	104°15'13.111"W	0.82	
14560.00	90.060	269.150	6110.93	9057.59	-1014.64	-9001.96	40°22'21.243"N	104°15'14.261"W	0.16	
14650.00	90.150	268.690	6110.76	9147.33	-1016.33	-9091.94	40°22'21.226"N	104°15'15.423"W	0.52	
14740.00	90.460	268.870	6110.28	9237.09	-1018.25	-9181.92	40°22'21.206"N	104°15'16.586"W	0.40	
14831.00	89.820	266.100	6110.06	9327.96	-1022.24	-9272.83	40°22'21.167"N	104°15'17.760"W	3.12	
14921.00	90.000	265.720	6110.20	9417.93	-1028.66	-9362.60	40°22'21.103"N	104°15'18.920"W	0.47	
15009.00	90.150	267.120	6110.09	9505.89	-1034.16	-9450.42	40°22'21.048"N	104°15'20.055"W	1.60	
15100.00	90.120	268.450	6109.87	9596.74	-1037.67	-9541.35	40°22'21.013"N	104°15'21.230"W	1.46	
15187.00	90.220	269.660	6109.61	9683.47	-1039.11	-9628.34	40°22'20.999"N	104°15'22.354"W	1.40	
15277.00	90.120	271.470	6109.35	9772.97	-1038.22	-9718.33	40°22'21.007"N	104°15'23.516"W	2.01	
15366.00	89.970	273.270	6109.28	9861.15	-1034.54	-9807.25	40°22'21.043"N	104°15'24.665"W	2.03	
15456.00	90.060	273.650	6109.25	9950.06	-1029.11	-9897.09	40°22'21.096"N	104°15'25.826"W	0.43	
15547.00	90.120	272.900	6109.11	10040.01	-1023.91	-9987.94	40°22'21.147"N	104°15'27.000"W	0.83	
15637.00	89.970	272.620	6109.04	10129.09	-1019.58	-10077.83	40°22'21.190"N	104°15'28.161"W	0.35	
15726.00	90.220	273.300	6108.89	10217.14	-1014.98	-10166.71	40°22'21.235"N	104°15'29.310"W	0.81	
15814.00	89.880	272.730	6108.82	10304.18	-1010.35	-10254.59	40°22'21.280"N	104°15'30.445"W	0.75	
15904.00	90.060	272.760	6108.86	10393.27	-1006.04	-10344.49	40°22'21.322"N	104°15'31.607"W	0.20	
15996.00	90.090	272.610	6108.74	10484.35	-1001.73	-10436.39	40°22'21.365"N	104°15'32.794"W	0.17	
16086.00	89.940	272.060	6108.72	10573.52	-998.07	-10526.31	40°22'21.400"N	104°15'33.956"W	0.63	
16176.00	89.850	271.040	6108.88	10662.85	-995.63	-10616.28	40°22'21.424"N	104°15'35.118"W	1.14	
16199.00	89.970	271.330	6108.92	10685.70	-995.16	-10639.27	40°22'21.429"N	104°15'35.415"W	1.36	LAST BHI MWD SURVEY
16224.00	89.970	271.330	6108.93	10710.52	-994.58	-10664.26	40°22'21.434"N	104°15'35.738"W	0.00	PROJECTION TO BIT (2309'FNL & 475'FWL, SEC.30 SWNW, LOT 2, 40.372622, -104.259929)

TARGETS								
Name	TVD [ft]	North [ft]	East [ft]	Grid East [US ft]	Grid North [US ft]	Latitude	Longitude	Shape
SEC.29-T05N-R61W	0.00	60.29	0.42	3356149.23	1382210.53	40°22'31.881"N	104°13'17.949"W	polygon
SEC.30-T05N-R61W	0.00	60.29	0.42	3356149.23	1382210.53	40°22'31.881"N	104°13'17.949"W	polygon
SEC.28-T05N-R61W	22.80	-2676.59	-191.16	3355997.14	1379471.29	40°22'04.836"N	104°13'20.424"W	polygon
STATE PRONGHORN W42-29-30XRLNB BHL REV-1 (2330'FNL & 470'FWL, SEC.30)	6071.00	-1014.75	-10669.60	3345496.28	1380981.83	40°22'21.235"N	104°15'35.807"W	point
STATE PRONGHORN W42-29-30XRLNB LP REV-2 (2365'FNL & 460'FWL, SEC.29)	6071.00	-992.25	-1004.58	3355159.55	1381143.65	40°22'21.480"N	104°13'30.934"W	point
STATE PRONGHORN W42-29-30XRLNB MID LATERAL REV-1 (2258'FNL & 0'FWL, SEC.29)	6071.00	-1032.36	-5818.57	3350346.85	1381034.16	40°22'21.077"N	104°14'33.131"W	point
SEC.29-T05N-R61W (460'FEL SETBACK)	6074.00	60.29	0.42	3356149.23	1382210.53	40°22'31.881"N	104°13'17.949"W	polygon
SEC.30-T05N-R61W (460'FWL SETBACK)	6074.00	60.29	0.42	3356149.23	1382210.53	40°22'31.881"N	104°13'17.949"W	polygon

WELLPATH COMPOSITION - Ref Wellbore: STATE PRONGHORN W42-29-30XRLNB AWP					Ref Wellpath: STATE PRONGHORN W42-29-30XRLNB AWP	
Start MD [ft]	End MD [ft]	Positional Uncertainty Model		Log Name/Comment		Wellbore
17.00	1585.00	Custom BHI NaviTrak (Standard Rotating) (Rockies 0.03Gt model)		13.5" HOLE BHI MWD NAVITRAK+SR+ROCKIES <322-1585>		STATE PRONGHORN W42-29-30XRLNB AWP
1585.00	16199.00	BHI Unknown Tool (Standard)		8.5" HOLE ATCURVE + SHORT+ROCKIES <1684-16199>		STATE PRONGHORN W42-29-30XRLNB AWP
16199.00	16224.00	Blind Drilling (std)		Projection to bit		STATE PRONGHORN W42-29-30XRLNB AWP



Actual Wellpath Report

STATE PRONGHORN W42-29-30XRLNB AWP

Page 8 of 8



REFERENCE WELLPATH IDENTIFICATION			
Operator	BONANZA CREEK OIL COMPANY	Slot	SLOT#14 STATE PRONGHORN W42-29-30XRLNB (1378'FNL & 547'FWL, SEC.28)
Area	COLORADO	Well	STATE PRONGHORN W42-29-30XRLNB
Field	WELD COUNTY	Wellbore	STATE PRONGHORN W42-29-30XRLNB AWB
Facility	SEC.28-T05N-R61W		

WELLPATH COMMENTS				
MD [ft]	Inclination [°]	Azimuth [°]	TVD [ft]	Comment
322.00	0.590	300.000	321.99	FIRST BHI MWD SURVEY
6556.00	88.715	266.212	6076.05	TOP OF PRODUCTION (2368'FNL & 465'FEL, SEC.29, SENE, 40.372630, -104.225278)
16199.00	89.970	271.330	6108.92	LAST BHI MWD SURVEY
16224.00	89.970	271.330	6108.93	PROJECTION TO BIT (2309'FNL & 475'FWL, SEC.30 SWNW, LOT 2, 40.372622, -104.259929)