



Well: Middlepark 18-08-2L  
Site: Section 18-T04N-R62W  
Project: Weld County, Colorado  
Wellbore: Original Hole  
Design: plan2

#### Section Details

Sec	MD	Inc	Azi	TVD	+N/-S	+E/-W	Dleg	Vsect	Annotation
1	0.00	0.00	0.00	0.00	0.00	0.00	0.00	0.00	
2	2000.00	0.00	0.00	2000.00	0.00	0.00	0.00	0.00	KOP Begin 2°/100' build
3	3506.84	30.14	107.20	3438.32	-114.49	369.92	2.00	-56.45	Begin 30.14° tangent
4	6113.67	30.14	107.20	5692.77	-501.46	1620.21	0.00	-247.22	Begin 10°/100' build
5	7110.70	90.00	357.58	6280.20	76.34	1917.35	10.00	369.30	LP Begin 90° lateral
6	16777.08	90.00	357.58	6280.20	9734.13	1509.71	0.00	9850.50	PBHL/TD 16777.08 MD/6280.20 TVD

#### DESIGN TARGET DETAILS

Name	TVD	+N/-S	+E/-W	Northing	Easting	Latitude	Longitude
Middlepark 18-08-2L BHL 470 FNL 1714 FWL p2	6280.20	9734.13	1509.71	14648604.62	1817395.67	40.33292885	-104.36495438
Middlepark 18-08-2L LP 470 FSL 1714 FEL p2	6280.20	76.34	1917.35	14638950.00	1817871.95	40.30640910	-104.36349447



Azimuths to True North  
Magnetic North: 8.18°

Magnetic Field  
Strength: 52247.5snT  
Dip Angle: 66.90°  
Date: 4/22/2018  
Model: HDGM

Middlepark 18-08-2L Surf loc: 373 FSL 1723 FWL Section 18-T04N-R62W			
NAD83 Colorado - HARN Universal Transverse Mercator (US Survey Feet) Zone 13N (108 W to 102 W) RKB=4557+24 @ 4581.20ft			
Northing	Easting	Latitude	Longitude
14638860.03	1815955.20	40.30619967	-104.37037146

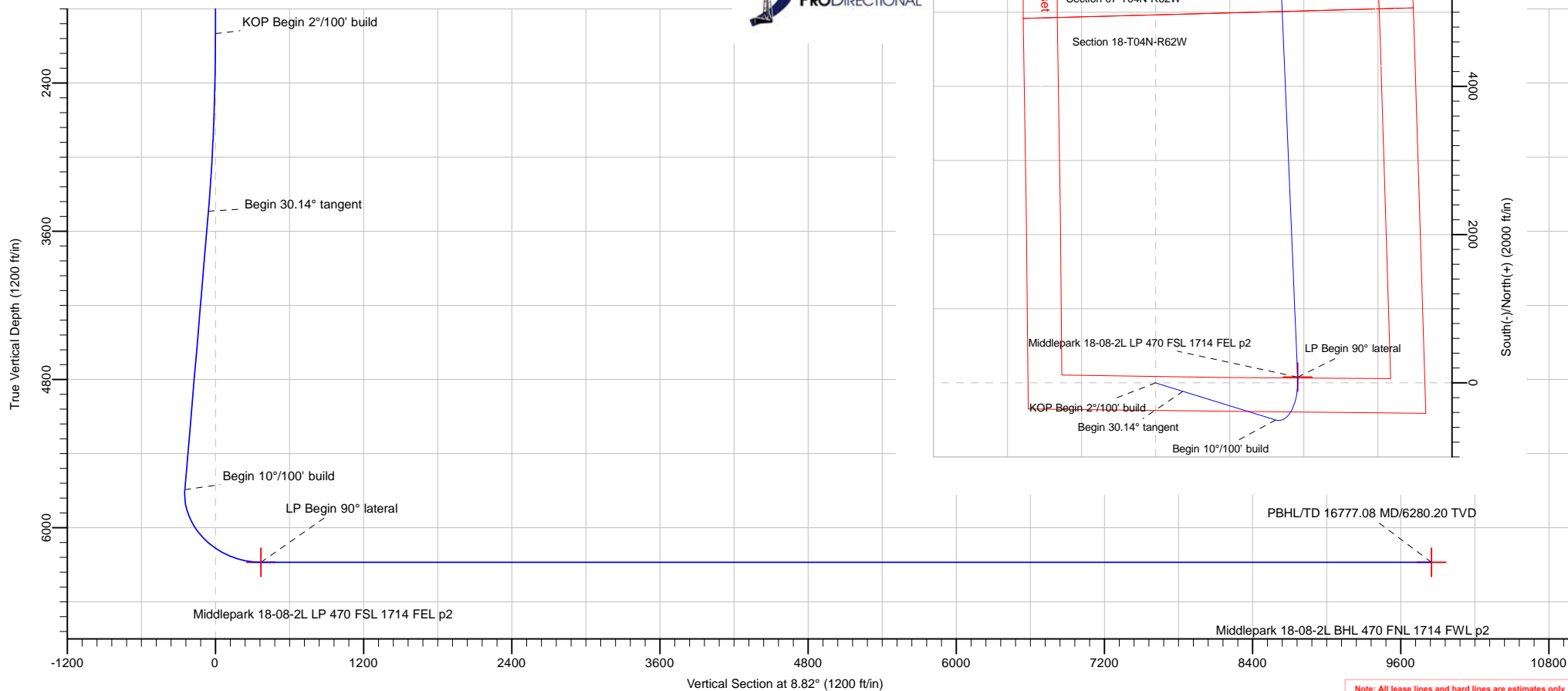

Note: All lease lines and hard lines are estimates only and are subject to customers approval.

<b>Database:</b>	DB_Jul2216dt_v14	<b>Local Co-ordinate Reference:</b>	Well Middlepark 18-08-2L
<b>Company:</b>	Confluence Resources	<b>TVD Reference:</b>	RKB=4557+24 @ 4581.20ft
<b>Project:</b>	Weld County, Colorado	<b>MD Reference:</b>	RKB=4557+24 @ 4581.20ft
<b>Site:</b>	Section 18-T04N-R62W	<b>North Reference:</b>	True
<b>Well:</b>	Middlepark 18-08-2L	<b>Survey Calculation Method:</b>	Minimum Curvature
<b>Wellbore:</b>	Original Hole		
<b>Design:</b>	plan2		

<b>Project</b>	Weld County, Colorado		
<b>Map System:</b>	Universal Transverse Mercator (US Survey Feet)	<b>System Datum:</b>	Mean Sea Level
<b>Geo Datum:</b>	NAD83 Colorado - HARN		
<b>Map Zone:</b>	Zone 13N (108 W to 102 W)		

Site		Section 18-T04N-R62W			
Site Position:		Northing:	14,641,153.41 usft	Latitude:	40.31252000
From:	Lat/Long	Easting:	1,814,773.97 usft	Longitude:	-104.37455000
Position Uncertainty:	0.00 ft	Slot Radius:	13-3/16 "	Grid Convergence:	0.40 °

Well	Middlepark 18-08-2L, Surf loc: 373 FSL 1723 FWL Section 18-T04N-R62W					
Well Position	+N/-S	-2,301.67 ft	Northing:	14,638,860.03 usft	Latitude:	40.30619968
	+E/-W	1,165.00 ft	Easting:	1,815,955.20 usft	Longitude:	-104.37037146
Position Uncertainty		0.00 ft	Wellhead Elevation:		Ground Level:	4,557.00 ft

<b>Wellbore</b>	Original Hole				
<b>Magnetics</b>	<b>Model Name</b>	<b>Sample Date</b>	<b>Declination (°)</b>	<b>Dip Angle (°)</b>	<b>Field Strength (nT)</b>
	HDGM	4/22/2018	8.18	66.90	52,247.50000000

<b>Design</b>	plan2			
<b>Audit Notes:</b>				
<b>Version:</b>	<b>Phase:</b>	PLAN	<b>Tie On Depth:</b>	0.00
<b>Vertical Section:</b>	<b>Depth From (TVD) (ft)</b>	<b>+N/-S (ft)</b>	<b>+E/-W (ft)</b>	<b>Direction (°)</b>
	0.00	0.00	0.00	8.82

<b>Plan Survey Tool Program</b>	<b>Date</b>	4/26/2018		
<b>Depth From (ft)</b>	<b>Depth To (ft)</b>	<b>Survey (Wellbore)</b>	<b>Tool Name</b>	<b>Remarks</b>
1	0.00	16,777.08	plan2 (Original Hole)	

<b>Plan Sections</b>										
<b>Measured Depth (ft)</b>	<b>Inclination (°)</b>	<b>Azimuth (°)</b>	<b>Vertical Depth (ft)</b>	<b>+N/-S (ft)</b>	<b>+E/-W (ft)</b>	<b>Dogleg Rate (°/100ft)</b>	<b>Build Rate (°/100ft)</b>	<b>Turn Rate (°/100ft)</b>	<b>TFO (°)</b>	<b>Target</b>
0.00	0.00	0.00	0.00	0.00	0.00	0.00	0.00	0.00	0.00	
2,000.00	0.00	0.00	2,000.00	0.00	0.00	0.00	0.00	0.00	0.00	
3,506.84	30.14	107.20	3,438.32	-114.49	369.92	2.00	2.00	0.00	107.20	
6,113.67	30.14	107.20	5,692.77	-501.46	1,620.21	0.00	0.00	0.00	0.00	
7,110.70	90.00	357.58	6,280.20	76.34	1,917.35	10.00	6.00	-10.99	-107.13	Middlepark 18-08-2L I
16,777.08	90.00	357.58	6,280.20	9,734.13	1,509.71	0.00	0.00	0.00	0.00	Middlepark 18-08-2L I

<b>Database:</b>	DB_Jul2216dt_v14	<b>Local Co-ordinate Reference:</b>	Well Middlepark 18-08-2L
<b>Company:</b>	Confluence Resources	<b>TVD Reference:</b>	RKB=4557+24 @ 4581.20ft
<b>Project:</b>	Weld County, Colorado	<b>MD Reference:</b>	RKB=4557+24 @ 4581.20ft
<b>Site:</b>	Section 18-T04N-R62W	<b>North Reference:</b>	True
<b>Well:</b>	Middlepark 18-08-2L	<b>Survey Calculation Method:</b>	Minimum Curvature
<b>Wellbore:</b>	Original Hole		
<b>Design:</b>	plan2		

Planned Survey									
Measured Depth (ft)	Inclination (°)	Azimuth (°)	Vertical Depth (ft)	+N/-S (ft)	+E/-W (ft)	Vertical Section (ft)	Dogleg Rate (°/100ft)	Build Rate (°/100ft)	Turn Rate (°/100ft)
0.00	0.00	0.00	0.00	0.00	0.00	0.00	0.00	0.00	0.00
100.00	0.00	0.00	100.00	0.00	0.00	0.00	0.00	0.00	0.00
200.00	0.00	0.00	200.00	0.00	0.00	0.00	0.00	0.00	0.00
300.00	0.00	0.00	300.00	0.00	0.00	0.00	0.00	0.00	0.00
400.00	0.00	0.00	400.00	0.00	0.00	0.00	0.00	0.00	0.00
500.00	0.00	0.00	500.00	0.00	0.00	0.00	0.00	0.00	0.00
600.00	0.00	0.00	600.00	0.00	0.00	0.00	0.00	0.00	0.00
700.00	0.00	0.00	700.00	0.00	0.00	0.00	0.00	0.00	0.00
800.00	0.00	0.00	800.00	0.00	0.00	0.00	0.00	0.00	0.00
900.00	0.00	0.00	900.00	0.00	0.00	0.00	0.00	0.00	0.00
1,000.00	0.00	0.00	1,000.00	0.00	0.00	0.00	0.00	0.00	0.00
1,100.00	0.00	0.00	1,100.00	0.00	0.00	0.00	0.00	0.00	0.00
1,200.00	0.00	0.00	1,200.00	0.00	0.00	0.00	0.00	0.00	0.00
1,300.00	0.00	0.00	1,300.00	0.00	0.00	0.00	0.00	0.00	0.00
1,400.00	0.00	0.00	1,400.00	0.00	0.00	0.00	0.00	0.00	0.00
1,500.00	0.00	0.00	1,500.00	0.00	0.00	0.00	0.00	0.00	0.00
1,600.00	0.00	0.00	1,600.00	0.00	0.00	0.00	0.00	0.00	0.00
1,700.00	0.00	0.00	1,700.00	0.00	0.00	0.00	0.00	0.00	0.00
1,800.00	0.00	0.00	1,800.00	0.00	0.00	0.00	0.00	0.00	0.00
1,900.00	0.00	0.00	1,900.00	0.00	0.00	0.00	0.00	0.00	0.00
2,000.00	0.00	0.00	2,000.00	0.00	0.00	0.00	0.00	0.00	0.00
<b>KOP Begin 2°/100' build</b>									
2,100.00	2.00	107.20	2,099.98	-0.52	1.67	-0.25	2.00	2.00	0.00
2,200.00	4.00	107.20	2,199.84	-2.06	6.67	-1.02	2.00	2.00	0.00
2,300.00	6.00	107.20	2,299.45	-4.64	14.99	-2.29	2.00	2.00	0.00
2,400.00	8.00	107.20	2,398.70	-8.24	26.63	-4.06	2.00	2.00	0.00
2,500.00	10.00	107.20	2,497.47	-12.87	41.58	-6.34	2.00	2.00	0.00
2,600.00	12.00	107.20	2,595.62	-18.51	59.80	-9.13	2.00	2.00	0.00
2,700.00	14.00	107.20	2,693.06	-25.16	81.29	-12.40	2.00	2.00	0.00
2,800.00	16.00	107.20	2,789.64	-32.81	106.02	-16.18	2.00	2.00	0.00
2,900.00	18.00	107.20	2,885.27	-41.46	133.94	-20.44	2.00	2.00	0.00
3,000.00	20.00	107.20	2,979.82	-51.08	165.04	-25.18	2.00	2.00	0.00
3,100.00	22.00	107.20	3,073.17	-61.68	199.28	-30.41	2.00	2.00	0.00
3,200.00	24.00	107.20	3,165.21	-73.23	236.60	-36.10	2.00	2.00	0.00
3,300.00	26.00	107.20	3,255.84	-85.72	276.97	-42.26	2.00	2.00	0.00
3,400.00	28.00	107.20	3,344.94	-99.15	320.34	-48.88	2.00	2.00	0.00
3,500.00	30.00	107.20	3,432.39	-113.48	366.65	-55.95	2.00	2.00	0.00
3,506.84	30.14	107.20	3,438.31	-114.49	369.92	-56.45	2.00	2.00	0.00
<b>Begin 30.14° tangent</b>									
3,600.00	30.14	107.20	3,518.88	-128.32	414.60	-63.26	0.00	0.00	0.00
3,700.00	30.14	107.20	3,605.36	-143.17	462.57	-70.58	0.00	0.00	0.00
3,800.00	30.14	107.20	3,691.85	-158.01	510.53	-77.90	0.00	0.00	0.00
3,900.00	30.14	107.20	3,778.33	-172.86	558.49	-85.22	0.00	0.00	0.00
4,000.00	30.14	107.20	3,864.81	-187.70	606.45	-92.54	0.00	0.00	0.00
4,100.00	30.14	107.20	3,951.30	-202.54	654.41	-99.86	0.00	0.00	0.00
4,200.00	30.14	107.20	4,037.78	-217.39	702.38	-107.17	0.00	0.00	0.00
4,300.00	30.14	107.20	4,124.26	-232.23	750.34	-114.49	0.00	0.00	0.00
4,400.00	30.14	107.20	4,210.74	-247.08	798.30	-121.81	0.00	0.00	0.00
4,500.00	30.14	107.20	4,297.23	-261.92	846.26	-129.13	0.00	0.00	0.00
4,600.00	30.14	107.20	4,383.71	-276.77	894.22	-136.45	0.00	0.00	0.00
4,700.00	30.14	107.20	4,470.19	-291.61	942.19	-143.77	0.00	0.00	0.00
4,800.00	30.14	107.20	4,556.68	-306.46	990.15	-151.08	0.00	0.00	0.00
4,900.00	30.14	107.20	4,643.16	-321.30	1,038.11	-158.40	0.00	0.00	0.00

<b>Database:</b>	DB_Jul2216dt_v14	<b>Local Co-ordinate Reference:</b>	Well Middlepark 18-08-2L
<b>Company:</b>	Confluence Resources	<b>TVD Reference:</b>	RKB=4557+24 @ 4581.20ft
<b>Project:</b>	Weld County, Colorado	<b>MD Reference:</b>	RKB=4557+24 @ 4581.20ft
<b>Site:</b>	Section 18-T04N-R62W	<b>North Reference:</b>	True
<b>Well:</b>	Middlepark 18-08-2L	<b>Survey Calculation Method:</b>	Minimum Curvature
<b>Wellbore:</b>	Original Hole		
<b>Design:</b>	plan2		

Planned Survey									
Measured Depth (ft)	Inclination (°)	Azimuth (°)	Vertical Depth (ft)	+N/-S (ft)	+E/-W (ft)	Vertical Section (ft)	Dogleg Rate (°/100ft)	Build Rate (°/100ft)	Turn Rate (°/100ft)
5,000.00	30.14	107.20	4,729.64	-336.15	1,086.07	-165.72	0.00	0.00	0.00
5,100.00	30.14	107.20	4,816.12	-350.99	1,134.04	-173.04	0.00	0.00	0.00
5,200.00	30.14	107.20	4,902.61	-365.83	1,182.00	-180.36	0.00	0.00	0.00
5,300.00	30.14	107.20	4,989.09	-380.68	1,229.96	-187.68	0.00	0.00	0.00
5,400.00	30.14	107.20	5,075.57	-395.52	1,277.92	-194.99	0.00	0.00	0.00
5,500.00	30.14	107.20	5,162.06	-410.37	1,325.88	-202.31	0.00	0.00	0.00
5,600.00	30.14	107.20	5,248.54	-425.21	1,373.85	-209.63	0.00	0.00	0.00
5,700.00	30.14	107.20	5,335.02	-440.06	1,421.81	-216.95	0.00	0.00	0.00
5,800.00	30.14	107.20	5,421.50	-454.90	1,469.77	-224.27	0.00	0.00	0.00
5,900.00	30.14	107.20	5,507.99	-469.75	1,517.73	-231.59	0.00	0.00	0.00
6,000.00	30.14	107.20	5,594.47	-484.59	1,565.69	-238.90	0.00	0.00	0.00
6,100.00	30.14	107.20	5,680.95	-499.44	1,613.66	-246.22	0.00	0.00	0.00
6,113.67	30.14	107.20	5,692.77	-501.46	1,620.21	-247.22	0.00	0.00	0.00
<b>Begin 10°/100' build</b>									
6,200.00	28.69	89.81	5,768.11	-507.82	1,661.72	-247.14	10.00	-1.68	-20.14
6,300.00	29.92	69.45	5,855.53	-498.96	1,709.19	-231.11	10.00	1.23	-20.36
6,400.00	33.91	52.03	5,940.58	-472.98	1,754.65	-198.47	10.00	3.99	-17.42
6,500.00	39.84	38.54	6,020.68	-430.66	1,796.70	-150.20	10.00	5.93	-13.48
6,600.00	46.96	28.29	6,093.38	-373.28	1,834.07	-87.78	10.00	7.12	-10.25
6,700.00	54.80	20.27	6,156.49	-302.60	1,865.63	-13.09	10.00	7.84	-8.02
6,800.00	63.08	13.71	6,208.08	-220.75	1,890.41	71.58	10.00	8.28	-6.57
6,900.00	71.61	8.06	6,246.59	-130.23	1,907.67	163.68	10.00	8.54	-5.65
7,000.00	80.30	2.95	6,270.85	-33.79	1,916.87	260.40	10.00	8.69	-5.11
7,100.00	89.06	358.10	6,280.11	65.65	1,917.75	358.79	10.00	8.76	-4.85
7,110.70	90.00	357.58	6,280.20	76.34	1,917.34	369.30	10.00	8.77	-4.80
<b>LP Begin 90° lateral</b>									
7,200.00	90.00	357.58	6,280.20	165.56	1,913.58	456.89	0.00	0.00	0.00
7,300.00	90.00	357.58	6,280.20	265.48	1,909.36	554.97	0.00	0.00	0.00
7,400.00	90.00	357.58	6,280.20	365.39	1,905.14	653.06	0.00	0.00	0.00
7,500.00	90.00	357.58	6,280.20	465.30	1,900.93	751.14	0.00	0.00	0.00
7,600.00	90.00	357.58	6,280.20	565.21	1,896.71	849.22	0.00	0.00	0.00
7,700.00	90.00	357.58	6,280.20	665.12	1,892.49	947.31	0.00	0.00	0.00
7,800.00	90.00	357.58	6,280.20	765.03	1,888.28	1,045.39	0.00	0.00	0.00
7,900.00	90.00	357.58	6,280.20	864.94	1,884.06	1,143.48	0.00	0.00	0.00
8,000.00	90.00	357.58	6,280.20	964.85	1,879.84	1,241.56	0.00	0.00	0.00
8,100.00	90.00	357.58	6,280.20	1,064.76	1,875.63	1,339.65	0.00	0.00	0.00
8,200.00	90.00	357.58	6,280.20	1,164.67	1,871.41	1,437.73	0.00	0.00	0.00
8,300.00	90.00	357.58	6,280.20	1,264.59	1,867.19	1,535.81	0.00	0.00	0.00
8,400.00	90.00	357.58	6,280.20	1,364.50	1,862.97	1,633.90	0.00	0.00	0.00
8,500.00	90.00	357.58	6,280.20	1,464.41	1,858.76	1,731.98	0.00	0.00	0.00
8,600.00	90.00	357.58	6,280.20	1,564.32	1,854.54	1,830.07	0.00	0.00	0.00
8,700.00	90.00	357.58	6,280.20	1,664.23	1,850.32	1,928.15	0.00	0.00	0.00
8,800.00	90.00	357.58	6,280.20	1,764.14	1,846.11	2,026.24	0.00	0.00	0.00
8,900.00	90.00	357.58	6,280.20	1,864.05	1,841.89	2,124.32	0.00	0.00	0.00
9,000.00	90.00	357.58	6,280.20	1,963.96	1,837.67	2,222.41	0.00	0.00	0.00
9,100.00	90.00	357.58	6,280.20	2,063.87	1,833.45	2,320.49	0.00	0.00	0.00
9,200.00	90.00	357.58	6,280.20	2,163.79	1,829.24	2,418.57	0.00	0.00	0.00
9,300.00	90.00	357.58	6,280.20	2,263.70	1,825.02	2,516.66	0.00	0.00	0.00
9,400.00	90.00	357.58	6,280.20	2,363.61	1,820.80	2,614.74	0.00	0.00	0.00
9,500.00	90.00	357.58	6,280.20	2,463.52	1,816.59	2,712.83	0.00	0.00	0.00
9,600.00	90.00	357.58	6,280.20	2,563.43	1,812.37	2,810.91	0.00	0.00	0.00
9,700.00	90.00	357.58	6,280.20	2,663.34	1,808.15	2,909.00	0.00	0.00	0.00
9,800.00	90.00	357.58	6,280.20	2,763.25	1,803.94	3,007.08	0.00	0.00	0.00
9,900.00	90.00	357.58	6,280.20	2,863.16	1,799.72	3,105.16	0.00	0.00	0.00

<b>Database:</b>	DB_Jul2216dt_v14	<b>Local Co-ordinate Reference:</b>	Well Middlepark 18-08-2L
<b>Company:</b>	Confluence Resources	<b>TVD Reference:</b>	RKB=4557+24 @ 4581.20ft
<b>Project:</b>	Weld County, Colorado	<b>MD Reference:</b>	RKB=4557+24 @ 4581.20ft
<b>Site:</b>	Section 18-T04N-R62W	<b>North Reference:</b>	True
<b>Well:</b>	Middlepark 18-08-2L	<b>Survey Calculation Method:</b>	Minimum Curvature
<b>Wellbore:</b>	Original Hole		
<b>Design:</b>	plan2		

Planned Survey									
Measured Depth (ft)	Inclination (°)	Azimuth (°)	Vertical Depth (ft)	+N/-S (ft)	+E/-W (ft)	Vertical Section (ft)	Dogleg Rate (°/100ft)	Build Rate (°/100ft)	Turn Rate (°/100ft)
10,000.00	90.00	357.58	6,280.20	2,963.07	1,795.50	3,203.25	0.00	0.00	0.00
10,100.00	90.00	357.58	6,280.20	3,062.98	1,791.28	3,301.33	0.00	0.00	0.00
10,200.00	90.00	357.58	6,280.20	3,162.90	1,787.07	3,399.42	0.00	0.00	0.00
10,300.00	90.00	357.58	6,280.20	3,262.81	1,782.85	3,497.50	0.00	0.00	0.00
10,400.00	90.00	357.58	6,280.20	3,362.72	1,778.63	3,595.59	0.00	0.00	0.00
10,500.00	90.00	357.58	6,280.20	3,462.63	1,774.42	3,693.67	0.00	0.00	0.00
10,600.00	90.00	357.58	6,280.20	3,562.54	1,770.20	3,791.75	0.00	0.00	0.00
10,700.00	90.00	357.58	6,280.20	3,662.45	1,765.98	3,889.84	0.00	0.00	0.00
10,800.00	90.00	357.58	6,280.20	3,762.36	1,761.76	3,987.92	0.00	0.00	0.00
10,900.00	90.00	357.58	6,280.20	3,862.27	1,757.55	4,086.01	0.00	0.00	0.00
11,000.00	90.00	357.58	6,280.20	3,962.18	1,753.33	4,184.09	0.00	0.00	0.00
11,100.00	90.00	357.58	6,280.20	4,062.09	1,749.11	4,282.18	0.00	0.00	0.00
11,200.00	90.00	357.58	6,280.20	4,162.01	1,744.90	4,380.26	0.00	0.00	0.00
11,300.00	90.00	357.58	6,280.20	4,261.92	1,740.68	4,478.34	0.00	0.00	0.00
11,400.00	90.00	357.58	6,280.20	4,361.83	1,736.46	4,576.43	0.00	0.00	0.00
11,500.00	90.00	357.58	6,280.20	4,461.74	1,732.25	4,674.51	0.00	0.00	0.00
11,600.00	90.00	357.58	6,280.20	4,561.65	1,728.03	4,772.60	0.00	0.00	0.00
11,700.00	90.00	357.58	6,280.20	4,661.56	1,723.81	4,870.68	0.00	0.00	0.00
11,800.00	90.00	357.58	6,280.20	4,761.47	1,719.59	4,968.77	0.00	0.00	0.00
11,900.00	90.00	357.58	6,280.20	4,861.38	1,715.38	5,066.85	0.00	0.00	0.00
12,000.00	90.00	357.58	6,280.20	4,961.29	1,711.16	5,164.94	0.00	0.00	0.00
12,100.00	90.00	357.58	6,280.20	5,061.21	1,706.94	5,263.02	0.00	0.00	0.00
12,200.00	90.00	357.58	6,280.20	5,161.12	1,702.73	5,361.10	0.00	0.00	0.00
12,300.00	90.00	357.58	6,280.20	5,261.03	1,698.51	5,459.19	0.00	0.00	0.00
12,400.00	90.00	357.58	6,280.20	5,360.94	1,694.29	5,557.27	0.00	0.00	0.00
12,500.00	90.00	357.58	6,280.20	5,460.85	1,690.07	5,655.36	0.00	0.00	0.00
12,600.00	90.00	357.58	6,280.20	5,560.76	1,685.86	5,753.44	0.00	0.00	0.00
12,700.00	90.00	357.58	6,280.20	5,660.67	1,681.64	5,851.53	0.00	0.00	0.00
12,800.00	90.00	357.58	6,280.20	5,760.58	1,677.42	5,949.61	0.00	0.00	0.00
12,900.00	90.00	357.58	6,280.20	5,860.49	1,673.21	6,047.69	0.00	0.00	0.00
13,000.00	90.00	357.58	6,280.20	5,960.40	1,668.99	6,145.78	0.00	0.00	0.00
13,100.00	90.00	357.58	6,280.20	6,060.32	1,664.77	6,243.86	0.00	0.00	0.00
13,200.00	90.00	357.58	6,280.20	6,160.23	1,660.55	6,341.95	0.00	0.00	0.00
13,300.00	90.00	357.58	6,280.20	6,260.14	1,656.34	6,440.03	0.00	0.00	0.00
13,400.00	90.00	357.58	6,280.20	6,360.05	1,652.12	6,538.12	0.00	0.00	0.00
13,500.00	90.00	357.58	6,280.20	6,459.96	1,647.90	6,636.20	0.00	0.00	0.00
13,600.00	90.00	357.58	6,280.20	6,559.87	1,643.69	6,734.28	0.00	0.00	0.00
13,700.00	90.00	357.58	6,280.20	6,659.78	1,639.47	6,832.37	0.00	0.00	0.00
13,800.00	90.00	357.58	6,280.20	6,759.69	1,635.25	6,930.45	0.00	0.00	0.00
13,900.00	90.00	357.58	6,280.20	6,859.60	1,631.04	7,028.54	0.00	0.00	0.00
14,000.00	90.00	357.58	6,280.20	6,959.52	1,626.82	7,126.62	0.00	0.00	0.00
14,100.00	90.00	357.58	6,280.20	7,059.43	1,622.60	7,224.71	0.00	0.00	0.00
14,200.00	90.00	357.58	6,280.20	7,159.34	1,618.38	7,322.79	0.00	0.00	0.00
14,300.00	90.00	357.58	6,280.20	7,259.25	1,614.17	7,420.88	0.00	0.00	0.00
14,400.00	90.00	357.58	6,280.20	7,359.16	1,609.95	7,518.96	0.00	0.00	0.00
14,500.00	90.00	357.58	6,280.20	7,459.07	1,605.73	7,617.04	0.00	0.00	0.00
14,600.00	90.00	357.58	6,280.20	7,558.98	1,601.52	7,715.13	0.00	0.00	0.00
14,700.00	90.00	357.58	6,280.20	7,658.89	1,597.30	7,813.21	0.00	0.00	0.00
14,800.00	90.00	357.58	6,280.20	7,758.80	1,593.08	7,911.30	0.00	0.00	0.00
14,900.00	90.00	357.58	6,280.20	7,858.71	1,588.86	8,009.38	0.00	0.00	0.00
15,000.00	90.00	357.58	6,280.20	7,958.63	1,584.65	8,107.47	0.00	0.00	0.00
15,100.00	90.00	357.58	6,280.20	8,058.54	1,580.43	8,205.55	0.00	0.00	0.00
15,200.00	90.00	357.58	6,280.20	8,158.45	1,576.21	8,303.63	0.00	0.00	0.00
15,300.00	90.00	357.58	6,280.20	8,258.36	1,572.00	8,401.72	0.00	0.00	0.00

<b>Database:</b>	DB_Jul2216dt_v14	<b>Local Co-ordinate Reference:</b>	Well Middlepark 18-08-2L
<b>Company:</b>	Confluence Resources	<b>TVD Reference:</b>	RKB=4557+24 @ 4581.20ft
<b>Project:</b>	Weld County, Colorado	<b>MD Reference:</b>	RKB=4557+24 @ 4581.20ft
<b>Site:</b>	Section 18-T04N-R62W	<b>North Reference:</b>	True
<b>Well:</b>	Middlepark 18-08-2L	<b>Survey Calculation Method:</b>	Minimum Curvature
<b>Wellbore:</b>	Original Hole		
<b>Design:</b>	plan2		

Planned Survey										
Measured Depth (ft)	Inclination (°)	Azimuth (°)	Vertical Depth (ft)	+N/-S (ft)	+E/-W (ft)	Vertical Section (ft)	Dogleg Rate (°/100ft)	Build Rate (°/100ft)	Turn Rate (°/100ft)	
15,400.00	90.00	357.58	6,280.20	8,358.27	1,567.78	8,499.80	0.00	0.00	0.00	
15,500.00	90.00	357.58	6,280.20	8,458.18	1,563.56	8,597.89	0.00	0.00	0.00	
15,600.00	90.00	357.58	6,280.20	8,558.09	1,559.35	8,695.97	0.00	0.00	0.00	
15,700.00	90.00	357.58	6,280.20	8,658.00	1,555.13	8,794.06	0.00	0.00	0.00	
15,800.00	90.00	357.58	6,280.20	8,757.91	1,550.91	8,892.14	0.00	0.00	0.00	
15,900.00	90.00	357.58	6,280.20	8,857.83	1,546.69	8,990.22	0.00	0.00	0.00	
16,000.00	90.00	357.58	6,280.20	8,957.74	1,542.48	9,088.31	0.00	0.00	0.00	
16,100.00	90.00	357.58	6,280.20	9,057.65	1,538.26	9,186.39	0.00	0.00	0.00	
16,200.00	90.00	357.58	6,280.20	9,157.56	1,534.04	9,284.48	0.00	0.00	0.00	
16,300.00	90.00	357.58	6,280.20	9,257.47	1,529.83	9,382.56	0.00	0.00	0.00	
16,400.00	90.00	357.58	6,280.20	9,357.38	1,525.61	9,480.65	0.00	0.00	0.00	
16,500.00	90.00	357.58	6,280.20	9,457.29	1,521.39	9,578.73	0.00	0.00	0.00	
16,600.00	90.00	357.58	6,280.20	9,557.20	1,517.17	9,676.81	0.00	0.00	0.00	
16,700.00	90.00	357.58	6,280.20	9,657.11	1,512.96	9,774.90	0.00	0.00	0.00	
16,777.08	90.00	357.58	6,280.20	9,734.12	1,509.71	9,850.50	0.00	0.00	0.00	
PBHL/TD 16777.08 MD/6280.20 TVD										

Design Targets										
Target Name	Dip Angle (°)	Dip Dir. (°)	TVD (ft)	+N/-S (ft)	+E/-W (ft)	Northing (usft)	Easting (usft)	Latitude		Longitude
- hit/miss target										
- Shape										
Middlepark 18-08-2L BH	0.00	0.00	6,280.20	9,734.13	1,509.71	14,648,604.62	1,817,395.67	40.33292884		-104.36495438
- plan hits target center										
- Point										
Middlepark 18-08-2L LP	0.00	0.00	6,280.20	76.34	1,917.35	14,638,950.00	1,817,871.95	40.30640910		-104.36349447
- plan hits target center										
- Point										

Plan Annotations					
Measured Depth (ft)	Vertical Depth (ft)	Local Coordinates			
		+N/-S (ft)	+E/-W (ft)	Comment	
2,000.00	2,000.00	0.00	0.00	KOP Begin 2°/100' build	
3,506.84	3,438.31	-114.49	369.92	Begin 30.14° tangent	
6,113.67	5,692.77	-501.46	1,620.21	Begin 10°/100' build	
7,110.70	6,280.20	76.34	1,917.34	LP Begin 90° lateral	
16,777.08	6,280.20	9,734.12	1,509.71	PBHL/TD 16777.08 MD/6280.20 TVD	

<b>Database:</b>	DB_Jul2216dt_v14	<b>Local Co-ordinate Reference:</b>	Well Middlepark 18-08-2L
<b>Company:</b>	Confluence Resources	<b>TVD Reference:</b>	RKB=4557+24 @ 4581.20ft
<b>Project:</b>	Weld County, Colorado	<b>MD Reference:</b>	RKB=4557+24 @ 4581.20ft
<b>Site:</b>	Section 18-T04N-R62W	<b>North Reference:</b>	True
<b>Well:</b>	Middlepark 18-08-2L	<b>Survey Calculation Method:</b>	Minimum Curvature
<b>Wellbore:</b>	Original Hole		
<b>Design:</b>	plan2		

<b>Project</b>	Weld County, Colorado		
<b>Map System:</b>	Universal Transverse Mercator (US Survey Feet)	<b>System Datum:</b>	Mean Sea Level
<b>Geo Datum:</b>	NAD83 Colorado - HARN		
<b>Map Zone:</b>	Zone 13N (108 W to 102 W)		

Site		Section 18-T04N-R62W			
Site Position:		Northing:	14,641,153.41 usft	Latitude:	40.31252000
From:	Lat/Long	Easting:	1,814,773.97 usft	Longitude:	-104.37455000
Position Uncertainty:	0.00 ft	Slot Radius:	13-3/16 "	Grid Convergence:	0.40 °

Well	Middlepark 18-08-2L, Surf loc: 373 FSL 1723 FWL Section 18-T04N-R62W					
Well Position	+N/-S	0.00 ft	Northing:	14,638,860.03 usft	Latitude:	40.30619968
	+E/-W	0.00 ft	Easting:	1,815,955.20 usft	Longitude:	-104.37037146
Position Uncertainty		0.00 ft	Wellhead Elevation:		Ground Level:	4,557.00 ft

<b>Wellbore</b>	Original Hole				
<b>Magnetics</b>	<b>Model Name</b>	<b>Sample Date</b>	<b>Declination (°)</b>	<b>Dip Angle (°)</b>	<b>Field Strength (nT)</b>
	HDGM	4/22/2018	8.18	66.90	52,247.50000000

<b>Design</b>	plan2			
<b>Audit Notes:</b>				
<b>Version:</b>	<b>Phase:</b>	PLAN	<b>Tie On Depth:</b>	0.00
<b>Vertical Section:</b>	<b>Depth From (TVD) (ft)</b>	<b>+N/-S (ft)</b>	<b>+E/-W (ft)</b>	<b>Direction (°)</b>
	0.00	0.00	0.00	8.82

<b>Plan Survey Tool Program</b>	<b>Date</b>	4/26/2018		
<b>Depth From (ft)</b>	<b>Depth To (ft)</b>	<b>Survey (Wellbore)</b>	<b>Tool Name</b>	<b>Remarks</b>
1	0.00	16,777.08 plan2 (Original Hole)		

<b>Plan Sections</b>										
<b>Measured Depth (ft)</b>	<b>Inclination (°)</b>	<b>Azimuth (°)</b>	<b>Vertical Depth (ft)</b>	<b>+N/-S (ft)</b>	<b>+E/-W (ft)</b>	<b>Dogleg Rate (°/100ft)</b>	<b>Build Rate (°/100ft)</b>	<b>Turn Rate (°/100ft)</b>	<b>TFO (°)</b>	<b>Target</b>
0.00	0.00	0.00	0.00	0.00	0.00	0.00	0.00	0.00	0.00	
2,000.00	0.00	0.00	2,000.00	0.00	0.00	0.00	0.00	0.00	0.00	
3,506.84	30.14	107.20	3,438.32	-114.49	369.92	2.00	2.00	0.00	107.20	
6,113.67	30.14	107.20	5,692.77	-501.46	1,620.21	0.00	0.00	0.00	0.00	
7,110.70	90.00	357.58	6,280.20	76.34	1,917.35	10.00	6.00	-10.99	-107.13	Middlepark 18-08-2L I
16,777.08	90.00	357.58	6,280.20	9,734.13	1,509.71	0.00	0.00	0.00	0.00	Middlepark 18-08-2L I



<b>Database:</b>	DB_Jul2216dt_v14	<b>Local Co-ordinate Reference:</b>	Well Middlepark 18-08-2L
<b>Company:</b>	Confluence Resources	<b>TVD Reference:</b>	RKB=4557+24 @ 4581.20ft
<b>Project:</b>	Weld County, Colorado	<b>MD Reference:</b>	RKB=4557+24 @ 4581.20ft
<b>Site:</b>	Section 18-T04N-R62W	<b>North Reference:</b>	True
<b>Well:</b>	Middlepark 18-08-2L	<b>Survey Calculation Method:</b>	Minimum Curvature
<b>Wellbore:</b>	Original Hole		
<b>Design:</b>	plan2		

Planned Survey									
Measured Depth (ft)	Inclination (°)	Azimuth (°)	Vertical Depth (ft)	+N/-S (ft)	+E/-W (ft)	Map Northing (usft)	Map Easting (usft)	Latitude	Longitude
0.00	0.00	0.00	0.00	0.00	0.00	14,638,860.03	1,815,955.20	40.30619968	-104.37037146
100.00	0.00	0.00	100.00	0.00	0.00	14,638,860.03	1,815,955.20	40.30619968	-104.37037146
200.00	0.00	0.00	200.00	0.00	0.00	14,638,860.03	1,815,955.20	40.30619968	-104.37037146
300.00	0.00	0.00	300.00	0.00	0.00	14,638,860.03	1,815,955.20	40.30619968	-104.37037146
400.00	0.00	0.00	400.00	0.00	0.00	14,638,860.03	1,815,955.20	40.30619968	-104.37037146
500.00	0.00	0.00	500.00	0.00	0.00	14,638,860.03	1,815,955.20	40.30619968	-104.37037146
600.00	0.00	0.00	600.00	0.00	0.00	14,638,860.03	1,815,955.20	40.30619968	-104.37037146
700.00	0.00	0.00	700.00	0.00	0.00	14,638,860.03	1,815,955.20	40.30619968	-104.37037146
800.00	0.00	0.00	800.00	0.00	0.00	14,638,860.03	1,815,955.20	40.30619968	-104.37037146
900.00	0.00	0.00	900.00	0.00	0.00	14,638,860.03	1,815,955.20	40.30619968	-104.37037146
1,000.00	0.00	0.00	1,000.00	0.00	0.00	14,638,860.03	1,815,955.20	40.30619968	-104.37037146
1,100.00	0.00	0.00	1,100.00	0.00	0.00	14,638,860.03	1,815,955.20	40.30619968	-104.37037146
1,200.00	0.00	0.00	1,200.00	0.00	0.00	14,638,860.03	1,815,955.20	40.30619968	-104.37037146
1,300.00	0.00	0.00	1,300.00	0.00	0.00	14,638,860.03	1,815,955.20	40.30619968	-104.37037146
1,400.00	0.00	0.00	1,400.00	0.00	0.00	14,638,860.03	1,815,955.20	40.30619968	-104.37037146
1,500.00	0.00	0.00	1,500.00	0.00	0.00	14,638,860.03	1,815,955.20	40.30619968	-104.37037146
1,600.00	0.00	0.00	1,600.00	0.00	0.00	14,638,860.03	1,815,955.20	40.30619968	-104.37037146
1,700.00	0.00	0.00	1,700.00	0.00	0.00	14,638,860.03	1,815,955.20	40.30619968	-104.37037146
1,800.00	0.00	0.00	1,800.00	0.00	0.00	14,638,860.03	1,815,955.20	40.30619968	-104.37037146
1,900.00	0.00	0.00	1,900.00	0.00	0.00	14,638,860.03	1,815,955.20	40.30619968	-104.37037146
2,000.00	0.00	0.00	2,000.00	0.00	0.00	14,638,860.03	1,815,955.20	40.30619968	-104.37037146
<b>KOP Begin 2°/100' build</b>									
2,100.00	2.00	107.20	2,099.98	-0.52	1.67	14,638,859.52	1,815,956.87	40.30619826	-104.37036548
2,200.00	4.00	107.20	2,199.84	-2.06	6.67	14,638,858.01	1,815,961.88	40.30619401	-104.37034755
2,300.00	6.00	107.20	2,299.45	-4.64	14.99	14,638,855.49	1,815,970.23	40.30618694	-104.37031769
2,400.00	8.00	107.20	2,398.70	-8.24	26.63	14,638,851.97	1,815,981.89	40.30617704	-104.37027594
2,500.00	10.00	107.20	2,497.47	-12.87	41.58	14,638,847.45	1,815,996.87	40.30616434	-104.37022234
2,600.00	12.00	107.20	2,595.62	-18.51	59.80	14,638,841.94	1,816,015.13	40.30614885	-104.37015696
2,700.00	14.00	107.20	2,693.06	-25.16	81.29	14,638,835.45	1,816,036.67	40.30613059	-104.37007989
2,800.00	16.00	107.20	2,789.64	-32.81	106.02	14,638,827.97	1,816,061.45	40.30610958	-104.36999122
2,900.00	18.00	107.20	2,885.27	-41.46	133.94	14,638,819.52	1,816,089.44	40.30608584	-104.36989104
3,000.00	20.00	107.20	2,979.82	-51.08	165.04	14,638,810.12	1,816,120.60	40.30605941	-104.36977950
3,100.00	22.00	107.20	3,073.17	-61.68	199.28	14,638,799.77	1,816,154.91	40.30603031	-104.36965672
3,200.00	24.00	107.20	3,165.21	-73.23	236.60	14,638,788.48	1,816,192.32	40.30599859	-104.36952285
3,300.00	26.00	107.20	3,255.84	-85.72	276.97	14,638,776.27	1,816,232.77	40.30596428	-104.36937805
3,400.00	28.00	107.20	3,344.94	-99.15	320.34	14,638,763.16	1,816,276.23	40.30592742	-104.36922251
3,500.00	30.00	107.20	3,432.39	-113.48	366.65	14,638,749.16	1,816,322.65	40.30588806	-104.36905640
3,506.84	30.14	107.20	3,438.31	-114.49	369.92	14,638,748.17	1,816,325.93	40.30588528	-104.36904466
<b>Begin 30.14° tangent</b>									
3,600.00	30.14	107.20	3,518.88	-128.32	414.60	14,638,734.66	1,816,370.71	40.30584730	-104.36888440
3,700.00	30.14	107.20	3,605.36	-143.17	462.57	14,638,720.15	1,816,418.77	40.30580654	-104.36871238
3,800.00	30.14	107.20	3,691.85	-158.01	510.53	14,638,705.65	1,816,466.84	40.30576577	-104.36854035
3,900.00	30.14	107.20	3,778.33	-172.86	558.49	14,638,691.15	1,816,514.90	40.30572501	-104.36836833
4,000.00	30.14	107.20	3,864.81	-187.70	606.45	14,638,676.64	1,816,562.97	40.30568424	-104.36819631
4,100.00	30.14	107.20	3,951.30	-202.54	654.41	14,638,662.14	1,816,611.04	40.30564348	-104.36802428
4,200.00	30.14	107.20	4,037.78	-217.39	702.38	14,638,647.64	1,816,659.10	40.30560271	-104.36785226
4,300.00	30.14	107.20	4,124.26	-232.23	750.34	14,638,633.13	1,816,707.17	40.30556194	-104.36768024
4,400.00	30.14	107.20	4,210.74	-247.08	798.30	14,638,618.63	1,816,755.24	40.30552118	-104.36750821
4,500.00	30.14	107.20	4,297.23	-261.92	846.26	14,638,604.13	1,816,803.30	40.30548041	-104.36733619
4,600.00	30.14	107.20	4,383.71	-276.77	894.22	14,638,589.62	1,816,851.37	40.30543965	-104.36716417
4,700.00	30.14	107.20	4,470.19	-291.61	942.19	14,638,575.12	1,816,899.43	40.30539888	-104.36699214
4,800.00	30.14	107.20	4,556.68	-306.46	990.15	14,638,560.62	1,816,947.50	40.30535811	-104.36682012
4,900.00	30.14	107.20	4,643.16	-321.30	1,038.11	14,638,546.11	1,816,995.57	40.30531734	-104.36664810
5,000.00	30.14	107.20	4,729.64	-336.15	1,086.07	14,638,531.61	1,817,043.63	40.30527658	-104.36647608



<b>Database:</b>	DB_Jul2216dt_v14	<b>Local Co-ordinate Reference:</b>	Well Middlepark 18-08-2L
<b>Company:</b>	Confluence Resources	<b>TVD Reference:</b>	RKB=4557+24 @ 4581.20ft
<b>Project:</b>	Weld County, Colorado	<b>MD Reference:</b>	RKB=4557+24 @ 4581.20ft
<b>Site:</b>	Section 18-T04N-R62W	<b>North Reference:</b>	True
<b>Well:</b>	Middlepark 18-08-2L	<b>Survey Calculation Method:</b>	Minimum Curvature
<b>Wellbore:</b>	Original Hole		
<b>Design:</b>	plan2		

Planned Survey									
Measured Depth (ft)	Inclination (°)	Azimuth (°)	Vertical Depth (ft)	+N/-S (ft)	+E/-W (ft)	Map Northing (usft)	Map Easting (usft)	Latitude	Longitude
5,100.00	30.14	107.20	4,816.12	-350.99	1,134.04	14,638,517.11	1,817,091.70	40.30523581	-104.36630406
5,200.00	30.14	107.20	4,902.61	-365.83	1,182.00	14,638,502.61	1,817,139.77	40.30519504	-104.36613204
5,300.00	30.14	107.20	4,989.09	-380.68	1,229.96	14,638,488.10	1,817,187.83	40.30515427	-104.36596001
5,400.00	30.14	107.20	5,075.57	-395.52	1,277.92	14,638,473.60	1,817,235.90	40.30511350	-104.36578799
5,500.00	30.14	107.20	5,162.06	-410.37	1,325.88	14,638,459.10	1,817,283.97	40.30507273	-104.36561597
5,600.00	30.14	107.20	5,248.54	-425.21	1,373.85	14,638,444.59	1,817,332.03	40.30503196	-104.36544395
5,700.00	30.14	107.20	5,335.02	-440.06	1,421.81	14,638,430.09	1,817,380.10	40.30499119	-104.36527193
5,800.00	30.14	107.20	5,421.50	-454.90	1,469.77	14,638,415.59	1,817,428.16	40.30495042	-104.36509991
5,900.00	30.14	107.20	5,507.99	-469.75	1,517.73	14,638,401.08	1,817,476.23	40.30490965	-104.36492789
6,000.00	30.14	107.20	5,594.47	-484.59	1,565.69	14,638,386.58	1,817,524.30	40.30486888	-104.36475587
6,100.00	30.14	107.20	5,680.95	-499.44	1,613.66	14,638,372.08	1,817,572.36	40.30482811	-104.36458385
6,113.67	30.14	107.20	5,692.77	-501.46	1,620.21	14,638,370.09	1,817,578.93	40.30482254	-104.36456034
Begin 10°/100' build									
6,200.00	28.69	89.81	5,768.11	-507.82	1,661.72	14,638,364.04	1,817,620.48	40.30480509	-104.36441148
6,300.00	29.92	69.45	5,855.53	-498.96	1,709.19	14,638,373.23	1,817,667.89	40.30482940	-104.36424120
6,400.00	33.91	52.03	5,940.58	-472.98	1,754.65	14,638,399.54	1,817,713.16	40.30490074	-104.36407817
6,500.00	39.84	38.54	6,020.68	-430.66	1,796.70	14,638,442.16	1,817,754.91	40.30501694	-104.36392733
6,600.00	46.96	28.29	6,093.38	-373.28	1,834.07	14,638,499.80	1,817,791.87	40.30517448	-104.36379327
6,700.00	54.80	20.27	6,156.49	-302.60	1,865.63	14,638,570.70	1,817,822.93	40.30536857	-104.36368007
6,800.00	63.08	13.71	6,208.08	-220.75	1,890.41	14,638,652.72	1,817,847.13	40.30559331	-104.36359115
6,900.00	71.61	8.06	6,246.59	-130.23	1,907.67	14,638,743.36	1,817,863.74	40.30584187	-104.36352923
7,000.00	80.30	2.95	6,270.85	-33.79	1,916.87	14,638,839.87	1,817,872.26	40.30610670	-104.36349619
7,100.00	89.06	358.10	6,280.11	65.65	1,917.75	14,638,939.31	1,817,872.43	40.30637975	-104.36349303
7,110.70	90.00	357.58	6,280.20	76.34	1,917.34	14,638,950.00	1,817,871.95	40.30640911	-104.36349447
LP Begin 90° lateral									
7,200.00	90.00	357.58	6,280.20	165.56	1,913.58	14,639,039.19	1,817,867.55	40.30665411	-104.36350795
7,300.00	90.00	357.58	6,280.20	265.48	1,909.36	14,639,139.07	1,817,862.62	40.30692846	-104.36352305
7,400.00	90.00	357.58	6,280.20	365.39	1,905.14	14,639,238.95	1,817,857.70	40.30720281	-104.36353815
7,500.00	90.00	357.58	6,280.20	465.30	1,900.93	14,639,338.83	1,817,852.77	40.30747716	-104.36355325
7,600.00	90.00	357.58	6,280.20	565.21	1,896.71	14,639,438.70	1,817,847.84	40.30775151	-104.36356834
7,700.00	90.00	357.58	6,280.20	665.12	1,892.49	14,639,538.58	1,817,842.91	40.30802586	-104.36358344
7,800.00	90.00	357.58	6,280.20	765.03	1,888.28	14,639,638.46	1,817,837.99	40.30830021	-104.36359854
7,900.00	90.00	357.58	6,280.20	864.94	1,884.06	14,639,738.34	1,817,833.06	40.30857456	-104.36361364
8,000.00	90.00	357.58	6,280.20	964.85	1,879.84	14,639,838.22	1,817,828.13	40.30884891	-104.36362874
8,100.00	90.00	357.58	6,280.20	1,064.76	1,875.63	14,639,938.10	1,817,823.21	40.30912326	-104.36364384
8,200.00	90.00	357.58	6,280.20	1,164.67	1,871.41	14,640,037.97	1,817,818.28	40.30939761	-104.36365894
8,300.00	90.00	357.58	6,280.20	1,264.59	1,867.19	14,640,137.85	1,817,813.35	40.30967197	-104.36367404
8,400.00	90.00	357.58	6,280.20	1,364.50	1,862.97	14,640,237.73	1,817,808.42	40.30994632	-104.36368913
8,500.00	90.00	357.58	6,280.20	1,464.41	1,858.76	14,640,337.61	1,817,803.50	40.31022067	-104.36370423
8,600.00	90.00	357.58	6,280.20	1,564.32	1,854.54	14,640,437.49	1,817,798.57	40.31049502	-104.36371933
8,700.00	90.00	357.58	6,280.20	1,664.23	1,850.32	14,640,537.37	1,817,793.64	40.31076937	-104.36373443
8,800.00	90.00	357.58	6,280.20	1,764.14	1,846.11	14,640,637.24	1,817,788.71	40.31104372	-104.36374953
8,900.00	90.00	357.58	6,280.20	1,864.05	1,841.89	14,640,737.12	1,817,783.79	40.31131807	-104.36376463
9,000.00	90.00	357.58	6,280.20	1,963.96	1,837.67	14,640,837.00	1,817,778.86	40.31159242	-104.36377973
9,100.00	90.00	357.58	6,280.20	2,063.87	1,833.45	14,640,936.88	1,817,773.93	40.31186677	-104.36379483
9,200.00	90.00	357.58	6,280.20	2,163.79	1,829.24	14,641,036.76	1,817,769.01	40.31214112	-104.36380993
9,300.00	90.00	357.58	6,280.20	2,263.70	1,825.02	14,641,136.64	1,817,764.08	40.31241547	-104.36382503
9,400.00	90.00	357.58	6,280.20	2,363.61	1,820.80	14,641,236.51	1,817,759.15	40.31268982	-104.36384013
9,500.00	90.00	357.58	6,280.20	2,463.52	1,816.59	14,641,336.39	1,817,754.22	40.31296416	-104.36385523
9,600.00	90.00	357.58	6,280.20	2,563.43	1,812.37	14,641,436.27	1,817,749.30	40.31323851	-104.36387033
9,700.00	90.00	357.58	6,280.20	2,663.34	1,808.15	14,641,536.15	1,817,744.37	40.31351286	-104.36388543
9,800.00	90.00	357.58	6,280.20	2,763.25	1,803.94	14,641,636.03	1,817,739.44	40.31378722	-104.36390053
9,900.00	90.00	357.58	6,280.20	2,863.16	1,799.72	14,641,735.91	1,817,734.52	40.31406157	-104.36391563
10,000.00	90.00	357.58	6,280.20	2,963.07	1,795.50	14,641,835.78	1,817,729.59	40.31433592	-104.36393074

<b>Database:</b>	DB_Jul2216dt_v14	<b>Local Co-ordinate Reference:</b>	Well Middlepark 18-08-2L
<b>Company:</b>	Confluence Resources	<b>TVD Reference:</b>	RKB=4557+24 @ 4581.20ft
<b>Project:</b>	Weld County, Colorado	<b>MD Reference:</b>	RKB=4557+24 @ 4581.20ft
<b>Site:</b>	Section 18-T04N-R62W	<b>North Reference:</b>	True
<b>Well:</b>	Middlepark 18-08-2L	<b>Survey Calculation Method:</b>	Minimum Curvature
<b>Wellbore:</b>	Original Hole		
<b>Design:</b>	plan2		

Planned Survey									
Measured Depth (ft)	Inclination (°)	Azimuth (°)	Vertical Depth (ft)	+N/-S (ft)	+E/-W (ft)	Map Northing (usft)	Map Easting (usft)	Latitude	Longitude
10,100.00	90.00	357.58	6,280.20	3,062.98	1,791.28	14,641,935.66	1,817,724.66	40.31461027	-104.36394584
10,200.00	90.00	357.58	6,280.20	3,162.90	1,787.07	14,642,035.54	1,817,719.73	40.31488462	-104.36396094
10,300.00	90.00	357.58	6,280.20	3,262.81	1,782.85	14,642,135.42	1,817,714.81	40.31515897	-104.36397604
10,400.00	90.00	357.58	6,280.20	3,362.72	1,778.63	14,642,235.30	1,817,709.88	40.31543332	-104.36399114
10,500.00	90.00	357.58	6,280.20	3,462.63	1,774.42	14,642,335.18	1,817,704.95	40.31570767	-104.36400624
10,600.00	90.00	357.58	6,280.20	3,562.54	1,770.20	14,642,435.05	1,817,700.02	40.31598202	-104.36402134
10,700.00	90.00	357.58	6,280.20	3,662.45	1,765.98	14,642,534.93	1,817,695.10	40.31625637	-104.36403644
10,800.00	90.00	357.58	6,280.20	3,762.36	1,761.76	14,642,634.81	1,817,690.17	40.31653072	-104.36405155
10,900.00	90.00	357.58	6,280.20	3,862.27	1,757.55	14,642,734.69	1,817,685.24	40.31680507	-104.36406665
11,000.00	90.00	357.58	6,280.20	3,962.18	1,753.33	14,642,834.57	1,817,680.32	40.31707942	-104.36408175
11,100.00	90.00	357.58	6,280.20	4,062.09	1,749.11	14,642,934.45	1,817,675.39	40.31735377	-104.36409685
11,200.00	90.00	357.58	6,280.20	4,162.01	1,744.90	14,643,034.32	1,817,670.46	40.31762812	-104.36411195
11,300.00	90.00	357.58	6,280.20	4,261.92	1,740.68	14,643,134.20	1,817,665.53	40.31790247	-104.36412706
11,400.00	90.00	357.58	6,280.20	4,361.83	1,736.46	14,643,234.08	1,817,660.61	40.31817682	-104.36414216
11,500.00	90.00	357.58	6,280.20	4,461.74	1,732.25	14,643,333.96	1,817,655.68	40.31845117	-104.36415726
11,600.00	90.00	357.58	6,280.20	4,561.65	1,728.03	14,643,433.84	1,817,650.75	40.31872552	-104.36417236
11,700.00	90.00	357.58	6,280.20	4,661.56	1,723.81	14,643,533.72	1,817,645.83	40.31899987	-104.36418747
11,800.00	90.00	357.58	6,280.20	4,761.47	1,719.59	14,643,633.59	1,817,640.90	40.31927422	-104.36420257
11,900.00	90.00	357.58	6,280.20	4,861.38	1,715.38	14,643,733.47	1,817,635.97	40.31954857	-104.36421767
12,000.00	90.00	357.58	6,280.20	4,961.29	1,711.16	14,643,833.35	1,817,631.04	40.31982292	-104.36423277
12,100.00	90.00	357.58	6,280.20	5,061.21	1,706.94	14,643,933.23	1,817,626.12	40.32009727	-104.36424788
12,200.00	90.00	357.58	6,280.20	5,161.12	1,702.73	14,644,033.11	1,817,621.19	40.32037162	-104.36426298
12,300.00	90.00	357.58	6,280.20	5,261.03	1,698.51	14,644,132.99	1,817,616.26	40.32064598	-104.36427808
12,400.00	90.00	357.58	6,280.20	5,360.94	1,694.29	14,644,232.86	1,817,611.33	40.32092033	-104.36429319
12,500.00	90.00	357.58	6,280.20	5,460.85	1,690.07	14,644,332.74	1,817,606.41	40.32119468	-104.36430829
12,600.00	90.00	357.58	6,280.20	5,560.76	1,685.86	14,644,432.62	1,817,601.48	40.32146903	-104.36432340
12,700.00	90.00	357.58	6,280.20	5,660.67	1,681.64	14,644,532.50	1,817,596.55	40.32174338	-104.36433850
12,800.00	90.00	357.58	6,280.20	5,760.58	1,677.42	14,644,632.38	1,817,591.63	40.32201773	-104.36435360
12,900.00	90.00	357.58	6,280.20	5,860.49	1,673.21	14,644,732.26	1,817,586.70	40.32229208	-104.36436871
13,000.00	90.00	357.58	6,280.20	5,960.40	1,668.99	14,644,832.13	1,817,581.77	40.32256643	-104.36438381
13,100.00	90.00	357.58	6,280.20	6,060.32	1,664.77	14,644,932.01	1,817,576.84	40.32284078	-104.36439891
13,200.00	90.00	357.58	6,280.20	6,160.23	1,660.55	14,645,031.89	1,817,571.92	40.32311513	-104.36441402
13,300.00	90.00	357.58	6,280.20	6,260.14	1,656.34	14,645,131.77	1,817,566.99	40.32338948	-104.36442912
13,400.00	90.00	357.58	6,280.20	6,360.05	1,652.12	14,645,231.65	1,817,562.06	40.32366383	-104.36444423
13,500.00	90.00	357.58	6,280.20	6,459.96	1,647.90	14,645,331.53	1,817,557.14	40.32393818	-104.36445933
13,600.00	90.00	357.58	6,280.20	6,559.87	1,643.69	14,645,431.40	1,817,552.21	40.32421253	-104.36447444
13,700.00	90.00	357.58	6,280.20	6,659.78	1,639.47	14,645,531.28	1,817,547.28	40.32448688	-104.36448954
13,800.00	90.00	357.58	6,280.20	6,759.69	1,635.25	14,645,631.16	1,817,542.35	40.32476123	-104.36450465
13,900.00	90.00	357.58	6,280.20	6,859.60	1,631.04	14,645,731.04	1,817,537.43	40.32503558	-104.36451975
14,000.00	90.00	357.58	6,280.20	6,959.52	1,626.82	14,645,830.92	1,817,532.50	40.32530993	-104.36453486
14,100.00	90.00	357.58	6,280.20	7,059.43	1,622.60	14,645,930.80	1,817,527.57	40.32558428	-104.36454996
14,200.00	90.00	357.58	6,280.20	7,159.34	1,618.38	14,646,030.67	1,817,522.64	40.32585863	-104.36456507
14,300.00	90.00	357.58	6,280.20	7,259.25	1,614.17	14,646,130.55	1,817,517.72	40.32613298	-104.36458017
14,400.00	90.00	357.58	6,280.20	7,359.16	1,609.95	14,646,230.43	1,817,512.79	40.32640733	-104.36459528
14,500.00	90.00	357.58	6,280.20	7,459.07	1,605.73	14,646,330.31	1,817,507.86	40.32668168	-104.36461038
14,600.00	90.00	357.58	6,280.20	7,558.98	1,601.52	14,646,430.19	1,817,502.94	40.32695603	-104.36462549
14,700.00	90.00	357.58	6,280.20	7,658.89	1,597.30	14,646,530.07	1,817,498.01	40.32723038	-104.36464060
14,800.00	90.00	357.58	6,280.20	7,758.80	1,593.08	14,646,629.94	1,817,493.08	40.32750473	-104.36465570
14,900.00	90.00	357.58	6,280.20	7,858.71	1,588.86	14,646,729.82	1,817,488.15	40.32777908	-104.36467081
15,000.00	90.00	357.58	6,280.20	7,958.63	1,584.65	14,646,829.70	1,817,483.23	40.32805343	-104.36468592
15,100.00	90.00	357.58	6,280.20	8,058.54	1,580.43	14,646,929.58	1,817,478.30	40.32832778	-104.36470102
15,200.00	90.00	357.58	6,280.20	8,158.45	1,576.21	14,647,029.46	1,817,473.37	40.32860213	-104.36471613
15,300.00	90.00	357.58	6,280.20	8,258.36	1,572.00	14,647,129.34	1,817,468.44	40.32887648	-104.36473123
15,400.00	90.00	357.58	6,280.20	8,358.27	1,567.78	14,647,229.21	1,817,463.52	40.32915083	-104.36474634
15,500.00	90.00	357.58	6,280.20	8,458.18	1,563.56	14,647,329.09	1,817,458.59	40.32942517	-104.36476145

<b>Database:</b>	DB_Jul2216dt_v14	<b>Local Co-ordinate Reference:</b>	Well Middlepark 18-08-2L
<b>Company:</b>	Confluence Resources	<b>TVD Reference:</b>	RKB=4557+24 @ 4581.20ft
<b>Project:</b>	Weld County, Colorado	<b>MD Reference:</b>	RKB=4557+24 @ 4581.20ft
<b>Site:</b>	Section 18-T04N-R62W	<b>North Reference:</b>	True
<b>Well:</b>	Middlepark 18-08-2L	<b>Survey Calculation Method:</b>	Minimum Curvature
<b>Wellbore:</b>	Original Hole		
<b>Design:</b>	plan2		

Planned Survey									
Measured Depth (ft)	Inclination (°)	Azimuth (°)	Vertical Depth (ft)	+N/-S (ft)	+E/-W (ft)	Map Northing (usft)	Map Easting (usft)	Latitude	Longitude
15,600.00	90.00	357.58	6,280.20	8,558.09	1,559.35	14,647,428.97	1,817,453.66	40.32969952	-104.36477655
15,700.00	90.00	357.58	6,280.20	8,658.00	1,555.13	14,647,528.85	1,817,448.74	40.32997387	-104.36479166
15,800.00	90.00	357.58	6,280.20	8,757.91	1,550.91	14,647,628.73	1,817,443.81	40.33024822	-104.36480677
15,900.00	90.00	357.58	6,280.20	8,857.83	1,546.69	14,647,728.61	1,817,438.88	40.33052257	-104.36482188
16,000.00	90.00	357.58	6,280.20	8,957.74	1,542.48	14,647,828.48	1,817,433.95	40.33079692	-104.36483698
16,100.00	90.00	357.58	6,280.20	9,057.65	1,538.26	14,647,928.36	1,817,429.03	40.33107127	-104.36485209
16,200.00	90.00	357.58	6,280.20	9,157.56	1,534.04	14,648,028.24	1,817,424.10	40.33134562	-104.36486720
16,300.00	90.00	357.58	6,280.20	9,257.47	1,529.83	14,648,128.12	1,817,419.17	40.33161997	-104.36488231
16,400.00	90.00	357.58	6,280.20	9,357.38	1,525.61	14,648,228.00	1,817,414.25	40.33189432	-104.36489741
16,500.00	90.00	357.58	6,280.20	9,457.29	1,521.39	14,648,327.88	1,817,409.32	40.33216867	-104.36491252
16,600.00	90.00	357.58	6,280.20	9,557.20	1,517.17	14,648,427.75	1,817,404.39	40.33244302	-104.36492763
16,700.00	90.00	357.58	6,280.20	9,657.11	1,512.96	14,648,527.63	1,817,399.46	40.33271737	-104.36494274
16,777.08	90.00	357.58	6,280.20	9,734.12	1,509.71	14,648,604.62	1,817,395.67	40.33292884	-104.36495438
PBHL/TD 16777.08 MD/6280.20 TVD									

Design Targets									
Target Name	Dip Angle (°)	Dip Dir. (°)	TVD (ft)	+N/-S (ft)	+E/-W (ft)	Northing (usft)	Easting (usft)	Latitude	Longitude
- hit/miss target									
- Shape									
Middlepark 18-08-2L BH	0.00	0.00	6,280.20	9,734.13	1,509.71	14,648,604.62	1,817,395.67	40.33292884	-104.36495438
- plan hits target center									
- Point									
Middlepark 18-08-2L LP	0.00	0.00	6,280.20	76.34	1,917.35	14,638,950.00	1,817,871.95	40.30640910	-104.36349447
- plan hits target center									
- Point									

Plan Annotations				
Measured Depth (ft)	Vertical Depth (ft)	Local Coordinates		Comment
		+N/-S (ft)	+E/-W (ft)	
2,000.00	2,000.00	0.00	0.00	KOP Begin 2°/100' build
3,506.84	3,438.31	-114.49	369.92	Begin 30.14° tangent
6,113.67	5,692.77	-501.46	1,620.21	Begin 10°/100' build
7,110.70	6,280.20	76.34	1,917.34	LP Begin 90° lateral
16,777.08	6,280.20	9,734.12	1,509.71	PBHL/TD 16777.08 MD/6280.20 TVD