

FACILITY LAYOUT DRAWING RINN VALLEY WEST PAD

SE 1/4 SE 1/4 SECTION 18, TOWNSHIP 2 NORTH, RANGE 68 WEST, 6TH P.M.

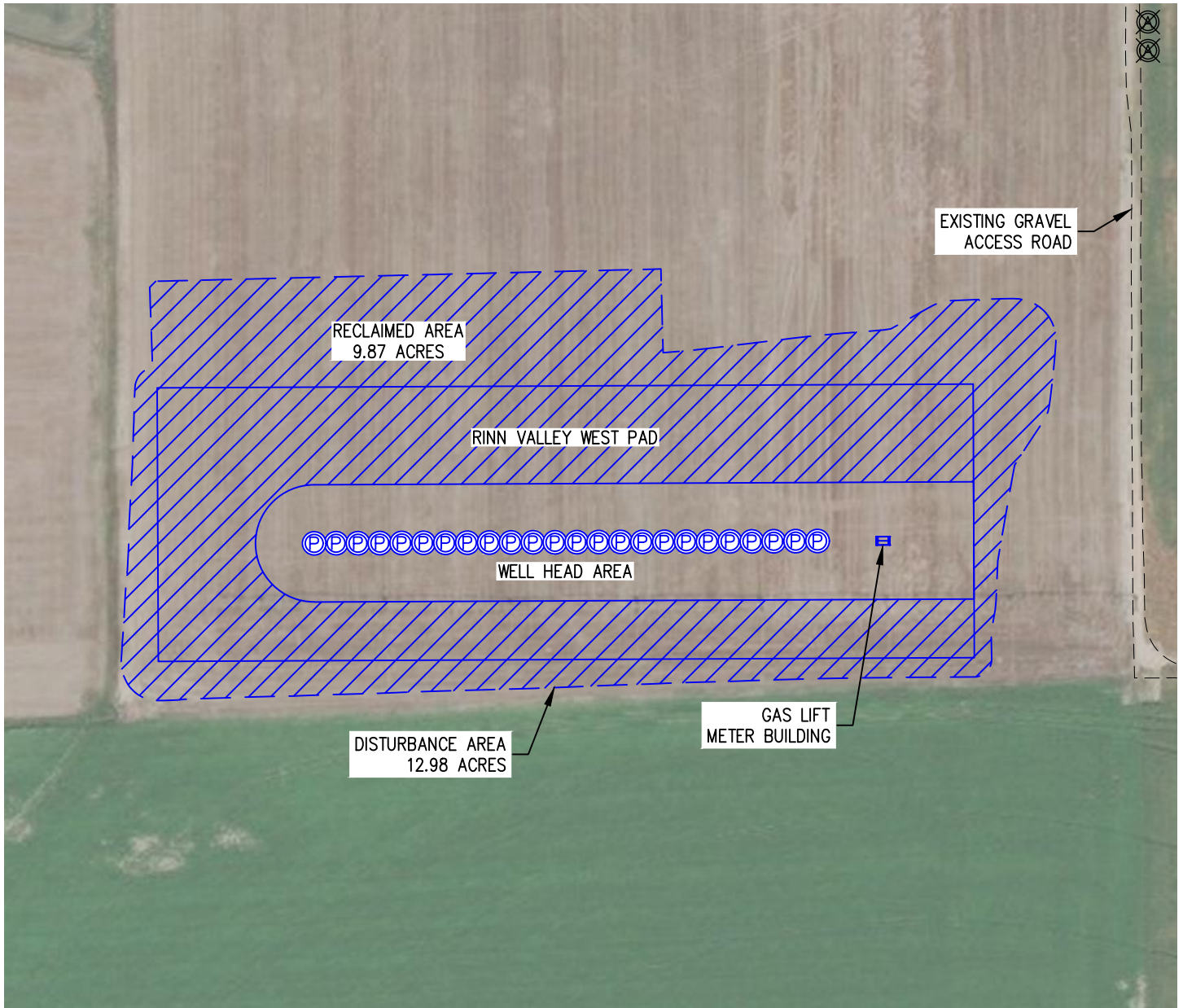

- Ⓢ PROPOSED WELL HEAD
- ⓧ ABANDONED WELL HEAD

NOTE: PROPOSED FEATURES SHOWN IN BLUE

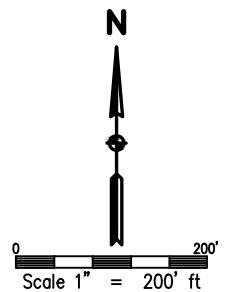

DISTURBED/RECLAIMED AREAS

TOTAL DISTURBED AREA OF LOCATION= 12.98 ACRES
TOTAL DISTURBED AREA OF LOCATION AFTER RECLAMATION= 3.11 ACRES



DRAWN BY DAM	CHECKED BY AAD
INITIAL SUBMITTAL 3/9/2018	
REVISED NA	
DRAWING SIZE 8.5" X 11"	
JOB NO. EXT02N68W17-01	
SHEET 1 OF 1	

BASELINE
Engineering - Planning - Surveying

4007 S. LINCOLN AVENUE, SUITE 405 - LOVELAND, COLORADO 80537
P: 970.353.7800 - F: 970.353.7801 - www.baselinecorp.com