

T. 9 S.

SHL
LATITUDE (NAD 83)
NORTH 39.244812 DEG.
LONGITUDE (NAD 83)
WEST 107.723381 DEG.
NORTHING (NAD 83)
1521762.12
EASTING (NAD 83)
2370384.66

BASIS OF BEARING/DATUM
SPCS COLORADO CENTRAL NAD 27
BASED ON STATIC GPS OBSERVATIONS
ON DRG CONTROL POINT CP 16-9-93
HAVING A POSITION OF:
NAD83(2011)
LAT 39° 16' 16.64" NORTH
LONG 107° 46' 11.24" WEST
NAVD88 ELEVATION: 7245.29'

THE EAST LINE OF THE NE¼ OF SECTION
25, MONUMENTED BY GLO BC'S AND
BEARING S 00° 52' 09" W.

SURVEYOR'S STATEMENT

I, DAVID E. HENDERHAN, AN EMPLOYEE AND AGENT ON BEHALF OF D.R. GRIFFIN & ASSOCIATES, INC. STATE THE PLAT HEREON IS A CORRECT REPRESENTATION OF A SURVEY MADE UNDER MY SUPERVISION ON THE 5th DAY OF MARCH, 2018 OF THE SHOWN SUP & SHEP FEDERAL 0993-25-15W AND THAT THE LOCATION HAS BEEN STAKED ON THE GROUND.

Notice: In accordance with Colorado State Law, any legal action based upon any defect in this survey plat must commence within three (3) years after first discovery of such defect. In no event, may any action based upon any defect in this survey plat be commenced more than ten (10) years from the date of certification shown hereon.

SUP & SHEP 25-11 PAD

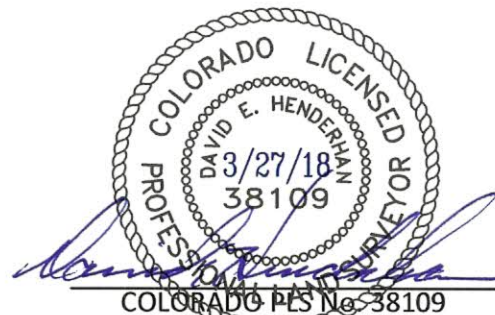

DRG RIFFIN & ASSOCIATES, INC.
(307) 362-5028 1414 ELK ST., ROCK SPRINGS, WY 82901

**PLAT OF DRILLING LOCATION IN
NESW, SECTION 25, FOR
LARAMIE ENERGY, LLC.**

DRAWN: 3/20/2018 - TCM	SCALE: 1" = 1000'
REVISED: 3/27/2018 - DEH	DRG JOB No. 21282
MISC. CORRECTIONS	A7-25-15W

**2397' F/SL, & 1766' F/WL, SECTION 25,
T. 9 S., R. 93 W., 6TH P.M.,
MESA COUNTY, COLORADO**