

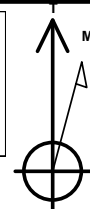

PROJECT DETAILS: Weld County, CO NAD 83

Geodetic System: US State Plane 1983
Datum: North American Datum 1983
Ellipsoid: GRS 1980
Zone: Colorado Northern Zone
System Datum: Mean Sea Level
Local North: True

Project: Weld County, CO NAD 83
Site: Critter Creek 14 SW Pad
Well: Critter Creek 240-1411H
Wellbore: OH
Design: Plan 1



Azimuths to True North
Magnetic North: 8.28°
Magnetic Field
Strength: 52807.4snT
Dip Angle: 67.20°
Date: 4/3/2018
Model: HDGM



Plan: Plan 1 (Critter Creek 240-1411H/OH)

Created By: Seth Burstad

SECTION DETAILS

MD	Inc	Azi	TVD	+N/-S	+E/-W	Dleg	TFace	VSect
0.00	0.00	0.000	0.00	0.00	0.00	0.00	0.00	0.00
100.00	0.00	0.000	100.00	0.00	0.00	0.00	0.00	0.00
400.00	6.00	109.272	399.45	-5.18	14.81	2.00	109.27	-5.23
1506.61	6.00	109.272	1500.00	-43.36	124.00	0.00	0.00	-43.81
1706.61	6.00	109.272	1698.90	-50.26	143.74	0.00	0.00	-50.79
3271.90	37.31	109.272	3135.71	-238.52	682.18	2.00	0.00	-241.03
3572.02	37.31	109.272	3374.43	-298.55	853.88	0.00	0.00	-301.69
6059.07	0.00	0.000	5689.44	-556.47	1591.56	1.50	180.00	-562.33
7181.17	0.00	0.000	6811.54	-556.47	1591.56	0.00	0.00	-562.33
7931.17	90.00	359.789	7289.00	-79.01	1589.80	12.00	359.79	-84.86
17925.14	90.00	359.789	7289.00	9914.90	1552.96	0.00	0.00	9909.11

WELL DETAILS: Critter Creek 240-1411H

GL 5217.8' & KB 20' @ 5237.80ft 5217.80						Longitude	
+N/-S	+E/-W	Northing	Easting	Latitude			
0.00	0.00	1578513.29	3302162.89	40° 54' 58.586 N		104° 24' 24.196 W	

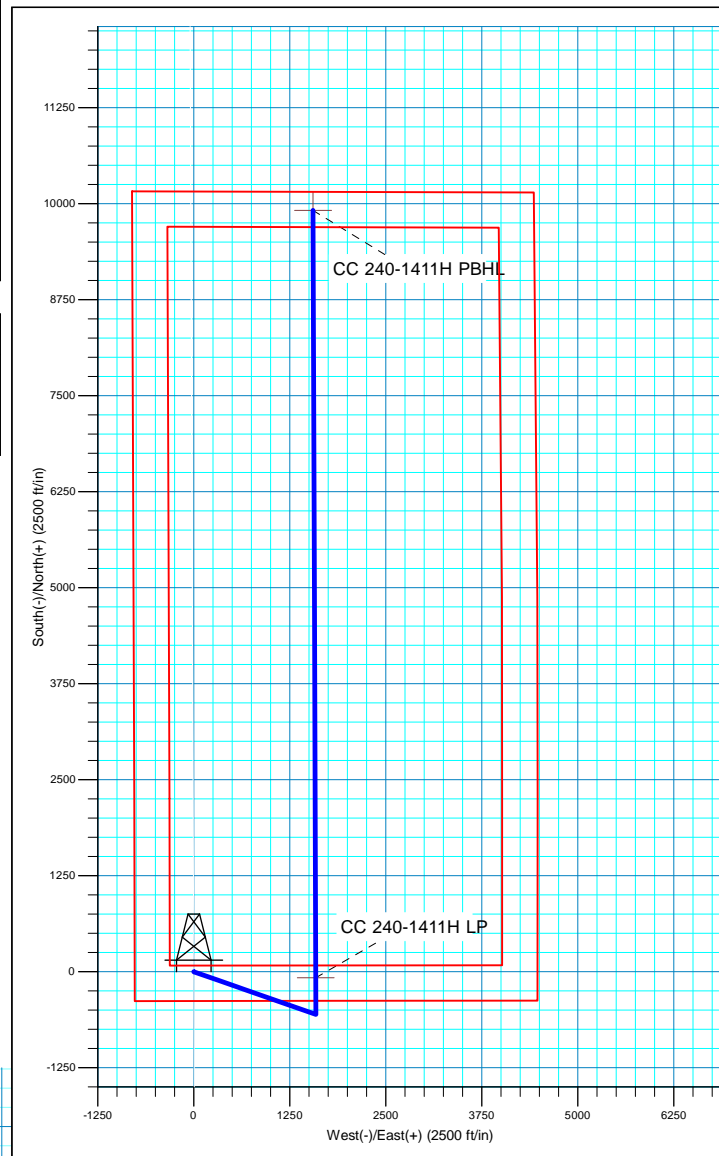
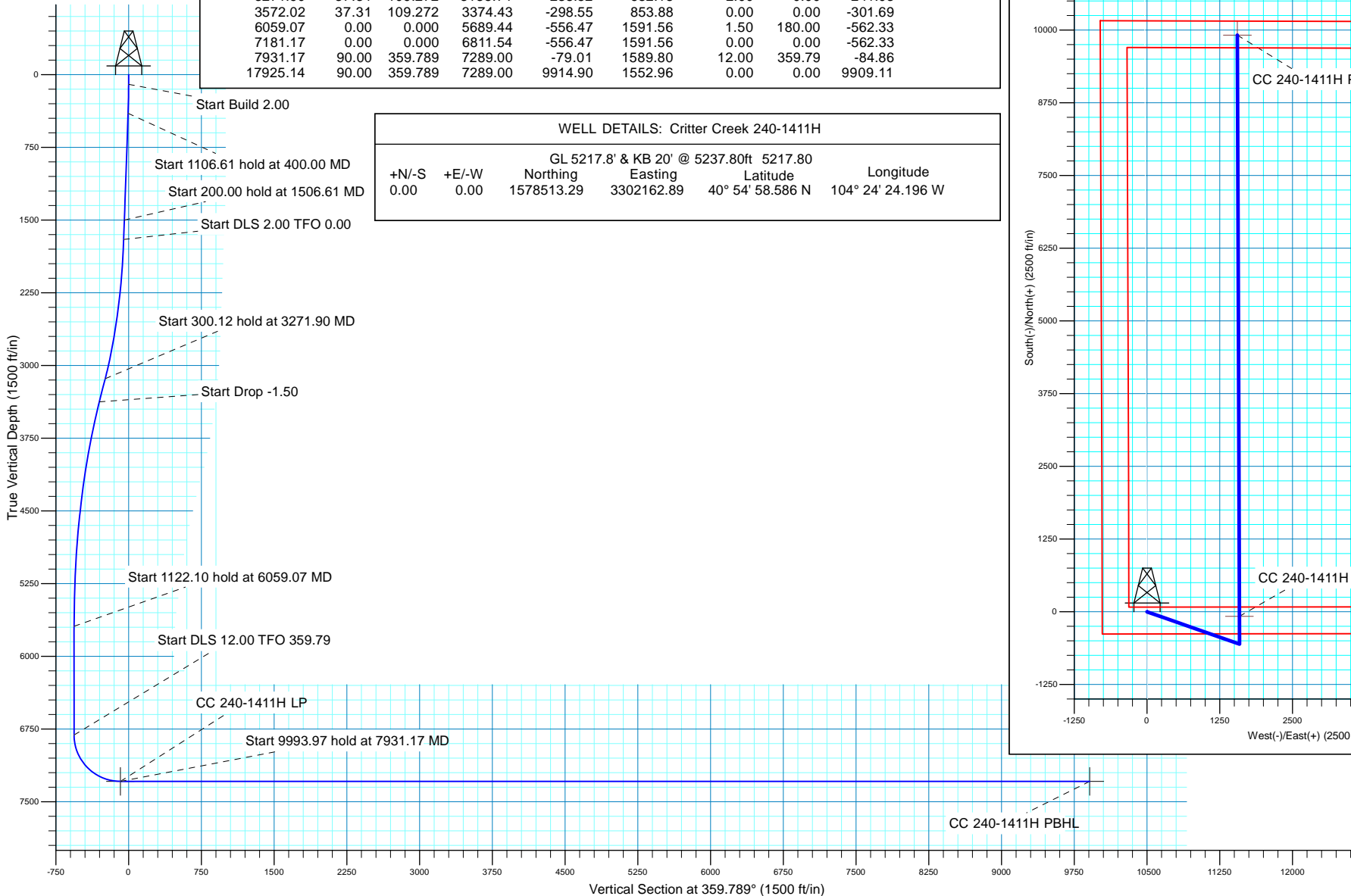



HighPoint Resources

Weld County, CO NAD 83
Crittter Creek 14 SW Pad
Crittter Creek 240-1411H

OH

Plan: Plan 1

Standard Planning Report

03 April, 2018



Database:	Casper District	Local Co-ordinate Reference:	Well Critter Creek 240-1411H
Company:	HighPoint Resources	TVD Reference:	GL 5217.8' & KB 20' @ 5237.80ft
Project:	Weld County, CO NAD 83	MD Reference:	GL 5217.8' & KB 20' @ 5237.80ft
Site:	Critter Creek 14 SW Pad	North Reference:	True
Well:	Critter Creek 240-1411H	Survey Calculation Method:	Minimum Curvature
Wellbore:	OH		
Design:	Plan 1		

Project	Weld County, CO NAD 83		
Map System:	US State Plane 1983	System Datum:	Mean Sea Level
Geo Datum:	North American Datum 1983		
Map Zone:	Colorado Northern Zone		

Site		Critter Creek 14 SW Pad, Site Center : Critter Creek 240-1411H			
Site Position:		Northing:	1,578,513.30 usft	Latitude:	40° 54' 58.586 N
From:	Lat/Long	Easting:	3,302,162.89 usft	Longitude:	104° 24' 24.196 W
Position Uncertainty:	0.00 ft	Slot Radius:	13.200 in	Grid Convergence:	0.71 °

Well	Critter Creek 240-1411H, 3382' FSL 770' FWL Sec 14 T11N R63W					
Well Position	+N/-S	-0.01 ft	Northing:	1,578,513.29 usft	Latitude:	40° 54' 58.586 N
	+E/-W	0.00 ft	Easting:	3,302,162.89 usft	Longitude:	104° 24' 24.196 W
Position Uncertainty		0.00 ft	Wellhead Elevation:	0.00 ft	Ground Level:	5,217.80 ft

Wellbore	OH				
Magnetics	Model Name	Sample Date	Declination (°)	Dip Angle (°)	Field Strength (nT)
	HDGM	4/3/2018	8.28	67.20	52,807

Design	Plan 1			
Audit Notes:				
Version:	Phase:	PLAN	Tie On Depth:	0.00
Vertical Section:	Depth From (TVD) (ft)	+N/-S (ft)	+E/-W (ft)	Direction (°)
	0.00	0.00	0.00	359.789

Plan Sections										
Measured Depth (ft)	Inclination (°)	Azimuth (°)	Vertical Depth (ft)	+N/-S (ft)	+E/-W (ft)	Dogleg Rate (°/100ft)	Build Rate (°/100ft)	Turn Rate (°/100ft)	TFO (°)	Target
0.00	0.00	0.000	0.00	0.00	0.00	0.00	0.00	0.00	0.00	
100.00	0.00	0.000	100.00	0.00	0.00	0.00	0.00	0.00	0.00	
400.00	6.00	109.272	399.45	-5.18	14.81	2.00	2.00	0.00	109.27	
1,506.61	6.00	109.272	1,500.00	-43.36	124.00	0.00	0.00	0.00	0.00	
1,706.61	6.00	109.272	1,698.90	-50.26	143.74	0.00	0.00	0.00	0.00	
3,271.90	37.31	109.271	3,135.71	-238.52	682.18	2.00	2.00	0.00	0.00	
3,572.02	37.31	109.271	3,374.43	-298.55	853.88	0.00	0.00	0.00	0.00	
6,059.07	0.00	0.000	5,689.44	-556.47	1,591.56	1.50	-1.50	0.00	180.00	
7,181.17	0.00	0.000	6,811.54	-556.47	1,591.56	0.00	0.00	0.00	0.00	
7,931.17	90.00	359.789	7,289.00	-79.01	1,589.80	12.00	12.00	-0.03	359.79	
17,925.14	90.00	359.789	7,289.00	9,914.90	1,552.96	0.00	0.00	0.00	0.00	CC 240-1411H PBHL

Database:	Casper District	Local Co-ordinate Reference:	Well Critter Creek 240-1411H
Company:	HighPoint Resources	TVD Reference:	GL 5217.8' & KB 20' @ 5237.80ft
Project:	Weld County, CO NAD 83	MD Reference:	GL 5217.8' & KB 20' @ 5237.80ft
Site:	Critter Creek 14 SW Pad	North Reference:	True
Well:	Critter Creek 240-1411H	Survey Calculation Method:	Minimum Curvature
Wellbore:	OH		
Design:	Plan 1		

Planned Survey									
Measured Depth (ft)	Inclination (°)	Azimuth (°)	Vertical Depth (ft)	+N/-S (ft)	+E/-W (ft)	Vertical Section (ft)	Dogleg Rate (°/100ft)	Build Rate (°/100ft)	Turn Rate (°/100ft)
0.00	0.00	0.000	0.00	0.00	0.00	0.00	0.00	0.00	0.00
100.00	0.00	0.000	100.00	0.00	0.00	0.00	0.00	0.00	0.00
Start Build 2.00									
200.00	2.00	109.272	199.98	-0.58	1.65	-0.58	2.00	2.00	0.00
300.00	4.00	109.272	299.84	-2.30	6.59	-2.33	2.00	2.00	0.00
400.00	6.00	109.272	399.45	-5.18	14.81	-5.23	2.00	2.00	0.00
Start 1106.61 hold at 400.00 MD									
500.00	6.00	109.272	498.90	-8.63	24.68	-8.72	0.00	0.00	0.00
600.00	6.00	109.272	598.36	-12.08	34.55	-12.21	0.00	0.00	0.00
700.00	6.00	109.272	697.81	-15.53	44.42	-15.69	0.00	0.00	0.00
800.00	6.00	109.272	797.26	-18.98	54.28	-19.18	0.00	0.00	0.00
900.00	6.00	109.272	896.71	-22.43	64.15	-22.67	0.00	0.00	0.00
1,000.00	6.00	109.272	996.17	-25.88	74.02	-26.15	0.00	0.00	0.00
1,100.00	6.00	109.272	1,095.62	-29.33	83.88	-29.64	0.00	0.00	0.00
1,200.00	6.00	109.272	1,195.07	-32.78	93.75	-33.12	0.00	0.00	0.00
1,300.00	6.00	109.272	1,294.52	-36.23	103.62	-36.61	0.00	0.00	0.00
1,400.00	6.00	109.272	1,393.97	-39.68	113.49	-40.10	0.00	0.00	0.00
1,488.51	6.00	109.272	1,482.00	-42.73	122.22	-43.18	0.00	0.00	0.00
Fox Hills-Pierre contact									
1,500.00	6.00	109.272	1,493.43	-43.13	123.35	-43.58	0.00	0.00	0.00
1,506.61	6.00	109.272	1,500.00	-43.36	124.00	-43.81	0.00	0.00	0.00
Start 200.00 hold at 1506.61 MD									
1,600.00	6.00	109.272	1,592.88	-46.58	133.22	-47.07	0.00	0.00	0.00
1,700.00	6.00	109.272	1,692.33	-50.03	143.09	-50.56	0.00	0.00	0.00
1,706.61	6.00	109.272	1,698.90	-50.26	143.74	-50.79	0.00	0.00	0.00
Start DLS 2.00 TFO 0.00									
1,800.00	7.87	109.272	1,791.61	-53.98	154.38	-54.55	2.00	2.00	0.00
1,900.00	9.87	109.272	1,890.41	-59.07	168.93	-59.69	2.00	2.00	0.00
2,000.00	11.87	109.272	1,988.61	-65.29	186.73	-65.98	2.00	2.00	0.00
2,100.00	13.87	109.272	2,086.09	-72.64	207.75	-73.40	2.00	2.00	0.00
2,200.00	15.87	109.272	2,182.74	-81.11	231.97	-81.96	2.00	2.00	0.00
2,300.00	17.87	109.272	2,278.43	-90.68	259.36	-91.64	2.00	2.00	0.00
2,400.00	19.87	109.272	2,373.05	-101.36	289.88	-102.42	2.00	2.00	0.00
2,500.00	21.87	109.272	2,466.49	-113.11	323.51	-114.30	2.00	2.00	0.00
2,600.00	23.87	109.272	2,558.63	-125.94	360.19	-127.26	2.00	2.00	0.00
2,700.00	25.87	109.272	2,649.35	-139.82	399.88	-141.29	2.00	2.00	0.00
2,800.00	27.87	109.272	2,738.55	-154.73	442.54	-156.36	2.00	2.00	0.00
2,900.00	29.87	109.272	2,826.12	-170.66	488.11	-172.46	2.00	2.00	0.00
3,000.00	31.87	109.272	2,911.95	-187.60	536.54	-189.57	2.00	2.00	0.00
3,100.00	33.87	109.272	2,995.94	-205.51	587.77	-207.67	2.00	2.00	0.00
3,200.00	35.87	109.272	3,077.98	-224.37	641.73	-226.74	2.00	2.00	0.00
3,271.90	37.31	109.271	3,135.71	-238.52	682.18	-241.03	2.00	2.00	0.00
Start 300.12 hold at 3271.90 MD									
3,300.00	37.31	109.271	3,158.06	-244.14	698.26	-246.71	0.00	0.00	0.00
3,333.87	37.31	109.271	3,185.00	-250.91	717.63	-253.55	0.00	0.00	0.00
Pierre A									
3,400.00	37.31	109.271	3,237.60	-264.14	755.47	-266.92	0.00	0.00	0.00
3,500.00	37.31	109.271	3,317.15	-284.15	812.68	-287.14	0.00	0.00	0.00
3,572.02	37.31	109.271	3,374.43	-298.55	853.88	-301.69	0.00	0.00	0.00
Start Drop -1.50									
3,600.00	36.89	109.271	3,396.75	-304.12	869.81	-307.32	1.50	-1.50	0.00
3,700.00	35.39	109.271	3,477.51	-323.58	925.48	-326.99	1.50	-1.50	0.00
3,800.00	33.89	109.271	3,559.78	-342.34	979.13	-345.94	1.50	-1.50	0.00

Database:	Casper District	Local Co-ordinate Reference:	Well Critter Creek 240-1411H
Company:	HighPoint Resources	TVD Reference:	GL 5217.8' & KB 20' @ 5237.80ft
Project:	Weld County, CO NAD 83	MD Reference:	GL 5217.8' & KB 20' @ 5237.80ft
Site:	Critter Creek 14 SW Pad	North Reference:	True
Well:	Critter Creek 240-1411H	Survey Calculation Method:	Minimum Curvature
Wellbore:	OH		
Design:	Plan 1		

Planned Survey									
Measured Depth (ft)	Inclination (°)	Azimuth (°)	Vertical Depth (ft)	+N/-S (ft)	+E/-W (ft)	Vertical Section (ft)	Dogleg Rate (°/100ft)	Build Rate (°/100ft)	Turn Rate (°/100ft)
3,900.00	32.39	109.271	3,643.52	-360.38	1,030.73	-364.18	1.50	-1.50	0.00
4,000.00	30.89	109.271	3,728.66	-377.69	1,080.24	-381.67	1.50	-1.50	0.00
4,100.00	29.39	109.271	3,815.14	-394.26	1,127.63	-398.41	1.50	-1.50	0.00
4,200.00	27.89	109.271	3,902.90	-410.08	1,172.87	-414.40	1.50	-1.50	0.00
4,300.00	26.39	109.271	3,991.89	-425.13	1,215.92	-429.61	1.50	-1.50	0.00
4,400.00	24.89	109.271	4,082.05	-439.41	1,256.76	-444.04	1.50	-1.50	0.00
4,459.27	24.00	109.271	4,136.00	-447.50	1,279.91	-452.22	1.50	-1.50	0.00
Parkman									
4,500.00	23.39	109.271	4,173.30	-452.91	1,295.36	-457.67	1.50	-1.50	0.00
4,600.00	21.89	109.271	4,265.60	-465.61	1,331.69	-470.51	1.50	-1.50	0.00
4,700.00	20.39	109.271	4,358.87	-477.51	1,365.73	-482.54	1.50	-1.50	0.00
4,800.00	18.89	109.271	4,453.05	-488.60	1,397.45	-493.74	1.50	-1.50	0.00
4,900.00	17.39	109.271	4,548.08	-498.87	1,426.83	-504.12	1.50	-1.50	0.00
5,000.00	15.89	109.271	4,643.89	-508.32	1,453.85	-513.67	1.50	-1.50	0.00
5,100.00	14.39	109.271	4,740.42	-516.94	1,478.50	-522.38	1.50	-1.50	0.00
5,200.00	12.89	109.271	4,837.60	-524.72	1,500.75	-530.24	1.50	-1.50	0.00
5,300.00	11.39	109.271	4,935.36	-531.66	1,520.60	-537.26	1.50	-1.50	0.00
5,400.00	9.89	109.271	5,033.64	-537.75	1,538.02	-543.41	1.50	-1.50	0.00
5,500.00	8.39	109.271	5,132.37	-542.99	1,553.01	-548.71	1.50	-1.50	0.00
5,600.00	6.89	109.271	5,231.48	-547.38	1,565.55	-553.14	1.50	-1.50	0.00
5,700.00	5.39	109.271	5,330.90	-550.90	1,575.64	-556.70	1.50	-1.50	0.00
5,800.00	3.89	109.271	5,430.57	-553.57	1,583.27	-559.40	1.50	-1.50	0.00
5,900.00	2.39	109.271	5,530.42	-555.38	1,588.43	-561.22	1.50	-1.50	0.00
6,000.00	0.89	109.271	5,630.37	-556.32	1,591.13	-562.18	1.50	-1.50	0.00
6,059.07	0.00	0.000	5,689.44	-556.47	1,591.56	-562.33	1.50	-1.50	0.00
Start 1122.10 hold at 6059.07 MD									
6,100.00	0.00	0.000	5,730.37	-556.47	1,591.56	-562.33	0.00	0.00	0.00
6,200.00	0.00	0.000	5,830.37	-556.47	1,591.56	-562.33	0.00	0.00	0.00
6,300.00	0.00	0.000	5,930.37	-556.47	1,591.56	-562.33	0.00	0.00	0.00
6,400.00	0.00	0.000	6,030.37	-556.47	1,591.56	-562.33	0.00	0.00	0.00
6,500.00	0.00	0.000	6,130.37	-556.47	1,591.56	-562.33	0.00	0.00	0.00
6,600.00	0.00	0.000	6,230.37	-556.47	1,591.56	-562.33	0.00	0.00	0.00
6,700.00	0.00	0.000	6,330.37	-556.47	1,591.56	-562.33	0.00	0.00	0.00
6,800.00	0.00	0.000	6,430.37	-556.47	1,591.56	-562.33	0.00	0.00	0.00
6,900.00	0.00	0.000	6,530.37	-556.47	1,591.56	-562.33	0.00	0.00	0.00
7,000.00	0.00	0.000	6,630.37	-556.47	1,591.56	-562.33	0.00	0.00	0.00
7,100.00	0.00	0.000	6,730.37	-556.47	1,591.56	-562.33	0.00	0.00	0.00
7,181.17	0.00	0.000	6,811.54	-556.47	1,591.56	-562.33	0.00	0.00	0.00
Start DLS 12.00 TFO 359.79									
7,200.00	2.26	359.789	6,830.37	-556.10	1,591.56	-561.96	12.00	12.00	0.00
7,300.00	14.26	359.789	6,929.15	-541.76	1,591.51	-547.62	12.00	12.00	0.00
7,400.00	26.26	359.789	7,022.79	-507.19	1,591.38	-513.05	12.00	12.00	0.00
7,500.00	38.26	359.789	7,107.20	-453.92	1,591.18	-459.77	12.00	12.00	0.00
7,536.54	42.64	359.789	7,135.00	-430.21	1,591.09	-436.07	12.00	12.00	0.00
Sharon Springs									
7,598.93	50.13	359.789	7,178.00	-385.08	1,590.93	-390.93	12.00	12.00	0.00
Niobrara A Chalk									
7,600.00	50.26	359.789	7,178.69	-384.25	1,590.93	-390.11	12.00	12.00	0.00
7,614.85	52.04	359.789	7,188.00	-372.69	1,590.88	-378.55	12.00	12.00	0.00
Niobrara A Marl									
7,631.48	54.04	359.789	7,198.00	-359.40	1,590.83	-365.26	12.00	12.00	0.00
Nio B1 Chalk									
7,679.10	59.75	359.789	7,224.00	-319.53	1,590.69	-325.38	12.00	12.00	0.00

Database:	Casper District	Local Co-ordinate Reference:	Well Critter Creek 240-1411H
Company:	HighPoint Resources	TVD Reference:	GL 5217.8' & KB 20' @ 5237.80ft
Project:	Weld County, CO NAD 83	MD Reference:	GL 5217.8' & KB 20' @ 5237.80ft
Site:	Critter Creek 14 SW Pad	North Reference:	True
Well:	Critter Creek 240-1411H	Survey Calculation Method:	Minimum Curvature
Wellbore:	OH		
Design:	Plan 1		

Planned Survey									
Measured Depth (ft)	Inclination (°)	Azimuth (°)	Vertical Depth (ft)	+N/-S (ft)	+E/-W (ft)	Vertical Section (ft)	Dogleg Rate (°/100ft)	Build Rate (°/100ft)	Turn Rate (°/100ft)
Nio B1 Marl									
7,700.00	62.26	359.789	7,234.13	-301.25	1,590.62	-307.11	12.00	12.00	0.00
7,722.20	64.92	359.789	7,244.00	-281.37	1,590.55	-287.23	12.00	12.00	0.00
Niobrara B Chalk									
7,800.00	74.26	359.789	7,271.10	-208.53	1,590.28	-214.39	12.00	12.00	0.00
7,833.25	78.25	359.789	7,279.00	-176.24	1,590.16	-182.09	12.00	12.00	0.00
Niobrara B Marl									
7,900.00	86.26	359.789	7,287.99	-110.15	1,589.91	-116.01	12.00	12.00	0.00
7,929.02	89.74	359.789	7,289.00	-81.16	1,589.81	-87.01	12.00	12.00	0.00
Niobrara B Chalk Landing Target - TD									
7,931.17	90.00	359.789	7,289.00	-79.01	1,589.80	-84.86	12.00	12.00	0.00
Start 9993.97 hold at 7931.17 MD									
8,000.00	90.00	359.789	7,289.00	-10.18	1,589.55	-16.03	0.00	0.00	0.00
8,100.00	90.00	359.789	7,289.00	89.82	1,589.18	83.97	0.00	0.00	0.00
8,200.00	90.00	359.789	7,289.00	189.82	1,588.81	183.97	0.00	0.00	0.00
8,300.00	90.00	359.789	7,289.00	289.82	1,588.44	283.97	0.00	0.00	0.00
8,400.00	90.00	359.789	7,289.00	389.82	1,588.07	383.97	0.00	0.00	0.00
8,500.00	90.00	359.789	7,289.00	489.82	1,587.70	483.97	0.00	0.00	0.00
8,600.00	90.00	359.789	7,289.00	589.82	1,587.33	583.97	0.00	0.00	0.00
8,700.00	90.00	359.789	7,289.00	689.82	1,586.97	683.97	0.00	0.00	0.00
8,800.00	90.00	359.789	7,289.00	789.82	1,586.60	783.97	0.00	0.00	0.00
8,900.00	90.00	359.789	7,289.00	889.82	1,586.23	883.97	0.00	0.00	0.00
9,000.00	90.00	359.789	7,289.00	989.82	1,585.86	983.97	0.00	0.00	0.00
9,100.00	90.00	359.789	7,289.00	1,089.82	1,585.49	1,083.97	0.00	0.00	0.00
9,200.00	90.00	359.789	7,289.00	1,189.81	1,585.12	1,183.97	0.00	0.00	0.00
9,300.00	90.00	359.789	7,289.00	1,289.81	1,584.75	1,283.97	0.00	0.00	0.00
9,400.00	90.00	359.789	7,289.00	1,389.81	1,584.39	1,383.97	0.00	0.00	0.00
9,500.00	90.00	359.789	7,289.00	1,489.81	1,584.02	1,483.97	0.00	0.00	0.00
9,600.00	90.00	359.789	7,289.00	1,589.81	1,583.65	1,583.97	0.00	0.00	0.00
9,700.00	90.00	359.789	7,289.00	1,689.81	1,583.28	1,683.97	0.00	0.00	0.00
9,800.00	90.00	359.789	7,289.00	1,789.81	1,582.91	1,783.97	0.00	0.00	0.00
9,900.00	90.00	359.789	7,289.00	1,889.81	1,582.54	1,883.97	0.00	0.00	0.00
10,000.00	90.00	359.789	7,289.00	1,989.81	1,582.17	1,983.97	0.00	0.00	0.00
10,100.00	90.00	359.789	7,289.00	2,089.81	1,581.80	2,083.97	0.00	0.00	0.00
10,200.00	90.00	359.789	7,289.00	2,189.81	1,581.44	2,183.97	0.00	0.00	0.00
10,300.00	90.00	359.789	7,289.00	2,289.81	1,581.07	2,283.97	0.00	0.00	0.00
10,400.00	90.00	359.789	7,289.00	2,389.81	1,580.70	2,383.97	0.00	0.00	0.00
10,500.00	90.00	359.789	7,289.00	2,489.81	1,580.33	2,483.97	0.00	0.00	0.00
10,600.00	90.00	359.789	7,289.00	2,589.80	1,579.96	2,583.97	0.00	0.00	0.00
10,700.00	90.00	359.789	7,289.00	2,689.80	1,579.59	2,683.97	0.00	0.00	0.00
10,800.00	90.00	359.789	7,289.00	2,789.80	1,579.22	2,783.97	0.00	0.00	0.00
10,900.00	90.00	359.789	7,289.00	2,889.80	1,578.86	2,883.97	0.00	0.00	0.00
11,000.00	90.00	359.789	7,289.00	2,989.80	1,578.49	2,983.97	0.00	0.00	0.00
11,100.00	90.00	359.789	7,289.00	3,089.80	1,578.12	3,083.97	0.00	0.00	0.00
11,200.00	90.00	359.789	7,289.00	3,189.80	1,577.75	3,183.97	0.00	0.00	0.00
11,300.00	90.00	359.789	7,289.00	3,289.80	1,577.38	3,283.97	0.00	0.00	0.00
11,400.00	90.00	359.789	7,289.00	3,389.80	1,577.01	3,383.97	0.00	0.00	0.00
11,500.00	90.00	359.789	7,289.00	3,489.80	1,576.64	3,483.97	0.00	0.00	0.00
11,600.00	90.00	359.789	7,289.00	3,589.80	1,576.28	3,583.97	0.00	0.00	0.00
11,700.00	90.00	359.789	7,289.00	3,689.80	1,575.91	3,683.97	0.00	0.00	0.00
11,800.00	90.00	359.789	7,289.00	3,789.80	1,575.54	3,783.97	0.00	0.00	0.00
11,900.00	90.00	359.789	7,289.00	3,889.80	1,575.17	3,883.97	0.00	0.00	0.00
12,000.00	90.00	359.789	7,289.00	3,989.80	1,574.80	3,983.97	0.00	0.00	0.00
12,100.00	90.00	359.789	7,289.00	4,089.79	1,574.43	4,083.97	0.00	0.00	0.00



Database:	Casper District	Local Co-ordinate Reference:	Well Critter Creek 240-1411H
Company:	HighPoint Resources	TVD Reference:	GL 5217.8' & KB 20' @ 5237.80ft
Project:	Weld County, CO NAD 83	MD Reference:	GL 5217.8' & KB 20' @ 5237.80ft
Site:	Critter Creek 14 SW Pad	North Reference:	True
Well:	Critter Creek 240-1411H	Survey Calculation Method:	Minimum Curvature
Wellbore:	OH		
Design:	Plan 1		

Planned Survey									
Measured Depth (ft)	Inclination (°)	Azimuth (°)	Vertical Depth (ft)	+N/-S (ft)	+E/-W (ft)	Vertical Section (ft)	Dogleg Rate (°/100ft)	Build Rate (°/100ft)	Turn Rate (°/100ft)
12,200.00	90.00	359.789	7,289.00	4,189.79	1,574.06	4,183.97	0.00	0.00	0.00
12,300.00	90.00	359.789	7,289.00	4,289.79	1,573.69	4,283.97	0.00	0.00	0.00
12,400.00	90.00	359.789	7,289.00	4,389.79	1,573.33	4,383.97	0.00	0.00	0.00
12,500.00	90.00	359.789	7,289.00	4,489.79	1,572.96	4,483.97	0.00	0.00	0.00
12,600.00	90.00	359.789	7,289.00	4,589.79	1,572.59	4,583.97	0.00	0.00	0.00
12,700.00	90.00	359.789	7,289.00	4,689.79	1,572.22	4,683.97	0.00	0.00	0.00
12,800.00	90.00	359.789	7,289.00	4,789.79	1,571.85	4,783.97	0.00	0.00	0.00
12,900.00	90.00	359.789	7,289.00	4,889.79	1,571.48	4,883.97	0.00	0.00	0.00
13,000.00	90.00	359.789	7,289.00	4,989.79	1,571.11	4,983.97	0.00	0.00	0.00
13,100.00	90.00	359.789	7,289.00	5,089.79	1,570.75	5,083.97	0.00	0.00	0.00
13,200.00	90.00	359.789	7,289.00	5,189.79	1,570.38	5,183.97	0.00	0.00	0.00
13,300.00	90.00	359.789	7,289.00	5,289.79	1,570.01	5,283.97	0.00	0.00	0.00
13,400.00	90.00	359.789	7,289.00	5,389.79	1,569.64	5,383.97	0.00	0.00	0.00
13,500.00	90.00	359.789	7,289.00	5,489.79	1,569.27	5,483.97	0.00	0.00	0.00
13,600.00	90.00	359.789	7,289.00	5,589.78	1,568.90	5,583.97	0.00	0.00	0.00
13,700.00	90.00	359.789	7,289.00	5,689.78	1,568.53	5,683.97	0.00	0.00	0.00
13,800.00	90.00	359.789	7,289.00	5,789.78	1,568.17	5,783.97	0.00	0.00	0.00
13,900.00	90.00	359.789	7,289.00	5,889.78	1,567.80	5,883.97	0.00	0.00	0.00
14,000.00	90.00	359.789	7,289.00	5,989.78	1,567.43	5,983.97	0.00	0.00	0.00
14,100.00	90.00	359.789	7,289.00	6,089.78	1,567.06	6,083.97	0.00	0.00	0.00
14,200.00	90.00	359.789	7,289.00	6,189.78	1,566.69	6,183.97	0.00	0.00	0.00
14,300.00	90.00	359.789	7,289.00	6,289.78	1,566.32	6,283.97	0.00	0.00	0.00
14,400.00	90.00	359.789	7,289.00	6,389.78	1,565.95	6,383.97	0.00	0.00	0.00
14,500.00	90.00	359.789	7,289.00	6,489.78	1,565.58	6,483.97	0.00	0.00	0.00
14,600.00	90.00	359.789	7,289.00	6,589.78	1,565.22	6,583.97	0.00	0.00	0.00
14,700.00	90.00	359.789	7,289.00	6,689.78	1,564.85	6,683.97	0.00	0.00	0.00
14,800.00	90.00	359.789	7,289.00	6,789.78	1,564.48	6,783.97	0.00	0.00	0.00
14,900.00	90.00	359.789	7,289.00	6,889.78	1,564.11	6,883.97	0.00	0.00	0.00
15,000.00	90.00	359.789	7,289.00	6,989.78	1,563.74	6,983.97	0.00	0.00	0.00
15,100.00	90.00	359.789	7,289.00	7,089.77	1,563.37	7,083.97	0.00	0.00	0.00
15,200.00	90.00	359.789	7,289.00	7,189.77	1,563.00	7,183.97	0.00	0.00	0.00
15,300.00	90.00	359.789	7,289.00	7,289.77	1,562.64	7,283.97	0.00	0.00	0.00
15,400.00	90.00	359.789	7,289.00	7,389.77	1,562.27	7,383.97	0.00	0.00	0.00
15,500.00	90.00	359.789	7,289.00	7,489.77	1,561.90	7,483.97	0.00	0.00	0.00
15,600.00	90.00	359.789	7,289.00	7,589.77	1,561.53	7,583.97	0.00	0.00	0.00
15,700.00	90.00	359.789	7,289.00	7,689.77	1,561.16	7,683.97	0.00	0.00	0.00
15,800.00	90.00	359.789	7,289.00	7,789.77	1,560.79	7,783.97	0.00	0.00	0.00
15,900.00	90.00	359.789	7,289.00	7,889.77	1,560.42	7,883.97	0.00	0.00	0.00
16,000.00	90.00	359.789	7,289.00	7,989.77	1,560.06	7,983.97	0.00	0.00	0.00
16,100.00	90.00	359.789	7,289.00	8,089.77	1,559.69	8,083.97	0.00	0.00	0.00
16,200.00	90.00	359.789	7,289.00	8,189.77	1,559.32	8,183.97	0.00	0.00	0.00
16,300.00	90.00	359.789	7,289.00	8,289.77	1,558.95	8,283.97	0.00	0.00	0.00
16,400.00	90.00	359.789	7,289.00	8,389.77	1,558.58	8,383.97	0.00	0.00	0.00
16,500.00	90.00	359.789	7,289.00	8,489.76	1,558.21	8,483.97	0.00	0.00	0.00
16,600.00	90.00	359.789	7,289.00	8,589.76	1,557.84	8,583.97	0.00	0.00	0.00
16,700.00	90.00	359.789	7,289.00	8,689.76	1,557.47	8,683.97	0.00	0.00	0.00
16,800.00	90.00	359.789	7,289.00	8,789.76	1,557.11	8,783.97	0.00	0.00	0.00
16,900.00	90.00	359.789	7,289.00	8,889.76	1,556.74	8,883.97	0.00	0.00	0.00
17,000.00	90.00	359.789	7,289.00	8,989.76	1,556.37	8,983.97	0.00	0.00	0.00
17,100.00	90.00	359.789	7,289.00	9,089.76	1,556.00	9,083.97	0.00	0.00	0.00
17,200.00	90.00	359.789	7,289.00	9,189.76	1,555.63	9,183.97	0.00	0.00	0.00
17,300.00	90.00	359.789	7,289.00	9,289.76	1,555.26	9,283.97	0.00	0.00	0.00
17,400.00	90.00	359.789	7,289.00	9,389.76	1,554.89	9,383.97	0.00	0.00	0.00
17,500.00	90.00	359.789	7,289.00	9,489.76	1,554.53	9,483.97	0.00	0.00	0.00

Database:	Casper District	Local Co-ordinate Reference:	Well Critter Creek 240-1411H
Company:	HighPoint Resources	TVD Reference:	GL 5217.8' & KB 20' @ 5237.80ft
Project:	Weld County, CO NAD 83	MD Reference:	GL 5217.8' & KB 20' @ 5237.80ft
Site:	Critter Creek 14 SW Pad	North Reference:	True
Well:	Critter Creek 240-1411H	Survey Calculation Method:	Minimum Curvature
Wellbore:	OH		
Design:	Plan 1		

Planned Survey									
Measured Depth (ft)	Inclination (°)	Azimuth (°)	Vertical Depth (ft)	+N/-S (ft)	+E/-W (ft)	Vertical Section (ft)	Dogleg Rate (°/100ft)	Build Rate (°/100ft)	Turn Rate (°/100ft)
17,600.00	90.00	359.789	7,289.00	9,589.76	1,554.16	9,583.97	0.00	0.00	0.00
17,700.00	90.00	359.789	7,289.00	9,689.76	1,553.79	9,683.97	0.00	0.00	0.00
17,800.00	90.00	359.789	7,289.00	9,789.76	1,553.42	9,783.97	0.00	0.00	0.00
17,900.00	90.00	359.789	7,289.00	9,889.76	1,553.05	9,883.97	0.00	0.00	0.00
17,925.14	90.00	359.789	7,289.00	9,914.90	1,552.96	9,909.11	0.00	0.00	0.00
TD at 17925.14									

Design Targets									
Target Name	Dip Angle (°)	Dip Dir. (°)	TVD (ft)	+N/-S (ft)	+E/-W (ft)	Northing (usft)	Easting (usft)	Latitude	Longitude
- hit/miss target									
- Shape									
CC 240-1411H PBHL	0.00	0.000	7,289.00	9,914.90	1,552.96	1,588,446.56	3,303,593.49	40° 56' 36.550 N	104° 24' 3.960 W
- plan hits target center									
- Point									
CC 240-1411H LP	0.00	0.000	7,289.00	-79.01	1,589.80	1,578,453.89	3,303,753.54	40° 54' 57.805 N	104° 24' 3.488 W
- plan hits target center									
- Point									

Formations						
Measured Depth (ft)	Vertical Depth (ft)	Name	Lithology	Dip (°)	Dip Direction (°)	
1,488.51	1,482.00	Fox Hills-Pierre contact				
3,333.87	3,185.00	Pierre A				
4,459.27	4,136.00	Parkman				
7,536.54	7,135.00	Sharon Springs				
7,598.93	7,178.00	Niobrara A Chalk				
7,614.85	7,188.00	Niobrara A Marl				
7,631.48	7,198.00	Nio B1 Chalk				
7,679.10	7,224.00	Nio B1 Marl				
7,722.20	7,244.00	Niobrara B Chalk				
7,833.25	7,279.00	Niobrara B Marl				
7,929.02	7,289.00	Niobrara B Chalk Landing Target				
7,929.02	7,289.00	TD				

Database:	Casper District	Local Co-ordinate Reference:	Well Critter Creek 240-1411H
Company:	HighPoint Resources	TVD Reference:	GL 5217.8' & KB 20' @ 5237.80ft
Project:	Weld County, CO NAD 83	MD Reference:	GL 5217.8' & KB 20' @ 5237.80ft
Site:	Critter Creek 14 SW Pad	North Reference:	True
Well:	Critter Creek 240-1411H	Survey Calculation Method:	Minimum Curvature
Wellbore:	OH		
Design:	Plan 1		

Plan Annotations				
Measured Depth (ft)	Vertical Depth (ft)	Local Coordinates		Comment
		+N/-S (ft)	+E/-W (ft)	
100.00	100.00	0.00	0.00	Start Build 2.00
400.00	399.45	-5.18	14.81	Start 1106.61 hold at 400.00 MD
1,506.61	1,500.00	-43.36	124.00	Start 200.00 hold at 1506.61 MD
1,706.61	1,698.90	-50.26	143.74	Start DLS 2.00 TFO 0.00
3,271.90	3,135.71	-238.52	682.18	Start 300.12 hold at 3271.90 MD
3,572.02	3,374.43	-298.55	853.88	Start Drop -1.50
6,059.07	5,689.44	-556.47	1,591.56	Start 1122.10 hold at 6059.07 MD
7,181.17	6,811.54	-556.47	1,591.56	Start DLS 12.00 TFO 359.79
7,931.17	7,289.00	-79.01	1,589.80	Start 9993.97 hold at 7931.17 MD
17,925.14	7,289.00	9,914.90	1,552.96	TD at 17925.14