

LOCATION DRAWING  
BLACK POWDER 2 WELL AND PRODUCTION PAD  
SECTION 10, TOWNSHIP 7 NORTH, RANGE 63 WEST OF THE 6TH P.M.

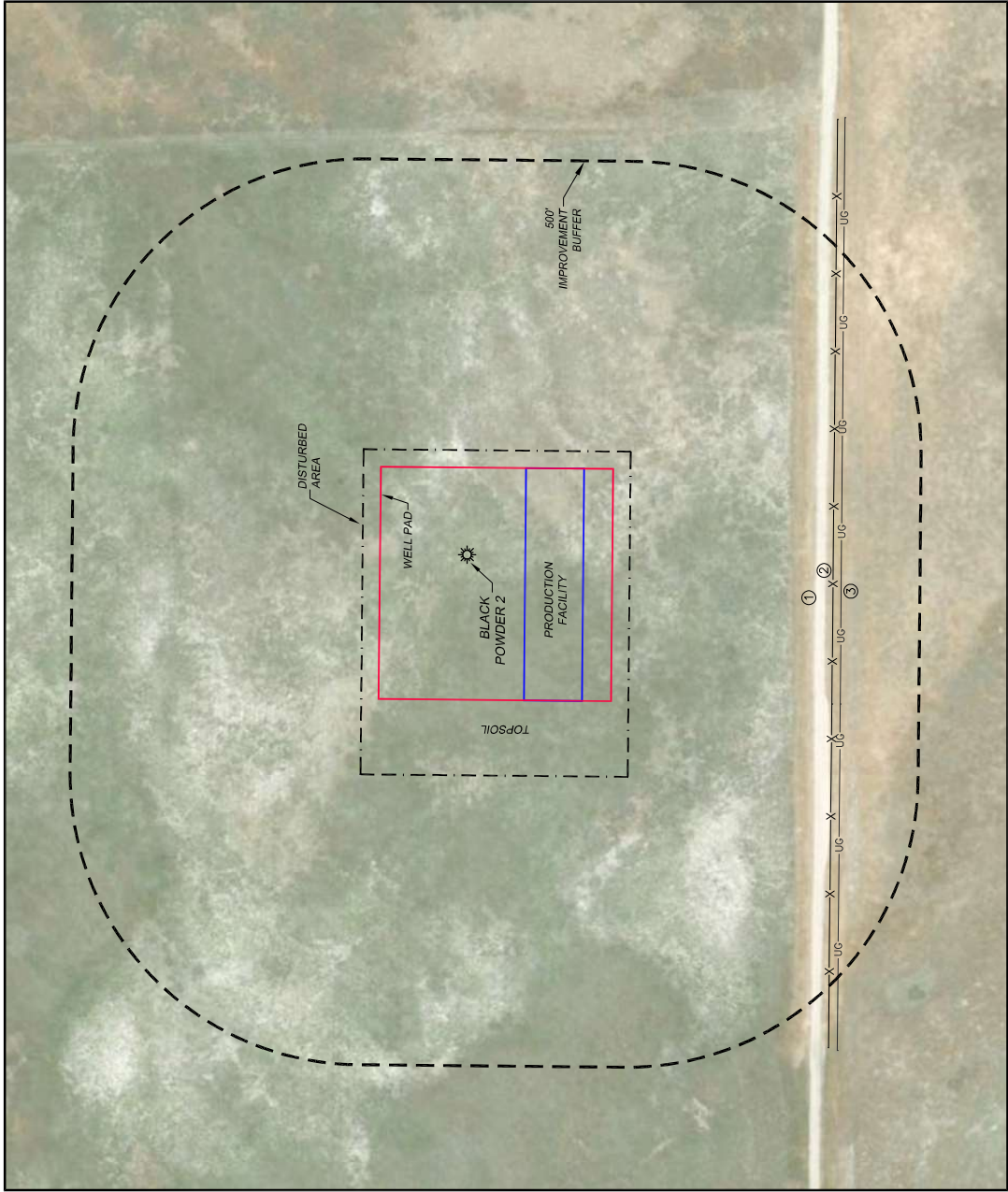

CULTURAL ITEMS:	
MEASURED FROM THE PROPOSED BLACK POWDER 2 WELLHEAD	
BUILDING:	3804' ± SE
BUILDING UNIT:	3955' ± SE
HIGH OCC. BLD. UNIT:	5280' ±
DES. OUTSIDE ACTIVITY AREA:	5280' ±
PUBLIC ROAD:	5280' ±
ABOVE GROUND UTILITY:	4268' ± SE
RAILROAD:	5280' ±
PROPERTY LINE:	600' ± S

CULTURAL ITEMS:	
MEASURED FROM THE NEAREST PROPOSED EQUIPMENT	
BUILDING:	3554' ± SE
BUILDING UNIT:	3705' ± SE
HIGH OCC. BLD. UNIT:	5280' ±
DES. OUTSIDE ACTIVITY AREA:	5280' ±
PUBLIC ROAD:	5280' ±
ABOVE GROUND UTILITY:	4019' ± SE
RAILROAD:	5280' ±
PROPERTY LINE:	400' ± S

IMPROVEMENTS:	
(AS MEASURED FROM THE PROPOSED BLACK POWDER 2 WELLHEAD)	
1. WELL ACCESS ROAD:	603' ± S
2. WIRE FENCE:	630' ± S
3. BURIED GAS LINE:	644' ± S

