

PROPOSED CUT-FILL EXHIBIT

BLACK POWDER 2 WELL AND PRODUCTION PAD

SECTION 10, TOWNSHIP 7 NORTH, RANGE 63 WEST OF THE 6TH P.M.

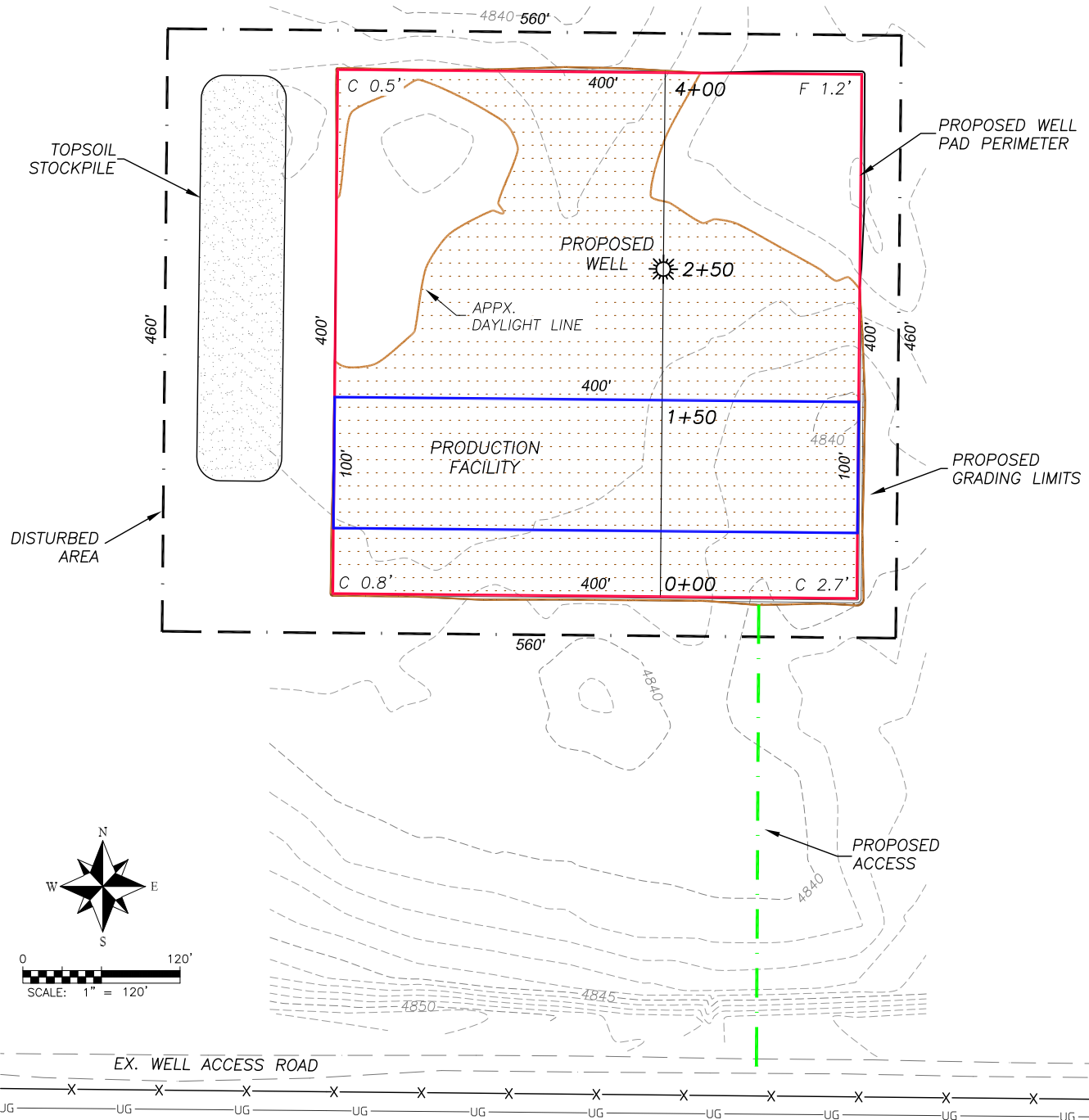

PROPOSED PAD DETAILS

Existing Elev. @ Well: 4837.7'
 Proposed Pad Elev.: 4737.4'
 Cut slope ratio: 2.0
 Fill slope ratio: 2.0
 Total cut: 3594± C.Y.
 Total fill: 594± C.Y.
 Topsoil @ 6" depth: 3000± C.Y.
 Well Pad: 3.7 Ac.
 Production Facility: 0.9 Ac.
 Disturbed Area: 5.9 Ac.

NOTES

1. Contour interval = 1'
2. No allowance has been made for soil expansion or compaction.
3. Proposed pad elevation is finish grade, no allowance has been made for gravel being placed on pad.
4. Balance Export Volume is based on removal of 6" of topsoil over entire pad.



Area of
Proposed Cut

**DALEY LAND
SURVEYING, INC.**
 303.953.9841

PROPOSED CROSS-SECTION EXHIBIT

BLACK POWDER 2 WELL AND PRODUCTION PAD

SECTION 10, TOWNSHIP 7 NORTH, RANGE 63 WEST OF THE 6TH P.M.

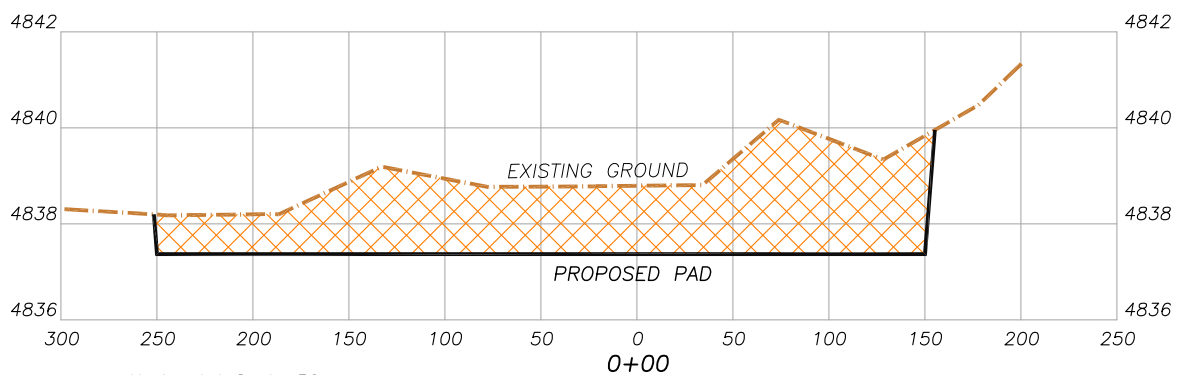
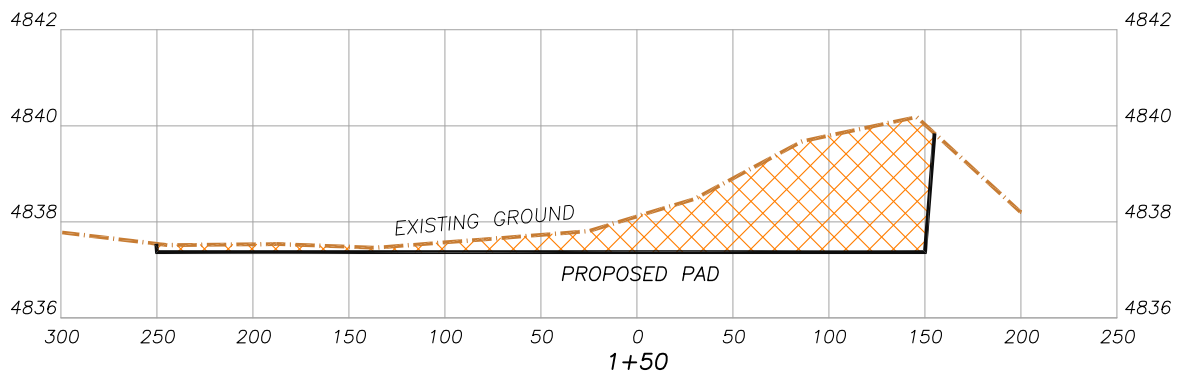
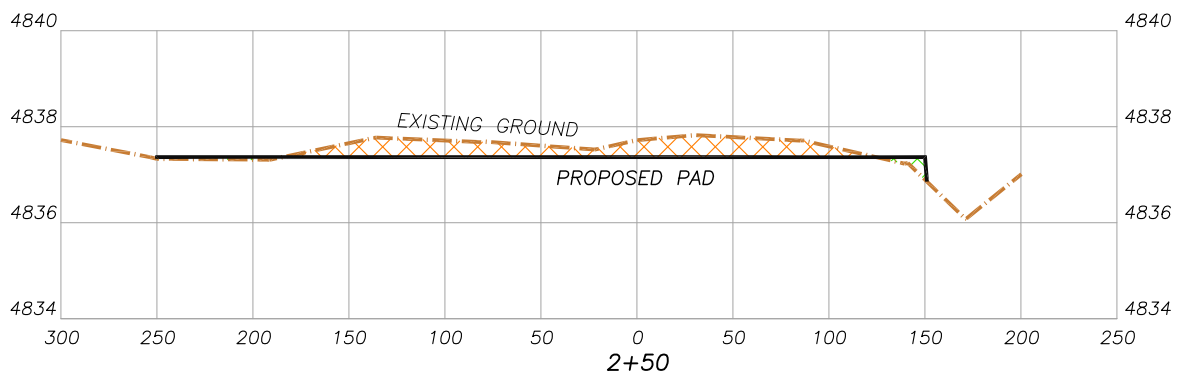
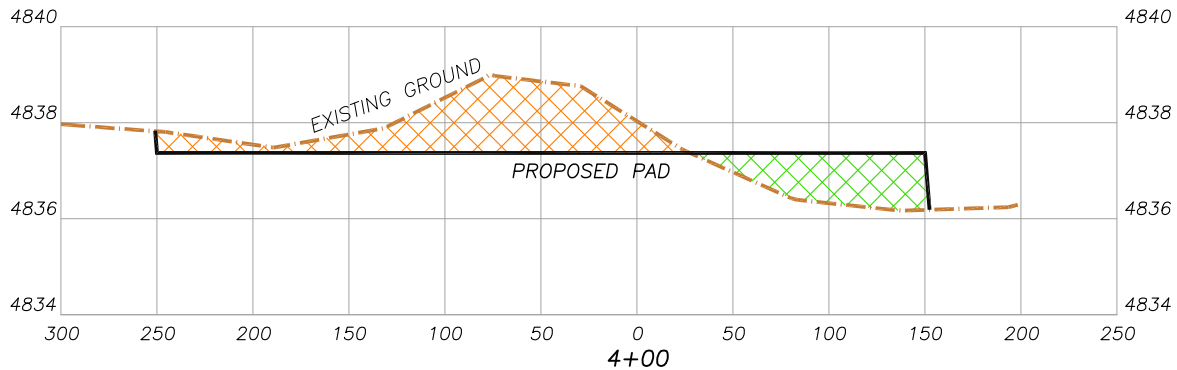

Horizontal Scale 50
Vertical Scale 2



PROPOSED RECLAMATION MAP
BLACK POWDER 2 WELL AND PRODUCTION PAD
SECTION 10, TOWNSHIP 7 NORTH, RANGE 63 WEST OF THE 6TH P.M.

