

**BAKER
HUGHES**
INTEQ

Slot: Reynolds 7-23
Well: Reynolds 7-23
Wellbore: Reynolds 7-23 PWB

Coordinates are in feet referenced to Slot

Created by: willera on 10/25/2009

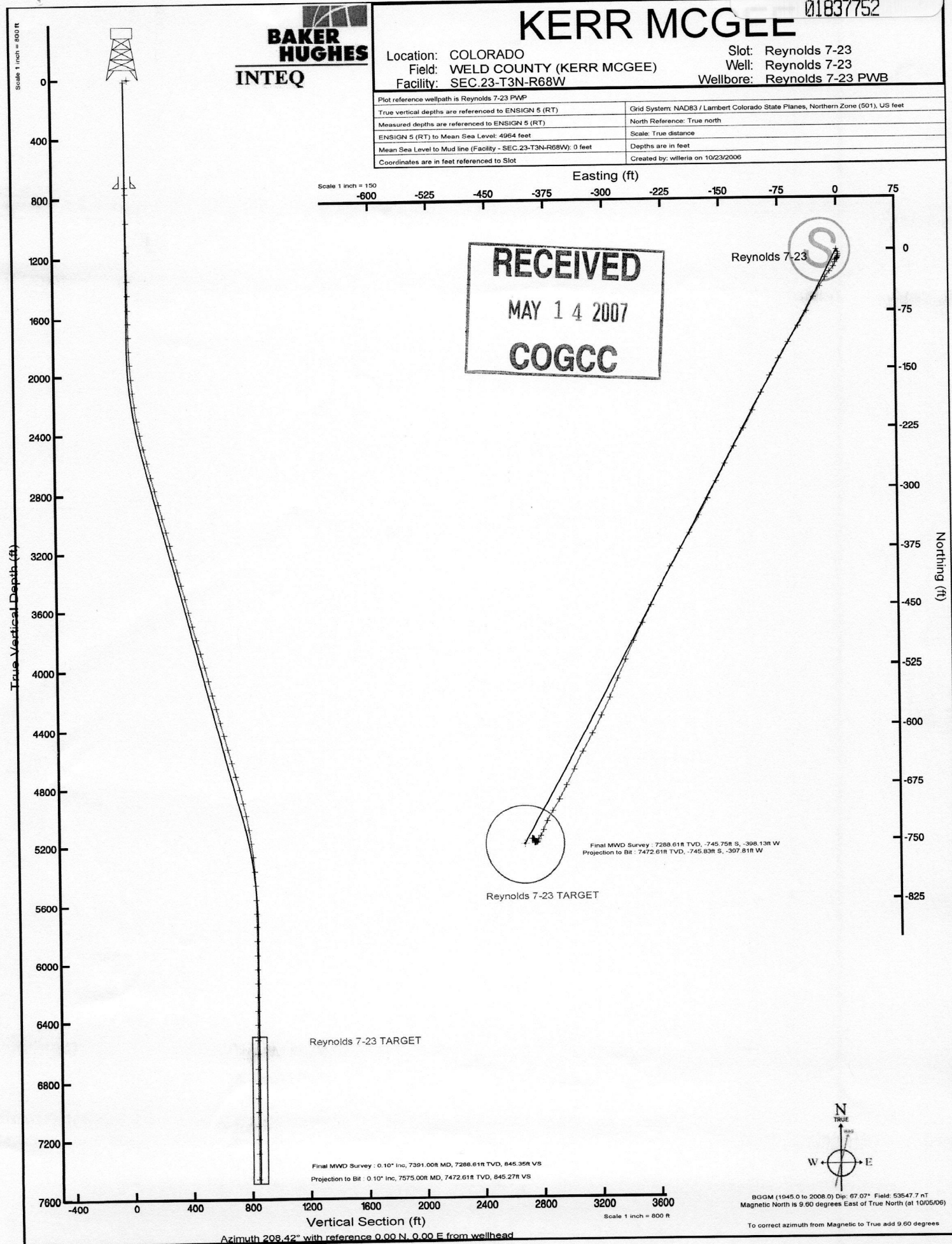



Actual Wellpath Report

Reynolds 7-23 AWP

Page 1 of 4



REFERENCE WELLPATH IDENTIFICATION

Operator	KERR MCGEE	Slot	Reynolds 7-23
Area	COLORADO	Well	Reynolds 7-23
Field	WELD COUNTY (KERR MCGEE)	Wellbore	Reynolds 7-23 AWB
Facility	SEC.23-T3N-R68W		

REPORT SETUP INFORMATION

Projection System	NAD83 / Lambert Colorado State Planes, Northern Zone (501), US feet	Software System	WellArchitect™ 1.2
North Reference	True	User	Thomsuzc
Scale	0.999957	Report Generated	10/31/06 at 14:26:51
Wellbore last revised	10/23/06	Database/Source file	WA_Denver/Reynolds_7

WELLPATH LOCATION

	Local coordinates		Grid coordinates		Geographic coordinates	
	North [feet]	East [feet]	Easting [US feet]	Northing [US feet]	Latitude [°]	Longitude [°]
Slot Location	-1103.79	1491.37	3148888.82	1321694.44	40 12 54.792N	104 58 00.696W
Facility Reference Pt			3147390.98	1322789.28	40 13 05.700N	104 58 19.920W
Field Reference Pt			3197771.84	1268891.29	40 04 09.600N	104 47 36.000W

WELLPATH DATUM

Calculation method	Minimum curvature	ENSIGN 5 (RT) to Facility Vertical Datum	4964.00 feet
Horizontal Reference Pt	Slot	ENSIGN 5 (RT) to Mean Sea Level	4964.00 feet
Vertical Reference Pt	ENSIGN 5 (RT)	Facility Vertical Datum to Mud Line (Facility)	0.00 feet
MD Reference Pt	ENSIGN 5 (RT)	Section Origin	N 0.00, E 0.00 ft
Field Vertical Reference	Mean Sea Level	Section Azimuth	208.42°



Actual Wellpath Report

Reynolds 7-23 AWP

Page 2 of 4



INTEQ

REFERENCE WELLPATH IDENTIFICATION

Operator	KERR MCGEE	Slot	Reynolds 7-23
Area	COLORADO	Well	Reynolds 7-23
Field	WELD COUNTY (KERR MCGEE)	Wellbore	Reynolds 7-23 AWB
Facility	SEC.23-T3N-R68W		

WELLPATH DATA (70 stations) † = interpolated/extrapolated station

MD [feet]	Inclination [°]	Azimuth [°]	TVD [feet]	Vert Sect [feet]	North [feet]	East [feet]	DLS [°/100ft]	Log Comment
0.00 †	0.000	0.000	0.00	0.00	0.00	0.00	0.00	
14.00	0.000	0.000	14.00	0.00	0.00	0.00	0.00	
771.00	0.600	154.400	770.99	2.33	-3.57	1.71	0.08	
964.00	0.900	177.700	963.97	4.23	-6.00	2.21	0.22	
1157.00	0.500	187.800	1156.96	6.32	-8.35	2.16	0.22	
1348.00	0.500	212.500	1347.95	7.93	-9.88	1.60	0.11	
1445.00	0.500	208.000	1444.94	8.77	-10.61	1.17	0.04	
1540.00	0.500	213.100	1539.94	9.60	-11.32	0.75	0.05	
1635.00	0.600	239.500	1634.94	10.44	-11.92	0.09	0.28	
1732.00	1.340	222.300	1731.92	11.98	-13.02	-1.11	0.81	
1828.00	2.500	181.200	1827.87	14.93	-15.94	-1.91	1.80	
1924.00	3.900	220.500	1923.73	19.98	-20.52	-4.07	2.63	
2020.00	5.100	220.900	2019.43	27.34	-26.23	-8.99	1.25	
2117.00	6.300	214.900	2115.95	36.84	-33.85	-14.85	1.38	
2213.00	8.600	213.500	2211.13	49.22	-44.16	-21.83	2.40	
2308.00	10.900	208.600	2304.76	65.28	-57.97	-30.05	2.57	
2405.00	12.500	207.200	2399.74	84.95	-75.36	-39.24	1.68	
2501.00	14.600	211.100	2493.06	107.43	-94.96	-50.24	2.38	
2597.00	15.100	211.400	2585.86	132.00	-115.99	-63.00	0.53	
2693.00	14.800	208.600	2678.61	156.75	-137.43	-75.39	0.81	
2789.00	14.900	207.500	2771.40	181.35	-159.15	-86.96	0.31	
2884.00	15.300	205.100	2863.12	206.08	-181.33	-97.91	0.78	
2980.00	15.400	207.500	2955.70	231.47	-204.11	-109.17	0.67	
3077.00	15.100	209.600	3049.28	256.98	-226.52	-121.36	0.65	
3173.00	15.400	208.900	3141.90	282.23	-248.55	-133.70	0.37	
3269.00	14.400	207.900	3234.68	306.91	-270.26	-145.44	1.08	
3365.00	14.300	208.900	3327.68	330.70	-291.19	-156.76	0.28	
3461.00	15.200	206.100	3420.52	355.13	-312.87	-168.03	1.20	
3556.00	15.300	208.900	3512.17	380.11	-335.03	-179.56	0.78	
3652.00	14.400	211.700	3604.97	404.69	-356.27	-191.96	1.20	
3747.00	15.100	210.700	3696.84	428.85	-376.96	-204.48	0.78	
3843.00	16.900	207.500	3789.11	455.30	-400.09	-217.31	2.09	
3940.00	17.300	207.200	3881.83	483.82	-425.43	-230.41	0.42	
4036.00	15.500	206.500	3973.92	510.91	-449.61	-242.66	1.89	
4131.00	14.400	208.600	4065.70	535.41	-471.34	-253.98	1.29	
4228.00	15.900	205.100	4159.33	560.74	-493.96	-265.39	1.81	
4324.00	15.600	203.700	4251.72	586.73	-517.69	-276.16	0.50	
4420.00	15.600	203.600	4344.19	612.46	-541.34	-286.52	0.03	
4514.00	15.600	204.400	4434.73	637.66	-564.43	-296.80	0.23	
4611.00	14.800	207.200	4528.33	663.06	-587.33	-307.85	1.12	



KerrMcGee

Actual Wellpath Report

Reynolds 7-23 AWP

Page 3 of 4



REFERENCE WELLPATH IDENTIFICATION

Operator	KERR MCGEE	Slot	Reynolds 7-23
Area	COLORADO	Well	Reynolds 7-23
Field	WELD COUNTY (KERR MCGEE)	Wellbore	Reynolds 7-23 AWB
Facility	SEC.23-T3N-R68W		

WELLPATH DATA (70 stations) † = interpolated/extrapolated station

MD [feet]	Inclination [°]	Azimuth [°]	TVD [feet]	Vert Sect [feet]	North [feet]	East [feet]	DLS [°/100ft]	Log Comment
4706.00	16.300	207.900	4619.85	688.52	-609.90	-319.63	1.59	
4802.00	15.600	208.600	4712.16	714.90	-633.14	-332.12	0.76	
4898.00	14.600	205.400	4804.84	739.89	-655.41	-343.49	1.36	
4994.00	13.100	206.800	4898.05	762.85	-676.05	-353.58	1.60	
5090.00	11.200	207.500	4991.89	783.05	-694.03	-362.79	1.99	
5186.00	9.800	209.900	5086.28	800.54	-709.38	-371.17	1.53	
5283.00	8.500	206.500	5182.05	815.96	-722.96	-378.48	1.45	
5378.00	6.200	199.400	5276.26	828.04	-734.08	-383.32	2.60	
5474.00	4.200	210.000	5371.87	836.68	-742.01	-386.80	2.30	
5569.00	2.200	216.300	5466.71	841.96	-746.50	-389.62	2.13	
5665.00	1.200	186.400	5562.67	844.72	-748.98	-390.82	1.36	
5761.00	0.400	227.900	5658.66	845.97	-750.21	-391.19	0.98	
5856.00	0.500	247.300	5753.66	846.60	-750.59	-391.81	0.19	
5951.00	0.600	259.600	5848.66	847.24	-750.84	-392.69	0.16	
6047.00	0.600	257.800	5944.65	847.88	-751.03	-393.67	0.02	
6143.00	0.300	290.900	6040.65	848.24	-751.05	-394.40	0.40	
6240.00	0.500	329.200	6137.64	848.06	-750.60	-394.85	0.33	
6336.00	0.700	6.100	6233.64	847.30	-749.65	-395.00	0.44	
6431.00	0.500	2.600	6328.63	846.39	-748.66	-394.92	0.21	
6527.00	0.800	342.500	6424.63	845.55	-747.60	-395.11	0.39	
6624.00	0.600	339.700	6521.62	844.74	-746.48	-395.48	0.21	
6719.00	0.300	293.300	6616.62	844.44	-745.92	-395.89	0.47	
6815.00	0.100	253.200	6712.62	844.52	-745.84	-396.20	0.24	
6911.00	0.400	279.600	6808.62	844.69	-745.81	-396.61	0.33	
7008.00	0.400	289.800	6905.61	844.85	-745.64	-397.26	0.07	
7103.00	0.100	60.600	7000.61	844.82	-745.49	-397.50	0.50	
7199.00	0.200	260.600	7096.61	844.86	-745.47	-397.59	0.31	
7295.00	0.300	243.300	7192.61	845.17	-745.61	-397.98	0.13	
7391.00	0.100	104.500	7288.61	845.35	-745.75	-398.13	0.40	
7575.00†	0.100	104.500	7472.61	845.27	-745.83	-397.81	0.00	

HOLE & CASING SECTIONS Ref Wellbore: Reynolds 7-23 AWB Ref Wellpath: Reynolds 7-23 AWP

String/Diameter	Start MD [feet]	End MD [feet]	Interval [feet]	Start TVD [feet]	End TVD [feet]	Start N/S [feet]	Start E/W [feet]	End N/S [feet]	End E/W [feet]
12.25in Open Hole	14.00	725.00	711.00	14.00	724.99	0.00	0.00	-3.15	1.51
8.625in Casing	14.00	725.00	711.00	14.00	724.99	0.00	0.00	-3.15	1.51
7.825in Open Hole	725.00	7575.00	6850.00	724.99	7472.61	-3.15	1.51	-745.83	-397.81



Actual Wellpath Report

Reynolds 7-23 AWP

Page 4 of 4

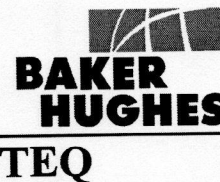

REFERENCE WELLPATH IDENTIFICATION

Operator	KERR MCGEE	Slot	Reynolds 7-23
Area	COLORADO	Well	Reynolds 7-23
Field	WELD COUNTY (KERR MCGEE)	Wellbore	Reynolds 7-23 AWB
Facility	SEC.23-T3N-R68W		

TARGETS

Name	MD [feet]	TVD [feet]	North [feet]	East [feet]	Grid East [us survey feet]	Grid North [us survey feet]	Latitude [°]	Longitude [°]	Shape
Reynolds 7-23 OFFSET (St Vrain A#1)		0.00	-43.00	24.00	3148913.08	1321651.59	40 12 54.367N	104 58 00.387W	circle
		6500.00	-752.00	-407.00	3148486.37	1320940.04	40 12 47.361N	104 58 05.942W	circle
Reynolds 7-23 TARGET									

WELLPATH COMPOSITION Ref Wellbore: Reynolds 7-23 AWB Ref Wellpath: Reynolds 7-23 AWP

Start MD [feet]	End MD [feet]	Positional Uncertainty Model	Log Name/Comment	Wellbore
14.00	7391.00	MTC (Collar, pre-2000) (Standard)	BHIMWD<771-7391>	Reynolds 7-23 AWB
7391.00	7575.00	Blind Drilling (std)	Projection to bit	Reynolds 7-23 AWB

WELLPATH COMMENTS

MD [feet]	Inclination [degrees]	Azimuth [degrees]	TVD [feet]	Comment
7391.00	0.100	104.500	7288.61	Final MWD Survey
7575.00	0.100	104.500	7472.61	Projection to Bit