

UNGRADED ELEVATION: 7390.9' STORMWATER BMP'S  
FINAL ELEVATION: 7392.9'  
PROPOSED AREA OF DISTURBANCE: 4.2+ ACRES  
DRAINS TO BUZZARD CREEK

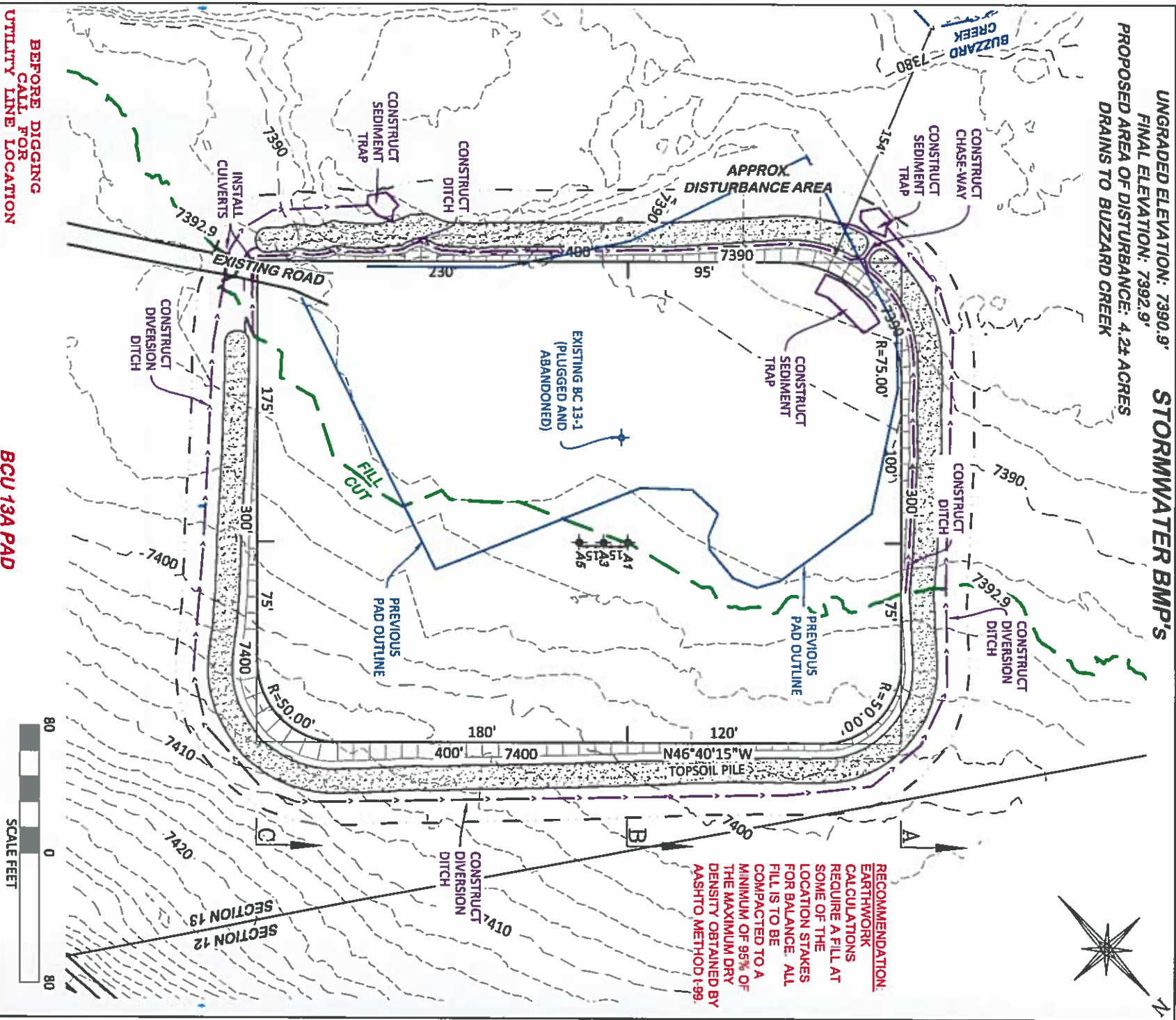

BEFORE DIGGING  
CALL FOR  
UTILITY LINE LOCATION

BCU 13A PAD

STORMWATER BMP'S



**RIFFIN & ASSOCIATES, INC.**  
1414 ELK ST., ROCK SPRINGS, WY 82901  
(307) 342-5028

DRAWN: 1/22/2018 - TCM  
REVISED: 3/12/2018 - DEH  
MISC. REVISIONS

**LARAMIE ENERGY, LLC.**  
BCU 13A  
NENE, SECTION 13, T. 9 S., R. 93 W., 6th P.M.,  
MESA COUNTY, COLORADO