

UNGRADED ELEVATION: 7390.9'
 FINAL ELEVATION: 7392.9'
 PROPOSED AREA OF DISTURBANCE: 4.2± ACRES
 DRAINS TO BUZZARD CREEK

LOCATION DRAWING

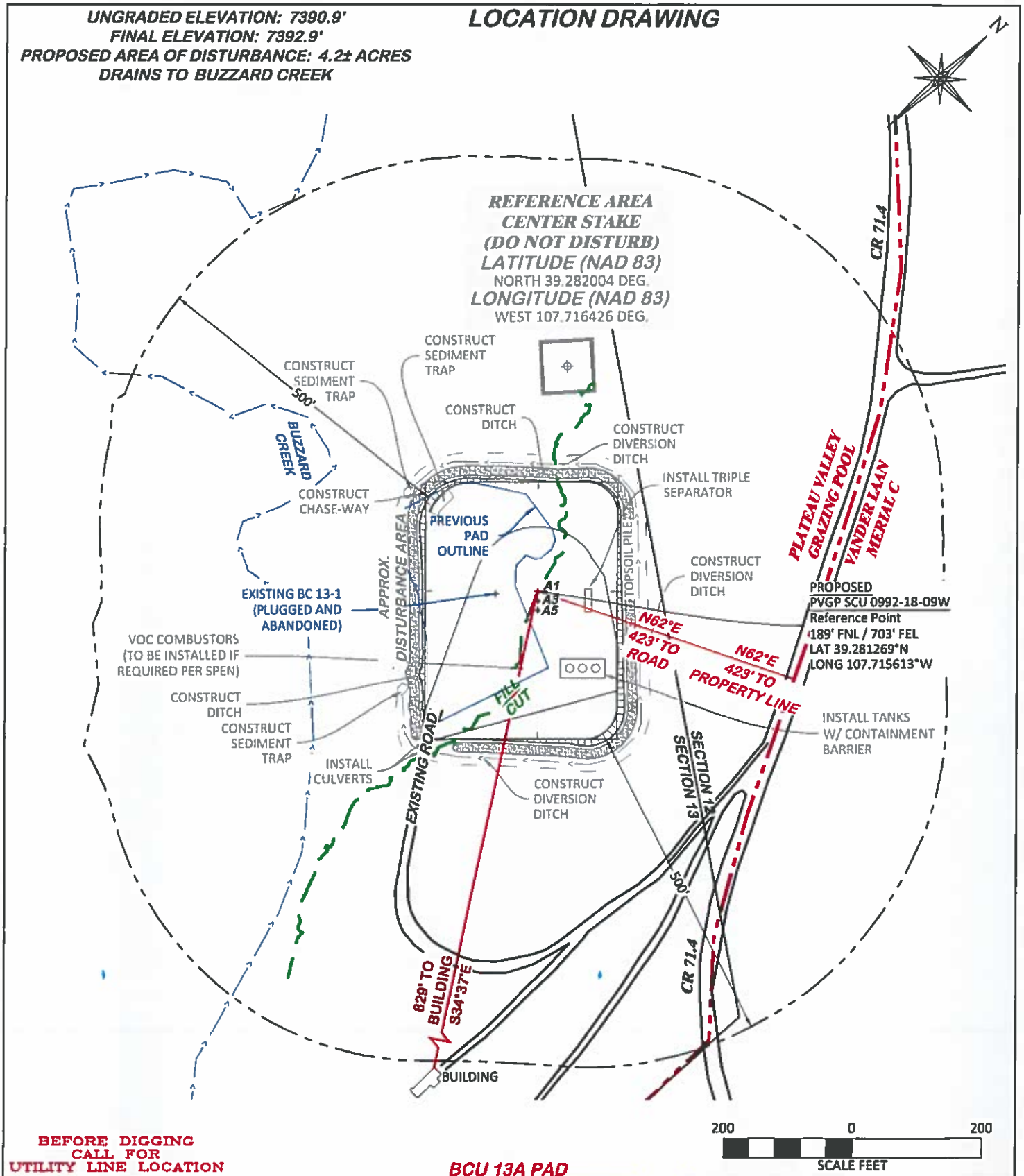

DRG RIFFIN & ASSOCIATES, INC.
 (307) 362-5028 1414 ELK ST., ROCK SPRINGS, WY 82901

DRAWN: 1/22/2018 - TCM	SCALE: 1" = 200'
REVISED: 3/12/2018 - DEH	DRG JOB No. 21205
MISC. REVISIONS	06 LOC DWG

LOCATION DRAWING

LARAMIE ENERGY, LLC.
BCU 13A
NENE, SECTION 13, T. 9 S., R. 93 W., 6th P.M.,
MESA COUNTY, COLORADO