

**Ignacio Blanco, Jaques Sec 27
Fruitland Coal
Jaques 9
Plan #1**

**Catamount Energy Partners
Proposal Report**

Section Drawing- Jaques 9

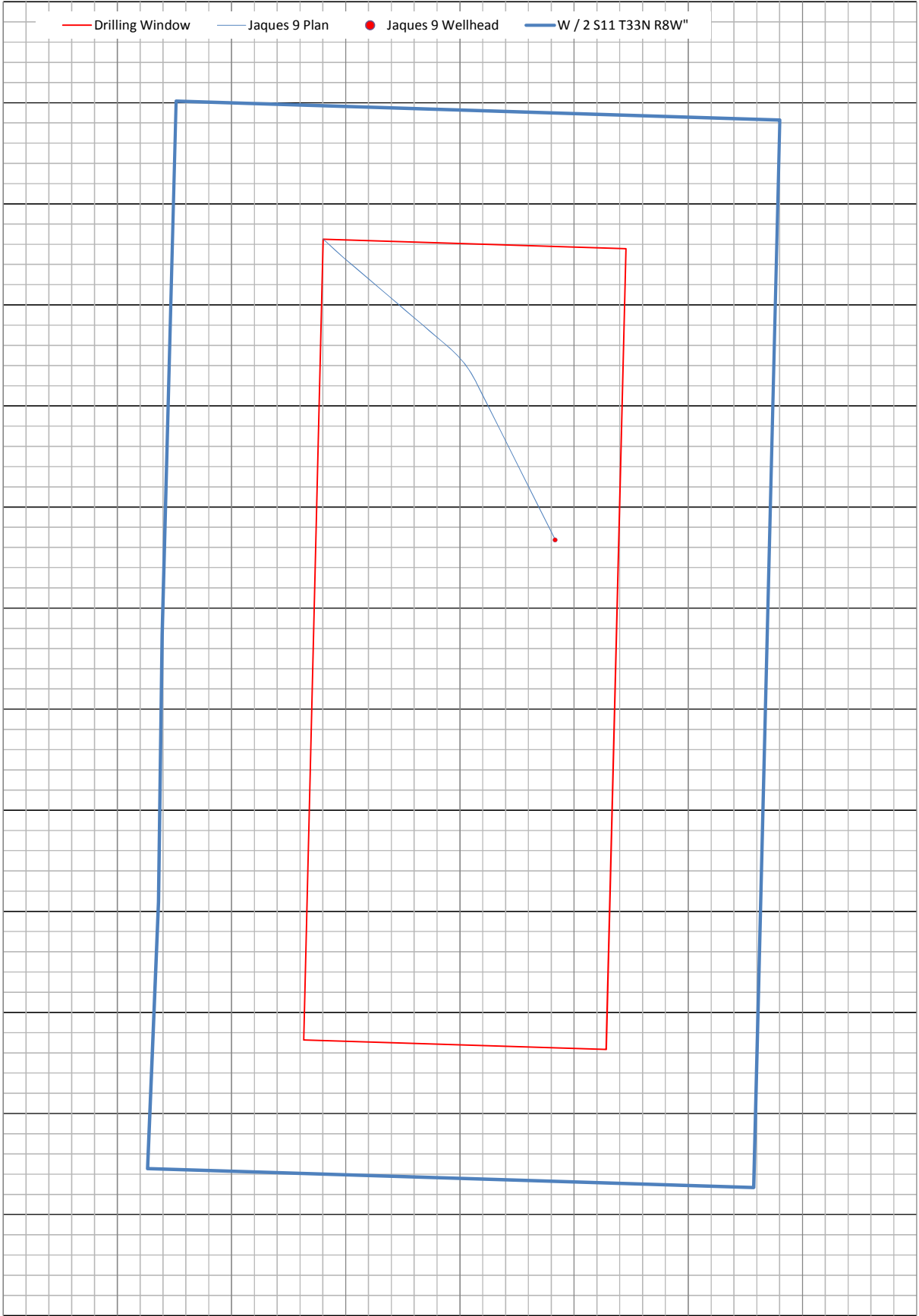

Jaques 9 VS View

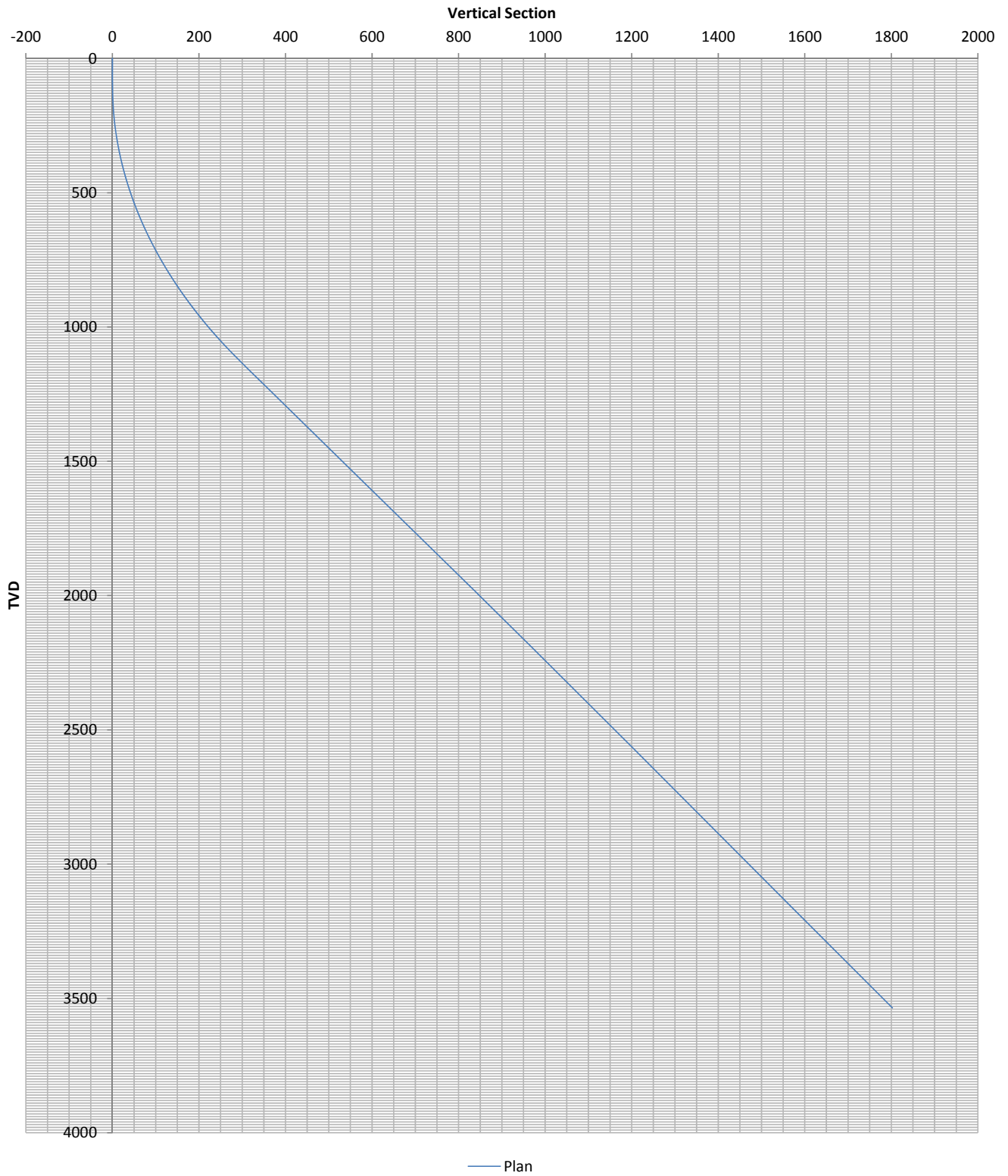

Catamount Energy Partners

Proposal Report



Database:	San Juan Basin	Local Coordinate Reference:	Map Coordinates
Company:		TVD Reference:	Mean Sea Level
Project:	Jaques Sec 27	MD Reference:	Jaques 9
Site:	Fruitland Coal	North reference:	Grid North
Well:	Jaques 9	Survey Calculation Method:	Minimum Curvature
Wellbore:			
Proposal:	Plan #1		

Project	Jaques Sec 27		
Map System:	NAD83 Colorado State Planes	System Datum:	Mean Sea Level
Geo Datum:	NAD 1983		
Map Zone:	Southern Zone		

Site	Fruitland Coal		
Site Position:		Northing:	0
From:	Map	Easting:	0
Position Uncertainty:	0ft	Slot Radius:	0in
		Latitude:	33.48902771° N
		Longitude:	115.33027986° W
		Grid Convergence:	-6.0°

Well	Jaques 9		
Well Position:	+N/-S	1,156,837ft	Northing: +1,156,837
	+E/-W	2,355,918ft	Easting: +2,355,918
Position Uncertainty:		1ft	Wellhead Elevation: 7,047ft
			Latitude: 37.07648569° N
			Longitude: 107.70786272° W
			Ground Level: 7,031ft

Magnetics	Model Name	Sample Date	Declination (°)	Dip Angle (°)	Field Strength (nT)
	User Defined	2/5/2018	0.0	0.0	0.0

Proposal	Plan #1		
Audit Notes:			
Version:		Phase:	Tie On Depth: 0ft

Vertical Section:	Depth from TVD (ft)	+N/-S (ft)	+E/-W (ft)	Direction (°)
	0	0	0	325.7

Survey Program		2/5/2018		
From (ft)	To (ft)	Survey (Wellbore)	Tool Name	Description
0	4,039	Plan #1	MWD	MWD

Plan Sections										
Measured Depth (ft)	Inclination (°)	Azimuth (°)	Vertical Depth (ft)	+N/-S (ft)	+E/-W (ft)	Dogleg Rate (°/100ft)	Build Rate (°/100ft)	Turn Rate (°/100ft)	TFO (°)	Target
0	0.0	0.0	0	0	0					
100	0.0	0.0	100	0	0	0.0	0.0	0.0	0.0	
1,193	32.8	336.0	1,135	278	-124	3.0	3.0	0.0	-24.0	
2,213	32.8	336.0	1,992	783	-348	0.0	0.0	0.0	0.0	
2,609	32.3	313.9	2,326	955	-468	3.0	-0.1	-5.6	-101.5	
3,745	32.3	313.9	3,286	1,377	-906	0.0	0.0	0.0	0.0	
4,039	32.2	316.5	3,535	1,488	-1,017	0.5	-0.1	0.9	97.2	TD

Planned Survey											
Measured Depth (ft)	Incl. (°)	Az. (°)	Vertical Depth (ft)	Sub Sea Depth (ft)	+N/-S (ft)	+E/-W (ft)	Vertical Section (ft)	Closure Distance (ft)	Closure Azimuth (°)	Dogleg Rate (°/100ft)	Comments/ Formations
0	0.0	0.0	0	-7,047	0	0	0	0	0.0	0.0	MWD
100	0.0	0.0	100	-6,947	0	0	0	0	0.0	0.0	
100	0.0	0.0	100	-6,947	0	0	0	0	0.0	0.0	
200	3.0	336.0	200	-6,847	2	-1	3	3	336.0	3.0	
300	6.0	336.0	300	-6,747	10	-4	10	10	336.0	3.0	

Catamount Energy Partners

Proposal Report



Database:	San Juan Basin	Local Coordinate Reference:	Map Coordinates
Company:		TVD Reference:	Mean Sea Level
Project:	Jaques Sec 27	MD Reference:	Jaques 9
Site:	Fruitland Coal	North reference:	Grid North
Well:	Jaques 9	Survey Calculation Method:	Minimum Curvature
Wellbore:			
Proposal:	Plan #1		

Planned Survey											
Measured Depth (ft)	Incl. (°)	Az. (°)	Vertical Depth (ft)	Sub Sea Depth (ft)	+N/-S (ft)	+E/-W (ft)	Vertical Section (ft)	Closure Distance (ft)	Closure Azimuth (°)	Dogleg Rate (°/100ft)	Comments/ Formations
350	7.5	336.0	349	-6,698	15	-7	16	16	336.0	3.0	9 5/8in Casing
400	9.0	336.0	399	-6,648	21	-10	23	24	336.0	3.0	
500	12.0	336.0	497	-6,550	38	-17	41	42	336.0	3.0	
600	15.0	336.0	594	-6,453	59	-26	64	65	336.0	3.0	
696	17.9	336.0	686	-6,361	84	-37	91	92	336.0	3.0	
700	18.0	336.0	690	-6,357	85	-38	92	93	336.0	3.0	KOP
800	21.0	336.0	784	-6,263	116	-52	125	127	336.0	3.0	
900	24.0	336.0	877	-6,170	151	-67	162	165	336.0	3.0	
1,000	27.0	336.0	967	-6,080	190	-85	205	208	336.0	3.0	
1,100	30.0	336.0	1,055	-5,992	234	-104	252	256	336.0	3.0	
1,193	32.8	336.0	1,135	-5,912	278	-124	300	305	336.0	3.0	
1,200	32.8	336.0	1,140	-5,907	282	-125	303	308	336.0	0.0	
1,300	32.8	336.0	1,224	-5,823	331	-147	356	362	336.0	0.0	
1,400	32.8	336.0	1,308	-5,739	381	-169	410	416	336.0	0.0	
1,500	32.8	336.0	1,392	-5,655	430	-191	463	471	336.0	0.0	
1,600	32.8	336.0	1,476	-5,571	480	-213	516	525	336.0	0.0	
1,700	32.8	336.0	1,560	-5,487	529	-235	570	579	336.0	0.0	
1,800	32.8	336.0	1,645	-5,402	579	-257	623	633	336.0	0.0	
1,900	32.8	336.0	1,729	-5,318	628	-279	676	687	336.0	0.0	
2,000	32.8	336.0	1,813	-5,234	678	-301	729	741	336.0	0.0	
2,100	32.8	336.0	1,897	-5,150	727	-323	783	796	336.0	0.0	Animas
2,109	32.8	336.0	1,904	-5,143	731	-325	787	800	336.0	0.0	
2,200	32.8	336.0	1,981	-5,066	777	-345	836	850	336.0	0.0	
2,213	32.8	336.0	1,992	-5,055	783	-348	843	857	336.0	0.0	
2,260	32.5	333.5	2,031	-5,016	806	-359	868	882	336.0	3.0	
2,300	32.4	331.3	2,065	-4,982	825	-369	889	904	335.9	3.0	Kirtland Shale
2,400	32.1	325.7	2,150	-4,897	870	-397	942	957	335.5	3.0	
2,411	32.1	325.1	2,159	-4,888	875	-400	948	962	335.4	3.0	
2,500	32.1	320.0	2,234	-4,813	913	-429	995	1,008	334.8	3.0	
2,600	32.3	314.4	2,319	-4,728	952	-465	1,048	1,059	334.0	3.0	
2,609	32.3	313.9	2,326	-4,721	955	-468	1,053	1,064	333.9	3.0	Farmington SS
2,668	32.3	313.9	2,376	-4,671	977	-491	1,083	1,093	333.3	0.0	
2,700	32.3	313.9	2,403	-4,644	989	-503	1,101	1,110	333.0	0.0	
2,800	32.3	313.9	2,488	-4,559	1,026	-542	1,153	1,160	332.2	0.0	
2,900	32.3	313.9	2,572	-4,475	1,063	-580	1,205	1,211	331.4	0.0	
3,000	32.3	313.9	2,657	-4,390	1,100	-619	1,258	1,262	330.6	0.0	Lower Kirtland Shale
3,100	32.3	313.9	2,741	-4,306	1,137	-657	1,310	1,314	330.0	0.0	
3,200	32.3	313.9	2,826	-4,221	1,175	-696	1,362	1,365	329.3	0.0	
3,229	32.3	313.9	2,850	-4,197	1,185	-707	1,377	1,380	329.2	0.0	
3,300	32.3	313.9	2,910	-4,137	1,212	-735	1,415	1,417	328.8	0.0	
3,400	32.3	313.9	2,995	-4,052	1,249	-773	1,467	1,469	328.2	0.0	Upper Fruitland Coal
3,500	32.3	313.9	3,079	-3,968	1,286	-812	1,520	1,521	327.7	0.0	
3,600	32.3	313.9	3,164	-3,883	1,323	-850	1,572	1,573	327.3	0.0	
3,632	32.3	313.9	3,191	-3,856	1,335	-863	1,589	1,589	327.1	0.0	
3,700	32.3	313.9	3,248	-3,799	1,360	-889	1,624	1,625	326.8	0.0	
3,745	32.3	313.9	3,286	-3,761	1,377	-906	1,648	1,648	326.7	0.0	Main Fruitland Coal
3,787	32.3	314.3	3,322	-3,725	1,392	-922	1,670	1,670	326.5	0.5	
3,800	32.3	314.4	3,333	-3,714	1,397	-927	1,677	1,677	326.4	0.5	Pictured Cliffs
3,862	32.3	314.9	3,385	-3,662	1,420	-951	1,709	1,709	326.2	0.5	
3,900	32.3	315.3	3,417	-3,630	1,435	-965	1,729	1,729	326.1	0.5	
4,000	32.2	316.2	3,502	-3,545	1,473	-1,002	1,782	1,782	325.8	0.5	

Catamount Energy Partners

Proposal Report



Database:	San Juan Basin	Local Coordinate Reference:	Map Coordinates
Company:		TVD Reference:	Mean Sea Level
Project:	Jaques Sec 27	MD Reference:	Jaques 9
Site:	Fruitland Coal	North reference:	Grid North
Well:	Jaques 9	Survey Calculation Method:	Minimum Curvature
Wellbore:			
Proposal:	Plan #1		

Planned Survey											
Measured Depth (ft)	Incl. (°)	Az. (°)	Vertical Depth (ft)	Sub Sea Depth (ft)	+N/-S (ft)	+E/-W (ft)	Vertical Section (ft)	Closure Distance (ft)	Closure Azimuth (°)	Dogleg Rate (°/100ft)	Comments/ Formations
4,029	32.2	316.4	3,526	-3,521	1,484	-1,013	1,797	1,797	325.7	0.5	7in Casing
4,039	32.2	316.5	3,535	-3,512	1,488	-1,017	1,802	1,802	325.7	0.5	TD

Targets										
Target Name	Dip Angle (°)	Dip Dir. (°)	TVD (ft)	+N/-S (ft)	+E/-W (ft)	Northing (ft)	Easting (ft)	Latitude	Longitude	
-hit/miss target										
-Shape										
KOP			716	0	0	+1,156,837	+2,355,918	37.07648569° N	107.70786272° W	
- proposal misses the target center by 97ft at 696ft MD (686TVD, +84, -37)										
- Point										
TD			3,535	1,488	-1,017	+1,158,325	+2,354,901	37.08050565° N	107.71146707° W	
- proposal hits the target center										
- Point										
Target 2			2,047	783	-348	+1,157,620	+2,355,570	37.07861360° N	107.70911892° W	
- proposal misses the target center by 30ft at 2,260ft MD (2,031TVD, +806, -359)										
- Point										

Formations						
Measured Depth (ft)	Vertical Depth (ft)	Subsea Depth (ft)	Name	Dip Angle (°)	Dip Direction (°)	
2,109	-5,143	-5,143	Animas	0.0	0.0	
2,411	-4,888	-4,888	Kirtland Shale	0.0	0.0	
2,668	-4,671	-4,671	Farmington SS	0.0	0.0	
3,229	-4,197	-4,197	Lower Kirtland Shale	0.0	0.0	
3,632	-3,856	-3,856	Upper Fruitland Coal	0.0	0.0	
3,787	-3,725	-3,725	Main Fruitland Coal	0.0	0.0	
3,862	-3,662	-3,662	Pictured Cliffs	0.0	0.0	

Casing Points				
Measured Depth (ft)	Vertical Depth (ft)	Name	Casing Diameter (in)	Hole Diameter (in)
350	349	9 5/8in Casing	9 5/8	12 1/4
4,029	3,526	7in Casing	7	9 1/2

Checked By:	Approved By:	Date:
-------------	--------------	-------

Disclaimer Notice
Catamount Energy Partners makes no warranty of any kind with respect to the subject matter included herein or the completeness or accuracy of this document.
Catamount Energy Partners are not responsible for any actions (or lack thereof) taken as a result of relying on or in any way using information contained in this document and in no event shall be liable for any damages resulting from reliance on or use of this information.