

T. 9 S.

H. THOMAS
0993-26-04W

UNGRADED ELEVATION:
7634.8'

BASIS OF ELEVATION:
DRG CONTROL POINT CP 16-9-93
NAVD88 ELEVATION: 7245.29'

SHL
LATITUDE (NAD 83)
NORTH 39.249228 DEG.
LONGITUDE (NAD 83)
WEST 107.742503 DEG.
NORTHING (NAD 83)
1523503.28
EASTING (NAD 83)
2365010.38

BASIS OF BEARING/DATUM

SPCS COLORADO CENTRAL NAD 27 BASED ON
STATIC GPS OBSERVATIONS ON DRG CONTROL
POINT CP 16-9-93 HAVING A POSITION OF:
NAD83(2011)
LAT 39° 16' 16.64" NORTH
LONG 107° 46' 11.24" WEST
NAVD88 ELEVATION: 7245.29'

THE WEST LINE OF THE NW¼ OF SECTION 26,
MONUMENTED BY AC'S AND BEARING
N 00°43'16" E.

NOTES

1. GPS OPERATOR T. SHERRILL OBSERVED A PDOP OF 1.5.
2. ALL GPS OBSERVATIONS ARE IN COMPLIANCE WITH COGCC RULE No.215.
3. EXISTING IMPROVEMENTS WITHIN 500' OF LOCATION. SEE LOC. DRAWING.
4. SURROUNDING SURFACE USE IS NATIVE BRUSH, NON CROP RANGELAND.

SURVEYOR'S STATEMENT

I, DAVID E. HENDERHAN, AN EMPLOYEE AND AGENT ON BEHALF OF D.R. GRIFFIN & ASSOCIATES, INC. STATE THE PLAT HEREON IS A CORRECT REPRESENTATION OF A SURVEY MADE UNDER MY SUPERVISION ON THE 23rd DAY OF AUGUST, 2017 OF THE SHOWN H. THOMAS 0993-26-04W AND THAT THE LOCATION HAS BEEN STAKED ON THE GROUND.

Notice: In accordance with Colorado State Law, any legal action based upon any defect in this survey plat must commence within three (3) years after first discovery of such defect. In no event, may any action based upon any defect in this survey plat be commenced more than ten (10) years from the date of certification shown hereon.

H THOMAS 0993-26-06 PAD

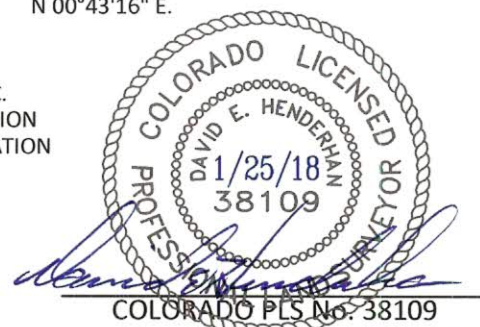

DRG **RIFFIN & ASSOCIATES, INC.**
(307) 362-5028 1414 ELK ST., ROCK SPRINGS, WY 82901

PLAT OF DRILLING LOCATION IN
SWNW, SECTION 26, FOR
LARAMIE ENERGY, LLC

1961' F/NL, & 1145' F/WL, SECTION 26,
T. 9 S., R. 93 W., 6TH P.M.,
MESA COUNTY, COLORADO

DRAWN: 1/22/2018 - TCM	SCALE: 1" = 1000'
REVISED: 1/25/2018 - DEH	DRG JOB No. 21278
REVISED SURVEY DATE	B1-0993-26-04W