

CAERUS OIL & GAS LLC

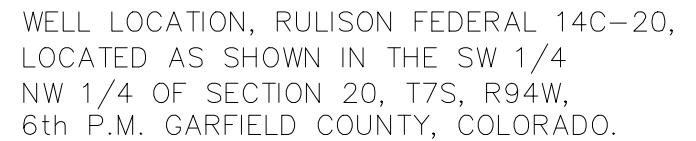

**WELL LOCATION:**  
**RULISON FEDERAL 14C-20**

THIS IS TO CERTIFY THAT THE ABOVE PLAT WAS  
PREPARED FROM FIELD NOTES AND MEASUREMENTS  
MADE BY ME OR UNDER MY PERSONAL SUPERVISION.  
THE LOCATION HAS BEEN STAKED ON THE GROUND, AS  
SHOWN ON THE PLAT, AND THAT THE SAME ARE  
TRUE AND CORRECT TO THE BEST OF MY  
KNOWLEDGE AND BELIEF. 07-10-17

REGISTERED LAND SURVEYOR  
REGISTRATION NO. 30125  
STATE OF COLORADO

<b>NAD 83 (SURFACE LOCATION)</b>		<b>NAD 83 (BOTTOM HOLE)</b>	
LATITUDE = 39°25'31.59" (39.425443)		LATITUDE = 39°25'11.66" (39.419905)	
LONGITUDE = 107°54'55.61" (107.915446)		LONGITUDE = 107°55'01.48" (107.917076)	
UTM ZONE N12 FEET		UTM ZONE N12 FEET	
N: = 14332423.804 E: = 2511527.377		N: = 14330391.115 E: = 2511135.872	
<b>NAD 27 (SURFACE LOCATION)</b>		<b>NAD 27 (BOTTOM HOLE)</b>	
LATITUDE = 39°25'31.67" (39.425464)		LATITUDE = 39°25'11.73" (39.419926)	
LONGITUDE = 107°54'53.36" (107.914822)		LONGITUDE = 107°54'59.23" (107.916452)	
UTM ZONE N12 FEET		UTM ZONE N12 FEET	
N: = 14331752.649 E: = 2511726.095		N: = 14329720.000 E: = 2511334.600	

DATE SURVEYED: 07-15-15	SURVEYED BY: K.G.S.	<b>SHEET</b>  <b>1.10</b>
DATE DRAWN: 07-10-17	DRAWN BY: F.T.M.	
REVISED:	SCALE: 1" = 1000'	