



December 27, 2017

VIA ELECTRONIC TRANSMITTAL

Department of Natural Resources
Oil and Gas Conservation Commission
The Chancery Building
Attn: Matt Lepore
1120 Lincoln St., Suite 801
Denver, CO 80203

Re: **30-Day Certification Letter – Rule 318A.e**

JACKSON 33-6H WELL TO BE LOCATED 283' FNL AND 1081' FWL, SEC 33, T2N, R64W

JACKSON 33-7H WELL TO BE LOCATED 290' FNL AND 1100' FWL, SEC 33, T2N, R64W

Dear Director Lepore,

Verdad Resources LLC (Verdad) herby certifies to the Director that where required by rule 318A, a thirty (30-day) notice has been given by certified mail to all owners in the proposed 240-acre wellbore spacing unit comprised of:

SEC 33, T2N, R64W: E2W2

SEC 28, T2N, R64W: SE4SW4

SEC 4, T1N, R64W: NE4NW4

We have not received any objections to such well location or proposed spacing unit, therefore Verdad hereby requests the Director to approve the proposed wells.

If you should have any questions or concerns regarding these proposed permits, please contact the undersigned at 720-651-8409.

Sincerely,

Kenny Trueax

JACKSON 02N-64W-33 PAD PROPOSED 318A.a.(4)D. SPACING UNIT

SEC 33, T2N, R64W: E2W2
SEC 28, T2N, R64W: SE4SW4
SEC 4, T1N, R64W: NE4NW4

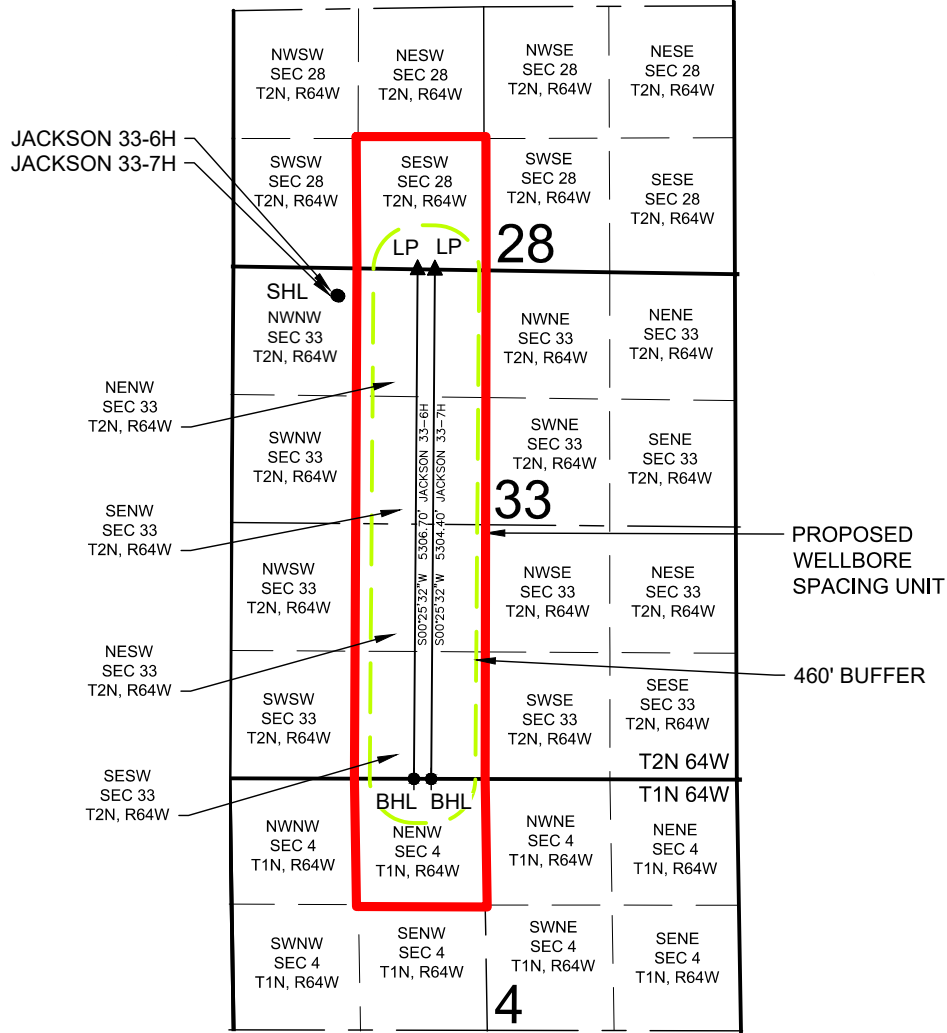

JACKSON 33-6H WELL TO BE LOCATED 283' FNL AND 1081' FWL, SEC 33, T2N, R64W
JACKSON 33-7H WELL TO BE LOCATED 290' FNL AND 1100' FWL, SEC 33, T2N, R64W

LEGEND

- = PROPOSED WELL
- = BOTTOM HOLE
- ▲ = LANDING POINT

SHL = SURFACE HOLE LOCATION
BHL = BOTTOM HOLE LOCATION
LP = LANDING POINT

DISCLAIMER:
THIS PLOT DOES NOT REPRESENT A MONUMENTED LAND SURVEY AND SHOULD NOT BE
RELIED UPON TO DETERMINE BOUNDARY LINES, PROPERTY OWNERSHIP OR OTHER
PROPERTY INTERESTS. PARCEL LINES, IF DEPICTED HAVE NOT BEEN FIELD VERIFIED AND
MAY BE BASED UPON PUBLICLY AVAILABLE DATA THAT ALSO HAS NOT BEEN
INDEPENDENTLY VERIFIED.

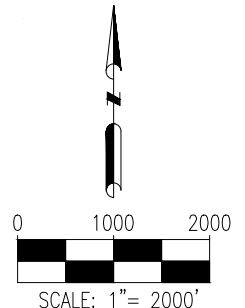

7535 Hilltop Circle
Denver, CO 80221
(303) 928-7128
www.ascentgeomatics.com

FIELD DATE:
05-15-17

DRAWING DATE:
12-14-17

BY:
DP

CHECKED:
IJM

SITE NAME:
JACKSON 02N-64W-33 PAD

SURFACE LOCATION:

NW 1/4 NW 1/4 SEC. 33, T2N, R64W, 6TH P.M.
WELD COUNTY, COLORADO

PREPARED FOR:

