

JACKSON 33-6H WELL LOCATION CERTIFICATE

LP: 0' FNL
1920' FWL

NW COR. SEC. 33
3/4" ALUM. CAP
ILLEGIBLE

S89°07'45"E 2613.42'

S89°06'59"E 2611.29'

NE COR. SEC. 33
2 1/2" ALUM. CAP
PLS 24305, 1998

N 1/4 COR. SEC. 33
2" ALUM. CAP
LS 25937, 1994

SURFACE LOCATION:
GROUND ELEVATION=5017'
NAD83
LATITUDE:40.101456° N
LONGITUDE:104.561579° W

LANDING POINT LOCATION:
NAD83
LATITUDE:40.102197° N
LONGITUDE:104.558575° W

BOTTOM HOLE LOCATION:
NAD83
LATITUDE:40.087634° N
LONGITUDE:104.558714° W

33

NOTES:
BH LOCATION PROVIDED BY CLIENT.
LAND SURFACE USE-DRY LAND CROP
SEE LOCATION DRAWING FOR ADDITIONAL
IMPROVEMENTS WITHIN 500'

PDOP=1.5
GPS OPERATOR: ROSS TODD

S 1/4 COR. SEC. 33
2 1/2" ALUM. CAP
PLS 24305, 1998

N89°51'33"W 2641.34'
BASIS OF BEARINGS
(SEE NOTE 2)

SE COR. SEC. 33
3/4" ALUM. CAP
ILLEGIBLE

W 1/4 COR. SEC. 33
3/4" ALUM. CAP
LS 6935, 1987

SW COR. SEC. 33
2 1/2" ALUM. CAP
PLS 24305, 1998

BHL: 0' FSL
1920' FWL

N89°51'42"W 2641.40'

LEGEND

- = EXISTING MONUMENT
- = CALCULATED POSITION
- = PROPOSED WELL
- ◆ = EXISTING WELL
- ▲ = BOTTOM HOLE
- ▲ = LANDING POINT
- LP = LANDING POINT
- BHL = BOTTOM HOLE LOCATION

NOTES:

- THIS FIELD SURVEY CONFORMS TO THE MINIMUM STANDARDS SET BY THE C.O.G.C.C., RULE NO. 215
- BEARINGS ARE BASED ON THE ASSUMPTION THAT THE SOUTH LINE OF THE SOUTHEAST QUARTER OF SECTION 33, BEARS N89°51'33"W BETWEEN THE MONUMENTS SHOWN HEREON.
- ALL DISTANCES AND BEARINGS SHOWN HEREON ARE GROUND VALUES AS GPS MEASURED IN THE FIELD, WITH TIES TO WELLS MEASURED PERPENDICULAR TO SECTION LINES. THIS LOW DISTORTION PROJECTION (LDP) IS BASED ON THE NORTH AMERICAN DATUM OF 1983, U.S. SURVEY FOOT WITH A LATITUDE ORIGIN OF 40.040652°N AND A LONGITUDE OF 104.546537°W AND A SCALE FACTOR ON THE CENTRAL MERIDIAN OF 1.000237(EXACT). THE LDP BASIS OF BEARINGS IS GEODETIC NORTH.
- ELEVATIONS SHOWN ARE NAVD 88, AS DERIVED BY GPS OBSERVATIONS.
- FIELD VERIFICATION OF MONUMENTS COMPLETED WITHIN 1 YEAR OF SIGNATURE DATE.

NOTICE: ACCORDING TO COLORADO LAW YOU MUST COMMENCE ANY LEGAL ACTION BASED UPON ANY DEFECT IN THIS SURVEY WITHIN THREE YEARS AFTER YOU FIRST DISCOVER SUCH DEFECT. IN NO EVENT MAY ANY ACTION BASED UPON ANY DEFECT IN THIS SURVEY BE COMMENCED MORE THAN TEN YEARS FROM THIS SAID DATE OF THIS CERTIFICATION SHOWN HEREON.

WELL JACKSON 33-6H TO BE LOCATED 283' FNL & 1081' FWL

I, BRIAN C. RITZ, A LICENSED PROFESSIONAL LAND SURVEYOR IN THE STATE OF COLORADO DO HEREBY CERTIFY TO VERDAD RESOURCES LLC., THAT THE SURVEY AND WELL LOCATION CERTIFICATE SHOWN HEREON WERE DONE BY ME OR UNDER MY DIRECT SUPERVISION AND THAT THE DRAWING SHOWN HEREON ACCURATELY DEPICTS THE PROPOSED LOCATION OF THE WELL. THIS CERTIFICATE DOES NOT REPRESENT A LAND SURVEY PLAT OR IMPROVEMENT SURVEY PLAT AS DEFINED BY C.R.S. 38-51-102 AND CANNOT BE RELIED UPON TO DETERMINE OWNERSHIP.

BRIAN C. RITZ, PLS 38452
COLORADO LICENSED PROFESSIONAL LAND SURVEYOR
FOR AND ON BEHALF OF P.F.S., LLC
d.b.a. ASCENT GEOMATICS SOLUTIONS

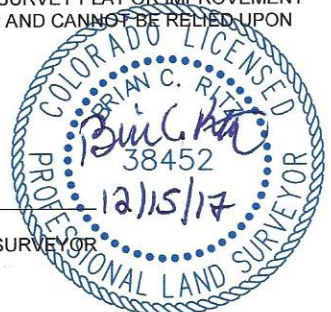

SHEET 1 OF 1

PREPARED BY:

FIELD DATE:
05-15-17

WELL NAME:
JACKSON 33-6H

PREPARED FOR:

DRAWING DATE:
12-14-17

SURFACE LOCATION:
NW 1/4 NW 1/4 SEC. 33, T2N, R64W, 6TH P.M.
WELD COUNTY, COLORADO

BY:
JAG

CHECKED BY:
IJM

