

COX 22-B PAD HYDROLOGY MAP

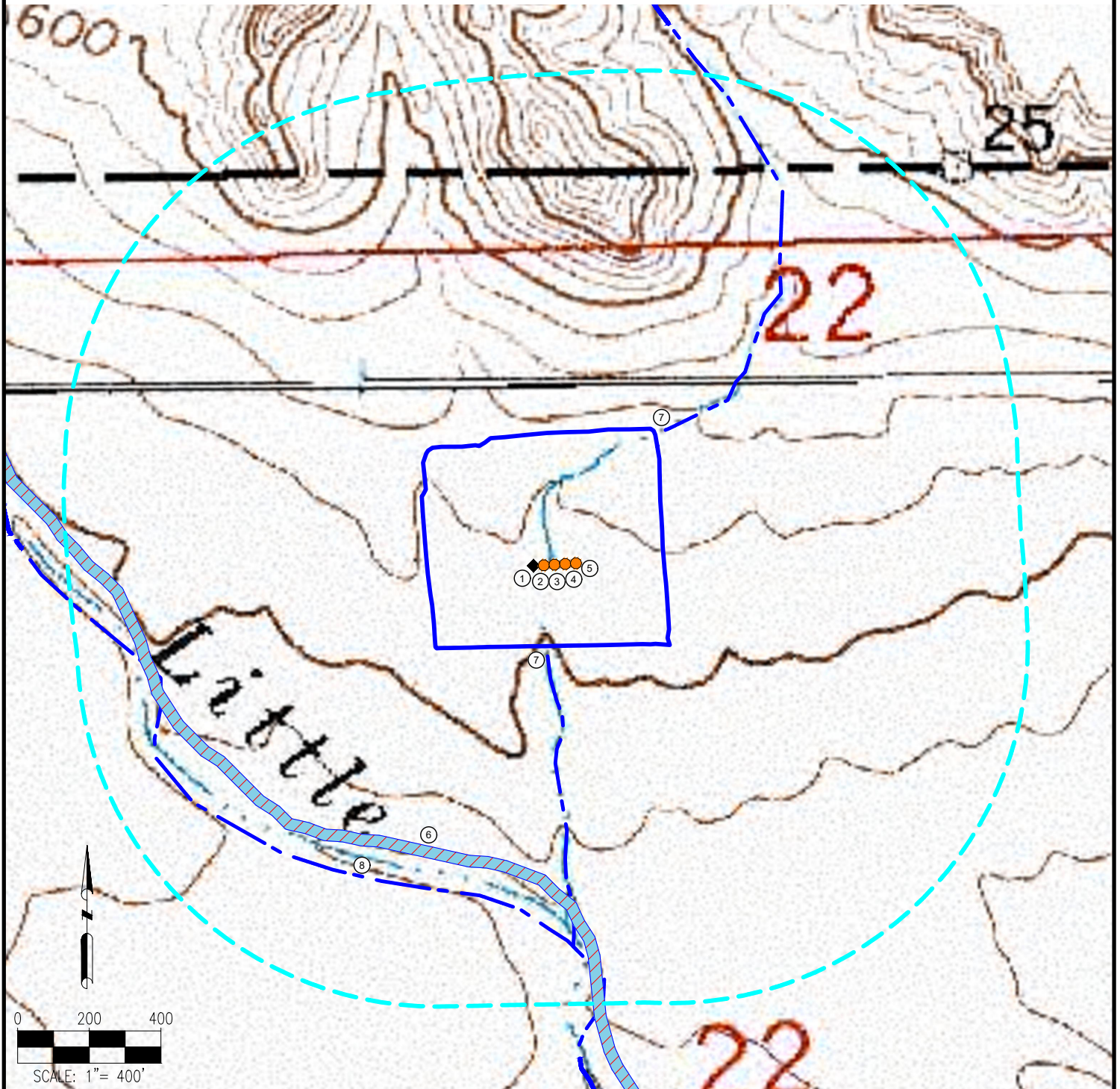

MEASUREMENTS ARE MADE FROM THE NEAREST EDGE OF THE DISTURBANCE AREA.

- | | |
|----------|---|
| 1. COX 1 | 6. WETLAND IS $\pm 544'$ SW |
| 2. COX 2 | 7. INTERMITTENT STREAMS ARE $\pm 32'$ NW, $\pm 28'$ S |
| 3. COX 3 | 8. LITTLE SIMPSON CREEK (STREAM) IS $\pm 611'$ SW |
| 4. COX 4 | |
| 5. COX 5 | |

LEGEND:

- | | | |
|--------------------|------------|--------------------|
| ◆ = EXISTING WELL | = WETLANDS | = DISTURBANCE AREA |
| ● = PERMITTED WELL | = STREAM | = 1000' RADIUS |

DISCLAIMER:
THIS PLOT DOES NOT REPRESENT A MONUMENTED LAND SURVEY AND SHOULD NOT BE RELIED UPON TO DETERMINE BOUNDARY LINES, PROPERTY OWNERSHIP OR OTHER PROPERTY INTERESTS. PARCEL LINES, IF DEPICTED HAVE NOT BEEN FIELD VERIFIED AND MAY BE BASED UPON PUBLICLY AVAILABLE DATA THAT ALSO HAS NOT BEEN INDEPENDENTLY VERIFIED.

DATA SOURCE:
TOPO MAP: USGS
NHD: USGS
PUBLICLY AVAILABLE DATA SOURCES HAVE NOT BEEN INDEPENDENTLY VERIFIED BY ASCENT.



7535 Hilltop Circle
Denver, CO 80221
(303) 928-7128
www.ascentgeomatics.com

FIELD DATE:
04-07-16

DRAWING DATE:
11-14-17

BY:
AS

CHECKED:
IJM

SITE NAME:
COX 22-B PAD

SURFACE LOCATION:

NE 1/4 NW 1/4 SEC. 22, T12N, R64W, 6TH P.M.
WELD COUNTY, COLORADO

PREPARED FOR:

