



FORM F-106

RECEIVED

JAN 14 1975

GOLD. CR. & GAS CONS. COMP. 53W

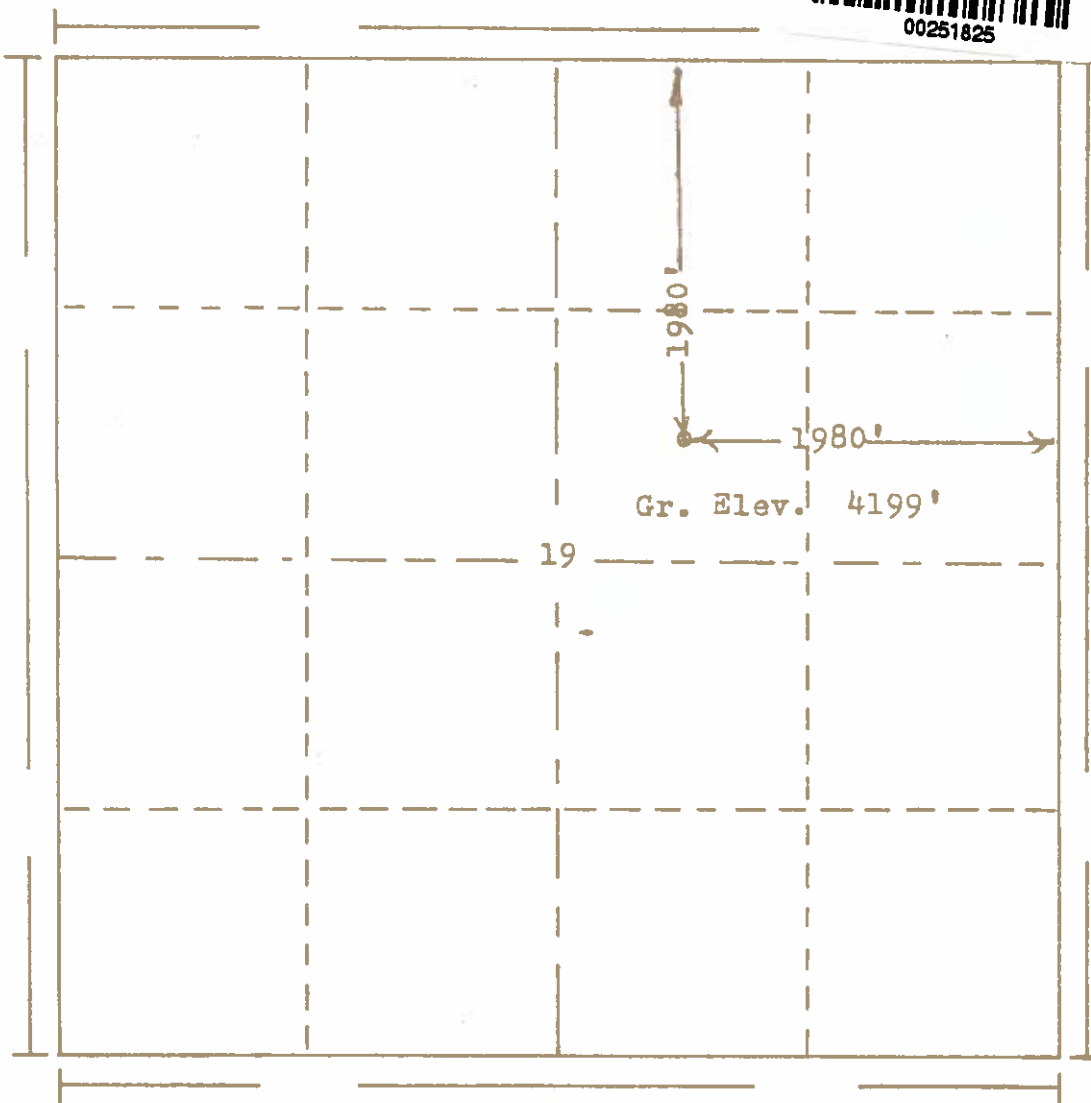

00251825

T.
8
N

Scale... 1" = 1000'

Powers Elevation Company, Inc. of Denver, Colorado
has in accordance with a request from Jo
for J.W. Gibson Well Service, Inc.

determined the location of No.1 State
to be CSW NE Section 19 Township 8N
Range 53W of the 6th Principal Meridian
Logan County, Colorado

I hereby certify that this plat is an
accurate representation of a correct
survey showing the location of

Date: 1-2-75

David D. Hall
Licensed Land Surveyor No. 2855
State of Colorado