

R. 97 W.

T. 5 S.

T. 6 S.

GRID NORTH

SCALE' 1" = 1000'

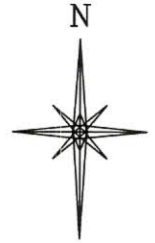

SHL

LATITUDE (NAD 83)
NORTH 39.558302 DEG.
LONGITUDE (NAD 83)
WEST 108.205146 DEG.
NORTHING (NAD 83)
1639594.71
EASTING (NAD 83)
2237394.86

BHL/TOG

LATITUDE (NAD 83)
NORTH 39.555939 DEG.
LONGITUDE (NAD 83)
WEST 108.210798 DEG.
NORTHING (NAD 83)
1638782
EASTING (NAD 83)
2235776

CC 0697-03-13W
UNGRADED ELEVATION:
8438.0'

BASIS OF ELEVATION: USGS SPOT ELEVATION
LOCATED AT THE SW CORNER OF SECTION 3,
T6S, R97W
ELEVATION: 8387'

NOTES

- GPS OPERATOR T. SHERRILL OBSERVED A PDOP OF 1.2.
- ALL GPS OBSERVATIONS ARE IN COMPLIANCE WITH COGCC RULE No.215.
- NO EXISTING IMPROVEMENTS WITHIN 500' OF LOCATION. SEE LOCATION DRAWING.
- SURROUNDING SURFACE USE IS NATIVE BRUSH, NON CROP RANGELAND.

BASIS OF BEARING/DATUM

SPCS COLORADO CENTRAL NAD 27 BASED ON GPS OBSERVATIONS
AND OPUS SOLUTION ON DRG CONTROL POINT "WILLIAMS"
HAVING A POSITION OF:
NAD83(2011)
LAT 39° 31' 35.18" NORTH
LONG 108° 12' 16.79" WEST
NAVD88 ELEVATION: 8618.14'

THE SOUTH LINE OF THE SW¼ OF
SECTION 3, MONUMENTED BY BLM BC'S AND BEARING
N 88°15'57" W.

SURVEYOR'S STATEMENT

I, DAVID E. HENDERHAN, AN EMPLOYEE AND AGENT ON BEHALF OF D.R. GRIFFIN & ASSOCIATES, INC.
STATE THE PLAT HEREON IS A CORRECT REPRESENTATION OF A SURVEY MADE UNDER MY SUPERVISION
ON THE 23rd DAY OF JUNE, 2017 OF THE SHOWN CC 0697-03-13W AND THAT THE LOCATION HAS BEEN
STAKED ON THE GROUND AS SHOWN ON THIS PLAT.

Notice: In accordance with Colorado State Law, any legal action based upon any defect in this
survey plat must commence within three (3) years after first discovery of such defect. In no
event, may any action based upon any defect in this survey plat be commenced more than
ten (10) years from the date of certification shown hereon.

CC 0697-03-07 PAD

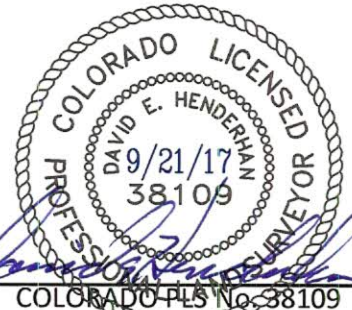

COLORADO PLS No. 38109



DRG RIFFIN & ASSOCIATES, INC.
1414 ELK ST., ROCK SPRINGS, WY 82901

DRAWN: 9/19/2017 - TCM

SCALE: 1" = 1000'

REVISED: N/A -

DRG JOB No. 21295

B8 03-13W

**PLAT OF DRILLING LOCATION IN
LOT 11, SECTION 3, FOR
LARAMIE ENERGY, LLC.**

**2215' F/NL, & 2356' F/EL, SECTION 3,
T. 6 S., R. 97 W., 6TH P.M.,
GARFIELD COUNTY, COLORADO**