

Location:	COLORADO	Slot:	SLOT#02 HFE 4 (1126FSL & 963FWL, SEC.22)
Field:	WELD COUNTY (NAD83/TRUE NORTH)	Well:	HFE 4
Facility:	SEC.22-T04N-R68W	Wellbore:	HFE 4 PWB

Plot reference wellpath is HFE 4 PWP (REV-B.0)	Grid System: NAD83 / Lambert Colorado SP, Northern Zone (501), US feet
True vertical depths are referenced to CYCLONE 37 (28KB) (RKB)	North Reference: True north
Measured depths are referenced to CYCLONE 37 (28KB) (RKB)	Scale: True distance
CYCLONE 37 (28KB) (RKB) to Mean Sea Level: 4947 feet	Depths are in feet
Mean Sea Level to Ground level (At Slot: SLOT#02 HFE 4 (1126FSL & 963FWL, SEC.22): 0 feet	Created by: ingmjmr on 2017-09-11
Coordinates are in feet referenced to Slot	Database: WA DEN Denver Delfn

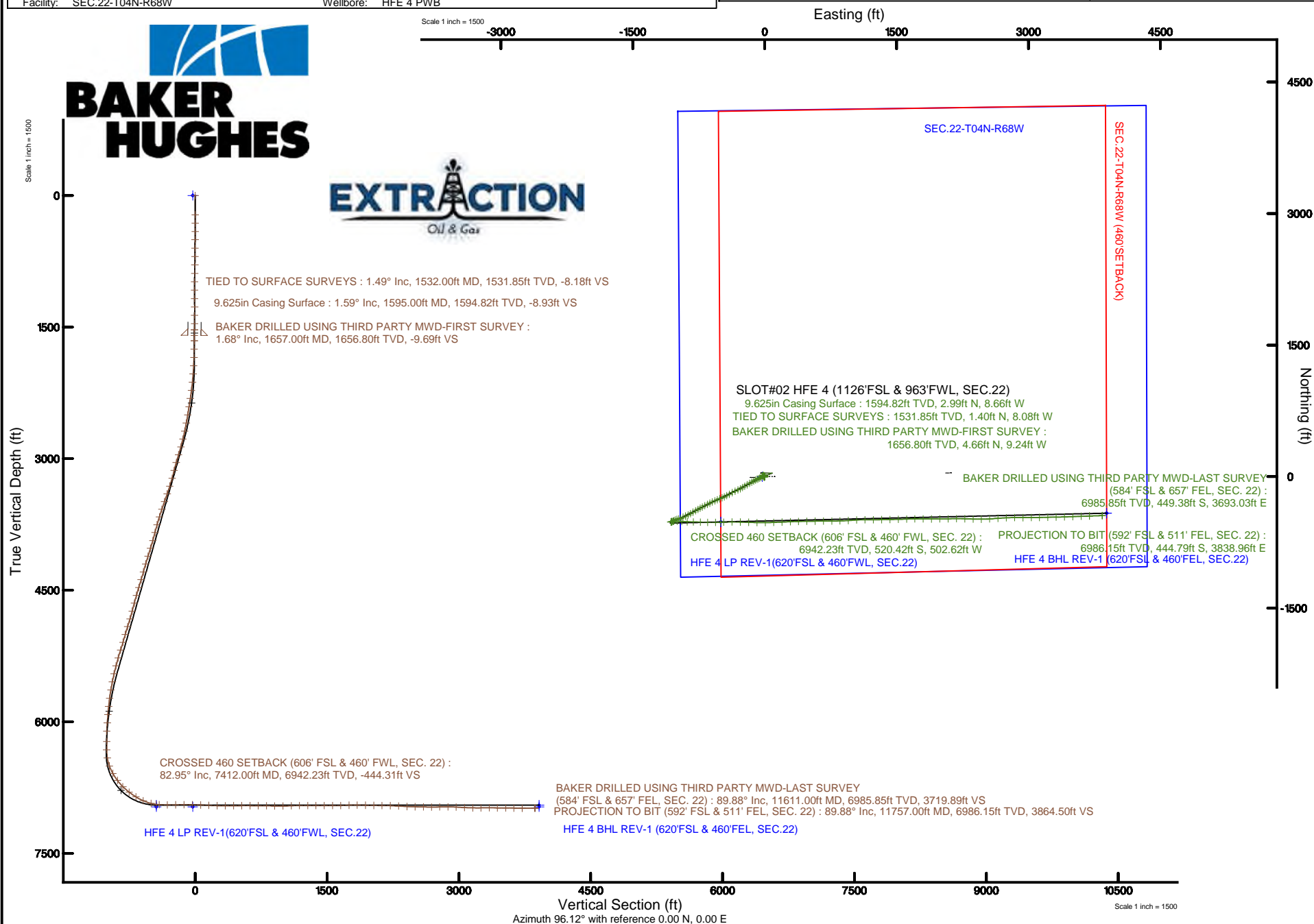



# Actual Wellpath Report

HFE 4 AWP

Page 1 of 7



## REFERENCE WELLPATH IDENTIFICATION

Operator	EXTRACTION OIL & GAS	Slot	SLOT#02 HFE 4 (1126'FSL & 963'FWL, SEC.22)
Area	COLORADO	Well	HFE 4
Field	WELD COUNTY (NAD83/TRUE NORTH)	Wellbore	HFE 4 AWB
Facility	SEC.22-T04N-R68W		

## REPORT SETUP INFORMATION

Projection System	NAD83 / Lambert Colorado SP, Northern Zone (501), US feet	Software System	WellArchitect® 5.1
North Reference	True	User	Ingmjmr
Scale	0.999957	Report Generated	9/11/2017 at 2:18:12 PM
Convergence at slot	0.33° East	Database/Source file	WA_DEN_Denver_Defn/HFE_4_AWP.xml

## WELLPATH LOCATION

	Local coordinates		Grid coordinates		Geographic coordinates	
	North[ft]	East[ft]	Easting[US ft]	Northing[US ft]	Latitude	Longitude
Slot Location	0.73	28.17	3140779.76	1350607.53	40°17'40.985"N	104°59'43.105"W
Facility Reference Pt			3140751.59	1350606.64	40°17'40.978"N	104°59'43.469"W
Field Reference Pt			3185481.27	1419166.81	40°28'55.560"N	104°49'59.556"W

## WELLPATH DATUM

Calculation method	Minimum curvature	CYCLONE 37 (28'KB) (RKB) to Facility Vertical Datum	4947.00ft
Horizontal Reference Pt	Slot	CYCLONE 37 (28'KB) (RKB) to Mean Sea Level	4947.00ft
Vertical Reference Pt	CYCLONE 37 (28'KB) (RKB)	CYCLONE 37 (28'KB) (RKB) to Ground Level at Slot (SLOT#02 HFE 4 (1126'FSL & 963'FWL, SEC.22))	4947.00ft
MD Reference Pt	CYCLONE 37 (28'KB) (RKB)	Section Origin	N 0.00, E 0.00 ft
Field Vertical Reference	Mean Sea Level	Section Azimuth	96.12°



# Actual Wellpath Report

HFE 4 AWP

Page 2 of 7



REFERENCE WELLPATH IDENTIFICATION			
Operator	EXTRACTION OIL & GAS	Slot	SLOT#02 HFE 4 (1126'FSL & 963'FWL, SEC.22)
Area	COLORADO	Well	HFE 4
Field	WELD COUNTY (NAD83/TRUE NORTH)	Wellbore	HFE 4 AWP
Facility	SEC.22-T04N-R68W		

WELLPATH DATA (109 stations)										
MD [ft]	Inclination [°]	Azimuth [°]	TVD [ft]	Vert Sect [ft]	North [ft]	East [ft]	Latitude	Longitude	DLS [°/100ft]	Comments
1532.00	1.490	339.150	1531.85	-8.18	1.40	-8.08	40°17'40.999"N	104°59'43.209"W	0.47	TIED TO SURFACE SURVEYS
1657.00	1.680	341.280	1656.80	-9.69	4.66	-9.24	40°17'41.031"N	104°59'43.224"W	0.16	BAKER DRILLED USING THIRD PARTY MWD-FIRST SURVEY
1752.00	2.300	342.780	1751.74	-11.03	7.80	-10.25	40°17'41.062"N	104°59'43.238"W	0.65	
1846.00	2.700	333.960	1845.65	-12.95	11.59	-11.78	40°17'41.099"N	104°59'43.257"W	0.59	
1941.00	3.180	275.400	1940.55	-16.78	13.85	-15.39	40°17'41.122"N	104°59'43.304"W	3.06	
2035.00	6.320	230.800	2034.24	-23.03	10.82	-22.00	40°17'41.092"N	104°59'43.389"W	4.92	
2130.00	8.620	222.690	2128.43	-30.95	2.28	-30.88	40°17'41.007"N	104°59'43.504"W	2.66	
2225.00	10.610	232.870	2222.10	-41.56	-8.23	-42.68	40°17'40.903"N	104°59'43.656"W	2.75	
2319.00	10.520	245.390	2314.52	-55.24	-17.03	-57.38	40°17'40.817"N	104°59'43.846"W	2.44	
2414.00	9.590	247.990	2408.06	-69.68	-23.61	-72.61	40°17'40.752"N	104°59'44.042"W	1.09	
2509.00	10.910	243.980	2501.54	-84.27	-30.52	-88.02	40°17'40.683"N	104°59'44.241"W	1.58	
2603.00	13.210	240.490	2593.46	-100.54	-39.71	-105.37	40°17'40.592"N	104°59'44.465"W	2.57	
2698.00	14.580	240.980	2685.68	-119.14	-50.86	-125.27	40°17'40.482"N	104°59'44.722"W	1.45	
2792.00	16.220	240.100	2776.30	-139.43	-63.14	-147.00	40°17'40.361"N	104°59'45.002"W	1.76	
2886.00	18.780	241.770	2865.94	-162.55	-76.85	-171.71	40°17'40.225"N	104°59'45.321"W	2.78	
2981.00	20.990	239.970	2955.27	-188.92	-92.60	-199.92	40°17'40.070"N	104°59'45.685"W	2.41	
3076.00	19.310	238.690	3044.45	-215.13	-109.28	-228.08	40°17'39.905"N	104°59'46.049"W	1.83	
3170.00	16.880	238.290	3133.80	-238.26	-124.53	-252.97	40°17'39.754"N	104°59'46.370"W	2.59	
3264.00	18.380	243.490	3223.39	-261.52	-138.32	-277.84	40°17'39.618"N	104°59'46.691"W	2.31	
3359.00	20.110	245.690	3313.08	-288.22	-151.73	-306.13	40°17'39.485"N	104°59'47.056"W	1.97	
3454.00	22.710	244.900	3401.51	-317.99	-166.23	-337.63	40°17'39.342"N	104°59'47.462"W	2.75	
3548.00	22.580	240.890	3488.27	-348.26	-182.71	-369.83	40°17'39.179"N	104°59'47.878"W	1.65	
3643.00	22.490	240.100	3576.02	-377.85	-200.64	-401.51	40°17'39.002"N	104°59'48.287"W	0.33	
3737.00	20.420	242.700	3663.50	-406.08	-217.13	-431.67	40°17'38.839"N	104°59'48.676"W	2.42	
3832.00	17.990	245.390	3753.21	-432.53	-230.84	-459.74	40°17'38.704"N	104°59'49.038"W	2.72	
3926.00	16.390	247.280	3843.01	-456.63	-242.01	-485.18	40°17'38.593"N	104°59'49.366"W	1.80	
4021.00	18.210	249.090	3933.71	-481.60	-252.48	-511.41	40°17'38.490"N	104°59'49.705"W	2.00	
4115.00	18.600	247.590	4022.90	-507.85	-263.44	-538.99	40°17'38.381"N	104°59'50.061"W	0.65	
4210.00	20.590	245.080	4112.40	-535.48	-276.26	-568.15	40°17'38.255"N	104°59'50.437"W	2.27	
4304.00	18.910	246.090	4200.86	-562.83	-289.40	-597.06	40°17'38.125"N	104°59'50.810"W	1.82	



# Actual Wellpath Report

HFE 4 AWP

Page 3 of 7



REFERENCE WELLPATH IDENTIFICATION			
Operator	EXTRACTION OIL & GAS	Slot	SLOT#02 HFE 4 (1126'FSL & 963'FWL, SEC.22)
Area	COLORADO	Well	HFE 4
Field	WELD COUNTY (NAD83/TRUE NORTH)	Wellbore	HFE 4 AWP
Facility	SEC.22-T04N-R68W		

WELLPATH DATA (109 stations)										
MD [ft]	Inclination [°]	Azimuth [°]	TVD [ft]	Vert Sect [ft]	North [ft]	East [ft]	Latitude	Longitude	DLS [°/100ft]	Comments
4399.00	18.290	241.680	4290.91	-588.46	-302.71	-624.26	40°17'37.993"N	104°59'51.161"W	1.62	
4494.00	20.420	242.790	4380.53	-614.60	-317.36	-652.13	40°17'37.849"N	104°59'51.521"W	2.28	
4588.00	20.020	243.090	4468.74	-641.79	-332.14	-681.06	40°17'37.703"N	104°59'51.894"W	0.44	
4683.00	17.810	244.200	4558.60	-667.76	-345.82	-708.64	40°17'37.567"N	104°59'52.250"W	2.36	
4777.00	17.590	240.760	4648.16	-691.55	-359.02	-733.98	40°17'37.437"N	104°59'52.577"W	1.14	
4872.00	18.690	240.670	4738.43	-715.66	-373.49	-759.78	40°17'37.294"N	104°59'52.910"W	1.16	
4967.00	20.020	240.100	4828.06	-741.21	-389.05	-787.14	40°17'37.140"N	104°59'53.263"W	1.41	
5061.00	21.700	241.200	4915.90	-768.48	-405.45	-816.32	40°17'36.978"N	104°59'53.640"W	1.84	
5156.00	19.000	239.790	5004.96	-795.35	-421.69	-845.08	40°17'36.818"N	104°59'54.011"W	2.89	
5250.00	19.400	242.870	5093.73	-820.73	-436.51	-872.20	40°17'36.671"N	104°59'54.361"W	1.16	
5345.00	20.420	246.180	5183.06	-848.29	-450.40	-901.41	40°17'36.534"N	104°59'54.738"W	1.60	
5439.00	18.120	246.090	5271.78	-875.16	-462.95	-929.77	40°17'36.410"N	104°59'55.104"W	2.45	
5534.00	16.080	249.080	5362.58	-899.67	-473.63	-955.57	40°17'36.304"N	104°59'55.437"W	2.34	
5628.00	14.320	253.890	5453.29	-922.03	-481.51	-978.90	40°17'36.226"N	104°59'55.738"W	2.30	
5723.00	12.020	251.290	5545.79	-941.89	-487.94	-999.56	40°17'36.163"N	104°59'56.005"W	2.50	
5817.00	11.180	246.400	5637.87	-958.68	-494.73	-1017.18	40°17'36.096"N	104°59'56.232"W	1.38	
5912.00	9.410	241.770	5731.34	-973.10	-502.09	-1032.47	40°17'36.023"N	104°59'56.429"W	2.06	
6007.00	6.980	236.790	5825.36	-983.98	-508.93	-1044.14	40°17'35.955"N	104°59'56.580"W	2.66	
6101.00	5.390	242.570	5918.81	-992.07	-514.09	-1052.84	40°17'35.904"N	104°59'56.692"W	1.81	
6196.00	4.600	258.080	6013.46	-999.42	-516.93	-1060.53	40°17'35.876"N	104°59'56.791"W	1.64	
6290.00	1.990	263.190	6107.29	-1004.59	-517.91	-1065.84	40°17'35.867"N	104°59'56.860"W	2.79	
6408.00	0.710	36.680	6225.27	-1006.22	-517.56	-1067.44	40°17'35.870"N	104°59'56.880"W	2.15	
6502.00	1.990	341.500	6319.25	-1006.60	-515.55	-1067.61	40°17'35.890"N	104°59'56.883"W	1.80	
6597.00	10.120	83.480	6413.76	-999.12	-513.03	-1059.81	40°17'35.915"N	104°59'56.782"W	11.27	
6691.00	20.420	81.370	6504.32	-975.14	-509.62	-1035.33	40°17'35.949"N	104°59'56.466"W	10.97	
6785.00	29.520	92.300	6589.48	-936.07	-508.08	-995.87	40°17'35.964"N	104°59'55.957"W	10.82	
6880.00	36.810	95.870	6668.96	-884.19	-511.94	-944.10	40°17'35.926"N	104°59'55.289"W	7.94	
6975.00	44.980	90.800	6740.73	-822.17	-515.33	-882.10	40°17'35.892"N	104°59'54.489"W	9.28	
7069.00	52.980	90.970	6802.38	-751.60	-516.43	-811.24	40°17'35.881"N	104°59'53.574"W	8.51	
7164.00	58.110	93.400	6856.11	-673.48	-519.46	-733.00	40°17'35.851"N	104°59'52.565"W	5.80	



# Actual Wellpath Report

HFE 4 AWP

Page 4 of 7



## REFERENCE WELLPATH IDENTIFICATION

Operator	EXTRACTION OIL & GAS	Slot	SLOT#02 HFE 4 (1126'FSL & 963'FWL, SEC.22)
Area	COLORADO	Well	HFE 4
Field	WELD COUNTY (NAD83/TRUE NORTH)	Wellbore	HFE 4 AWP
Facility	SEC.22-T04N-R68W		

## WELLPATH DATA (109 stations) † = interpolated/extrapolated station

MD [ft]	Inclination [°]	Azimuth [°]	TVD [ft]	Vert Sect [ft]	North [ft]	East [ft]	Latitude	Longitude	DLS [°/100ft]	Comments
7259.00	65.800	90.490	6900.75	-589.94	-522.23	-649.28	40°17'35.824"N	104°59'51.484"W	8.53	
7353.00	76.010	88.990	6931.46	-501.79	-521.79	-560.57	40°17'35.828"N	104°59'50.339"W	10.97	
7412.00†	82.953	88.300	6942.23	-444.31	-520.42	-502.62	40°17'35.842"N	104°59'49.591"W	11.82	CROSSED 460 SETBACK (606' FSL & 460' FWL, SEC. 22)
7448.00	87.190	87.890	6945.32	-408.80	-519.22	-466.78	40°17'35.854"N	104°59'49.129"W	11.82	
7542.00	90.320	89.700	6947.36	-315.60	-517.25	-372.84	40°17'35.873"N	104°59'47.917"W	3.85	
7637.00	90.010	91.190	6947.09	-221.07	-517.99	-277.84	40°17'35.866"N	104°59'46.691"W	1.60	
7732.00	91.600	91.900	6945.75	-126.39	-520.55	-182.89	40°17'35.841"N	104°59'45.465"W	1.83	
7826.00	88.690	92.300	6945.52	-32.63	-523.99	-88.96	40°17'35.807"N	104°59'44.253"W	3.12	
7921.00	86.790	88.680	6949.26	61.82	-524.81	5.94	40°17'35.799"N	104°59'43.029"W	4.30	
8016.00	87.580	87.580	6953.93	155.78	-521.71	100.77	40°17'35.829"N	104°59'41.805"W	1.42	
8111.00	88.860	87.890	6956.88	249.72	-517.96	195.65	40°17'35.866"N	104°59'40.580"W	1.39	
8206.00	90.590	87.580	6957.34	343.70	-514.20	290.57	40°17'35.904"N	104°59'39.355"W	1.85	
8300.00	89.620	88.290	6957.16	436.74	-510.82	384.51	40°17'35.937"N	104°59'38.143"W	1.28	
8394.00	90.810	89.480	6956.81	529.99	-508.99	478.49	40°17'35.955"N	104°59'36.930"W	1.79	
8489.00	89.090	89.080	6956.89	624.31	-507.79	573.47	40°17'35.967"N	104°59'35.704"W	1.86	
8583.00	90.720	90.490	6957.05	717.73	-507.44	667.47	40°17'35.970"N	104°59'34.492"W	2.29	
8678.00	88.200	88.860	6957.94	812.12	-506.90	762.45	40°17'35.976"N	104°59'33.266"W	3.16	
8772.00	88.510	88.680	6960.64	905.31	-504.88	856.39	40°17'35.995"N	104°59'32.053"W	0.38	
8867.00	91.120	86.080	6960.95	999.19	-500.54	951.27	40°17'36.038"N	104°59'30.829"W	3.88	
8962.00	92.310	86.570	6958.11	1092.76	-494.46	1046.04	40°17'36.098"N	104°59'29.606"W	1.35	
9057.00	90.590	89.780	6955.70	1186.81	-491.43	1140.94	40°17'36.128"N	104°59'28.381"W	3.83	
9151.00	89.480	89.480	6955.64	1280.20	-490.83	1234.94	40°17'36.134"N	104°59'27.168"W	1.22	
9246.00	91.210	89.870	6955.07	1374.60	-490.29	1329.93	40°17'36.140"N	104°59'25.942"W	1.87	
9340.00	89.000	88.860	6954.90	1467.94	-489.25	1423.92	40°17'36.150"N	104°59'24.730"W	2.58	
9435.00	89.790	88.200	6955.90	1562.10	-486.81	1518.88	40°17'36.174"N	104°59'23.504"W	1.08	
9530.00	91.520	88.070	6954.82	1656.17	-483.72	1613.82	40°17'36.204"N	104°59'22.279"W	1.83	
9624.00	92.490	89.170	6951.53	1749.31	-481.45	1707.73	40°17'36.227"N	104°59'21.067"W	1.56	
9719.00	89.310	91.190	6950.04	1843.77	-481.75	1802.70	40°17'36.224"N	104°59'19.841"W	3.97	
9813.00	88.110	89.960	6952.15	1937.30	-482.70	1896.67	40°17'36.214"N	104°59'18.629"W	1.83	
9908.00	89.620	89.700	6954.03	2031.71	-482.42	1991.65	40°17'36.217"N	104°59'17.403"W	1.61	



# Actual Wellpath Report

HFE 4 AWP

Page 5 of 7



REFERENCE WELLPATH IDENTIFICATION			
Operator	EXTRACTION OIL & GAS	Slot	SLOT#02 HFE 4 (1126'FSL & 963'FWL, SEC.22)
Area	COLORADO	Well	HFE 4
Field	WELD COUNTY (NAD83/TRUE NORTH)	Wellbore	HFE 4 AWP
Facility	SEC.22-T04N-R68W		

WELLPATH DATA (109 stations)											
MD [ft]	Inclination [°]	Azimuth [°]	TVD [ft]	Vert Sect [ft]	North [ft]	East [ft]	Latitude	Longitude	DLS °/100ft	Comments	
10002.00	89.310	88.370	6954.91	2124.99	480.83	2085.63	40°17'36.232"N	104°59'16.190"W	1.45		
10097.00	88.380	89.870	6956.83	2219.26	479.37	2180.59	40°17'36.247"N	104°59'14.965"W	1.86		
10192.00	86.300	91.460	6961.24	2313.72	480.47	2275.48	40°17'36.236"N	104°59'13.740"W	2.75		
10287.00	87.320	92.160	6966.52	2408.30	483.47	2370.28	40°17'36.206"N	104°59'12.517"W	1.30		
10381.00	89.400	90.090	6969.21	2501.89	485.31	2464.21	40°17'36.188"N	104°59'11.304"W	3.12		
10476.00	88.510	86.170	6970.95	2595.94	482.22	2559.13	40°17'36.218"N	104°59'10.080"W	4.23		
10570.00	89.480	85.380	6972.60	2688.40	475.29	2652.86	40°17'36.287"N	104°59'08.870"W	1.33		
10665.00	92.000	87.360	6971.37	2782.00	469.28	2747.65	40°17'36.346"N	104°59'07.647"W	3.37		
10760.00	89.480	90.490	6970.14	2876.23	467.50	2842.60	40°17'36.363"N	104°59'06.421"W	4.23		
10854.00	86.480	89.780	6973.45	2969.65	467.72	2936.53	40°17'36.361"N	104°59'05.209"W	3.28		
10949.00	87.410	89.300	6978.52	3063.89	466.96	3031.39	40°17'36.369"N	104°59'03.985"W	1.10		
11043.00	88.910	88.770	6981.54	3157.12	465.37	3125.33	40°17'36.384"N	104°59'02.773"W	1.69		
11138.00	90.900	88.680	6981.69	3251.33	463.26	3220.30	40°17'36.405"N	104°59'01.547"W	2.10		
11233.00	89.880	89.300	6981.05	3345.59	461.59	3315.28	40°17'36.421"N	104°59'00.321"W	1.26		
11327.00	88.820	88.070	6982.11	3438.79	459.43	3409.25	40°17'36.442"N	104°58'59.109"W	1.73		
11422.00	90.100	87.580	6983.01	3532.79	455.82	3504.17	40°17'36.478"N	104°58'57.884"W	1.44		
11516.00	88.290	88.200	6984.33	3625.81	452.36	3598.09	40°17'36.512"N	104°58'56.672"W	2.04		
11611.00	89.880	88.200	6985.85	3719.89	449.38	3693.03	40°17'36.541"N	104°58'55.446"W	1.67	BAKER DRILLED USING THIRD PARTY MWD-LAST SURVEY (584' FSL & 657' FEL, SEC. 22)	
11757.00	89.880	88.200	6986.15	3864.50	444.79	3838.96	40°17'36.586"N	104°58'53.563"W	0.00	PROJECTION TO BIT (592' FSL & 511' FEL, SEC. 22)	

HOLE & CASING SECTIONS - Ref Wellbore: HFE 4 AWP      Ref Wellpath: HFE 4 AWP									
String/Diameter	Start MD [ft]	End MD [ft]	Interval [ft]	Start TVD [ft]	End TVD [ft]	Start N/S [ft]	Start E/W [ft]	End N/S [ft]	End E/W [ft]
9.625in Casing Surface	28.00	1595.00	1567.00	28.00	1594.82	0.01	0.00	2.99	-8.66
8.5in Open Hole	1595.00	11757.00	10162.00	1594.82	6986.15	2.99	-8.66	-444.79	3838.96



# Actual Wellpath Report

HFE 4 AWP

Page 6 of 7



## REFERENCE WELLPATH IDENTIFICATION

Operator	EXTRACTION OIL & GAS	Slot	SLOT#02 HFE 4 (1126'FSL & 963'FWL, SEC.22)
Area	COLORADO	Well	HFE 4
Field	WELD COUNTY (NAD83/TRUE NORTH)	Wellbore	HFE 4 AWP
Facility	SEC.22-T04N-R68W		

## TARGETS

Name	TVD [ft]	North [ft]	East [ft]	Grid East [US ft]	Grid North [US ft]	Latitude	Longitude	Shape
SEC.22-T04N-R68W	-1.00	-0.73	-28.17	3140751.59	1350606.64	40°17'40.978"N	104°59'43.469"W	polygon
HFE 4 BHL REV-1 (620'FSL & 460'FEL, SEC.22)	6950.00	-416.80	3889.80	3144671.69	1350212.89	40°17'36.863"N	104°58'52.907"W	point
HFE 4 LP REV-1(620'FSL & 460'FWL, SEC.22)	6950.00	-516.98	-500.18	3140282.55	1350087.73	40°17'35.876"N	104°59'49.560"W	point
HFE 4 BHL (620'FSL & 460'FEL, SEC.22)	6970.00	-416.82	3889.82	3144671.71	1350212.87	40°17'36.863"N	104°58'52.907"W	point
HFE 4 LP (620'FSL & 460'FWL, SEC.22)	6970.00	-516.94	-500.18	3140282.55	1350087.77	40°17'35.876"N	104°59'49.560"W	point
SEC.22-T04N-R68W (460'SETBACK)	6970.00	-0.73	-28.17	3140751.59	1350606.64	40°17'40.978"N	104°59'43.469"W	polygon

## WELLPATH COMPOSITION - Ref Wellbore: HFE 4 AWP Ref Wellpath: HFE 4 AWP

Start MD [ft]	End MD [ft]	Positional Uncertainty Model	Log Name/Comment	Wellbore
0.00	1532.00	ISCWSA MWD, Rev. 4 (Standard)	SURFACE SURVEYS PROVIDED BY EXTRACTION <221-1532>	HFE 4 AWP
1532.00	11611.00	ISCWSA MWD, Rev. 4 (Standard)	BAKER DRILLED USING THIRD PARTY MWD <1657-11611>	HFE 4 AWP
11611.00	11757.00	Blind Drilling (std)	Projection to bit	HFE 4 AWP



# Actual Wellpath Report

HFE 4 AWP

Page 7 of 7



## REFERENCE WELLPATH IDENTIFICATION

Operator	EXTRACTION OIL & GAS	Slot	SLOT#02 HFE 4 (1126'FSL & 963'FWL, SEC.22)
Area	COLORADO	Well	HFE 4
Field	WELD COUNTY (NAD83/TRUE NORTH)	Wellbore	HFE 4 AWB
Facility	SEC.22-T04N-R68W		

## WELLPATH COMMENTS

MD [ft]	Inclination [°]	Azimuth [°]	TVD [ft]	Comment
1532.00	1.490	339.150	1531.85	TIED TO SURFACE SURVEYS
1657.00	1.680	341.280	1656.80	BAKER DRILLED USING THIRD PARTY MWD-FIRST SURVEY
7412.00	82.953	88.300	6942.23	CROSSED 460 SETBACK (606' FSL & 460' FWL, SEC. 22)
11611.00	89.880	88.200	6985.85	BAKER DRILLED USING THIRD PARTY MWD-LAST SURVEY (584' FSL & 657' FEL, SEC. 22)
11757.00	89.880	88.200	6986.15	PROJECTION TO BIT (592' FSL & 511' FEL, SEC. 22)