



October 6, 2017

Mr. Matt Lepore, Director
Colorado Oil and Gas Conservation Commission
1120 Lincoln Street, Suite 801
Denver, Colorado 80203

**RE: COGCC Rule 318A.e.: Proposed Spacing Unit
G & D Hanks X-27-28HN Well: SWSE Section 27, Township 7 North, Range 66 West
Weld County, Colorado**

Dear Mr. Lepore:

Bayswater Exploration & Production, LLC (Bayswater) is planning to drill the above referenced well in accordance with the provisions set out in Colorado Oil and Gas Conservation Commission (COGCC) Rule 318A.e. Bayswater's Proposed Spacing Unit consists of:

S½S½ of Section 27 & 28, Township 7 North, Range 66 West
SE¼SE¼ of Section 29, Township 7 North, Range 66 West
N½N½ of Section 33 & 34, Township 7 North, Range 66 West
NE¼NE¼ of Section 32, Township 7 North, Range 66 West
Containing 720.00 acres, more or less

Bayswater is not the only owner within the Proposed Spacing Unit and has provided notice to the remaining owners, as required by COGCC Rule 318A.e.(6). Copies of the required notification letters are on file at Bayswater's office. The required thirty (30) day notice period has elapsed absent the receipt by Bayswater of any objection to their proposal by the owners within the Proposed Spacing Unit for the subject well.

Enclosed is the Proposed Spacing Unit Exhibit to assist in your review and approval of Bayswater's proposed Application for Permit to Drill for the G & D Hanks X-27-28HN Well. Many thanks for your attention to this matter.

Respectfully,

A handwritten signature in blue ink, appearing to read 'Jeff Annable', written over a light blue circular background.

Jeff Annable
Regulatory Analyst
Agent for Bayswater Exploration & Production, LLC

:ja

Enclosure: Proposed Spacing Unit Exhibit

G & D HANKS 27-N PAD
PROPOSED 318A.a.(4)D. SPACING UNIT
SEC 27, T7N, R66W: S2S2
SEC 28, T7N, R66W: S2S2
SEC 29, T7N, R66W: SE4SE4
SEC 32, T7N, R66W: NE4NE4
SEC 33, T7N, R66W: N2N2
SEC 34, T7N, R66W: N2N2

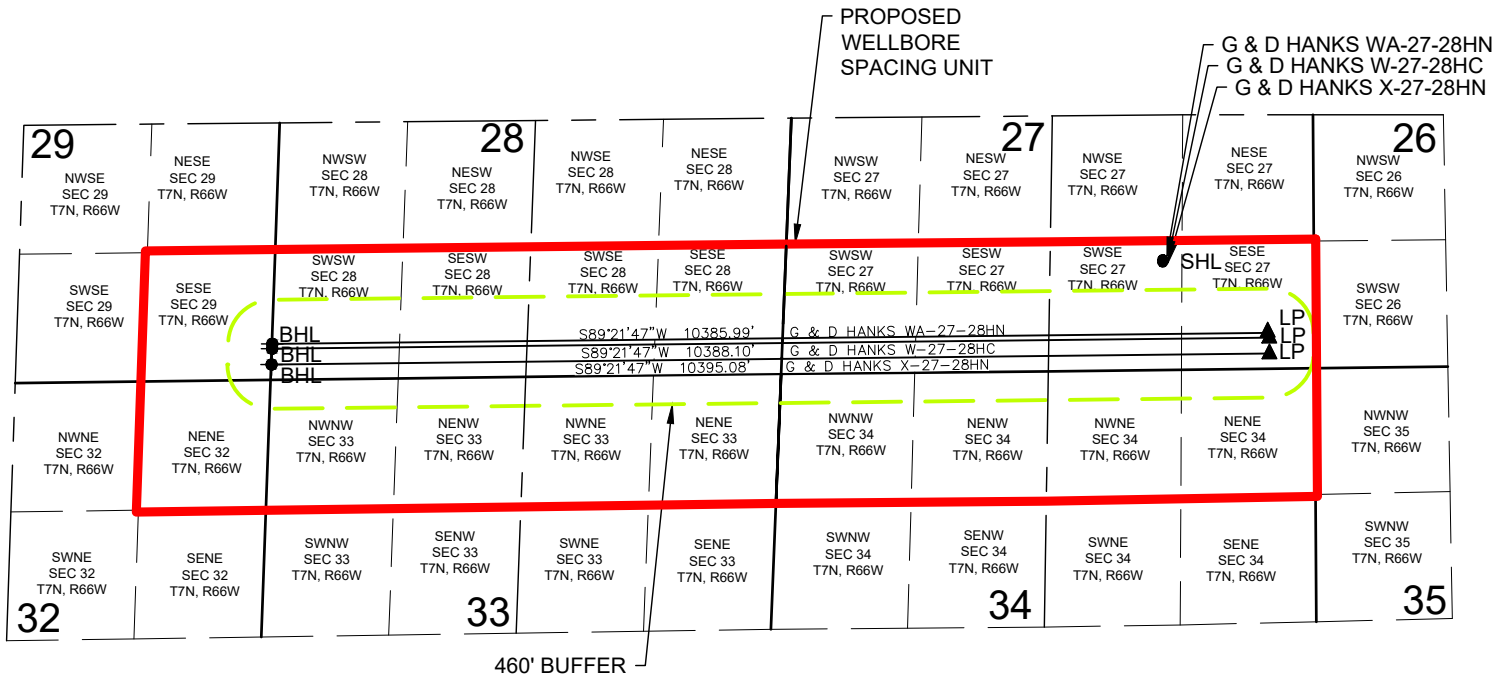

G & D HANKS WA-27-28HN WELL TO BE LOCATED 1153' FSL AND 1575' FEL, SEC 27, T7N, R66W
G & D HANKS W-27-28HC WELL TO BE LOCATED 1138' FSL AND 1575' FEL, SEC 27, T7N, R66W
G & D HANKS X-27-28HN WELL TO BE LOCATED 1123' FSL AND 1575' FEL, SEC 27, T7N, R66W

LEGEND

- = PROPOSED WELL
- = BOTTOM HOLE
- ▲ = LANDING POINT
- SHL = SURFACE HOLE LOCATION
- BHL = BOTTOM HOLE LOCATION
- LP = LANDING POINT

DISCLAIMER:
THIS PLOT DOES NOT REPRESENT A MONUMENTED LAND SURVEY AND SHOULD NOT BE
RELIED UPON TO DETERMINE BOUNDARY LINES, PROPERTY OWNERSHIP OR OTHER
PROPERTY INTERESTS. PARCEL LINES, IF DEPICTED HAVE NOT BEEN FIELD VERIFIED AND
MAY BE BASED UPON PUBLICLY AVAILABLE DATA THAT ALSO HAS NOT BEEN
INDEPENDENTLY VERIFIED.

