



October 26, 2017

Mr. Matt Lepore, Director
Colorado Oil and Gas Conservation Commission
1120 Lincoln Street, Suite 801
Denver, Colorado 80203

**RE: COGCC Rule 318A.e.: Proposed Spacing Unit
Booth 8-L Pad (Loc ID: 452439)
Wells: Booth M-8-7HN (API: 123-45585), Booth N-8-7HC (API: 123-45591)
SESE Section 8, Township 6 North, Range 66 West
Weld County, Colorado**

Dear Mr. Lepore:

Bayswater Exploration & Production, LLC (Bayswater) is planning to drill the above referenced wells in accordance with the provisions set out in Colorado Oil and Gas Conservation Commission (COGCC) Rule 318A.e. Bayswater's Proposed Spacing Unit consists of:

S/2NE/4, N/2SE/4 of Section 7, Township 6 North, Range 66 West
S/2N/2, N/2S/2 of Section 8, Township 6 North, Range 66 West
S/2NW/4, N/2SW/4 of Section 9, Township 6 North, Range 66 West
Containing 640.00 acres, more or less

Bayswater is not the only owner within the Proposed Spacing Unit and has provided notice to the remaining owners, as required by COGCC Rule 318A.e.(6). Copies of the required notification letters are on file at Bayswater's office. The required thirty (30) day notice period has elapsed absent the receipt by Bayswater of any objection to their proposal by the owners within the Proposed Spacing Unit for the subject wells.

Enclosed is the Proposed Spacing Unit Exhibit to assist in your review and approval of Bayswater's proposed sundries for the subject wells. Many thanks for your attention to this matter.

Respectfully,

A handwritten signature in black ink, appearing to read 'Justin Garrett', written over a light blue horizontal line.

Justin Garrett
Regulatory Analyst
Agent for Bayswater Exploration & Production, LLC

:jg

Enclosure: Proposed Spacing Unit Exhibit

BOOTH 8-L PAD
PROPOSED 318A.a.(4)D. SPACING UNIT
SEC 7: S2NE, N2SE
SEC 8: S2N2, N2S2
SEC 9: S2NW, N2SW

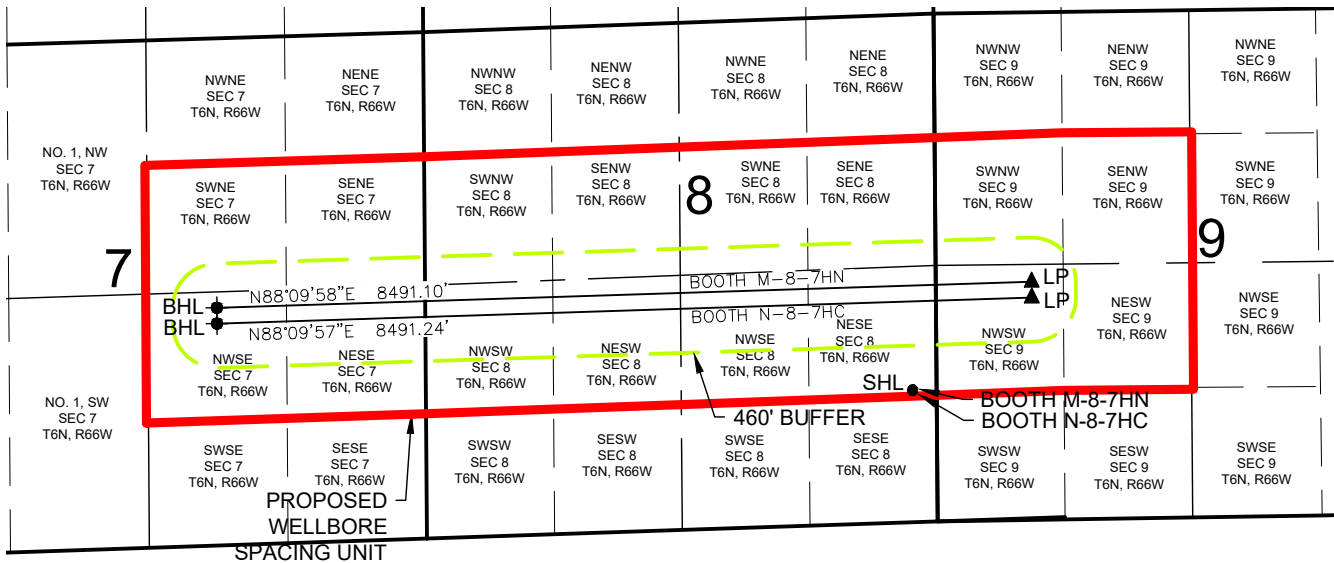

BOOTH M-8-7HN WELL TO BE LOCATED 1381' FSL AND 249' FEL, SEC 8, T6N, R66W
BOOTH N-8-7HC WELL TO BE LOCATED 1366' FSL AND 249' FEL, SEC 8, T6N, R66W

LEGEND

- = PROPOSED WELL
- = BOTTOM HOLE
- ▲ = LANDING POINT
- SHL = SURFACE HOLE LOCATION
- BHL = BOTTOM HOLE LOCATION
- LP = LANDING POINT

DISCLAIMER:
THIS PLOT DOES NOT REPRESENT A MONUMENTED LAND SURVEY AND SHOULD NOT BE
RELIED UPON TO DETERMINE BOUNDARY LINES, PROPERTY OWNERSHIP OR OTHER
PROPERTY INTERESTS. PARCEL LINES, IF DEPICTED HAVE NOT BEEN FIELD VERIFIED AND
MAY BE BASED UPON PUBLICLY AVAILABLE DATA THAT ALSO HAS NOT BEEN
INDEPENDENTLY VERIFIED.

