

Location:	COLORADO	Slot:	SLOT#17 DONN 4N-20B-L (818'FNL & 251'FEL, SEC.21)
Field:	WELD COUNTY (NAD83,TRUE NORTH)	Well:	DONN 4N-20B-L
Facility:	SEC.21-T06N-R66W	Wellbore:	DONN 4N-20B-L PWB

Plot reference wellpath is DONN 4N-20B-L PWP (REV.8.0)	Grid System: NAD83 / Lambert Colorado SP, Northern Zone (501), US feet
True vertical depths are referenced to PRECISION DRILLING (25) (RKB)	North Reference: True north
Measured depths are referenced to PRECISION DRILLING (25) (RKB)	Scale: True distance
PRECISION DRILLING (25) (RKB) to Mean Sea Level: 4777 feet	Depths are in feet
Mean Sea Level to Mud line (At Slot: SLOT#17 DONN 4N-20B-L (818FNL & 251FEL, SEC.21)): 0 feet	Created by: doddiana on 2017-08-25
Coordinates are in feet referenced to Slot	Database: Denver DB

Facility Name	Grid East (US ft)	Grid North (US ft)	Latitude	Longitude
SEC.21-TDGN-R66W	3201871.604	1417148.268	40°28'34.342"N	104°46'27.660"W
Slot	Local N (ft)	Local E (ft)	Grid East (US ft)	Grid North (US ft)
SLOT#17 DONN 4N-20B-L (818FNL & 251FEL, SEC.21)	983.62	24.48	3201888.034	1418132.014
PRECISION DRILLING (25) (RKb) to Mud line (At Slot: SLOT#17 DONN 4N-20B-L (818FNL & 251FEL, SEC.21))				4777R
Mean Sea Level to Mud line (At Slot: SLOT#17 DONN 4N-20B-L (818FNL & 251FEL, SEC.21))				0R
PRECISION DRILLING (25) (RKb) to Mean Sea Level				4777R

Start MD (ft)	End MD (ft)	Tool	Model	Log Name/Comment	Wellbore
25.00	1750.00	BHI NavTrak	Custom BHI NavTrak (Standard Rotating-Axial Corr) (Rockies 0.03Gt model)		DONN 4N-208-L PWB
1750.00	17753.95	BHI AutoTrak Curve	Custom BHI AutoTrak Curve (FR1, Short) (Rockies 0.03Gt model)		DONN 4N-208-L PWB

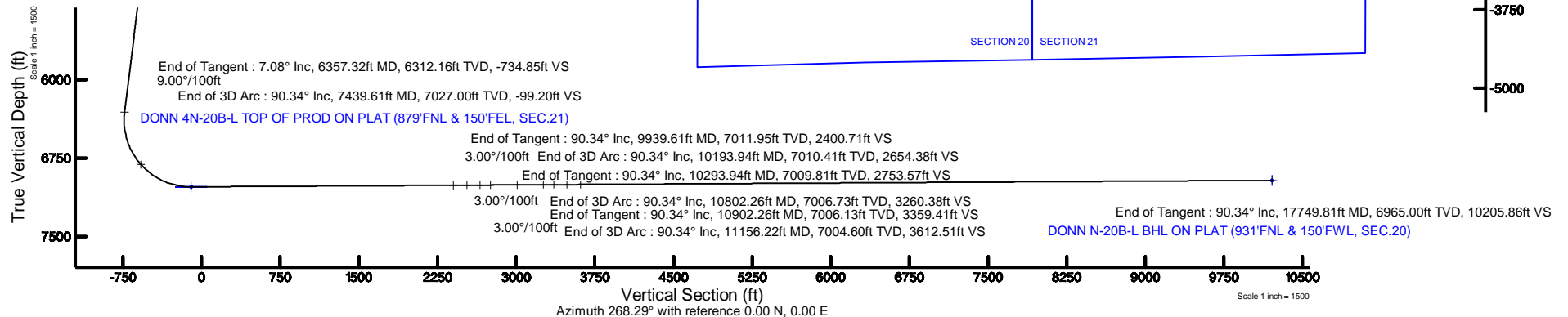
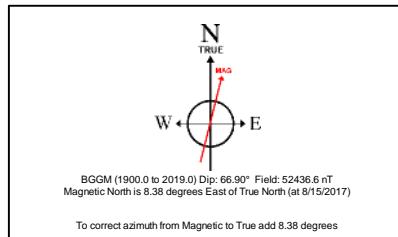

## ~VERSION INFORMATION

VERS. 2.0 : CWLS LOG ASCII STANDARD-VERSION 2.0

WRAP. NO : ASCII DATA SECTION CONTAINS ONE ROW PER WELLPATH STATION

## ~WELL INFORMATION

#MNEM	.UNITS	DATA	:DESCRIPTION
#----	.-----	----	:-----
STRT	.ft	0.00	:START MD
STOP	.ft	17749.81	:STOP MD
STEP	.ft	0.0	:STEP (non-uniform increment)
NULL	.	-999.99	:NULL
COMP	.	SRC ENERGY	:OPERATOR
WELL	.	DONN 4N-20B-L	:WELL
FLD	.	WELD COUNTY (NAD83,TRUE NORTH)	:FIELD
LOC	.	COLORADO	:AREA (aka: Location)
CNTY	.	N/A	:COUNTY
STAT	.	N/A	:STATE
CTRY	.	N/A	:COUNTRY
SRVC	.	Baker Hughes	:CONTRACTOR
DATE	.	08/16/2017	:LOG REV DATE
API	.		:API NUMBER

## ~OTHER INFORMATION

#Software: WellArchitect(R) Version 5.1

#MNEM	.UNITS	DATA	:DESCRIPTION
#----	.-----	----	:-----
WPTYPE	.	PLANNED WELLPATH	:WELLPATH TYPE
FACILITY	.	SEC.21-T06N-R66W	:FACILITY
SLOT	.	SLOT#17 DONN 4N-20B-L (818'FNL & 251'FEL, SEC.21)	:SLOT
WELLBORE	.	DONN 4N-20B-L PWB	:WELLBORE
WELLPATH	.	DONN 4N-20B-L PWP (REV-B.0)	:WELLPATH
MDREFPT	.	PRECISION DRILLING (25') (RKB)	:MD REFERENCE POINT
TVDREFPT	.	PRECISION DRILLING (25') (RKB)	:TVD REFERENCE POINT
LCLREFPT	.	Slot	:LOCAL COORDINATE
REFERENCE PT			
VSAZIMUTH.deg		268.29	:VERTICAL SECTION
AZIMUTH			
VSORIGN .ft		0.00	:VERTICAL SECTION
ORIGIN NORTH			
VSORIGE .ft		0.00	:VERTICAL SECTION
ORIGIN EAST			

## ~CURVE (WELLPATH) INFORMATION

#MNEM	.UNITS	:DESCRIPTION
#----	.-----	:-----
DEPT	.ft	:MEASURED DEPTH
INC	.deg	:INCLINATION
AZI	.deg	:AZIMUTH
TVD	.ft	:TRUE VERTICAL DEPTH
SECT	.ft	:CROSS SECTION (CURTAIN/VERTICAL)
LOCALN	.ft	:LOCAL NORTH

DONN\_4N-20B-L\_PWP\_\_REV-B.0\_.las

LOCALE .ft :LOCAL EAST  
 LAT .deg :LATITUDE  
 LONG .deg :LONGITUDE  
 DLS .deg/100ft :DOGLEG SEVERITY

~ASCII DATA

0.00	0.00	92.84	0.00	0.00	0.00	0.00	40.4789060
-104.7742620	0.00						
25.00	0.00	92.84	25.00	0.00	0.00	0.00	40.4789060
-104.7742620	0.00						
125.00	0.00	92.84	125.00	0.00	0.00	0.00	40.4789060
-104.7742620	0.00						
200.00	0.00	92.84	200.00	0.00	0.00	0.00	40.4789060
-104.7742620	0.00						
225.00	0.50	92.84	225.00	-0.11	-0.01	0.11	40.4789060
-104.7742616	2.00						
325.00	2.50	92.84	324.96	-2.72	-0.14	2.72	40.4789056
-104.7742522	2.00						
425.00	4.50	92.84	424.77	-8.80	-0.44	8.82	40.4789048
-104.7742303	2.00						
525.00	6.50	92.84	524.30	-18.36	-0.91	18.39	40.4789035
-104.7741959	2.00						
554.02	7.08	92.84	553.12	-21.78	-1.08	21.82	40.4789030
-104.7741836	2.00						
625.00	7.08	92.84	623.56	-30.50	-1.52	30.56	40.4789018
-104.7741522	0.00						
725.00	7.08	92.84	722.80	-42.79	-2.13	42.87	40.4789002
-104.7741079	0.00						
825.00	7.08	92.84	822.03	-55.07	-2.74	55.18	40.4788985
-104.7740637	0.00						
925.00	7.08	92.84	921.27	-67.36	-3.35	67.49	40.4788968
-104.7740194	0.00						
1025.00	7.08	92.84	1020.51	-79.65	-3.96	79.80	40.4788951
-104.7739751	0.00						
1125.00	7.08	92.84	1119.75	-91.94	-4.57	92.11	40.4788935
-104.7739309	0.00						
1225.00	7.08	92.84	1218.98	-104.22	-5.18	104.42	40.4788918
-104.7738866	0.00						
1325.00	7.08	92.84	1318.22	-116.51	-5.79	116.74	40.4788901
-104.7738424	0.00						
1425.00	7.08	92.84	1417.46	-128.80	-6.40	129.05	40.4788884
-104.7737981	0.00						
1525.00	7.08	92.84	1516.70	-141.09	-7.01	141.36	40.4788867
-104.7737539	0.00						
1625.00	7.08	92.84	1615.93	-153.37	-7.63	153.67	40.4788851
-104.7737096	0.00						
1725.00	7.08	92.84	1715.17	-165.66	-8.24	165.98	40.4788834
-104.7736654	0.00						
1825.00	7.08	92.84	1814.41	-177.95	-8.85	178.29	40.4788817
-104.7736211	0.00						
1925.00	7.08	92.84	1913.64	-190.24	-9.46	190.60	40.4788800
-104.7735769	0.00						

DONN\_4N-20B-L\_PWP\_\_REV-B.0\_.las

2025.00	7.08	92.84	2012.88	-202.52	-10.07	202.91	40.4788784
-104.7735326	0.00						
2125.00	7.08	92.84	2112.12	-214.81	-10.68	215.23	40.4788767
-104.7734884	0.00						
2225.00	7.08	92.84	2211.36	-227.10	-11.29	227.54	40.4788750
-104.7734441	0.00						
2325.00	7.08	92.84	2310.59	-239.39	-11.90	239.85	40.4788733
-104.7733998	0.00						
2425.00	7.08	92.84	2409.83	-251.67	-12.51	252.16	40.4788717
-104.7733556	0.00						
2525.00	7.08	92.84	2509.07	-263.96	-13.12	264.47	40.4788700
-104.7733113	0.00						
2625.00	7.08	92.84	2608.31	-276.25	-13.73	276.78	40.4788683
-104.7732671	0.00						
2725.00	7.08	92.84	2707.54	-288.53	-14.35	289.09	40.4788666
-104.7732228	0.00						
2825.00	7.08	92.84	2806.78	-300.82	-14.96	301.40	40.4788649
-104.7731786	0.00						
2925.00	7.08	92.84	2906.02	-313.11	-15.57	313.71	40.4788633
-104.7731343	0.00						
3025.00	7.08	92.84	3005.26	-325.40	-16.18	326.03	40.4788616
-104.7730901	0.00						
3125.00	7.08	92.84	3104.49	-337.68	-16.79	338.34	40.4788599
-104.7730458	0.00						
3225.00	7.08	92.84	3203.73	-349.97	-17.40	350.65	40.4788582
-104.7730016	0.00						
3325.00	7.08	92.84	3302.97	-362.26	-18.01	362.96	40.4788566
-104.7729573	0.00						
3425.00	7.08	92.84	3402.21	-374.55	-18.62	375.27	40.4788549
-104.7729131	0.00						
3525.00	7.08	92.84	3501.44	-386.83	-19.23	387.58	40.4788532
-104.7728688	0.00						
3625.00	7.08	92.84	3600.68	-399.12	-19.84	399.89	40.4788515
-104.7728246	0.00						
3725.00	7.08	92.84	3699.92	-411.41	-20.45	412.20	40.4788498
-104.7727803	0.00						
3825.00	7.08	92.84	3799.16	-423.70	-21.07	424.51	40.4788482
-104.7727361	0.00						
3925.00	7.08	92.84	3898.39	-435.98	-21.68	436.83	40.4788465
-104.7726918	0.00						
4025.00	7.08	92.84	3997.63	-448.27	-22.29	449.14	40.4788448
-104.7726475	0.00						
4125.00	7.08	92.84	4096.87	-460.56	-22.90	461.45	40.4788431
-104.7726033	0.00						
4225.00	7.08	92.84	4196.10	-472.85	-23.51	473.76	40.4788415
-104.7725590	0.00						
4325.00	7.08	92.84	4295.34	-485.13	-24.12	486.07	40.4788398
-104.7725148	0.00						
4425.00	7.08	92.84	4394.58	-497.42	-24.73	498.38	40.4788381
-104.7724705	0.00						
4525.00	7.08	92.84	4493.82	-509.71	-25.34	510.69	40.4788364
-104.7724263	0.00						

DONN\_4N-20B-L\_PWP\_\_REV-B.0\_.las

4625.00	7.08	92.84	4593.05	-522.00	-25.95	523.00	40.4788347
-104.7723820	0.00						
4725.00	7.08	92.84	4692.29	-534.28	-26.56	535.31	40.4788331
-104.7723378	0.00						
4825.00	7.08	92.84	4791.53	-546.57	-27.17	547.63	40.4788314
-104.7722935	0.00						
4925.00	7.08	92.84	4890.77	-558.86	-27.79	559.94	40.4788297
-104.7722493	0.00						
5025.00	7.08	92.84	4990.00	-571.15	-28.40	572.25	40.4788280
-104.7722050	0.00						
5125.00	7.08	92.84	5089.24	-583.43	-29.01	584.56	40.4788264
-104.7721608	0.00						
5225.00	7.08	92.84	5188.48	-595.72	-29.62	596.87	40.4788247
-104.7721165	0.00						
5325.00	7.08	92.84	5287.72	-608.01	-30.23	609.18	40.4788230
-104.7720723	0.00						
5425.00	7.08	92.84	5386.95	-620.29	-30.84	621.49	40.4788213
-104.7720280	0.00						
5525.00	7.08	92.84	5486.19	-632.58	-31.45	633.80	40.4788196
-104.7719837	0.00						
5625.00	7.08	92.84	5585.43	-644.87	-32.06	646.11	40.4788180
-104.7719395	0.00						
5725.00	7.08	92.84	5684.67	-657.16	-32.67	658.43	40.4788163
-104.7718952	0.00						
5825.00	7.08	92.84	5783.90	-669.44	-33.28	670.74	40.4788146
-104.7718510	0.00						
5925.00	7.08	92.84	5883.14	-681.73	-33.89	683.05	40.4788129
-104.7718067	0.00						
6025.00	7.08	92.84	5982.38	-694.02	-34.51	695.36	40.4788113
-104.7717625	0.00						
6125.00	7.08	92.84	6081.62	-706.31	-35.12	707.67	40.4788096
-104.7717182	0.00						
6225.00	7.08	92.84	6180.85	-718.59	-35.73	719.98	40.4788079
-104.7716740	0.00						
6325.00	7.08	92.84	6280.09	-730.88	-36.34	732.29	40.4788062
-104.7716297	0.00						
6357.32	7.08	92.84	6312.16	-734.85	-36.54	736.27	40.4788057
-104.7716154	0.00						
6425.00	1.10	116.96	6379.64	-739.59	-37.04	741.02	40.4788043
-104.7715983	9.00						
6525.00	8.05	264.93	6479.35	-733.43	-38.10	734.89	40.4788014
-104.7716204	9.00						
6625.00	17.04	266.92	6576.86	-711.75	-39.50	713.25	40.4787975
-104.7716982	9.00						
6725.00	26.04	267.56	6669.78	-675.09	-41.23	676.62	40.4787928
-104.7718298	9.00						
6825.00	35.03	267.88	6755.83	-624.34	-43.23	625.91	40.4787873
-104.7720121	9.00						
6925.00	44.03	268.09	6832.87	-560.75	-45.46	562.36	40.4787812
-104.7722406	9.00						
7025.00	53.03	268.23	6899.03	-485.89	-47.86	487.54	40.4787746
-104.7725095	9.00						

DONN\_4N-20B-L\_PWP\_\_REV-B.0\_.las

7125.00	62.03	268.35	6952.65	-401.61	-50.37	403.29	40.4787677
-104.7728123	9.00						
7225.00	71.03	268.45	6992.44	-309.98	-52.92	311.70	40.4787607
-104.7731416	9.00						
7325.00	80.03	268.54	7017.40	-213.25	-55.47	215.00	40.4787537
-104.7734892	9.00						
7425.00	89.03	268.62	7026.92	-113.81	-57.94	115.59	40.4787470
-104.7738465	9.00						
7439.61	90.35	268.63	7027.00	-99.20	-58.29	100.99	40.4787460
-104.7738990	9.00						
7525.00	90.35	268.63	7026.49	-13.81	-60.33	15.62	40.4787404
-104.7742058	0.00						
7625.00	90.35	268.63	7025.88	86.18	-62.72	-84.35	40.4787338
-104.7745652	0.00						
7725.00	90.35	268.63	7025.28	186.18	-65.11	-184.32	40.4787273
-104.7749245	0.00						
7825.00	90.35	268.63	7024.68	286.18	-67.50	-284.29	40.4787207
-104.7752839	0.00						
7925.00	90.35	268.63	7024.08	386.17	-69.90	-384.26	40.4787141
-104.7756432	0.00						
8025.00	90.35	268.63	7023.48	486.17	-72.29	-484.23	40.4787076
-104.7760026	0.00						
8125.00	90.35	268.63	7022.87	586.17	-74.68	-584.20	40.4787010
-104.7763619	0.00						
8225.00	90.35	268.63	7022.27	686.16	-77.07	-684.17	40.4786944
-104.7767213	0.00						
8325.00	90.35	268.63	7021.67	786.16	-79.46	-784.14	40.4786879
-104.7770806	0.00						
8425.00	90.35	268.63	7021.07	886.15	-81.85	-884.11	40.4786813
-104.7774400	0.00						
8525.00	90.35	268.63	7020.46	986.15	-84.24	-984.08	40.4786747
-104.7777993	0.00						
8625.00	90.35	268.63	7019.86	1086.15	-86.63	-1084.04	40.4786681
-104.7781587	0.00						
8725.00	90.35	268.63	7019.26	1186.14	-89.02	-1184.01	40.4786616
-104.7785180	0.00						
8825.00	90.35	268.63	7018.66	1286.14	-91.41	-1283.98	40.4786550
-104.7788774	0.00						
8925.00	90.35	268.63	7018.06	1386.14	-93.80	-1383.95	40.4786484
-104.7792367	0.00						
9025.00	90.35	268.63	7017.45	1486.13	-96.19	-1483.92	40.4786418
-104.7795961	0.00						
9125.00	90.35	268.63	7016.85	1586.13	-98.59	-1583.89	40.4786353
-104.7799554	0.00						
9225.00	90.35	268.63	7016.25	1686.13	-100.98	-1683.86	40.4786287
-104.7803148	0.00						
9325.00	90.35	268.63	7015.65	1786.12	-103.37	-1783.83	40.4786221
-104.7806741	0.00						
9425.00	90.35	268.63	7015.05	1886.12	-105.76	-1883.80	40.4786155
-104.7810334	0.00						
9525.00	90.35	268.63	7014.44	1986.12	-108.15	-1983.77	40.4786089
-104.7813928	0.00						

DONN\_4N-20B-L\_PWP\_\_REV-B.0\_.las

9625.00	90.35	268.63	7013.84	2086.11	-110.54	-2083.74	40.4786023
-104.7817521	0.00						
9725.00	90.35	268.63	7013.24	2186.11	-112.93	-2183.71	40.4785958
-104.7821115	0.00						
9825.00	90.35	268.63	7012.64	2286.10	-115.32	-2283.68	40.4785892
-104.7824708	0.00						
9925.00	90.35	268.63	7012.03	2386.10	-117.71	-2383.65	40.4785826
-104.7828302	0.00						
9939.61	90.35	268.63	7011.95	2400.71	-118.06	-2398.25	40.4785816
-104.7828827	0.00						
10025.00	90.35	266.07	7011.43	2486.08	-122.01	-2483.54	40.4785708
-104.7831893	3.00						
10125.00	90.35	263.07	7010.83	2585.86	-131.48	-2583.08	40.4785447
-104.7835471	3.00						
10193.94	90.35	261.00	7010.41	2654.38	-141.03	-2651.35	40.4785185
-104.7837924	3.00						
10225.00	90.35	261.00	7010.23	2685.19	-145.89	-2682.03	40.4785052
-104.7839027	0.00						
10293.94	90.35	261.00	7009.81	2753.57	-156.67	-2750.12	40.4784755
-104.7841475	0.00						
10325.00	90.35	261.93	7009.62	2784.41	-161.28	-2780.83	40.4784629
-104.7842579	3.00						
10425.00	90.35	264.93	7009.02	2884.04	-172.72	-2880.17	40.4784315
-104.7846149	3.00						
10525.00	90.35	267.93	7008.41	2983.97	-178.94	-2979.96	40.4784143
-104.7849736	3.00						
10625.00	90.35	270.93	7007.80	3083.94	-179.93	-3079.94	40.4784116
-104.7853330	3.00						
10725.00	90.35	273.93	7007.20	3183.66	-175.69	-3179.84	40.4784232
-104.7856921	3.00						
10802.26	90.35	276.25	7006.73	3260.38	-168.83	-3256.79	40.4784420
-104.7859687	3.00						
10825.00	90.35	276.25	7006.59	3282.89	-166.36	-3279.39	40.4784488
-104.7860500	0.00						
10902.26	90.35	276.25	7006.13	3359.41	-157.95	-3356.19	40.4784718
-104.7863260	0.00						
10925.00	90.35	275.57	7005.99	3381.95	-155.61	-3378.81	40.4784782
-104.7864073	3.00						
11025.00	90.35	272.57	7005.39	3481.43	-148.51	-3478.54	40.4784977
-104.7867658	3.00						
11125.00	90.35	269.57	7004.79	3581.29	-146.65	-3578.51	40.4785028
-104.7871252	3.00						
11156.22	90.34	268.63	7004.60	3612.51	-147.14	-3609.73	40.4785014
-104.7872374	3.00						
11225.00	90.34	268.63	7004.19	3681.29	-148.78	-3678.49	40.4784969
-104.7874845	0.00						
11325.00	90.34	268.63	7003.59	3781.28	-151.17	-3778.46	40.4784903
-104.7878439	0.00						
11425.00	90.34	268.63	7002.99	3881.28	-153.56	-3878.43	40.4784837
-104.7882032	0.00						
11525.00	90.34	268.63	7002.39	3981.28	-155.95	-3978.40	40.4784771
-104.7885626	0.00						

DONN\_4N-20B-L\_PWP\_\_REV-B.0\_.las

11625.00	90.34	268.63	7001.78	4081.27	-158.34	-4078.37	40.4784705
-104.7889219	0.00						
11725.00	90.34	268.63	7001.18	4181.27	-160.73	-4178.33	40.4784639
-104.7892813	0.00						
11825.00	90.34	268.63	7000.58	4281.27	-163.12	-4278.30	40.4784573
-104.7896406	0.00						
11925.00	90.34	268.63	6999.98	4381.26	-165.50	-4378.27	40.4784506
-104.7900000	0.00						
12025.00	90.34	268.63	6999.38	4481.26	-167.89	-4478.24	40.4784440
-104.7903593	0.00						
12125.00	90.34	268.63	6998.78	4581.26	-170.28	-4578.21	40.4784374
-104.7907186	0.00						
12225.00	90.34	268.63	6998.18	4681.25	-172.67	-4678.18	40.4784308
-104.7910780	0.00						
12325.00	90.34	268.63	6997.58	4781.25	-175.06	-4778.15	40.4784242
-104.7914373	0.00						
12425.00	90.34	268.63	6996.98	4881.25	-177.45	-4878.12	40.4784176
-104.7917967	0.00						
12525.00	90.34	268.63	6996.38	4981.24	-179.84	-4978.09	40.4784110
-104.7921560	0.00						
12625.00	90.34	268.63	6995.78	5081.24	-182.23	-5078.06	40.4784044
-104.7925154	0.00						
12725.00	90.34	268.63	6995.18	5181.23	-184.61	-5178.03	40.4783978
-104.7928747	0.00						
12825.00	90.34	268.63	6994.58	5281.23	-187.00	-5278.00	40.4783912
-104.7932341	0.00						
12925.00	90.34	268.63	6993.98	5381.23	-189.39	-5377.97	40.4783845
-104.7935934	0.00						
13025.00	90.34	268.63	6993.38	5481.22	-191.78	-5477.94	40.4783779
-104.7939527	0.00						
13125.00	90.34	268.63	6992.78	5581.22	-194.17	-5577.91	40.4783713
-104.7943121	0.00						
13225.00	90.34	268.63	6992.18	5681.22	-196.56	-5677.88	40.4783647
-104.7946714	0.00						
13325.00	90.34	268.63	6991.57	5781.21	-198.95	-5777.85	40.4783581
-104.7950308	0.00						
13425.00	90.34	268.63	6990.97	5881.21	-201.34	-5877.82	40.4783514
-104.7953901	0.00						
13525.00	90.34	268.63	6990.37	5981.21	-203.72	-5977.79	40.4783448
-104.7957495	0.00						
13625.00	90.34	268.63	6989.77	6081.20	-206.11	-6077.76	40.4783382
-104.7961088	0.00						
13725.00	90.34	268.63	6989.17	6181.20	-208.50	-6177.73	40.4783316
-104.7964682	0.00						
13825.00	90.34	268.63	6988.57	6281.20	-210.89	-6277.70	40.4783249
-104.7968275	0.00						
13925.00	90.34	268.63	6987.97	6381.19	-213.28	-6377.67	40.4783183
-104.7971868	0.00						
14025.00	90.34	268.63	6987.37	6481.19	-215.67	-6477.64	40.4783117
-104.7975462	0.00						
14125.00	90.34	268.63	6986.77	6581.18	-218.06	-6577.61	40.4783051
-104.7979055	0.00						



DONN\_4N-20B-L\_PWP\_\_REV-B.0\_.las

14225.00	90.34	268.63	6986.17	6681.18	-220.45	-6677.58	40.4782984
-104.7982649	0.00						
14325.00	90.34	268.63	6985.57	6781.18	-222.83	-6777.55	40.4782918
-104.7986242	0.00						
14425.00	90.34	268.63	6984.97	6881.17	-225.22	-6877.52	40.4782852
-104.7989836	0.00						
14525.00	90.34	268.63	6984.37	6981.17	-227.61	-6977.49	40.4782785
-104.7993429	0.00						
14625.00	90.34	268.63	6983.77	7081.17	-230.00	-7077.45	40.4782719
-104.7997022	0.00						
14725.00	90.34	268.63	6983.17	7181.16	-232.39	-7177.42	40.4782653
-104.8000616	0.00						
14825.00	90.34	268.63	6982.57	7281.16	-234.78	-7277.39	40.4782586
-104.8004209	0.00						
14925.00	90.34	268.63	6981.97	7381.16	-237.17	-7377.36	40.4782520
-104.8007803	0.00						
15025.00	90.34	268.63	6981.36	7481.15	-239.56	-7477.33	40.4782453
-104.8011396	0.00						
15125.00	90.34	268.63	6980.76	7581.15	-241.95	-7577.30	40.4782387
-104.8014990	0.00						
15225.00	90.34	268.63	6980.16	7681.15	-244.33	-7677.27	40.4782321
-104.8018583	0.00						
15325.00	90.34	268.63	6979.56	7781.14	-246.72	-7777.24	40.4782254
-104.8022176	0.00						
15425.00	90.34	268.63	6978.96	7881.14	-249.11	-7877.21	40.4782188
-104.8025770	0.00						
15525.00	90.34	268.63	6978.36	7981.13	-251.50	-7977.18	40.4782121
-104.8029363	0.00						
15625.00	90.34	268.63	6977.76	8081.13	-253.89	-8077.15	40.4782055
-104.8032957	0.00						
15725.00	90.34	268.63	6977.16	8181.13	-256.28	-8177.12	40.4781988
-104.8036550	0.00						
15825.00	90.34	268.63	6976.56	8281.12	-258.67	-8277.09	40.4781922
-104.8040144	0.00						
15925.00	90.34	268.63	6975.96	8381.12	-261.06	-8377.06	40.4781855
-104.8043737	0.00						
16025.00	90.34	268.63	6975.36	8481.12	-263.44	-8477.03	40.4781789
-104.8047330	0.00						
16125.00	90.34	268.63	6974.76	8581.11	-265.83	-8577.00	40.4781722
-104.8050924	0.00						
16225.00	90.34	268.63	6974.16	8681.11	-268.22	-8676.97	40.4781656
-104.8054517	0.00						
16325.00	90.34	268.63	6973.56	8781.11	-270.61	-8776.94	40.4781589
-104.8058111	0.00						
16425.00	90.34	268.63	6972.96	8881.10	-273.00	-8876.91	40.4781523
-104.8061704	0.00						
16525.00	90.34	268.63	6972.36	8981.10	-275.39	-8976.88	40.4781456
-104.8065298	0.00						
16625.00	90.34	268.63	6971.76	9081.09	-277.78	-9076.85	40.4781390
-104.8068891	0.00						
16725.00	90.34	268.63	6971.15	9181.09	-280.17	-9176.82	40.4781323
-104.8072484	0.00						

DONN\_4N-20B-L\_PWP\_\_REV-B.0\_.las

16825.00	90.34	268.63	6970.55	9281.09	-282.55	-9276.79	40.4781256
-104.8076078	0.00						
16925.00	90.34	268.63	6969.95	9381.08	-284.94	-9376.76	40.4781190
-104.8079671	0.00						
17025.00	90.34	268.63	6969.35	9481.08	-287.33	-9476.73	40.4781123
-104.8083265	0.00						
17125.00	90.34	268.63	6968.75	9581.08	-289.72	-9576.70	40.4781057
-104.8086858	0.00						
17225.00	90.34	268.63	6968.15	9681.07	-292.11	-9676.67	40.4780990
-104.8090451	0.00						
17325.00	90.34	268.63	6967.55	9781.07	-294.50	-9776.64	40.4780923
-104.8094045	0.00						
17425.00	90.34	268.63	6966.95	9881.07	-296.89	-9876.61	40.4780857
-104.8097638	0.00						
17525.00	90.34	268.63	6966.35	9981.06	-299.28	-9976.58	40.4780790
-104.8101232	0.00						
17625.00	90.34	268.63	6965.75	10081.06	-301.66	-10076.54	40.4780723
-104.8104825	0.00						
17725.00	90.34	268.63	6965.15	10181.06	-304.05	-10176.51	40.4780657
-104.8108419	0.00						
17749.81	90.34	268.63	6965.00	10205.86	-304.65	-10201.32	40.4780640
-104.8109310	0.00						

# Planned Wellpath Report

DONN 4N-20B-L PWP (REV-B.0)

Page 1 of 6



## REFERENCE WELLPATH IDENTIFICATION

Operator	SRC ENERGY	Slot	SLOT#17 DONN 4N-20B-L (818'FNL & 251'FEL, SEC.21)
Area	COLORADO	Well	DONN 4N-20B-L
Field	WELD COUNTY (NAD83,TRUE NORTH)	Wellbore	DONN 4N-20B-L PWB
Facility	SEC.21-T06N-R66W		

## REPORT SETUP INFORMATION

Projection System	NAD83 / Lambert Colorado SP, Northern Zone (501), US feet	Software System	WellArchitect® 5.1
North Reference	True	User	Doddanna
Scale	0.999965	Report Generated	8/25/2017 at 10:55:21 AM
Convergence at slot	0.47° East	Database/Source file	Denver DB/DONN_4N-20B-L_PWP__REV-B.0_.xml

## WELLPATH LOCATION

	Local coordinates		Grid coordinates		Geographic coordinates	
	North[ft]	East[ft]	Easting[US ft]	Northing[US ft]	Latitude	Longitude
Slot Location	983.62	24.48	3201888.03	1418132.01	40°28'44.062"N	104°46'27.343"W
Facility Reference Pt			3201871.60	1417148.27	40°28'34.342"N	104°46'27.660"W
Field Reference Pt			3171284.48	1426358.81	40°30'07.643"N	104°53'02.634"W

## WELLPATH DATUM

Calculation method	Minimum curvature	PRECISION DRILLING (25') (RKB) to Facility Vertical Datum	4777.00ft
Horizontal Reference Pt	Slot	PRECISION DRILLING (25') (RKB) to Mean Sea Level	4777.00ft
Vertical Reference Pt	PRECISION DRILLING (25') (RKB)	PRECISION DRILLING (25') (RKB) to Mud Line at Slot (SLOT#17 DONN 4N-20B-L (818'FNL & 251'FEL, SEC.21))	4777.00ft
MD Reference Pt	PRECISION DRILLING (25') (RKB)	Section Origin	N 0.00, E 0.00 ft
Field Vertical Reference	Mean Sea Level	Section Azimuth	268.29°

# Planned Wellpath Report

DONN 4N-20B-L PWP (REV-B.0)

Page 2 of 6



## REFERENCE WELLPATH IDENTIFICATION

Operator	SRC ENERGY	Slot	SLOT#17 DONN 4N-20B-L (818'FNL & 251'FEL, SEC.21)
Area	COLORADO	Well	DONN 4N-20B-L
Field	WELD COUNTY (NAD83,TRUE NORTH)	Wellbore	DONN 4N-20B-L PWB
Facility	SEC.21-T06N-R66W		

## WELLPATH DATA (190 stations) † = interpolated/extrapolated station

MD [ft]	Inclination [°]	Azimuth [°]	TVD [ft]	Vert Sect [ft]	North [ft]	East [ft]	DLS [°/100ft]	Comments
0.00†	0.000	92.841	0.00	0.00	0.00	0.00	0.00	
25.00	0.000	92.841	25.00	0.00	0.00	0.00	0.00	Tie On
125.00†	0.000	92.841	125.00	0.00	0.00	0.00	0.00	
200.00	0.000	92.841	200.00	0.00	0.00	0.00	0.00	End of Tangent
225.00†	0.500	92.841	225.00	-0.11	-0.01	0.11	2.00	
325.00†	2.500	92.841	324.96	-2.72	-0.14	2.72	2.00	
425.00†	4.500	92.841	424.77	-8.80	-0.44	8.82	2.00	
525.00†	6.500	92.841	524.30	-18.36	-0.91	18.39	2.00	
554.02	7.080	92.841	553.12	-21.78	-1.08	21.82	2.00	End of Build
625.00†	7.080	92.841	623.56	-30.50	-1.52	30.56	0.00	
725.00†	7.080	92.841	722.80	-42.79	-2.13	42.87	0.00	
825.00†	7.080	92.841	822.03	-55.07	-2.74	55.18	0.00	
925.00†	7.080	92.841	921.27	-67.36	-3.35	67.49	0.00	
1025.00†	7.080	92.841	1020.51	-79.65	-3.96	79.80	0.00	
1125.00†	7.080	92.841	1119.75	-91.94	-4.57	92.11	0.00	
1225.00†	7.080	92.841	1218.98	-104.22	-5.18	104.42	0.00	
1325.00†	7.080	92.841	1318.22	-116.51	-5.79	116.74	0.00	
1425.00†	7.080	92.841	1417.46	-128.80	-6.40	129.05	0.00	
1525.00†	7.080	92.841	1516.70	-141.09	-7.01	141.36	0.00	
1625.00†	7.080	92.841	1615.93	-153.37	-7.63	153.67	0.00	
1725.00†	7.080	92.841	1715.17	-165.66	-8.24	165.98	0.00	
1825.00†	7.080	92.841	1814.41	-177.95	-8.85	178.29	0.00	
1925.00†	7.080	92.841	1913.64	-190.24	-9.46	190.60	0.00	
2025.00†	7.080	92.841	2012.88	-202.52	-10.07	202.91	0.00	
2125.00†	7.080	92.841	2112.12	-214.81	-10.68	215.23	0.00	
2225.00†	7.080	92.841	2211.36	-227.10	-11.29	227.54	0.00	
2325.00†	7.080	92.841	2310.59	-239.39	-11.90	239.85	0.00	
2425.00†	7.080	92.841	2409.83	-251.67	-12.51	252.16	0.00	
2525.00†	7.080	92.841	2509.07	-263.96	-13.12	264.47	0.00	
2625.00†	7.080	92.841	2608.31	-276.25	-13.73	276.78	0.00	
2725.00†	7.080	92.841	2707.54	-288.53	-14.35	289.09	0.00	
2825.00†	7.080	92.841	2806.78	-300.82	-14.96	301.40	0.00	
2925.00†	7.080	92.841	2906.02	-313.11	-15.57	313.71	0.00	
3025.00†	7.080	92.841	3005.26	-325.40	-16.18	326.03	0.00	
3125.00†	7.080	92.841	3104.49	-337.68	-16.79	338.34	0.00	
3225.00†	7.080	92.841	3203.73	-349.97	-17.40	350.65	0.00	
3325.00†	7.080	92.841	3302.97	-362.26	-18.01	362.96	0.00	
3425.00†	7.080	92.841	3402.21	-374.55	-18.62	375.27	0.00	
3525.00†	7.080	92.841	3501.44	-386.83	-19.23	387.58	0.00	
3625.00†	7.080	92.841	3600.68	-399.12	-19.84	399.89	0.00	
3725.00†	7.080	92.841	3699.92	-411.41	-20.45	412.20	0.00	
3825.00†	7.080	92.841	3799.16	-423.70	-21.07	424.51	0.00	
3925.00†	7.080	92.841	3898.39	-435.98	-21.68	436.83	0.00	
4025.00†	7.080	92.841	3997.63	-448.27	-22.29	449.14	0.00	
4125.00†	7.080	92.841	4096.87	-460.56	-22.90	461.45	0.00	

# Planned Wellpath Report

DONN 4N-20B-L PWP (REV-B.0)

Page 3 of 6



## REFERENCE WELLPATH IDENTIFICATION

Operator	SRC ENERGY	Slot	SLOT#17 DONN 4N-20B-L (818'FNL & 251'FEL, SEC.21)
Area	COLORADO	Well	DONN 4N-20B-L
Field	WELD COUNTY (NAD83,TRUE NORTH)	Wellbore	DONN 4N-20B-L PWB
Facility	SEC.21-T06N-R66W		

## WELLPATH DATA (190 stations) † = interpolated/extrapolated station

MD [ft]	Inclination [°]	Azimuth [°]	TVD [ft]	Vert Sect [ft]	North [ft]	East [ft]	DLS [°/100ft]	Comments
4225.00†	7.080	92.841	4196.10	-472.85	-23.51	473.76	0.00	
4325.00†	7.080	92.841	4295.34	-485.13	-24.12	486.07	0.00	
4425.00†	7.080	92.841	4394.58	-497.42	-24.73	498.38	0.00	
4525.00†	7.080	92.841	4493.82	-509.71	-25.34	510.69	0.00	
4625.00†	7.080	92.841	4593.05	-522.00	-25.95	523.00	0.00	
4725.00†	7.080	92.841	4692.29	-534.28	-26.56	535.31	0.00	
4825.00†	7.080	92.841	4791.53	-546.57	-27.17	547.63	0.00	
4925.00†	7.080	92.841	4890.77	-558.86	-27.79	559.94	0.00	
5025.00†	7.080	92.841	4990.00	-571.15	-28.40	572.25	0.00	
5125.00†	7.080	92.841	5089.24	-583.43	-29.01	584.56	0.00	
5225.00†	7.080	92.841	5188.48	-595.72	-29.62	596.87	0.00	
5325.00†	7.080	92.841	5287.72	-608.01	-30.23	609.18	0.00	
5425.00†	7.080	92.841	5386.95	-620.29	-30.84	621.49	0.00	
5525.00†	7.080	92.841	5486.19	-632.58	-31.45	633.80	0.00	
5625.00†	7.080	92.841	5585.43	-644.87	-32.06	646.11	0.00	
5725.00†	7.080	92.841	5684.67	-657.16	-32.67	658.43	0.00	
5825.00†	7.080	92.841	5783.90	-669.44	-33.28	670.74	0.00	
5925.00†	7.080	92.841	5883.14	-681.73	-33.89	683.05	0.00	
6025.00†	7.080	92.841	5982.38	-694.02	-34.51	695.36	0.00	
6125.00†	7.080	92.841	6081.62	-706.31	-35.12	707.67	0.00	
6225.00†	7.080	92.841	6180.85	-718.59	-35.73	719.98	0.00	
6325.00†	7.080	92.841	6280.09	-730.88	-36.34	732.29	0.00	
6357.32	7.080	92.841	6312.16	-734.85	-36.54	736.27	0.00	End of Tangent
6425.00†	1.102	116.958	6379.64	-739.59	-37.04	741.02	9.00	
6525.00†	8.047	264.925	6479.35	-733.43	-38.10	734.89	9.00	
6625.00†	17.038	266.920	6576.86	-711.75	-39.50	713.25	9.00	
6725.00†	26.035	267.556	6669.78	-675.09	-41.23	676.62	9.00	
6825.00†	35.034	267.881	6755.83	-624.34	-43.23	625.91	9.00	
6925.00†	44.033	268.086	6832.87	-560.75	-45.46	562.36	9.00	
7025.00†	53.032	268.233	6899.03	-485.89	-47.86	487.54	9.00	
7125.00†	62.031	268.349	6952.65	-401.61	-50.37	403.29	9.00	
7225.00†	71.031	268.447	6992.44	-309.98	-52.92	311.70	9.00	
7325.00†	80.031	268.535	7017.40	-213.25	-55.47	215.00	9.00	
7425.00†	89.030	268.618	7026.92	-113.81	-57.94	115.59	9.00	
7439.61	90.345	268.630	7027.00†	-99.20	-58.29	100.99	9.00	End of 3D Arc
7525.00†	90.345	268.630	7026.49	-13.81	-60.33	15.62	0.00	
7625.00†	90.345	268.630	7025.88	86.18	-62.72	-84.35	0.00	
7725.00†	90.345	268.630	7025.28	186.18	-65.11	-184.32	0.00	
7825.00†	90.345	268.630	7024.68	286.18	-67.50	-284.29	0.00	
7925.00†	90.345	268.630	7024.08	386.17	-69.90	-384.26	0.00	
8025.00†	90.345	268.630	7023.48	486.17	-72.29	-484.23	0.00	
8125.00†	90.345	268.630	7022.87	586.17	-74.68	-584.20	0.00	
8225.00†	90.345	268.630	7022.27	686.16	-77.07	-684.17	0.00	
8325.00†	90.345	268.630	7021.67	786.16	-79.46	-784.14	0.00	
8425.00†	90.345	268.630	7021.07	886.15	-81.85	-884.11	0.00	

# Planned Wellpath Report

DONN 4N-20B-L PWP (REV-B.0)

Page 4 of 6



## REFERENCE WELLPATH IDENTIFICATION

Operator	SRC ENERGY	Slot	SLOT#17 DONN 4N-20B-L (818'FNL & 251'FEL, SEC.21)
Area	COLORADO	Well	DONN 4N-20B-L
Field	WELD COUNTY (NAD83,TRUE NORTH)	Wellbore	DONN 4N-20B-L PWB
Facility	SEC.21-T06N-R66W		

## WELLPATH DATA (190 stations) † = interpolated/extrapolated station

MD [ft]	Inclination [°]	Azimuth [°]	TVD [ft]	Vert Sect [ft]	North [ft]	East [ft]	DLS [°/100ft]	Comments
8525.00†	90.345	268.630	7020.46	986.15	-84.24	-984.08	0.00	
8625.00†	90.345	268.630	7019.86	1086.15	-86.63	-1084.04	0.00	
8725.00†	90.345	268.630	7019.26	1186.14	-89.02	-1184.01	0.00	
8825.00†	90.345	268.630	7018.66	1286.14	-91.41	-1283.98	0.00	
8925.00†	90.345	268.630	7018.06	1386.14	-93.80	-1383.95	0.00	
9025.00†	90.345	268.630	7017.45	1486.13	-96.19	-1483.92	0.00	
9125.00†	90.345	268.630	7016.85	1586.13	-98.59	-1583.89	0.00	
9225.00†	90.345	268.630	7016.25	1686.13	-100.98	-1683.86	0.00	
9325.00†	90.345	268.630	7015.65	1786.12	-103.37	-1783.83	0.00	
9425.00†	90.345	268.630	7015.05	1886.12	-105.76	-1883.80	0.00	
9525.00†	90.345	268.630	7014.44	1986.12	-108.15	-1983.77	0.00	
9625.00†	90.345	268.630	7013.84	2086.11	-110.54	-2083.74	0.00	
9725.00†	90.345	268.630	7013.24	2186.11	-112.93	-2183.71	0.00	
9825.00†	90.345	268.630	7012.64	2286.10	-115.32	-2283.68	0.00	
9925.00†	90.345	268.630	7012.03	2386.10	-117.71	-2383.65	0.00	
9939.61	90.345	268.630	7011.95	2400.71	-118.06	-2398.25	0.00	End of Tangent
10025.00†	90.346	266.068	7011.43	2486.08	-122.01	-2483.54	3.00	
10125.00†	90.346	263.068	7010.83	2585.86	-131.48	-2583.08	3.00	
10193.94	90.345	261.000	7010.41	2654.38	-141.03	-2651.35	3.00	End of 3D Arc
10225.00†	90.345	261.000	7010.23	2685.19	-145.89	-2682.03	0.00	
10293.94	90.345	261.000	7009.81	2753.57	-156.67	-2750.12	0.00	End of Tangent
10325.00†	90.346	261.932	7009.62	2784.41	-161.28	-2780.83	3.00	
10425.00†	90.347	264.932	7009.02	2884.04	-172.72	-2880.17	3.00	
10525.00†	90.348	267.932	7008.41	2983.97	-178.94	-2979.96	3.00	
10625.00†	90.348	270.932	7007.80	3083.94	-179.93	-3079.94	3.00	
10725.00†	90.347	273.932	7007.20	3183.66	-175.69	-3179.84	3.00	
10802.26	90.345	276.250	7006.73	3260.38	-168.83	-3256.79	3.00	End of 3D Arc
10825.00†	90.345	276.250	7006.59	3282.89	-166.36	-3279.39	0.00	
10902.26	90.345	276.250	7006.13	3359.41	-157.95	-3356.19	0.00	End of Tangent
10925.00†	90.345	275.568	7005.99	3381.95	-155.61	-3378.81	3.00	
11025.00†	90.345	272.568	7005.39	3481.43	-148.51	-3478.54	3.00	
11125.00†	90.345	269.568	7004.79	3581.29	-146.65	-3578.51	3.00	
11156.22	90.344	268.631	7004.60	3612.51	-147.14	-3609.73	3.00	End of 3D Arc
11225.00†	90.344	268.631	7004.19	3681.29	-148.78	-3678.49	0.00	
11325.00†	90.344	268.631	7003.59	3781.28	-151.17	-3778.46	0.00	
11425.00†	90.344	268.631	7002.99	3881.28	-153.56	-3878.43	0.00	
11525.00†	90.344	268.631	7002.39	3981.28	-155.95	-3978.40	0.00	
11625.00†	90.344	268.631	7001.78	4081.27	-158.34	-4078.37	0.00	
11725.00†	90.344	268.631	7001.18	4181.27	-160.73	-4178.33	0.00	
11825.00†	90.344	268.631	7000.58	4281.27	-163.12	-4278.30	0.00	
11925.00†	90.344	268.631	6999.98	4381.26	-165.50	-4378.27	0.00	
12025.00†	90.344	268.631	6999.38	4481.26	-167.89	-4478.24	0.00	
12125.00†	90.344	268.631	6998.78	4581.26	-170.28	-4578.21	0.00	
12225.00†	90.344	268.631	6998.18	4681.25	-172.67	-4678.18	0.00	
12325.00†	90.344	268.631	6997.58	4781.25	-175.06	-4778.15	0.00	

# Planned Wellpath Report

DONN 4N-20B-L PWP (REV-B.0)

Page 5 of 6



## REFERENCE WELLPATH IDENTIFICATION

Operator	SRC ENERGY	Slot	SLOT#17 DONN 4N-20B-L (818'FNL & 251'FEL, SEC.21)
Area	COLORADO	Well	DONN 4N-20B-L
Field	WELD COUNTY (NAD83,TRUE NORTH)	Wellbore	DONN 4N-20B-L PWB
Facility	SEC.21-T06N-R66W		

## WELLPATH DATA (190 stations) † = interpolated/extrapolated station

MD [ft]	Inclination [°]	Azimuth [°]	TVD [ft]	Vert Sect [ft]	North [ft]	East [ft]	DLS [°/100ft]	Comments
12425.00†	90.344	268.631	6996.98	4881.25	-177.45	-4878.12	0.00	
12525.00†	90.344	268.631	6996.38	4981.24	-179.84	-4978.09	0.00	
12625.00†	90.344	268.631	6995.78	5081.24	-182.23	-5078.06	0.00	
12725.00†	90.344	268.631	6995.18	5181.23	-184.61	-5178.03	0.00	
12825.00†	90.344	268.631	6994.58	5281.23	-187.00	-5278.00	0.00	
12925.00†	90.344	268.631	6993.98	5381.23	-189.39	-5377.97	0.00	
13025.00†	90.344	268.631	6993.38	5481.22	-191.78	-5477.94	0.00	
13125.00†	90.344	268.631	6992.78	5581.22	-194.17	-5577.91	0.00	
13225.00†	90.344	268.631	6992.18	5681.22	-196.56	-5677.88	0.00	
13325.00†	90.344	268.631	6991.57	5781.21	-198.95	-5777.85	0.00	
13425.00†	90.344	268.631	6990.97	5881.21	-201.34	-5877.82	0.00	
13525.00†	90.344	268.631	6990.37	5981.21	-203.72	-5977.79	0.00	
13625.00†	90.344	268.631	6989.77	6081.20	-206.11	-6077.76	0.00	
13725.00†	90.344	268.631	6989.17	6181.20	-208.50	-6177.73	0.00	
13825.00†	90.344	268.631	6988.57	6281.20	-210.89	-6277.70	0.00	
13925.00†	90.344	268.631	6987.97	6381.19	-213.28	-6377.67	0.00	
14025.00†	90.344	268.631	6987.37	6481.19	-215.67	-6477.64	0.00	
14125.00†	90.344	268.631	6986.77	6581.18	-218.06	-6577.61	0.00	
14225.00†	90.344	268.631	6986.17	6681.18	-220.45	-6677.58	0.00	
14325.00†	90.344	268.631	6985.57	6781.18	-222.83	-6777.55	0.00	
14425.00†	90.344	268.631	6984.97	6881.17	-225.22	-6877.52	0.00	
14525.00†	90.344	268.631	6984.37	6981.17	-227.61	-6977.49	0.00	
14625.00†	90.344	268.631	6983.77	7081.17	-230.00	-7077.45	0.00	
14725.00†	90.344	268.631	6983.17	7181.16	-232.39	-7177.42	0.00	
14825.00†	90.344	268.631	6982.57	7281.16	-234.78	-7277.39	0.00	
14925.00†	90.344	268.631	6981.97	7381.16	-237.17	-7377.36	0.00	
15025.00†	90.344	268.631	6981.36	7481.15	-239.56	-7477.33	0.00	
15125.00†	90.344	268.631	6980.76	7581.15	-241.95	-7577.30	0.00	
15225.00†	90.344	268.631	6980.16	7681.15	-244.33	-7677.27	0.00	
15325.00†	90.344	268.631	6979.56	7781.14	-246.72	-7777.24	0.00	
15425.00†	90.344	268.631	6978.96	7881.14	-249.11	-7877.21	0.00	
15525.00†	90.344	268.631	6978.36	7981.13	-251.50	-7977.18	0.00	
15625.00†	90.344	268.631	6977.76	8081.13	-253.89	-8077.15	0.00	
15725.00†	90.344	268.631	6977.16	8181.13	-256.28	-8177.12	0.00	
15825.00†	90.344	268.631	6976.56	8281.12	-258.67	-8277.09	0.00	
15925.00†	90.344	268.631	6975.96	8381.12	-261.06	-8377.06	0.00	
16025.00†	90.344	268.631	6975.36	8481.12	-263.44	-8477.03	0.00	
16125.00†	90.344	268.631	6974.76	8581.11	-265.83	-8577.00	0.00	
16225.00†	90.344	268.631	6974.16	8681.11	-268.22	-8676.97	0.00	
16325.00†	90.344	268.631	6973.56	8781.11	-270.61	-8776.94	0.00	
16425.00†	90.344	268.631	6972.96	8881.10	-273.00	-8876.91	0.00	
16525.00†	90.344	268.631	6972.36	8981.10	-275.39	-8976.88	0.00	
16625.00†	90.344	268.631	6971.76	9081.09	-277.78	-9076.85	0.00	
16725.00†	90.344	268.631	6971.15	9181.09	-280.17	-9176.82	0.00	
16825.00†	90.344	268.631	6970.55	9281.09	-282.55	-9276.79	0.00	



# Planned Wellpath Report

DONN 4N-20B-L PWP (REV-B.0)

Page 6 of 6



## REFERENCE WELLPATH IDENTIFICATION

Operator	SRC ENERGY	Slot	SLOT#17 DONN 4N-20B-L (818'FNL & 251'FEL, SEC.21)
Area	COLORADO	Well	DONN 4N-20B-L
Field	WELD COUNTY (NAD83, TRUE NORTH)	Wellbore	DONN 4N-20B-L PWB
Facility	SEC.21-T06N-R66W		

## WELLPATH DATA (190 stations) † = interpolated/extrapolated station

MD [ft]	Inclination [°]	Azimuth [°]	TVD [ft]	Vert Sect [ft]	North [ft]	East [ft]	DLS [°/100ft]	Comments
16925.00†	90.344	268.631	6969.95	9381.08	-284.94	-9376.76	0.00	
17025.00†	90.344	268.631	6969.35	9481.08	-287.33	-9476.73	0.00	
17125.00†	90.344	268.631	6968.75	9581.08	-289.72	-9576.70	0.00	
17225.00†	90.344	268.631	6968.15	9681.07	-292.11	-9676.67	0.00	
17325.00†	90.344	268.631	6967.55	9781.07	-294.50	-9776.64	0.00	
17425.00†	90.344	268.631	6966.95	9881.07	-296.89	-9876.61	0.00	
17525.00†	90.344	268.631	6966.35	9981.06	-299.28	-9976.58	0.00	
17625.00†	90.344	268.631	6965.75	10081.06	-301.66	-10076.54	0.00	
17725.00†	90.344	268.631	6965.15	10181.06	-304.05	-10176.51	0.00	
17749.81	90.344	268.631	6965.00 <sup>2</sup>	10205.86	-304.65	-10201.32	0.00	End of Tangent

## HOLE & CASING SECTIONS

- Ref Wellbore: DONN 4N-20B-L PWB Ref Wellpath: DONN 4N-20B-L PWP (REV-B.0)

String/Diameter	Start MD [ft]	End MD [ft]	Interval [ft]	Start TVD [ft]	End TVD [ft]	Start N/S [ft]	Start E/W [ft]	End N/S [ft]	End E/W [ft]
13.5in Open Hole	25.00	1750.00	1725.00	25.00	1739.98	0.00	0.00	-8.39	169.06
9.625in Casing Surface	25.00	1750.00	1725.00	25.00	1739.98	0.00	0.00	-8.39	169.06
8.5in Open Hole	1750.00	17749.81	15999.81	1739.98	6965.00	-8.39	169.06	-304.65	-10201.32

## TARGETS

Name	MD [ft]	TVD [ft]	North [ft]	East [ft]	Grid East [US ft]	Grid North [US ft]	Latitude	Longitude	Shape
SEC.20-T06N-R66W		-1.00	80.15	0.56	3201887.93	1418212.16	40°28'44.854"N	104°46'27.336"W	polygon
SEC.21-T06N-R66W		39.00	-3802.65	-6166.08	3195753.51	1414279.17	40°28'06.478"N	104°47'47.123"W	polygon
2) DONN N-20B-L BHL ON PLAT (931'FNL & 150'FWL, SEC.20)	17749.81	6965.00	-304.65	-10201.32	3191689.93	1417743.90	40°28'41.030"N	104°48'39.352"W	circle
1) DONN 4N-20B-L TOP OF PROD ON PLAT (879'FNL & 150'FEL, SEC.21)	7439.61	7027.00	-58.29	100.99	3201989.49	1418074.55	40°28'43.486"N	104°46'26.036"W	circle

## SURVEY PROGRAM - Ref Wellbore: DONN 4N-20B-L PWB Ref Wellpath: DONN 4N-20B-L PWP (REV-B.0)

Start MD [ft]	End MD [ft]	Positional Uncertainty Model	Log Name/Comment	Wellbore
25.00	1750.00	Custom BHI NaviTrak (Standard Rotating+Axial Corr) (Rockies 0.03Gt model)		DONN 4N-20B-L PWB
1750.00	17749.81	Custom BHI AutoTrak Curve (IFR1, Short) (Rockies 0.03Gt model)		DONN 4N-20B-L PWB