

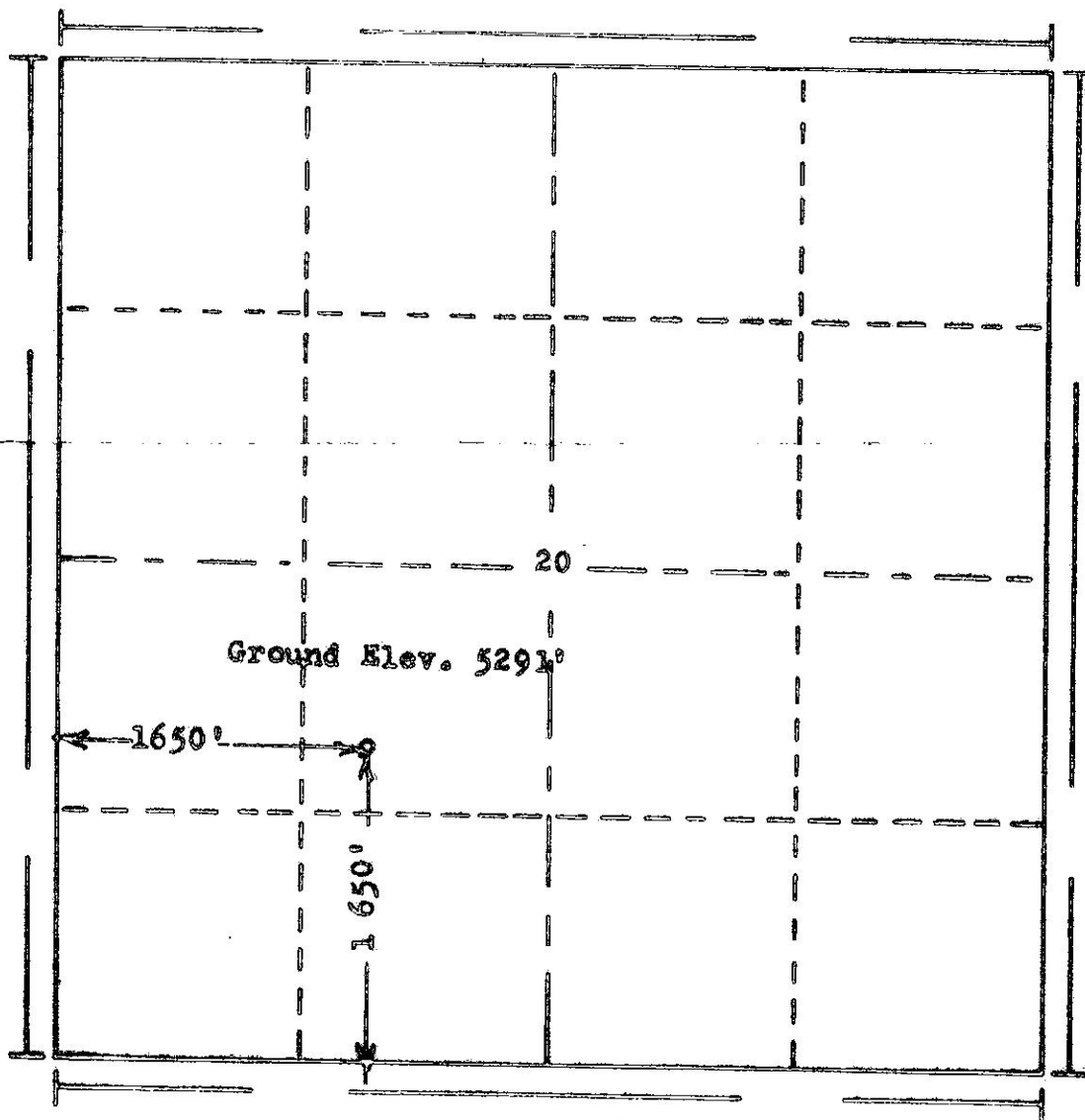

00370335

R. 65W



Scale... 1" = 1000'

Powers Elevation Company, Inc. of Denver, Colorado  
 has in accordance with a request from Mr. Romack  
 for Koch Exploration Co.  
 determined the location of No. 2 Box Elder "E"  
 to be CSW NE SW Section 20 Township 2S  
 Range 65W of the 6th Principal Meridian  
 Adams County, Colorado

I hereby certify that this plat is an  
 accurate representation of a correct  
 survey showing the location of

Date: 3-2-73

Edw. J. Hume  
 Licensed Land Surveyor No. 2853  
 State of Colorado