

HERGERT 35-L PAD
HYDROLOGY MAP

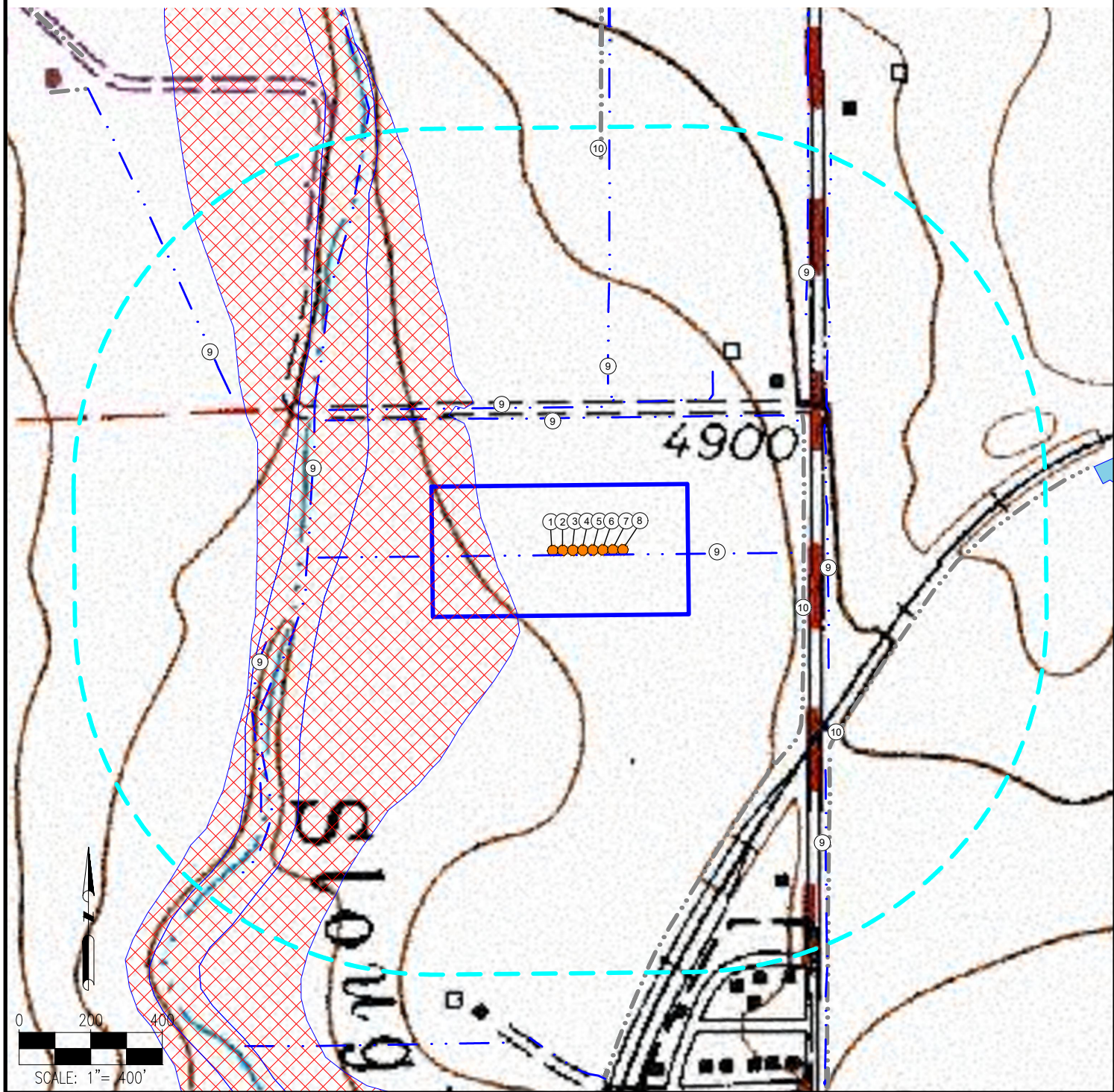

MEASUREMENTS ARE MADE FROM THE NEAREST EDGE OF THE DISTURBANCE AREA.

- | | |
|----------------------------|----------------------------------------------------------------------------------------------|
| 1. HERGERT SOUTH 35W-15-1C | 7. HERGERT SOUTH 35W-15-10N |
| 2. HERGERT SOUTH 35W-15-2N | 8. HERGERT SOUTH 35W-15-11N |
| 3. HERGERT SOUTH 35W-15-4N | 9. DITCHES ARE $\pm 0'$, $\pm 189'$ N, $\pm 218'$ N, $\pm 230'$ N, $\pm 334'$ W, $\pm 602'$ |
| 4. HERGERT SOUTH 35W-15-5N | NW, $\pm 469'$ SW, $\pm 386'$ E, $\pm 557'$ NE, $\pm 579'$ SE |
| 5. HERGERT SOUTH 35W-15-7C | 10. CONCRETE DITCHES ARE $\pm 321'$ E, $\pm 529'$ SE, $\pm 915'$ N |
| 6. HERGERT SOUTH 35W-15-8N | |

LEGEND:

- | | | |
|------------------|--------------|--------------------|
| = PROPOSED WELL | = POND | = DISTURBANCE AREA |
| = DITCH | = FLOODPLAIN | = 1000' RADIUS |
| = CONCRETE DITCH | | |

DISCLAIMER:
THIS PLOT DOES NOT REPRESENT A MONUMENTED LAND SURVEY AND SHOULD NOT BE RELIED UPON TO DETERMINE BOUNDARY LINES, PROPERTY OWNERSHIP OR OTHER PROPERTY INTERESTS. PARCEL LINES, IF DEPICTED HAVE NOT BEEN FIELD VERIFIED AND MAY BE BASED UPON PUBLICLY AVAILABLE DATA THAT ALSO HAS NOT BEEN INDEPENDENTLY VERIFIED.

DATA SOURCE:
TOPO MAP: USGS
NHD: USGS

PUBLICLY AVAILABLE DATA SOURCES HAVE NOT BEEN INDEPENDENTLY VERIFIED BY ASCENT.



7535 Hilltop Circle
Denver, CO 80221
(303) 928-7128
www.ascentgeomatics.com

FIELD DATE:
06-29-17

DRAWING DATE:
08-15-17

BY:
CSG

CHECKED:
DJP

SITE NAME:
HERGERT 35-L PAD

SURFACE LOCATION:

NE 1/4 SE 1/4 SEC. 35, T7N, R67W, 6TH P.M.
WELD COUNTY, COLORADO

PREPARED FOR:

