



---

August 31, 2017

Mr. Matthew Lepore, Director  
Colorado Oil & Gas Conservation Commission  
1120 Lincoln Street, Ste. 801  
Denver, Colorado 80203

RE: Rule 318.A.e.  
Jesser 3E-10-15N  
Jesser 3E-10-16N  
Jesser 3E-10-17C

Surface Location: NWSW, Section 3, Township 4 North, Range 68 West, Weld County, Colorado

Dear Mr. Lepore,

Extraction Oil and Gas is planning to drill the captioned horizontal wells in accordance with the provision of COGCC Rule 318A.e.

The proposed wellbore spacing unit consists of:

Sec. 3-4N-68W: S/2S/2  
Sec. 10-4N-68W: N/2N/2

The spacing unit is a 320-acre wellbore spacing unit for the Niobrara and Codell formations.

Extraction Oil and Gas hereby certifies to the Director that all Owners within the proposed spacing unit above were notified and 30 days have passed without objection.

If you have any questions or issues regarding this permit, please contact Alyssa Andrews at (720) 481-2379.

Sincerely,

Alyssa Andrews  
Regulatory Analyst  
Extraction Oil & Gas, Inc.

**JESSER 3-I PAD**  
**PROPOSED 318A.a.(4)D. SPACING UNIT**  
**SEC 3: S2S2**  
**SEC 10: N2N2**

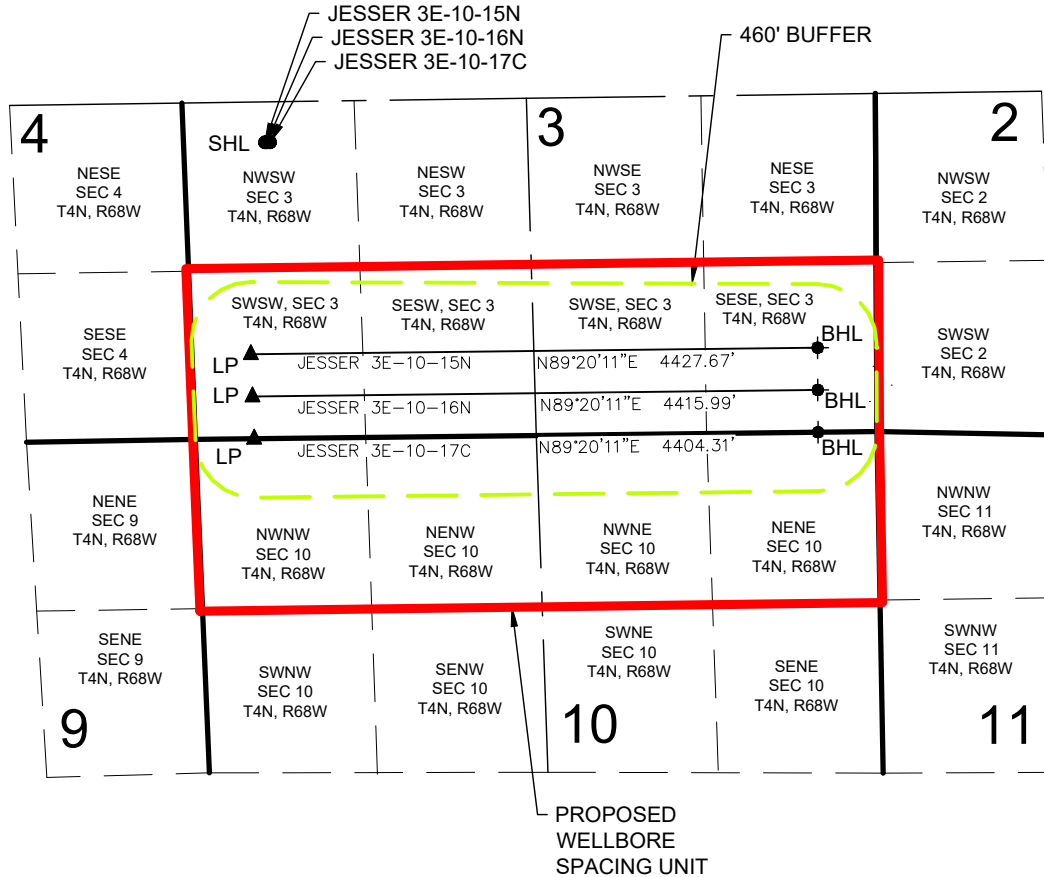

**JESSER 3E-10-15N WELL TO BE LOCATED 2314' FSL AND 636' FWL, SEC 3, T4N, R68W**  
**JESSER 3E-10-16N WELL TO BE LOCATED 2315' FSL AND 656' FWL, SEC 3, T4N, R68W**  
**JESSER 3E-10-17C WELL TO BE LOCATED 2315' FSL AND 676' FWL, SEC 3, T4N, R68W**

**LEGEND**

● = PROPOSED WELL  
 ● = BOTTOM HOLE  
 ▲ = LANDING POINT

SHL = SURFACE HOLE LOCATION  
 BHL = BOTTOM HOLE LOCATION  
 LP = LANDING POINT

DISCLAIMER:  
 THIS PLOT DOES NOT REPRESENT A MONUMENTED LAND SURVEY AND SHOULD NOT BE  
 RELIED UPON TO DETERMINE BOUNDARY LINES, PROPERTY OWNERSHIP OR OTHER  
 PROPERTY INTERESTS. PARCEL LINES, IF DEPICTED HAVE NOT BEEN FIELD VERIFIED AND  
 MAY BE BASED UPON PUBLICLY AVAILABLE DATA THAT ALSO HAS NOT BEEN  
 INDEPENDENTLY VERIFIED.

