

LEGEND:

- └─ = 90° SYMBOL  
● = PROPOSED WELLHEAD.  
◆ = LANDING POINT.  
◻ = BOTTOM OF COMPLETED INTERVAL.  
○ = TARGET BOTTOM HOLE TD.  
▲ = SECTION CORNERS LOCATED. (NAD 83)

T4N, R62W, 6th P.M.

BILL BARRETT CORPORATION

ANSCHUTZ EQUUS FARMS 4-62-28\_27 SWSW PAD  
#4-62-28-6457CB  
SW 1/4 SW 1/4, SECTION 28, T4N, R62W, 6th P.M.  
WELD COUNTY, COLORADO

2011 Alum. Cap,  
0.3' High  
Lat: 40.289986°  
Long: 104.338475°

2011 Alum. Cap,  
#17492, 0.3' High  
Lat: 40.290114°  
Long: 104.319503°

1974 Brass Cap,  
0.8' High  
Lat: 40.290094°  
Long: 104.300850°

| LINE TABLE |             |         |
|------------|-------------|---------|
| LINE       | DIRECTION   | LENGTH  |
| L1         | N05°06'17"W | 281.01' |

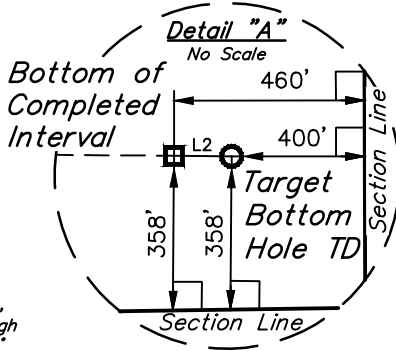

2014 Alum. Cap,  
#28285, 0.4' High,  
in Line With East Fence  
Lat: 40.275642°  
Long: 104.338522°

2011 Alum. Cap,  
#17492, 0.3' High  
Lat: 40.276069°  
Long: 104.300792°

ANSCHUTZ EQUUS FARMS  
4-62-28\_27 SWSW PAD  
#4-62-28-6457CB  
Elev. Ungraded Ground = 4639.4'

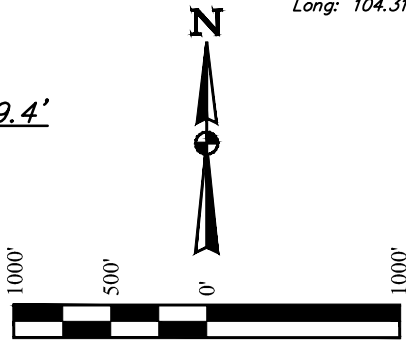

PDOP = 1.1

| NAD 83 (SURFACE LOCATION)                                                     | NAD 83 (LANDING POINT)                                                        | NAD 83 (BTM. OF COMPLETED INT.)                                               | NAD 83 (TARGET BOTTOM HOLE TD)                                                |
|-------------------------------------------------------------------------------|-------------------------------------------------------------------------------|-------------------------------------------------------------------------------|-------------------------------------------------------------------------------|
| LATITUDE = 40°16'34.77" (40.276325)<br>LONGITUDE = 104°20'12.40" (104.336778) | LATITUDE = 40°16'37.53" (40.277092)<br>LONGITUDE = 104°20'12.72" (104.336867) | LATITUDE = 40°16'37.32" (40.277033)<br>LONGITUDE = 104°18'08.80" (104.302444) | LATITUDE = 40°16'37.33" (40.277036)<br>LONGITUDE = 104°18'08.03" (104.302231) |
| NAD 27 (SURFACE LOCATION)                                                     | NAD 27 (LANDING POINT)                                                        | NAD 27 (BTM. OF COMPLETED INT.)                                               | NAD 27 (TARGET BOTTOM HOLE TD)                                                |
| LATITUDE = 40°16'34.84" (40.276344)<br>LONGITUDE = 104°20'10.57" (104.336269) | LATITUDE = 40°16'37.60" (40.277111)<br>LONGITUDE = 104°20'10.89" (104.336358) | LATITUDE = 40°16'37.39" (40.277053)<br>LONGITUDE = 104°18'06.97" (104.301936) | LATITUDE = 40°16'37.40" (40.277056)<br>LONGITUDE = 104°18'06.20" (104.301722) |
| STATE PLANE NAD 83 (CO. NORTH)                                                | STATE PLANE NAD 83 (CO. NORTH)                                                | STATE PLANE NAD 83 (CO. NORTH)                                                | STATE PLANE NAD 83 (CO. NORTH)                                                |
| N: 1345635.15 E: 3324551.20                                                   | N: 1345914.60 E: 3324522.30                                                   | N: 1346020.60 E: 3334126.35                                                   | N: 1346022.27 E: 3334186.32                                                   |
| STATE PLANE NAD 27 (CO. NORTH)                                                | STATE PLANE NAD 27 (CO. NORTH)                                                | STATE PLANE NAD 27 (CO. NORTH)                                                | STATE PLANE NAD 27 (CO. NORTH)                                                |
| N: 345637.85 E: 2324701.54                                                    | N: 345917.29 E: 2324672.63                                                    | N: 346023.36 E: 2334276.70                                                    | N: 346025.04 E: 2334336.66                                                    |

CERTIFICATE OF SURVEY  
THIS IS TO CERTIFY THAT THE ABOVE PLAT WAS PREPARED FROM FIELD NOTES OF ACTUAL SURVEYS MADE BY ME OR UNDER MY SUPERVISION, AND THAT THE SAME ARE TRUE AND CORRECT TO THE BEST OF MY KNOWLEDGE AND BELIEF.



**BASIS OF BEARINGS**  
BASIS OF BEARINGS IS A G.P.S. OBSERVATION  
**BASIS OF ELEVATION**

SPOT ELEVATION LOCATED AT THE NORTHEAST CORNER OF SECTION 24, T5N, R62W, 6th P.M. TAKEN FROM THE POINT OF ROCKS, QUADRANGLE, COLORADO, WELD COUNTY, 7.5 MINUTE QUAD (TOPOGRAPHIC MAP) PUBLISHED BY THE UNITED STATES DEPARTMENT OF THE INTERIOR, GEOLOGICAL SURVEY. SAID ELEVATION IS MARKED AS BEING 4530 FEET.

REV: 2 06-13-17 D.COX (LP & BHL CHANGE)



**UELS, LLC**  
Corporate Office \* 85 South 200 East  
Vernal, UT 84078 \* (435) 789-1017

|             |                   |          |            |
|-------------|-------------------|----------|------------|
| SURVEYED BY | CHAD MEIERS, N.P. | 12-22-16 | SCALE      |
| DRAWN BY    | S.F.              | 01-16-17 | 1" = 1000' |

**WELL LOCATION PLAT**