

Well Details: RU 41-17

GL 7859' & RKB 24' @ 7883.00usft (H&P 318)

+N/-S	+E/-W	Northing	Easting	Latitude	Longitude	Slot
0.00	0.00	1596998.90	2351747.60	39.4500417	-107.7958798	RU 41-17

T M Azimuths to True North
Magnetic North: 9.28°

Magnetic Field
Strength: 51718.6snT
Dip Angle: 65.65°
Date: 2/9/2017
Model: HDGM

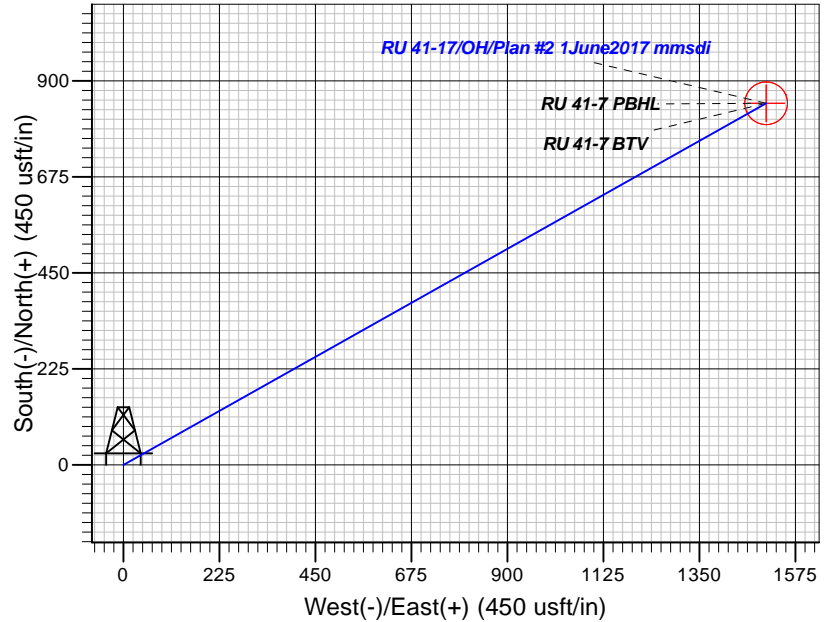
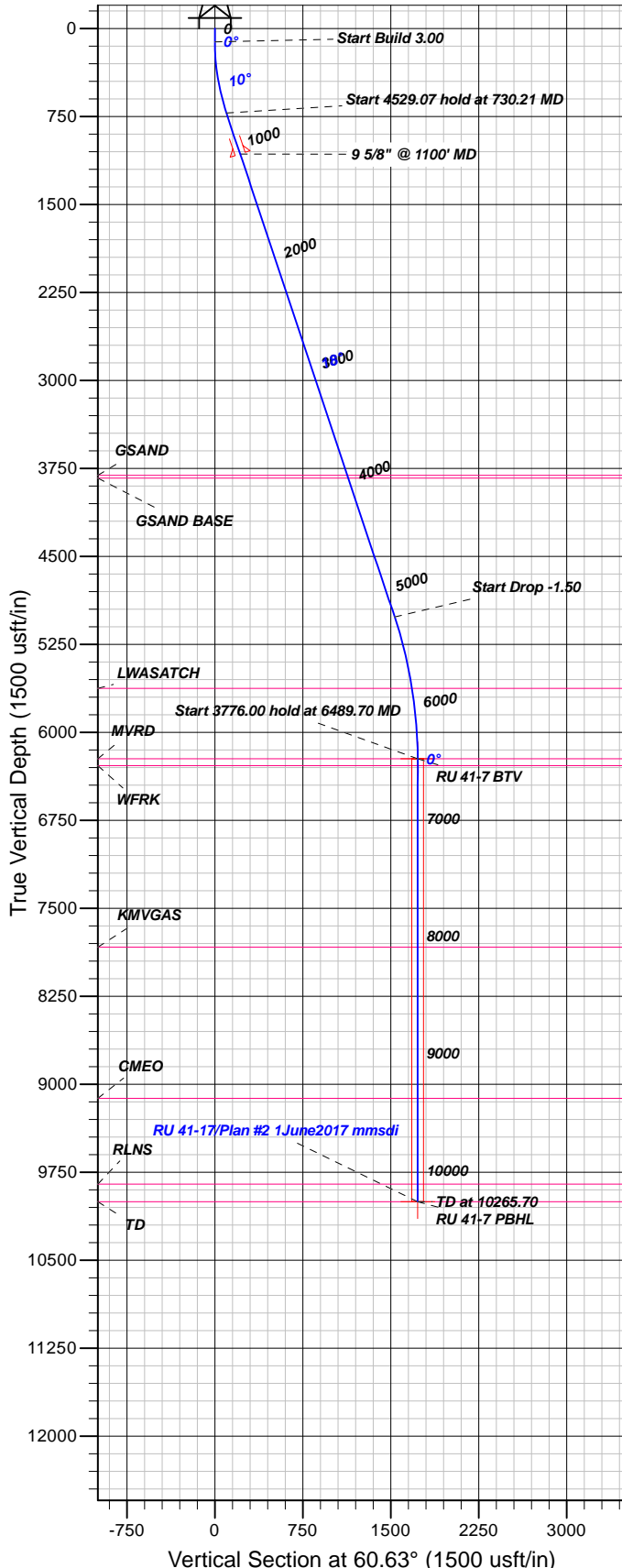

FORMATION TOP DETAILS

TVDPath	MDPath	Formation
3808.00	3986.05	GSAND
3833.00	4012.40	GSAND BASE
5625.00	5887.21	LWASATCH
6225.00	6489.70	MVRD
6283.00	6547.70	WFRK
7831.00	8095.70	KMVGAS
9120.00	9384.70	CMEO
9851.00	10115.70	RLNS
10001.00	10265.70	TD

Plan: Plan #2 1June2017 mmsdi

12:44, June 02 2017
Created By: Mel Mireles

PROJECT DETAILS: Garfield County, CO NAD83

Geodetic System: US State Plane 1983
Datum: North American Datum 1983
Ellipsoid: GRS 1980
Zone: Colorado Central Zone

System Datum: Mean Sea Level

CASING DETAILS

TVD	MD	Name	Size
1070.40	1100.00	9 5/8" @ 1100' MD	9.62

SECTION DETAILS

Sec	MD	Inc	Azi	TVD	+N/-S	+E/-W	Dleg	TFace	VSec	Target
1	0.00	0.00	0.00	0.00	0.00	0.00	0.00	0.00	0.00	
2	115.00	0.00	0.00	115.00	0.00	0.00	0.00	0.00	0.00	
3	730.21	18.46	60.63	719.63	48.18	85.61	3.00	60.63	98.23	
4	5259.28	18.46	60.63	5015.75	751.38	1335.14	0.00	0.001532.05		
5	6489.70	0.00	0.00	6225.00	847.74	1506.36	1.50	180.001728.52		RU 41-7 BTV
6	10265.70	0.00	0.0010001.00	847.74	1506.36	0.00	0.001728.52			RU 41-7 PBHL

DESIGN TARGET DETAILS

Name	TVD	+N/-S	+E/-W	Northing	Easting	Latitude	Longitude	Shape
RU 41-7 BTV	6225.00	847.74	1506.36	1597808.30	2353274.90	39.4523690	-107.7905452	Circle (Radius: 50.00)
- plan hits target center								
RU 41-7 PBHL	10001.00	847.74	1506.36	1597808.30	2353274.90	39.4523690	-107.7905452	Point
- plan hits target center								



TEP Rocky Mountain LLC

Garfield County, CO NAD83

RU 31-17 Pad

RU 41-17 - Slot RU 41-17

OH

Plan: Plan #2 1June2017 mmsdi

Standard Planning Report

02 June, 2017



Database:	Grand Junction District	Local Co-ordinate Reference:	Well RU 41-17 - Slot RU 41-17
Company:	TEP Rocky Mountain LLC	TVD Reference:	GL 7859' & RKB 24' @ 7883.00usft (H&P 318)
Project:	Garfield County, CO NAD83	MD Reference:	GL 7859' & RKB 24' @ 7883.00usft (H&P 318)
Site:	RU 31-17 Pad	North Reference:	True
Well:	RU 41-17	Survey Calculation Method:	Minimum Curvature
Wellbore:	OH		
Design:	Plan #2 1June2017 mmsdi		

Project	Garfield County, CO NAD83		
Map System:	US State Plane 1983	System Datum:	Mean Sea Level
Geo Datum:	North American Datum 1983		
Map Zone:	Colorado Central Zone		

Site	RU 31-17 Pad			
Site Position:		Northing:	1,596,940.40 usft	Latitude: 39.4498852
From: Map		Easting:	2,351,805.70 usft	Longitude: -107.7956689
Position Uncertainty:	0.00 usft	Slot Radius:	13.20 in	Grid Convergence: -1.45 °

Well	RU 41-17 - Slot RU 41-17			
Well Position	+N/-S	57.01 usft	Northing:	1,596,998.90 usft
	+E/-W	-59.56 usft	Easting:	2,351,747.60 usft
Position Uncertainty	0.00 usft		Wellhead Elevation:	0.00 usft
			Ground Level:	7,859.00 usft

Wellbore	OH				
Magnetics	Model Name	Sample Date	Declination (°)	Dip Angle (°)	Field Strength (nT)
	HDGM	2/9/2017	9.28	65.65	51,719

Design	Plan #2 1June2017 mmsdi			
Audit Notes:				
Version:	Phase:	PLAN	Tie On Depth:	0.00
Vertical Section:	Depth From (TVD) (usft)	+N/-S (usft)	+E/-W (usft)	Direction (°)
	0.00	0.00	0.00	60.63

Plan Sections										
Measured Depth (usft)	Inclination (°)	Azimuth (°)	Vertical Depth (usft)	+N/-S (usft)	+E/-W (usft)	Dogleg Rate (°/100usft)	Build Rate (°/100usft)	Turn Rate (°/100usft)	TFO (°)	Target
0.00	0.00	0.00	0.00	0.00	0.00	0.00	0.00	0.00	0.00	
115.00	0.00	0.00	115.00	0.00	0.00	0.00	0.00	0.00	0.00	
730.21	18.46	60.63	719.63	48.18	85.61	3.00	3.00	0.00	60.63	
5,259.28	18.46	60.63	5,015.75	751.38	1,335.14	0.00	0.00	0.00	0.00	
6,489.70	0.00	0.00	6,225.00	847.74	1,506.36	1.50	-1.50	0.00	180.00	RU 41-7 BTV
10,265.70	0.00	0.00	10,001.00	847.74	1,506.36	0.00	0.00	0.00	0.00	RU 41-7 PBHL

Database:	Grand Junction District	Local Co-ordinate Reference:	Well RU 41-17 - Slot RU 41-17
Company:	TEP Rocky Mountain LLC	TVD Reference:	GL 7859' & RKB 24' @ 7883.00usft (H&P 318)
Project:	Garfield County, CO NAD83	MD Reference:	GL 7859' & RKB 24' @ 7883.00usft (H&P 318)
Site:	RU 31-17 Pad	North Reference:	True
Well:	RU 41-17	Survey Calculation Method:	Minimum Curvature
Wellbore:	OH		
Design:	Plan #2 1June2017 mmsdi		

Planned Survey									
Measured Depth (usft)	Inclination (°)	Azimuth (°)	Vertical Depth (usft)	+N/-S (usft)	+E/-W (usft)	Vertical Section (usft)	Dogleg Rate (°/100usft)	Build Rate (°/100usft)	Turn Rate (°/100usft)
0.00	0.00	0.00	0.00	0.00	0.00	0.00	0.00	0.00	0.00
100.00	0.00	0.00	100.00	0.00	0.00	0.00	0.00	0.00	0.00
115.00	0.00	0.00	115.00	0.00	0.00	0.00	0.00	0.00	0.00
200.00	2.55	60.63	199.97	0.93	1.65	1.89	3.00	3.00	0.00
300.00	5.55	60.63	299.71	4.39	7.80	8.95	3.00	3.00	0.00
400.00	8.55	60.63	398.94	10.41	18.50	21.23	3.00	3.00	0.00
500.00	11.55	60.63	497.40	18.97	33.70	38.67	3.00	3.00	0.00
600.00	14.55	60.63	594.80	30.04	53.38	61.25	3.00	3.00	0.00
700.00	17.55	60.63	690.90	43.60	77.47	88.90	3.00	3.00	0.00
730.21	18.46	60.63	719.63	48.18	85.61	98.23	3.00	3.00	0.00
800.00	18.46	60.63	785.83	59.01	104.86	120.33	0.00	0.00	0.00
900.00	18.46	60.63	880.68	74.54	132.45	151.99	0.00	0.00	0.00
1,000.00	18.46	60.63	975.54	90.07	160.04	183.64	0.00	0.00	0.00
1,100.00	18.46	60.63	1,070.40	105.59	187.63	215.30	0.00	0.00	0.00
9 5/8" @ 1100' MD									
1,200.00	18.46	60.63	1,165.25	121.12	215.22	246.96	0.00	0.00	0.00
1,300.00	18.46	60.63	1,260.11	136.65	242.81	278.62	0.00	0.00	0.00
1,400.00	18.46	60.63	1,354.97	152.17	270.40	310.28	0.00	0.00	0.00
1,500.00	18.46	60.63	1,449.82	167.70	297.99	341.93	0.00	0.00	0.00
1,600.00	18.46	60.63	1,544.68	183.22	325.58	373.59	0.00	0.00	0.00
1,700.00	18.46	60.63	1,639.54	198.75	353.17	405.25	0.00	0.00	0.00
1,800.00	18.46	60.63	1,734.39	214.28	380.75	436.91	0.00	0.00	0.00
1,900.00	18.46	60.63	1,829.25	229.80	408.34	468.57	0.00	0.00	0.00
2,000.00	18.46	60.63	1,924.10	245.33	435.93	500.22	0.00	0.00	0.00
2,100.00	18.46	60.63	2,018.96	260.86	463.52	531.88	0.00	0.00	0.00
2,200.00	18.46	60.63	2,113.82	276.38	491.11	563.54	0.00	0.00	0.00
2,300.00	18.46	60.63	2,208.67	291.91	518.70	595.20	0.00	0.00	0.00
2,400.00	18.46	60.63	2,303.53	307.44	546.29	626.86	0.00	0.00	0.00
2,500.00	18.46	60.63	2,398.39	322.96	573.88	658.51	0.00	0.00	0.00
2,600.00	18.46	60.63	2,493.24	338.49	601.47	690.17	0.00	0.00	0.00
2,700.00	18.46	60.63	2,588.10	354.02	629.06	721.83	0.00	0.00	0.00
2,800.00	18.46	60.63	2,682.96	369.54	656.65	753.49	0.00	0.00	0.00
2,900.00	18.46	60.63	2,777.81	385.07	684.24	785.15	0.00	0.00	0.00
3,000.00	18.46	60.63	2,872.67	400.59	711.83	816.81	0.00	0.00	0.00
3,100.00	18.46	60.63	2,967.53	416.12	739.41	848.46	0.00	0.00	0.00
3,200.00	18.46	60.63	3,062.38	431.65	767.00	880.12	0.00	0.00	0.00
3,300.00	18.46	60.63	3,157.24	447.17	794.59	911.78	0.00	0.00	0.00
3,400.00	18.46	60.63	3,252.10	462.70	822.18	943.44	0.00	0.00	0.00
3,500.00	18.46	60.63	3,346.95	478.23	849.77	975.10	0.00	0.00	0.00
3,600.00	18.46	60.63	3,441.81	493.75	877.36	1,006.75	0.00	0.00	0.00
3,700.00	18.46	60.63	3,536.67	509.28	904.95	1,038.41	0.00	0.00	0.00
3,800.00	18.46	60.63	3,631.52	524.81	932.54	1,070.07	0.00	0.00	0.00
3,900.00	18.46	60.63	3,726.38	540.33	960.13	1,101.73	0.00	0.00	0.00
3,986.05	18.46	60.63	3,808.00	553.69	983.87	1,128.97	0.00	0.00	0.00
GSAND									
4,000.00	18.46	60.63	3,821.24	555.86	987.72	1,133.39	0.00	0.00	0.00
4,012.40	18.46	60.63	3,833.00	557.78	991.14	1,137.31	0.00	0.00	0.00
GSAND BASE									
4,100.00	18.46	60.63	3,916.09	571.39	1,015.31	1,165.04	0.00	0.00	0.00
4,200.00	18.46	60.63	4,010.95	586.91	1,042.90	1,196.70	0.00	0.00	0.00
4,300.00	18.46	60.63	4,105.81	602.44	1,070.49	1,228.36	0.00	0.00	0.00
4,400.00	18.46	60.63	4,200.66	617.96	1,098.07	1,260.02	0.00	0.00	0.00

Database:	Grand Junction District	Local Co-ordinate Reference:	Well RU 41-17 - Slot RU 41-17
Company:	TEP Rocky Mountain LLC	TVD Reference:	GL 7859' & RKB 24' @ 7883.00usft (H&P 318)
Project:	Garfield County, CO NAD83	MD Reference:	GL 7859' & RKB 24' @ 7883.00usft (H&P 318)
Site:	RU 31-17 Pad	North Reference:	True
Well:	RU 41-17	Survey Calculation Method:	Minimum Curvature
Wellbore:	OH		
Design:	Plan #2 1June2017 mmsdi		

Planned Survey									
Measured Depth (usft)	Inclination (°)	Azimuth (°)	Vertical Depth (usft)	+N/-S (usft)	+E/-W (usft)	Vertical Section (usft)	Dogleg Rate (°/100usft)	Build Rate (°/100usft)	Turn Rate (°/100usft)
4,500.00	18.46	60.63	4,295.52	633.49	1,125.66	1,291.68	0.00	0.00	0.00
4,600.00	18.46	60.63	4,390.37	649.02	1,153.25	1,323.34	0.00	0.00	0.00
4,700.00	18.46	60.63	4,485.23	664.54	1,180.84	1,354.99	0.00	0.00	0.00
4,800.00	18.46	60.63	4,580.09	680.07	1,208.43	1,386.65	0.00	0.00	0.00
4,900.00	18.46	60.63	4,674.94	695.60	1,236.02	1,418.31	0.00	0.00	0.00
5,000.00	18.46	60.63	4,769.80	711.12	1,263.61	1,449.97	0.00	0.00	0.00
5,100.00	18.46	60.63	4,864.66	726.65	1,291.20	1,481.63	0.00	0.00	0.00
5,200.00	18.46	60.63	4,959.51	742.18	1,318.79	1,513.28	0.00	0.00	0.00
5,259.28	18.46	60.63	5,015.75	751.38	1,335.14	1,532.05	0.00	0.00	0.00
5,300.00	17.85	60.63	5,054.44	757.60	1,346.20	1,544.74	1.50	-1.50	0.00
5,400.00	16.35	60.63	5,150.02	772.02	1,371.82	1,574.13	1.50	-1.50	0.00
5,500.00	14.85	60.63	5,246.33	785.20	1,395.24	1,601.02	1.50	-1.50	0.00
5,600.00	13.35	60.63	5,343.32	797.15	1,416.47	1,625.37	1.50	-1.50	0.00
5,700.00	11.85	60.63	5,440.91	807.84	1,435.47	1,647.17	1.50	-1.50	0.00
5,800.00	10.35	60.63	5,539.04	817.28	1,452.24	1,666.42	1.50	-1.50	0.00
5,887.21	9.04	60.63	5,625.00	824.48	1,465.04	1,681.10	1.50	-1.50	0.00
LWASATCH									
5,900.00	8.85	60.63	5,637.64	825.45	1,466.77	1,683.09	1.50	-1.50	0.00
6,000.00	7.35	60.63	5,736.64	832.36	1,479.04	1,697.17	1.50	-1.50	0.00
6,100.00	5.85	60.63	5,835.97	837.99	1,489.05	1,708.66	1.50	-1.50	0.00
6,200.00	4.35	60.63	5,935.57	842.35	1,496.79	1,717.54	1.50	-1.50	0.00
6,300.00	2.85	60.63	6,035.37	845.43	1,502.25	1,723.81	1.50	-1.50	0.00
6,400.00	1.35	60.63	6,135.30	847.22	1,505.44	1,727.46	1.50	-1.50	0.00
6,489.70	0.00	0.00	6,225.00	847.74	1,506.36	1,728.52	1.50	-1.50	-67.59
MVRD - RU 41-7 BTV									
6,500.00	0.00	0.00	6,235.30	847.74	1,506.36	1,728.52	0.00	0.00	0.00
6,547.70	0.00	0.00	6,283.00	847.74	1,506.36	1,728.52	0.00	0.00	0.00
WFRK									
6,600.00	0.00	0.00	6,335.30	847.74	1,506.36	1,728.52	0.00	0.00	0.00
6,700.00	0.00	0.00	6,435.30	847.74	1,506.36	1,728.52	0.00	0.00	0.00
6,800.00	0.00	0.00	6,535.30	847.74	1,506.36	1,728.52	0.00	0.00	0.00
6,900.00	0.00	0.00	6,635.30	847.74	1,506.36	1,728.52	0.00	0.00	0.00
7,000.00	0.00	0.00	6,735.30	847.74	1,506.36	1,728.52	0.00	0.00	0.00
7,100.00	0.00	0.00	6,835.30	847.74	1,506.36	1,728.52	0.00	0.00	0.00
7,200.00	0.00	0.00	6,935.30	847.74	1,506.36	1,728.52	0.00	0.00	0.00
7,300.00	0.00	0.00	7,035.30	847.74	1,506.36	1,728.52	0.00	0.00	0.00
7,400.00	0.00	0.00	7,135.30	847.74	1,506.36	1,728.52	0.00	0.00	0.00
7,500.00	0.00	0.00	7,235.30	847.74	1,506.36	1,728.52	0.00	0.00	0.00
7,600.00	0.00	0.00	7,335.30	847.74	1,506.36	1,728.52	0.00	0.00	0.00
7,700.00	0.00	0.00	7,435.30	847.74	1,506.36	1,728.52	0.00	0.00	0.00
7,800.00	0.00	0.00	7,535.30	847.74	1,506.36	1,728.52	0.00	0.00	0.00
7,900.00	0.00	0.00	7,635.30	847.74	1,506.36	1,728.52	0.00	0.00	0.00
8,000.00	0.00	0.00	7,735.30	847.74	1,506.36	1,728.52	0.00	0.00	0.00
8,095.70	0.00	0.00	7,831.00	847.74	1,506.36	1,728.52	0.00	0.00	0.00
KMVGAS									
8,100.00	0.00	0.00	7,835.30	847.74	1,506.36	1,728.52	0.00	0.00	0.00
8,200.00	0.00	0.00	7,935.30	847.74	1,506.36	1,728.52	0.00	0.00	0.00
8,300.00	0.00	0.00	8,035.30	847.74	1,506.36	1,728.52	0.00	0.00	0.00
8,400.00	0.00	0.00	8,135.30	847.74	1,506.36	1,728.52	0.00	0.00	0.00
8,500.00	0.00	0.00	8,235.30	847.74	1,506.36	1,728.52	0.00	0.00	0.00
8,600.00	0.00	0.00	8,335.30	847.74	1,506.36	1,728.52	0.00	0.00	0.00

Database:	Grand Junction District	Local Co-ordinate Reference:	Well RU 41-17 - Slot RU 41-17
Company:	TEP Rocky Mountain LLC	TVD Reference:	GL 7859' & RKB 24' @ 7883.00usft (H&P 318)
Project:	Garfield County, CO NAD83	MD Reference:	GL 7859' & RKB 24' @ 7883.00usft (H&P 318)
Site:	RU 31-17 Pad	North Reference:	True
Well:	RU 41-17	Survey Calculation Method:	Minimum Curvature
Wellbore:	OH		
Design:	Plan #2 1June2017 mmsdi		

Planned Survey										
Measured Depth (usft)	Inclination (°)	Azimuth (°)	Vertical Depth (usft)	+N/-S (usft)	+E/-W (usft)	Vertical Section (usft)	Dogleg Rate (°/100usft)	Build Rate (°/100usft)	Turn Rate (°/100usft)	
8,700.00	0.00	0.00	8,435.30	847.74	1,506.36	1,728.52	0.00	0.00	0.00	
8,800.00	0.00	0.00	8,535.30	847.74	1,506.36	1,728.52	0.00	0.00	0.00	
8,900.00	0.00	0.00	8,635.30	847.74	1,506.36	1,728.52	0.00	0.00	0.00	
9,000.00	0.00	0.00	8,735.30	847.74	1,506.36	1,728.52	0.00	0.00	0.00	
9,100.00	0.00	0.00	8,835.30	847.74	1,506.36	1,728.52	0.00	0.00	0.00	
9,200.00	0.00	0.00	8,935.30	847.74	1,506.36	1,728.52	0.00	0.00	0.00	
9,300.00	0.00	0.00	9,035.30	847.74	1,506.36	1,728.52	0.00	0.00	0.00	
9,384.70	0.00	0.00	9,120.00	847.74	1,506.36	1,728.52	0.00	0.00	0.00	
CMEO										
9,400.00	0.00	0.00	9,135.30	847.74	1,506.36	1,728.52	0.00	0.00	0.00	
9,500.00	0.00	0.00	9,235.30	847.74	1,506.36	1,728.52	0.00	0.00	0.00	
9,600.00	0.00	0.00	9,335.30	847.74	1,506.36	1,728.52	0.00	0.00	0.00	
9,700.00	0.00	0.00	9,435.30	847.74	1,506.36	1,728.52	0.00	0.00	0.00	
9,800.00	0.00	0.00	9,535.30	847.74	1,506.36	1,728.52	0.00	0.00	0.00	
9,900.00	0.00	0.00	9,635.30	847.74	1,506.36	1,728.52	0.00	0.00	0.00	
10,000.00	0.00	0.00	9,735.30	847.74	1,506.36	1,728.52	0.00	0.00	0.00	
10,100.00	0.00	0.00	9,835.30	847.74	1,506.36	1,728.52	0.00	0.00	0.00	
10,115.70	0.00	0.00	9,851.00	847.74	1,506.36	1,728.52	0.00	0.00	0.00	
RLNS										
10,200.00	0.00	0.00	9,935.30	847.74	1,506.36	1,728.52	0.00	0.00	0.00	
10,265.70	0.00	0.00	10,001.00	847.74	1,506.36	1,728.52	0.00	0.00	0.00	
TD - RU 41-7 PBHL										

Design Targets									
Target Name - hit/miss target - Shape	Dip Angle (°)	Dip Dir. (°)	TVD (usft)	+N/-S (usft)	+E/-W (usft)	Northing (usft)	Easting (usft)	Latitude	Longitude
RU 41-7 BTV - plan hits target center - Circle (radius 50.00)	0.00	0.00	6,225.00	847.74	1,506.36	1,597,808.30	2,353,274.90	39.4523690	-107.7905452
RU 41-7 PBHL - plan hits target center - Point	0.00	0.00	10,001.00	847.74	1,506.36	1,597,808.30	2,353,274.90	39.4523690	-107.7905452

Casing Points					
Measured Depth (usft)	Vertical Depth (usft)	Name	Casing Diameter (in)	Hole Diameter (in)	
1,100.00	1,070.40	9 5/8" @ 1100' MD	9.62	9.62	

Database:	Grand Junction District	Local Co-ordinate Reference:	Well RU 41-17 - Slot RU 41-17
Company:	TEP Rocky Mountain LLC	TVD Reference:	GL 7859' & RKB 24' @ 7883.00usft (H&P 318)
Project:	Garfield County, CO NAD83	MD Reference:	GL 7859' & RKB 24' @ 7883.00usft (H&P 318)
Site:	RU 31-17 Pad	North Reference:	True
Well:	RU 41-17	Survey Calculation Method:	Minimum Curvature
Wellbore:	OH		
Design:	Plan #2 1June2017 mmsdi		

Formations						
Measured Depth (usft)	Vertical Depth (usft)	Name	Lithology	Dip (°)	Dip Direction (°)	
3,986.05	3,808.00	GSAND		0.00	0.00	
4,012.40	3,833.00	GSAND BASE		0.00	0.00	
5,887.21	5,625.00	LWASATCH		0.00	0.00	
6,489.70	6,225.00	MVRD		0.00	0.00	
6,547.70	6,283.00	WFRK		0.00	0.00	
8,095.70	7,831.00	KMVGAS		0.00	0.00	
9,384.70	9,120.00	CMEO		0.00	0.00	
10,115.70	9,851.00	RLNS		0.00	0.00	
10,265.70	10,001.00	TD		0.00	0.00	