

Holloway & Holloway, Inc.  
P.O. Box 3331  
Greeley, CO 80633  
(303) 867-3715  
(303) 352-5852



00059911

RECEIVED

R63W

JUN 26 00

NE cor. T-fence  
North

NW cor. re-bar  
in roadway

N

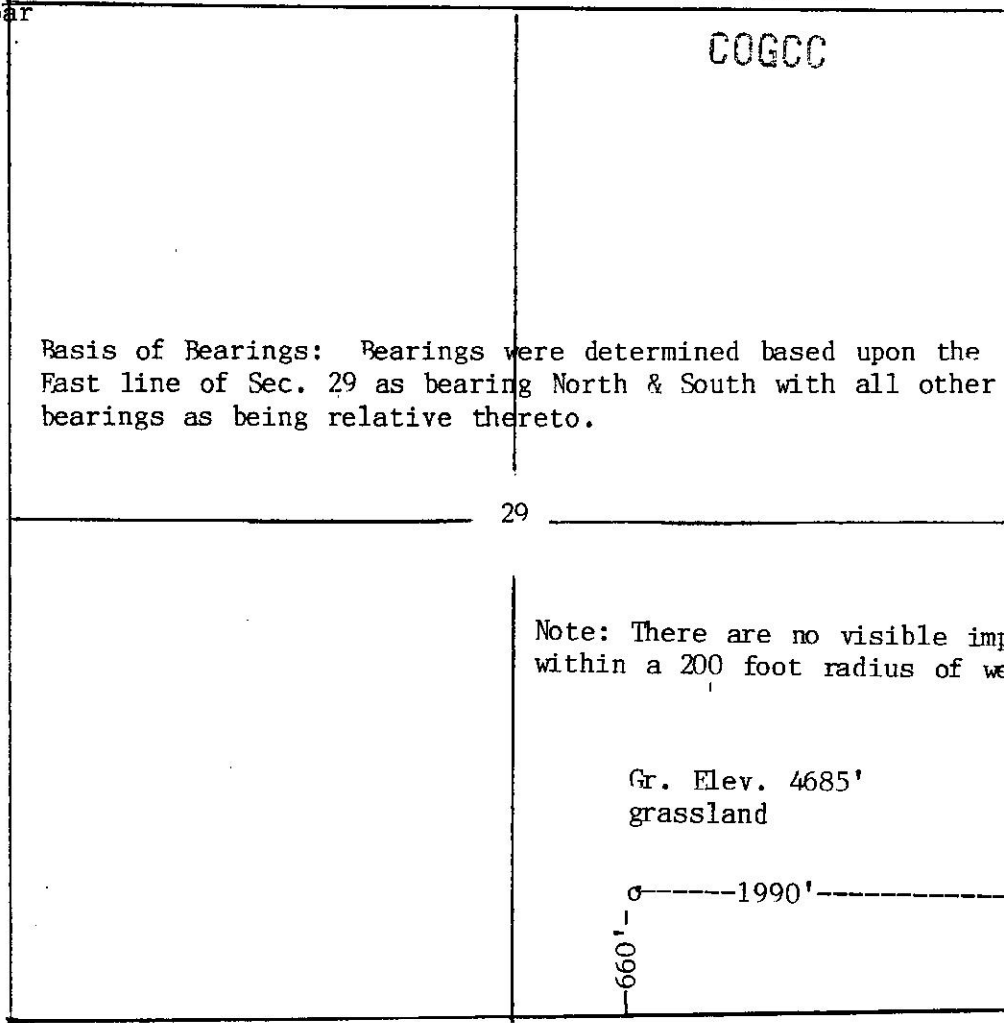
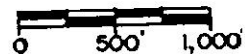

SW cor. proportioned from  
SE cor. sec. 29 to SW cor.  
Sec. 30 & CL old road F&W

N89°46'W 5308'

Scale --- 1" = 1000'

SE cor. fence  
corner South & East  
Basis of elev spot elev  
at SE cor. 4719'

In accordance with a request from Petroleum Development Corp.  
the Undersigned has  
determined the location of the J&L Farms 29-34 well

to be 660'FSL & 1990'FEL at right angles as co-ordinates

Section 29 Township 6N Range 63W of the 6th principal Meridian

Weld County, Colorado.

I hereby certify,  
that this oil and/or gas well location certificate was prepared for Petroleum Development Corp.  
that it is not a land survey plat or improvement survey plat, and that it is not to be relied upon for the  
establishment of fence, building or other future improvement lines

Date 1-19-2000

*Billy L. Holloway*  
Holloway & Holloway, Inc.  
States of

