



Lat40°, Inc. 6250 W. 10th Street, Unit 2, Greeley, CO 970-515-5294

# NOTIFICATION ZONE DRAWING

**HOMESTEAD 1N66W34 PAD**

SECTION: 34  
TOWNSHIP: 1N  
RANGE: 66W  
6TH. P.M.  
WELD COUNTY, CO

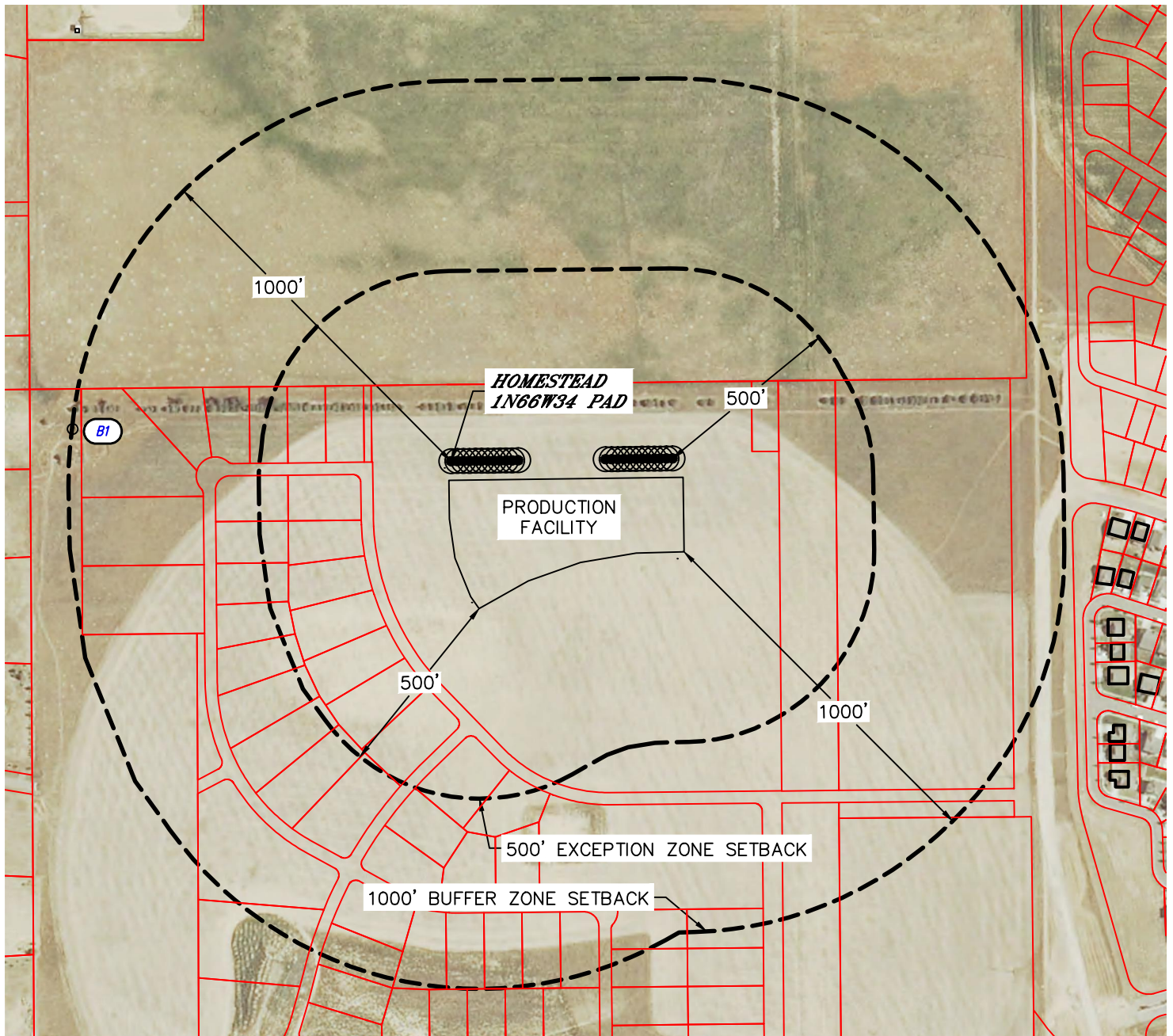

NOTE: THIS NOTIFICATION ZONE MAP IS BEING REVISED TO UPDATE THE PARCEL LINE WORK PER HOMESTEAD SUBDIVISION AMENDMENT NO. 1 RECORDED MARCH 7, 2017 AT REC. NO. 4283845. EXISTING BUILDING UNITS HAVE NOT BEEN RE-VERIFIED WITH THIS UPDATE.

## EXCEPTION ZONE:

NO EXISTING BUILDING UNITS WITHIN EXCEPTION ZONE

## BUFFER ZONE:

NO EXISTING BUILDING UNITS WITHIN BUFFER ZONE

### LEGEND

- PROPERTY LINE
- BUILDING
- BUILDING UNIT

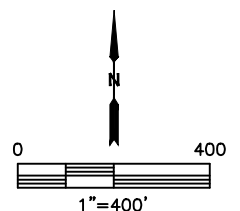

DATE: 4/19/2017  
PROJECT#: 2014230