

LEGEND:

- └─┘ = 90° SYMBOL
● = PROPOSED WELLHEAD.
◇ = HEEL.
○ = TARGET BOTTOM HOLE.
▲ = SECTION CORNERS LOCATED. (NAD 83)

T12N, R62W, 6th P.M.

WYOMING
COLORADO

C.C. 1922 Brass Cap,
0.1' High, E-W Fenceline
Lat: 41.001661°
Long: 104.352661°

Brass Cap, 0.5' High
Lat: 41.002242°
Long: 104.352642°

1911 Brass Cap, 0.4' High,
Post, Pile of Stones
Lat: 41.002386°
Long: 104.343125°

1911 Brass Cap,
0.5' Below Ground,
Post,
Lat: 41.002528°
Long: 104.333581°

LARAMIE CO.
WELD CO.

1911 Brass Cap
Lat: 41.001661°
Long: 104.333608°

2015 Alum. Cap
#17492, Flush W/Ground
Lat: 40.987794°
Long: 104.352572°

2010 Alum. Cap,
At Fence Corner
Lat: 40.988167°
Long: 104.333947°

2015 Alum. Cap
#17492, 0.7' Below
Road Surface
Lat: 40.973344°
Long: 104.353161°

2010 Alum. Cap,
In Center of Road
Lat: 40.973386°
Long: 104.334847°

RANDALL CREEK #503-2920H
Elev. Ungraded Ground = 5347.8'

LINE TABLE

LINE	DIRECTION	LENGTH
L1	N72°35'23"W	827.23'
L2	N63°47'08"E	113.91'

PDOP = 1.3



NAD 83 (SURFACE LOCATION) LATITUDE = 40°58'26.63" (40.974064) LONGITUDE = 104°20'15.73" (104.337703)	NAD 83 (HEEL) LATITUDE = 40°58'27.13" (40.974203) LONGITUDE = 104°20'14.40" (104.337333)	NAD 83 (TARGET BOTTOM HOLE) LATITUDE = 41°00'03.01" (41.000836) LONGITUDE = 104°20'10.18" (104.336161)
NAD 27 (SURFACE LOCATION) LATITUDE = 40°58'26.69" (40.974081) LONGITUDE = 104°20'13.90" (104.337194)	NAD 27 (HEEL) LATITUDE = 40°58'27.19" (40.974219) LONGITUDE = 104°20'12.56" (104.336822)	NAD 27 (TARGET BOTTOM HOLE) LATITUDE = 41°00'03.07" (41.000853) LONGITUDE = 104°20'08.34" (104.335650)
STATE PLANE NAD 83 (CO. NORTH) N: 1599810.59 E: 3320961.04	STATE PLANE NAD 83 (CO. NORTH) N: 1599862.18 E: 3321062.56	STATE PLANE NAD 83 (CO. NORTH) N: 1609570.20 E: 3321259.28
STATE PLANE NAD 27 (CO. NORTH) N: 599808.13 E: 2321110.46	STATE PLANE NAD 27 (CO. NORTH) N: 599859.73 E: 2321211.98	STATE PLANE NAD 27 (CO. NORTH) N: 609567.57 E: 2321408.76

BASIS OF BEARINGS

BASIS OF BEARINGS IS A G.P.S. OBSERVATION

BASIS OF ELEVATION

SPOT ELEVATION LOCATED AT THE NORTHEAST CORNER OF SECTION 1, T11N, R63W, 6th P.M., TAKEN FROM THE HEREFORD, QUADRANGLE, COLORADO, WELD COUNTY, 7.5 MINUTE QUAD. (TOPOGRAPHIC MAP) PUBLISHED BY THE UNITED STATES DEPARTMENT OF THE INTERIOR, GEOLOGICAL SURVEY. SAID ELEVATION IS MARKED AS BEING 5352 FEET.



UELS, LLC
Corporate Office * 85 South 200 East
Vernal, UT 84078 * (435) 789-1017



CERTIFICATE
THIS IS TO CERTIFY THAT THE ABOVE AND WAS PREPARED FROM FIELD NOTES OF ACTUAL SURVEYS MADE BY ME OR UNDER MY SUPERVISION, AND THAT THE SAME ARE TRUE AND CORRECT TO THE BEST OF MY KNOWLEDGE AND BELIEF.

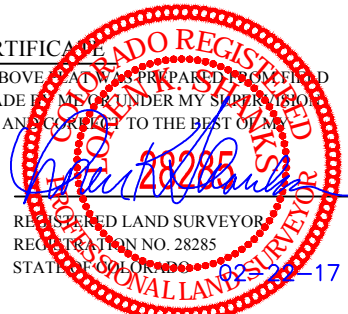

REV: 1 02-17-17 M.D. (WELL CHANGE)

FIFTH CREEK ENERGY COMPANY, LLC

RANDALL CREEK #503-2920H
SE 1/4 SE 1/4, SECTION 29, T12N, R62W, 6th P.M.
WELD COUNTY, COLORADO

SURVEYED BY	GREG WEIMER, J.S.	02-10-17	SCALE
DRAWN BY	M.D.	02-17-17	1" = 1000'

WELL LOCATION PLAT