

T11N

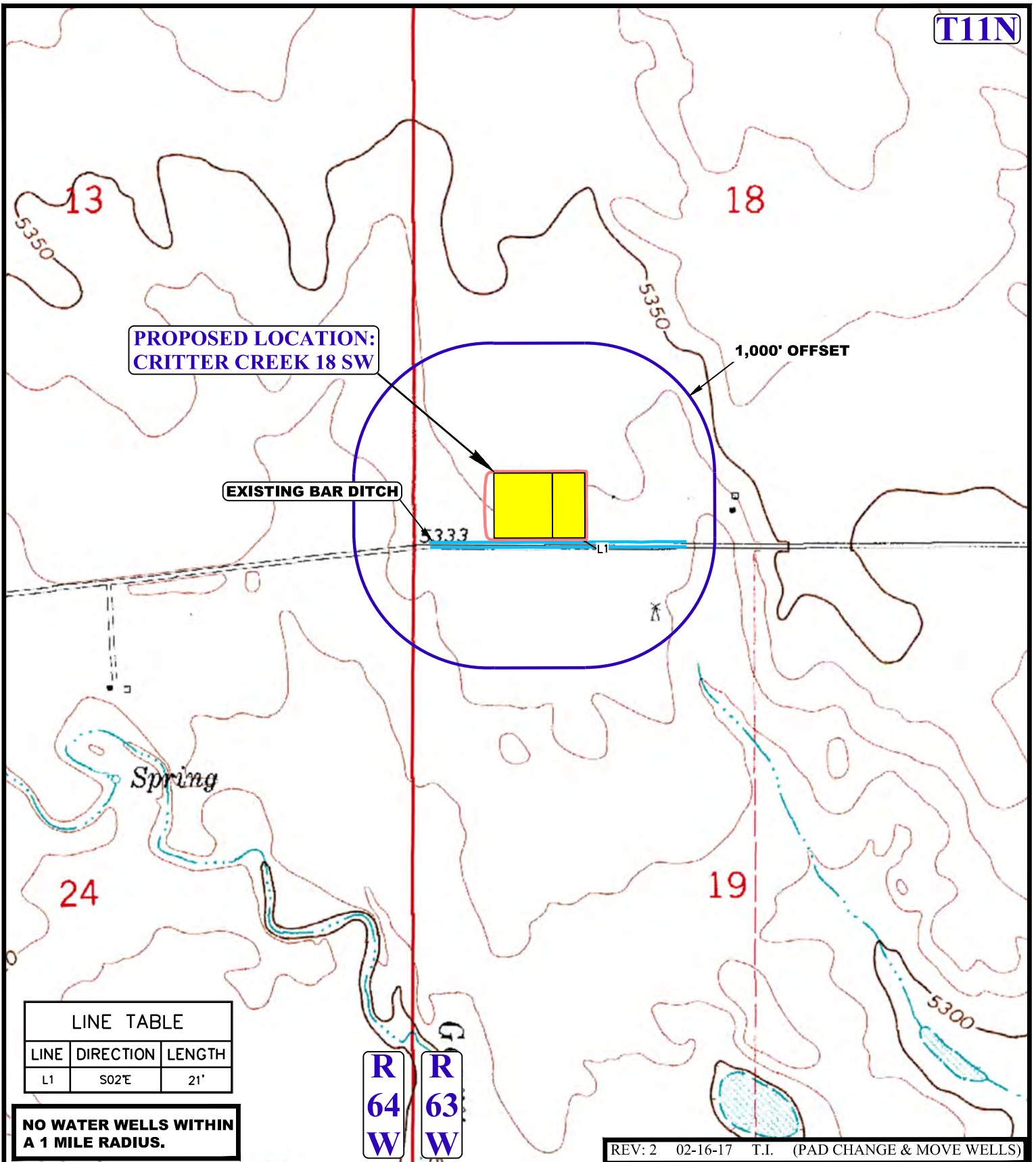

LEGEND:

- EXISTING DRAINAGE
- 1000' OFFSET BOUNDARY
- EDGE OF DISTURBANCE
- FLOOD PLAINS



UELS, LLC
Corporate Office * 85 South 200 East
Vernal, UT 84078 * (435) 789-1017



FIFTH CREEK ENERGY COMPANY, LLC

CRITTER CREEK 18 SW
S 1/2 SW 1/4, SECTION 18, T11N, R63W, 6th P.M.
WELD COUNTY, COLORADO

SURVEYED BY	G.W., N.P.	02-01-17	SCALE
DRAWN BY	R.C.	04-01-15	1 : 12,000
HYDROLOGY MAP			TOPO W