

Project: Weld County, CO  
 Site: SEC 26, T8N-R67W  
 Well: Sligo Sweet Stout 8-67-26-23C  
 Wellbore: Hz  
 Design: Plan 1

## Reference Details

Geodetic System: US State Plane 1983  
 Datum: North American Datum 1983  
 Ellipsoid: GRS 1980  
 Latitude: 40° 37' 35.303 N  
 Longitude: 104° 51' 27.659 W  
 Grid Convergence: 0.42° West  
 Ground Elevation: 5189.0  
 KB Elevation: Well @ 5215.0usft

RPM Consulting, Inc.  
 1600 Broadway, Suite 1510  
 Denver, CO 80013  
 303-595-7625

## SECTION DETAILS

MD	Inc	Azi	TVD	+N/-S	+E/-W	Dleg	TFace	Vsect
0.0	0.00	0.00	0.0	0.0	0.0	0.00	0.00	0.0
1500.0	0.00	0.00	1500.0	0.0	0.0	0.00	0.00	0.0
2307.8	0.00	0.00	2307.8	0.0	0.0	0.00	0.00	0.0
2974.5	20.00	105.92	2961.0	-31.6	110.8	3.00	105.92	-15.9
6340.2	20.00	105.92	6123.8	-347.4	1217.7	0.00	0.00	-175.0
7006.9	0.00	0.00	6777.0	-379.0	1328.5	3.00	180.00	-190.9
7906.9	90.00	0.00	7350.0	194.0	1328.5	10.00	0.00	376.5
7937.9	90.00	0.00	7350.0	225.0	1328.5	0.01	94.82	407.2
17193.9	90.00	0.00	7350.0	9481.0	1329.0	0.00	0.00	9573.7

## CASING DETAILS

TVD	MD	Name
1500.0	1500.0	Surface
7350.0	7950.0	Intermediate

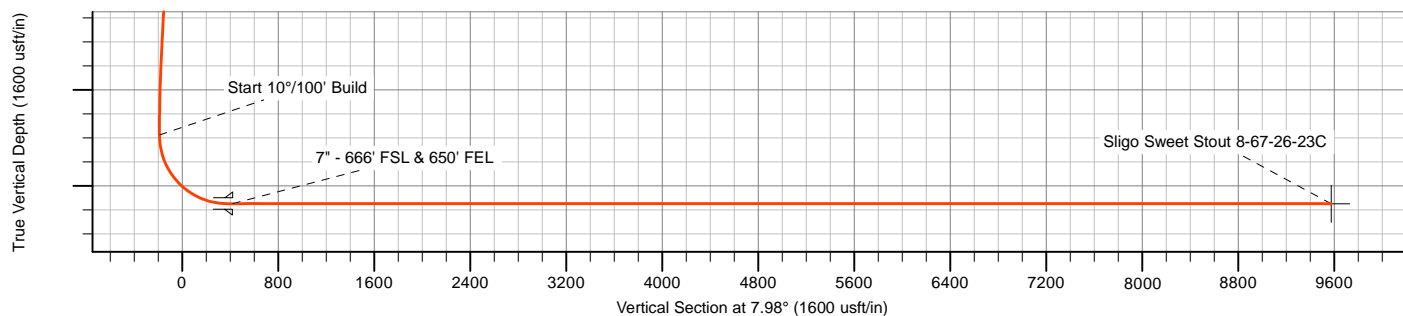
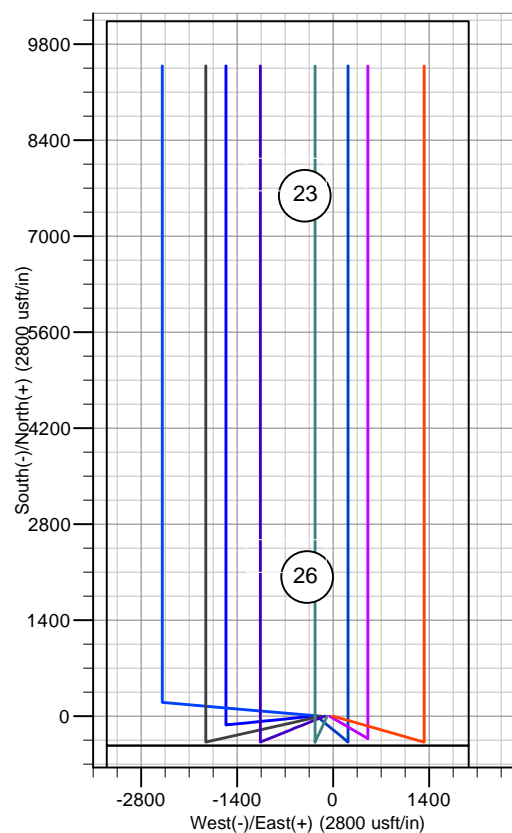
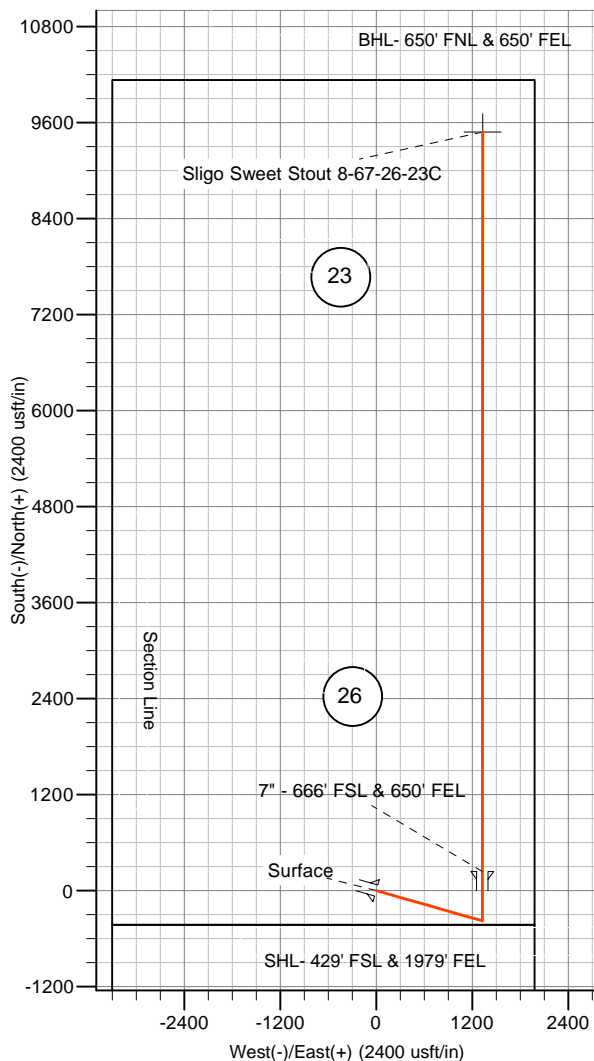

# **Enerplus Resources (USA) Corporation**

**Weld County, CO**

**SEC 26, T8N-R67W**

**Sligo Sweet Stout 8-67-26-23C**

**Hz**

**Plan: Plan 1**

## **Standard Planning Report**

**10 February, 2017**

## Planning Report

<b>Database:</b>	EDM	<b>Local Co-ordinate Reference:</b>	Well Sligo Sweet Stout 8-67-26-23C
<b>Company:</b>	Enerplus Resources (USA) Corporation	<b>TVD Reference:</b>	Well @ 5215.0usft
<b>Project:</b>	Weld County, CO	<b>MD Reference:</b>	Well @ 5215.0usft
<b>Site:</b>	SEC 26, T8N-R67W	<b>North Reference:</b>	True
<b>Well:</b>	Sligo Sweet Stout 8-67-26-23C	<b>Survey Calculation Method:</b>	Minimum Curvature
<b>Wellbore:</b>	Hz		
<b>Design:</b>	Plan 1		

<b>Project</b>	Weld County, CO		
<b>Map System:</b>	US State Plane 1983	<b>System Datum:</b>	Mean Sea Level
<b>Geo Datum:</b>	North American Datum 1983		
<b>Map Zone:</b>	Colorado Northern Zone		

Site		SEC 26, T8N-R67W			
Site Position:		Northing:	1,471,710.17 usft	Latitude:	40° 37' 35.306 N
From:	Lat/Long	Easting:	3,178,017.95 usft	Longitude:	104° 51' 31.223 W
Position Uncertainty:	0.0 usft	Slot Radius:	13-3/16 "	Grid Convergence:	0.41 °

Well	Sligo Sweet Stout 8-67-26-23C					
Well Position	+N/-S	-0.4 usft	Northing:	1,471,711.79 usft	Latitude:	40° 37' 35.303 N
	+E/-W	274.8 usft	Easting:	3,178,292.75 usft	Longitude:	104° 51' 27.659 W
Position Uncertainty		0.0 usft	Wellhead Elevation:	0.0 usft	Ground Level:	5,189.0 usft

<b>Wellbore</b>	Hz				
<b>Magnetics</b>	<b>Model Name</b>	<b>Sample Date</b>	<b>Declination (°)</b>	<b>Dip Angle (°)</b>	<b>Field Strength (nT)</b>
	IGRF2010	2/9/2017	8.17	67.02	52,641

<b>Design</b>	Plan 1			
<b>Audit Notes:</b>				
<b>Version:</b>	<b>Phase:</b>	PROTOTYPE	<b>Tie On Depth:</b>	0.0
<b>Vertical Section:</b>	<b>Depth From (TVD) (usft)</b>	<b>+N/-S (usft)</b>	<b>+E/-W (usft)</b>	<b>Direction (°)</b>
	0.0	0.0	0.0	7.98

<b>Plan Sections</b>										
Measured Depth (usft)	Inclination (°)	Azimuth (°)	Vertical Depth (usft)	+N/-S (usft)	+E/-W (usft)	Dogleg Rate (°/100usft)	Build Rate (°/100usft)	Turn Rate (°/100usft)	TFO (°)	Target
0.0	0.00	0.00	0.0	0.0	0.0	0.00	0.00	0.00	0.00	
1,500.0	0.00	0.00	1,500.0	0.0	0.0	0.00	0.00	0.00	0.00	
2,307.8	0.00	0.00	2,307.8	0.0	0.0	0.00	0.00	0.00	0.00	
2,974.5	20.00	105.92	2,961.0	-31.6	110.8	3.00	3.00	0.00	105.92	
6,340.2	20.00	105.92	6,123.8	-347.4	1,217.7	0.00	0.00	0.00	0.00	
7,006.9	0.00	0.00	6,777.0	-379.0	1,328.5	3.00	-3.00	0.00	180.00	
7,906.9	90.00	0.00	7,350.0	194.0	1,328.5	10.00	10.00	0.00	0.00	
7,937.9	90.00	0.00	7,350.0	225.0	1,328.5	0.01	0.00	0.01	94.82	
17,193.9	90.00	0.00	7,350.0	9,481.0	1,329.0	0.00	0.00	0.00	0.00	Sligo Sweet Stout 8-6

# Planning Report

<b>Database:</b>	EDM	<b>Local Co-ordinate Reference:</b>	Well Sligo Sweet Stout 8-67-26-23C
<b>Company:</b>	Enerplus Resources (USA) Corporation	<b>TVD Reference:</b>	Well @ 5215.0usft
<b>Project:</b>	Weld County, CO	<b>MD Reference:</b>	Well @ 5215.0usft
<b>Site:</b>	SEC 26, T8N-R67W	<b>North Reference:</b>	True
<b>Well:</b>	Sligo Sweet Stout 8-67-26-23C	<b>Survey Calculation Method:</b>	Minimum Curvature
<b>Wellbore:</b>	Hz		
<b>Design:</b>	Plan 1		

Planned Survey									
Measured Depth (usft)	Inclination (°)	Azimuth (°)	Vertical Depth (usft)	+N/-S (usft)	+E/-W (usft)	Vertical Section (usft)	Dogleg Rate (°/100usft)	Build Rate (°/100usft)	Turn Rate (°/100usft)
0.0	0.00	0.00	0.0	0.0	0.0	0.0	0.00	0.00	0.00
100.0	0.00	0.00	100.0	0.0	0.0	0.0	0.00	0.00	0.00
200.0	0.00	0.00	200.0	0.0	0.0	0.0	0.00	0.00	0.00
300.0	0.00	0.00	300.0	0.0	0.0	0.0	0.00	0.00	0.00
400.0	0.00	0.00	400.0	0.0	0.0	0.0	0.00	0.00	0.00
500.0	0.00	0.00	500.0	0.0	0.0	0.0	0.00	0.00	0.00
600.0	0.00	0.00	600.0	0.0	0.0	0.0	0.00	0.00	0.00
700.0	0.00	0.00	700.0	0.0	0.0	0.0	0.00	0.00	0.00
800.0	0.00	0.00	800.0	0.0	0.0	0.0	0.00	0.00	0.00
900.0	0.00	0.00	900.0	0.0	0.0	0.0	0.00	0.00	0.00
1,000.0	0.00	0.00	1,000.0	0.0	0.0	0.0	0.00	0.00	0.00
1,100.0	0.00	0.00	1,100.0	0.0	0.0	0.0	0.00	0.00	0.00
1,200.0	0.00	0.00	1,200.0	0.0	0.0	0.0	0.00	0.00	0.00
1,300.0	0.00	0.00	1,300.0	0.0	0.0	0.0	0.00	0.00	0.00
1,400.0	0.00	0.00	1,400.0	0.0	0.0	0.0	0.00	0.00	0.00
1,500.0	0.00	0.00	1,500.0	0.0	0.0	0.0	0.00	0.00	0.00
9-5/8" - Surface									
1,600.0	0.00	0.00	1,600.0	0.0	0.0	0.0	0.00	0.00	0.00
1,700.0	0.00	0.00	1,700.0	0.0	0.0	0.0	0.00	0.00	0.00
1,800.0	0.00	0.00	1,800.0	0.0	0.0	0.0	0.00	0.00	0.00
1,900.0	0.00	0.00	1,900.0	0.0	0.0	0.0	0.00	0.00	0.00
2,000.0	0.00	0.00	2,000.0	0.0	0.0	0.0	0.00	0.00	0.00
2,100.0	0.00	0.00	2,100.0	0.0	0.0	0.0	0.00	0.00	0.00
2,200.0	0.00	0.00	2,200.0	0.0	0.0	0.0	0.00	0.00	0.00
2,300.0	0.00	0.00	2,300.0	0.0	0.0	0.0	0.00	0.00	0.00
2,307.8	0.00	0.00	2,307.8	0.0	0.0	0.0	0.00	0.00	0.00
Begin 3°/100' Nudge									
2,400.0	2.77	105.92	2,400.0	-0.6	2.1	-0.3	3.00	3.00	0.00
2,500.0	5.77	105.92	2,499.7	-2.7	9.3	-1.3	3.00	3.00	0.00
2,600.0	8.77	105.92	2,598.9	-6.1	21.4	-3.1	3.00	3.00	0.00
2,700.0	11.77	105.92	2,697.2	-11.0	38.6	-5.5	3.00	3.00	0.00
2,800.0	14.77	105.92	2,794.6	-17.3	60.6	-8.7	3.00	3.00	0.00
2,900.0	17.77	105.92	2,890.6	-25.0	87.6	-12.6	3.00	3.00	0.00
2,974.5	20.00	105.92	2,961.0	-31.6	110.8	-15.9	3.00	3.00	0.00
3,000.0	20.00	105.92	2,985.0	-34.0	119.1	-17.1	0.00	0.00	0.00
3,100.0	20.00	105.92	3,079.0	-43.4	152.0	-21.8	0.00	0.00	0.00
3,200.0	20.00	105.92	3,172.9	-52.8	184.9	-26.6	0.00	0.00	0.00
3,300.0	20.00	105.92	3,266.9	-62.1	217.8	-31.3	0.00	0.00	0.00
3,400.0	20.00	105.92	3,360.9	-71.5	250.7	-36.0	0.00	0.00	0.00
3,500.0	20.00	105.92	3,454.9	-80.9	283.6	-40.8	0.00	0.00	0.00
3,600.0	20.00	105.92	3,548.8	-90.3	316.5	-45.5	0.00	0.00	0.00
3,700.0	20.00	105.92	3,642.8	-99.7	349.4	-50.2	0.00	0.00	0.00
3,800.0	20.00	105.92	3,736.8	-109.1	382.3	-54.9	0.00	0.00	0.00
3,900.0	20.00	105.92	3,830.7	-118.4	415.2	-59.7	0.00	0.00	0.00
4,000.0	20.00	105.92	3,924.7	-127.8	448.0	-64.4	0.00	0.00	0.00
4,100.0	20.00	105.92	4,018.7	-137.2	480.9	-69.1	0.00	0.00	0.00
4,200.0	20.00	105.92	4,112.6	-146.6	513.8	-73.8	0.00	0.00	0.00
4,300.0	20.00	105.92	4,206.6	-156.0	546.7	-78.6	0.00	0.00	0.00
4,400.0	20.00	105.92	4,300.6	-165.4	579.6	-83.3	0.00	0.00	0.00
4,500.0	20.00	105.92	4,394.5	-174.7	612.5	-88.0	0.00	0.00	0.00
4,600.0	20.00	105.92	4,488.5	-184.1	645.4	-92.7	0.00	0.00	0.00
4,700.0	20.00	105.92	4,582.5	-193.5	678.3	-97.5	0.00	0.00	0.00
4,800.0	20.00	105.92	4,676.5	-202.9	711.2	-102.2	0.00	0.00	0.00
4,900.0	20.00	105.92	4,770.4	-212.3	744.1	-106.9	0.00	0.00	0.00

# Planning Report

<b>Database:</b>	EDM	<b>Local Co-ordinate Reference:</b>	Well Sligo Sweet Stout 8-67-26-23C
<b>Company:</b>	Enerplus Resources (USA) Corporation	<b>TVD Reference:</b>	Well @ 5215.0usft
<b>Project:</b>	Weld County, CO	<b>MD Reference:</b>	Well @ 5215.0usft
<b>Site:</b>	SEC 26, T8N-R67W	<b>North Reference:</b>	True
<b>Well:</b>	Sligo Sweet Stout 8-67-26-23C	<b>Survey Calculation Method:</b>	Minimum Curvature
<b>Wellbore:</b>	Hz		
<b>Design:</b>	Plan 1		

Planned Survey									
Measured Depth (usft)	Inclination (°)	Azimuth (°)	Vertical Depth (usft)	+N/-S (usft)	+E/-W (usft)	Vertical Section (usft)	Dogleg Rate (°/100usft)	Build Rate (°/100usft)	Turn Rate (°/100usft)
5,000.0	20.00	105.92	4,864.4	-221.6	776.9	-111.6	0.00	0.00	0.00
5,100.0	20.00	105.92	4,958.4	-231.0	809.8	-116.4	0.00	0.00	0.00
5,200.0	20.00	105.92	5,052.3	-240.4	842.7	-121.1	0.00	0.00	0.00
5,300.0	20.00	105.92	5,146.3	-249.8	875.6	-125.8	0.00	0.00	0.00
5,400.0	20.00	105.92	5,240.3	-259.2	908.5	-130.6	0.00	0.00	0.00
5,500.0	20.00	105.92	5,334.2	-268.6	941.4	-135.3	0.00	0.00	0.00
5,600.0	20.00	105.92	5,428.2	-277.9	974.3	-140.0	0.00	0.00	0.00
5,700.0	20.00	105.92	5,522.2	-287.3	1,007.2	-144.7	0.00	0.00	0.00
5,800.0	20.00	105.92	5,616.1	-296.7	1,040.1	-149.5	0.00	0.00	0.00
5,900.0	20.00	105.92	5,710.1	-306.1	1,073.0	-154.2	0.00	0.00	0.00
6,000.0	20.00	105.92	5,804.1	-315.5	1,105.8	-158.9	0.00	0.00	0.00
6,100.0	20.00	105.92	5,898.1	-324.9	1,138.7	-163.6	0.00	0.00	0.00
6,200.0	20.00	105.92	5,992.0	-334.2	1,171.6	-168.4	0.00	0.00	0.00
6,300.0	20.00	105.92	6,086.0	-343.6	1,204.5	-173.1	0.00	0.00	0.00
6,340.2	20.00	105.92	6,123.8	-347.4	1,217.7	-175.0	0.00	0.00	0.00
6,400.0	18.21	105.92	6,180.3	-352.8	1,236.6	-177.7	3.00	-3.00	0.00
6,500.0	15.21	105.92	6,276.0	-360.7	1,264.2	-181.7	3.00	-3.00	0.00
6,600.0	12.21	105.92	6,373.2	-367.2	1,287.0	-184.9	3.00	-3.00	0.00
6,700.0	9.21	105.92	6,471.4	-372.3	1,304.8	-187.5	3.00	-3.00	0.00
6,800.0	6.21	105.92	6,570.5	-375.9	1,317.7	-189.4	3.00	-3.00	0.00
6,900.0	3.21	105.92	6,670.2	-378.2	1,325.6	-190.5	3.00	-3.00	0.00
7,000.0	0.21	105.92	6,770.1	-379.0	1,328.5	-190.9	3.00	-3.00	0.00
7,006.9	0.00	0.00	6,777.0	-379.0	1,328.5	-190.9	3.00	-3.00	0.00
Start 10°/100' Build									
7,100.0	9.31	0.00	6,869.7	-371.5	1,328.5	-183.4	10.00	10.00	0.00
7,200.0	19.31	0.00	6,966.5	-346.8	1,328.5	-159.0	10.00	10.00	0.00
7,300.0	29.31	0.00	7,057.5	-305.6	1,328.5	-118.3	10.00	10.00	0.00
7,400.0	39.31	0.00	7,140.0	-249.4	1,328.5	-62.5	10.00	10.00	0.00
7,500.0	49.31	0.00	7,211.5	-179.6	1,328.5	6.6	10.00	10.00	0.00
7,600.0	59.31	0.00	7,269.7	-98.5	1,328.5	86.9	10.00	10.00	0.00
7,700.0	69.31	0.00	7,313.0	-8.5	1,328.5	176.0	10.00	10.00	0.00
7,800.0	79.31	0.00	7,340.0	87.7	1,328.5	271.3	10.00	10.00	0.00
7,900.0	89.31	0.00	7,349.9	187.1	1,328.5	369.7	10.00	10.00	0.00
7,906.9	90.00	0.00	7,350.0	194.0	1,328.5	376.5	10.00	10.00	0.00
7,937.9	90.00	0.00	7,350.0	225.0	1,328.5	407.2	0.01	0.00	0.01
7,950.0	90.00	0.00	7,350.0	237.1	1,328.5	419.2	0.00	0.00	0.00
7" - 666' FSL & 650' FEL - Intermediate									
8,000.0	90.00	0.00	7,350.0	287.1	1,328.5	468.7	0.00	0.00	0.00
8,100.0	90.00	0.00	7,350.0	387.1	1,328.5	567.7	0.00	0.00	0.00
8,200.0	90.00	0.00	7,350.0	487.1	1,328.5	666.8	0.00	0.00	0.00
8,300.0	90.00	0.00	7,350.0	587.1	1,328.5	765.8	0.00	0.00	0.00
8,400.0	90.00	0.00	7,350.0	687.1	1,328.5	864.8	0.00	0.00	0.00
8,500.0	90.00	0.00	7,350.0	787.1	1,328.5	963.9	0.00	0.00	0.00
8,600.0	90.00	0.00	7,350.0	887.1	1,328.5	1,062.9	0.00	0.00	0.00
8,700.0	90.00	0.00	7,350.0	987.1	1,328.5	1,161.9	0.00	0.00	0.00
8,800.0	90.00	0.00	7,350.0	1,087.1	1,328.5	1,261.0	0.00	0.00	0.00
8,900.0	90.00	0.00	7,350.0	1,187.1	1,328.6	1,360.0	0.00	0.00	0.00
9,000.0	90.00	0.00	7,350.0	1,287.1	1,328.6	1,459.0	0.00	0.00	0.00
9,100.0	90.00	0.00	7,350.0	1,387.1	1,328.6	1,558.1	0.00	0.00	0.00
9,200.0	90.00	0.00	7,350.0	1,487.1	1,328.6	1,657.1	0.00	0.00	0.00
9,300.0	90.00	0.00	7,350.0	1,587.1	1,328.6	1,756.1	0.00	0.00	0.00
9,400.0	90.00	0.00	7,350.0	1,687.1	1,328.6	1,855.2	0.00	0.00	0.00
9,500.0	90.00	0.00	7,350.0	1,787.1	1,328.6	1,954.2	0.00	0.00	0.00
9,600.0	90.00	0.00	7,350.0	1,887.1	1,328.6	2,053.2	0.00	0.00	0.00

## Planning Report

<b>Database:</b>	EDM	<b>Local Co-ordinate Reference:</b>	Well Sligo Sweet Stout 8-67-26-23C
<b>Company:</b>	Enerplus Resources (USA) Corporation	<b>TVD Reference:</b>	Well @ 5215.0usft
<b>Project:</b>	Weld County, CO	<b>MD Reference:</b>	Well @ 5215.0usft
<b>Site:</b>	SEC 26, T8N-R67W	<b>North Reference:</b>	True
<b>Well:</b>	Sligo Sweet Stout 8-67-26-23C	<b>Survey Calculation Method:</b>	Minimum Curvature
<b>Wellbore:</b>	Hz		
<b>Design:</b>	Plan 1		

Planned Survey									
Measured Depth (usft)	Inclination (°)	Azimuth (°)	Vertical Depth (usft)	+N/-S (usft)	+E/-W (usft)	Vertical Section (usft)	Dogleg Rate (°/100usft)	Build Rate (°/100usft)	Turn Rate (°/100usft)
9,700.0	90.00	0.00	7,350.0	1,987.1	1,328.6	2,152.3	0.00	0.00	0.00
9,800.0	90.00	0.00	7,350.0	2,087.1	1,328.6	2,251.3	0.00	0.00	0.00
9,900.0	90.00	0.00	7,350.0	2,187.1	1,328.6	2,350.3	0.00	0.00	0.00
10,000.0	90.00	0.00	7,350.0	2,287.1	1,328.6	2,449.4	0.00	0.00	0.00
10,100.0	90.00	0.00	7,350.0	2,387.1	1,328.6	2,548.4	0.00	0.00	0.00
10,200.0	90.00	0.00	7,350.0	2,487.1	1,328.6	2,647.4	0.00	0.00	0.00
10,300.0	90.00	0.00	7,350.0	2,587.1	1,328.6	2,746.5	0.00	0.00	0.00
10,400.0	90.00	0.00	7,350.0	2,687.1	1,328.6	2,845.5	0.00	0.00	0.00
10,500.0	90.00	0.00	7,350.0	2,787.1	1,328.6	2,944.5	0.00	0.00	0.00
10,600.0	90.00	0.00	7,350.0	2,887.1	1,328.6	3,043.6	0.00	0.00	0.00
10,700.0	90.00	0.00	7,350.0	2,987.1	1,328.6	3,142.6	0.00	0.00	0.00
10,800.0	90.00	0.00	7,350.0	3,087.1	1,328.7	3,241.6	0.00	0.00	0.00
10,900.0	90.00	0.00	7,350.0	3,187.1	1,328.7	3,340.7	0.00	0.00	0.00
11,000.0	90.00	0.00	7,350.0	3,287.1	1,328.7	3,439.7	0.00	0.00	0.00
11,100.0	90.00	0.00	7,350.0	3,387.1	1,328.7	3,538.7	0.00	0.00	0.00
11,200.0	90.00	0.00	7,350.0	3,487.1	1,328.7	3,637.7	0.00	0.00	0.00
11,300.0	90.00	0.00	7,350.0	3,587.1	1,328.7	3,736.8	0.00	0.00	0.00
11,400.0	90.00	0.00	7,350.0	3,687.1	1,328.7	3,835.8	0.00	0.00	0.00
11,500.0	90.00	0.00	7,350.0	3,787.1	1,328.7	3,934.8	0.00	0.00	0.00
11,600.0	90.00	0.00	7,350.0	3,887.1	1,328.7	4,033.9	0.00	0.00	0.00
11,700.0	90.00	0.00	7,350.0	3,987.1	1,328.7	4,132.9	0.00	0.00	0.00
11,800.0	90.00	0.00	7,350.0	4,087.1	1,328.7	4,231.9	0.00	0.00	0.00
11,900.0	90.00	0.00	7,350.0	4,187.1	1,328.7	4,331.0	0.00	0.00	0.00
12,000.0	90.00	0.00	7,350.0	4,287.1	1,328.7	4,430.0	0.00	0.00	0.00
12,100.0	90.00	0.00	7,350.0	4,387.1	1,328.7	4,529.0	0.00	0.00	0.00
12,200.0	90.00	0.00	7,350.0	4,487.1	1,328.7	4,628.1	0.00	0.00	0.00
12,300.0	90.00	0.00	7,350.0	4,587.1	1,328.7	4,727.1	0.00	0.00	0.00
12,400.0	90.00	0.00	7,350.0	4,687.1	1,328.7	4,826.1	0.00	0.00	0.00
12,500.0	90.00	0.00	7,350.0	4,787.1	1,328.7	4,925.2	0.00	0.00	0.00
12,600.0	90.00	0.00	7,350.0	4,887.1	1,328.8	5,024.2	0.00	0.00	0.00
12,700.0	90.00	0.00	7,350.0	4,987.1	1,328.8	5,123.2	0.00	0.00	0.00
12,800.0	90.00	0.00	7,350.0	5,087.1	1,328.8	5,222.3	0.00	0.00	0.00
12,900.0	90.00	0.00	7,350.0	5,187.1	1,328.8	5,321.3	0.00	0.00	0.00
13,000.0	90.00	0.00	7,350.0	5,287.1	1,328.8	5,420.3	0.00	0.00	0.00
13,100.0	90.00	0.00	7,350.0	5,387.1	1,328.8	5,519.4	0.00	0.00	0.00
13,200.0	90.00	0.00	7,350.0	5,487.1	1,328.8	5,618.4	0.00	0.00	0.00
13,300.0	90.00	0.00	7,350.0	5,587.1	1,328.8	5,717.4	0.00	0.00	0.00
13,400.0	90.00	0.00	7,350.0	5,687.1	1,328.8	5,816.5	0.00	0.00	0.00
13,500.0	90.00	0.00	7,350.0	5,787.1	1,328.8	5,915.5	0.00	0.00	0.00
13,600.0	90.00	0.00	7,350.0	5,887.1	1,328.8	6,014.5	0.00	0.00	0.00
13,700.0	90.00	0.00	7,350.0	5,987.1	1,328.8	6,113.6	0.00	0.00	0.00
13,800.0	90.00	0.00	7,350.0	6,087.1	1,328.8	6,212.6	0.00	0.00	0.00
13,900.0	90.00	0.00	7,350.0	6,187.1	1,328.8	6,311.6	0.00	0.00	0.00
14,000.0	90.00	0.00	7,350.0	6,287.1	1,328.8	6,410.7	0.00	0.00	0.00
14,100.0	90.00	0.00	7,350.0	6,387.1	1,328.8	6,509.7	0.00	0.00	0.00
14,200.0	90.00	0.00	7,350.0	6,487.1	1,328.8	6,608.7	0.00	0.00	0.00
14,300.0	90.00	0.00	7,350.0	6,587.1	1,328.8	6,707.8	0.00	0.00	0.00
14,400.0	90.00	0.00	7,350.0	6,687.1	1,328.8	6,806.8	0.00	0.00	0.00
14,500.0	90.00	0.00	7,350.0	6,787.1	1,328.9	6,905.8	0.00	0.00	0.00
14,600.0	90.00	0.00	7,350.0	6,887.1	1,328.9	7,004.9	0.00	0.00	0.00
14,700.0	90.00	0.00	7,350.0	6,987.1	1,328.9	7,103.9	0.00	0.00	0.00
14,800.0	90.00	0.00	7,350.0	7,087.1	1,328.9	7,202.9	0.00	0.00	0.00
14,900.0	90.00	0.00	7,350.0	7,187.1	1,328.9	7,302.0	0.00	0.00	0.00
15,000.0	90.00	0.00	7,350.0	7,287.1	1,328.9	7,401.0	0.00	0.00	0.00

## Planning Report

<b>Database:</b>	EDM	<b>Local Co-ordinate Reference:</b>	Well Sligo Sweet Stout 8-67-26-23C
<b>Company:</b>	Enerplus Resources (USA) Corporation	<b>TVD Reference:</b>	Well @ 5215.0usft
<b>Project:</b>	Weld County, CO	<b>MD Reference:</b>	Well @ 5215.0usft
<b>Site:</b>	SEC 26, T8N-R67W	<b>North Reference:</b>	True
<b>Well:</b>	Sligo Sweet Stout 8-67-26-23C	<b>Survey Calculation Method:</b>	Minimum Curvature
<b>Wellbore:</b>	Hz		
<b>Design:</b>	Plan 1		

Planned Survey										
Measured Depth (usft)	Inclination (°)	Azimuth (°)	Vertical Depth (usft)	+N/-S (usft)	+E/-W (usft)	Vertical Section (usft)	Dogleg Rate (°/100usft)	Build Rate (°/100usft)	Turn Rate (°/100usft)	
15,100.0	90.00	0.00	7,350.0	7,387.1	1,328.9	7,500.0	0.00	0.00	0.00	
15,200.0	90.00	0.00	7,350.0	7,487.1	1,328.9	7,599.1	0.00	0.00	0.00	
15,300.0	90.00	0.00	7,350.0	7,587.1	1,328.9	7,698.1	0.00	0.00	0.00	
15,400.0	90.00	0.00	7,350.0	7,687.1	1,328.9	7,797.1	0.00	0.00	0.00	
15,500.0	90.00	0.00	7,350.0	7,787.1	1,328.9	7,896.1	0.00	0.00	0.00	
15,600.0	90.00	0.00	7,350.0	7,887.1	1,328.9	7,995.2	0.00	0.00	0.00	
15,700.0	90.00	0.00	7,350.0	7,987.1	1,328.9	8,094.2	0.00	0.00	0.00	
15,800.0	90.00	0.00	7,350.0	8,087.1	1,328.9	8,193.2	0.00	0.00	0.00	
15,900.0	90.00	0.00	7,350.0	8,187.1	1,328.9	8,292.3	0.00	0.00	0.00	
16,000.0	90.00	0.00	7,350.0	8,287.1	1,328.9	8,391.3	0.00	0.00	0.00	
16,100.0	90.00	0.00	7,350.0	8,387.1	1,328.9	8,490.3	0.00	0.00	0.00	
16,200.0	90.00	0.00	7,350.0	8,487.1	1,328.9	8,589.4	0.00	0.00	0.00	
16,300.0	90.00	0.00	7,350.0	8,587.1	1,329.0	8,688.4	0.00	0.00	0.00	
16,400.0	90.00	0.00	7,350.0	8,687.1	1,329.0	8,787.4	0.00	0.00	0.00	
16,500.0	90.00	0.00	7,350.0	8,787.1	1,329.0	8,886.5	0.00	0.00	0.00	
16,600.0	90.00	0.00	7,350.0	8,887.1	1,329.0	8,985.5	0.00	0.00	0.00	
16,700.0	90.00	0.00	7,350.0	8,987.1	1,329.0	9,084.5	0.00	0.00	0.00	
16,800.0	90.00	0.00	7,350.0	9,087.1	1,329.0	9,183.6	0.00	0.00	0.00	
16,900.0	90.00	0.00	7,350.0	9,187.1	1,329.0	9,282.6	0.00	0.00	0.00	
17,000.0	90.00	0.00	7,350.0	9,287.1	1,329.0	9,381.6	0.00	0.00	0.00	
17,100.0	90.00	0.00	7,350.0	9,387.1	1,329.0	9,480.7	0.00	0.00	0.00	
17,193.9	90.00	0.00	7,350.0	9,481.0	1,329.0	9,573.7	0.00	0.00	0.00	
Total Depth - Sligo Sweet Stout 8-67-26-23C										

Design Targets										
Target Name	Dip Angle (°)	Dip Dir. (°)	TVD (usft)	+N/-S (usft)	+E/-W (usft)	Northing (usft)	Easting (usft)	Latitude	Longitude	
- hit/miss target										
- Shape										
Sligo Sweet Stout 8-67-26-23C	0.00	0.00	7,350.0	9,481.0	1,329.0	1,481,202.17	3,179,553.04	40° 39' 8.988 N	104° 51' 10.416 W	
- plan hits target center										
- Point										

Casing Points						
Measured Depth (usft)	Vertical Depth (usft)	Name	Casing Diameter (")	Hole Diameter (")		
1,500.0	1,500.0	Surface	9-5/8	9-5/8		
7,950.0	7,350.0	Intermediate	7	7		

Plan Annotations					
Measured Depth (usft)	Vertical Depth (usft)	+N/-S (usft)	+E/-W (usft)	Comment	
1,500.0	1,500.0	0.0	0.0	9-5/8"	
2,307.8	2,307.8	0.0	0.0	Begin 3°/100' Nudge	
7,006.9	6,777.0	-379.0	1,328.5	Start 10°/100' Build	
7,950.0	7,350.0	237.1	1,328.5	7" - 666' FSL & 650' FEL	
17,193.9	7,350.0	9,481.0	1,329.0	Total Depth	