

BAYSWATER E & P LLC

Location: COLORADO Slot: SLOT#03 THORNTON I-29-30HN (1674'FNL & 355'FWL SEC 28)
Field: WELD COUNTY (NAD83/TRUE NORTH) Well: THORNTON I-29-30HN
Facility: SEC.28-T07N-R66W Wellbore: THORNTON I-29-30HN PWB

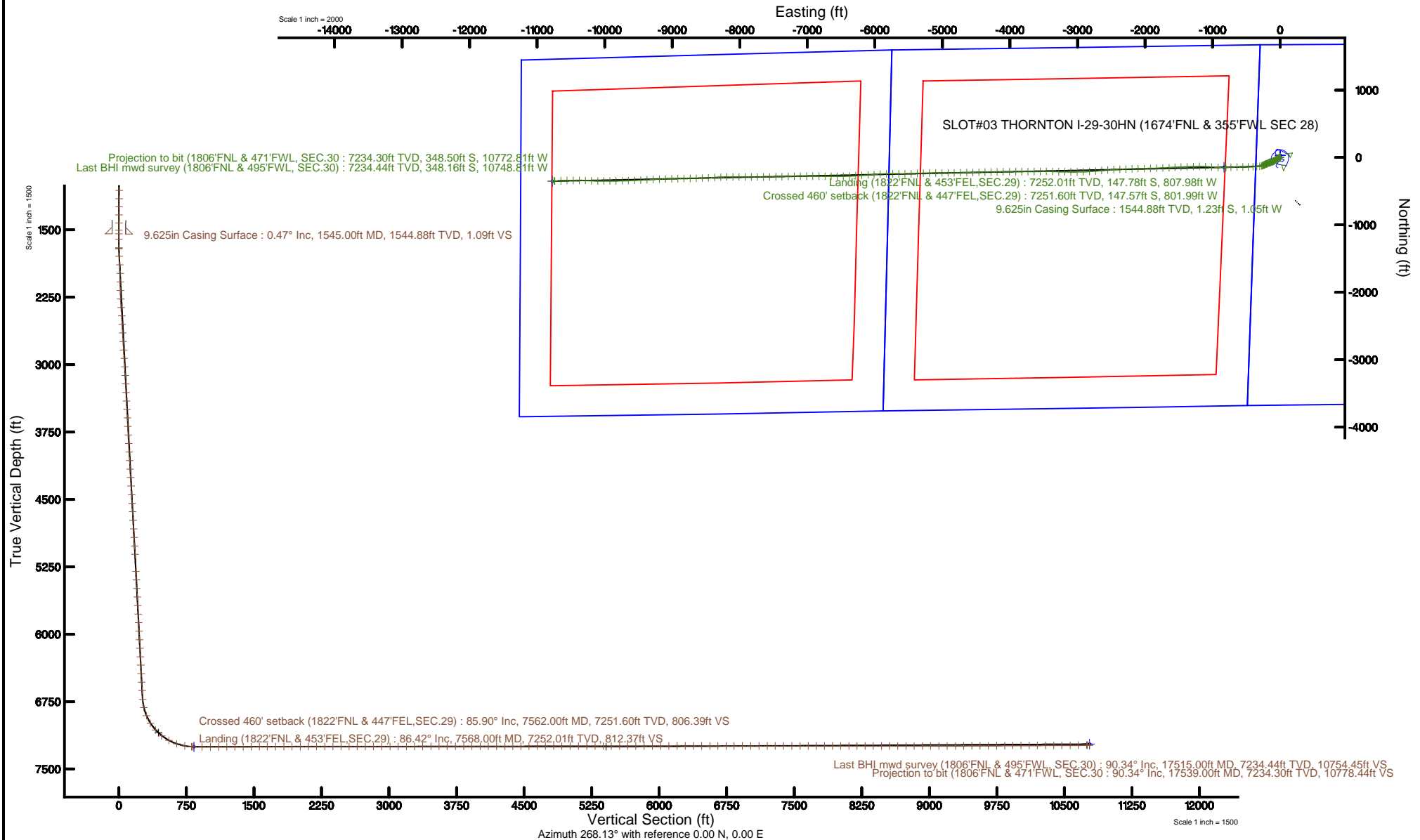

| | |
|--|--|
| Plot reference wellpath is THORNTON I-29-30HN REV-C.0 PWP | Grid System: NAD83 / Lambert Colorado SP, Northern Zone (501), US feet |
| True vertical depths are referenced to XTREME 18 (17) (RKB) | * = Wellpath was transformed from a different geodetic datum |
| Measured depths are referenced to XTREME 18 (17) (RKB) | North Reference: True north |
| XTREME 18 (17) (RKB) to Mean Sea Level: 4923 feet | Scale: True distance |
| Mean Sea Level to Mud line (At Slot: SLOT#03 THORNTON I-29-30HN (1674'FNL & 355'FWL SEC 28)): 0 feet | Depths are in feet |
| Coordinates are in feet referenced to Slot | Created by: cookdannm on 2017-01-17 |
| | Database: WA_DEN_Denver_Defn |



Actual Wellpath Report

THORNTON I-29-30HN AWP

Page 1 of 10



REFERENCE WELLPATH IDENTIFICATION

| | | | |
|----------|--------------------------------|----------|--|
| Operator | BAYSWATER E & P LLC | Slot | SLOT#03 THORNTON I-29-30HN (1674'FNL & 355'FWL SEC 28) |
| Area | COLORADO | Well | THORNTON I-29-30HN |
| Field | WELD COUNTY (NAD83/TRUE NORTH) | Wellbore | THORNTON I-29-30HN AWP |
| Facility | SEC.28-T07N-R66W | | |

REPORT SETUP INFORMATION

| | | | |
|---------------------|---|----------------------|---|
| Projection System | NAD83 / Lambert Colorado SP, Northern Zone (501), US feet | Software System | WellArchitect® 5.0 |
| North Reference | True | User | Cookdanm |
| Scale | 0.999970 | Report Generated | 1/17/17 at 2:32:45 PM |
| Convergence at slot | 0.46° East | Database/Source file | WA_DEN_Denver_Defn/THORNTON_I-29-30HN_AWP.xml |

WELLPATH LOCATION

| | Local coordinates | | Grid coordinates | | Geographic coordinates | |
|-----------------------|-------------------|----------|------------------|-----------------|------------------------|-----------------|
| | North[ft] | East[ft] | Easting[US ft] | Northing[US ft] | Latitude | Longitude |
| Slot Location | -29.85 | -1.16 | 3196880.94 | 1443461.19 | 40°32'54.751"N | 104°47'29.519"W |
| Facility Reference Pt | | | 3196881.86 | 1443491.05 | 40°32'55.046"N | 104°47'29.504"W |
| Field Reference Pt | | | 3174587.00 | 1430859.75 | 40°30'51.890"N | 104°52'19.470"W |

WELLPATH DATUM

| | | | |
|--------------------------|-----------------------|--|-------------------|
| Calculation method | Minimum curvature | XTREME 18 (17') (RKB) to Facility Vertical Datum | 4923.00ft |
| Horizontal Reference Pt | Slot | XTREME 18 (17') (RKB) to Mean Sea Level | 4923.00ft |
| Vertical Reference Pt | XTREME 18 (17') (RKB) | XTREME 18 (17') (RKB) to Mud Line at Slot (SLOT#03 THORNTON I-29-30HN (1674'FNL & 355'FWL SEC 28)) | 4923.00ft |
| MD Reference Pt | XTREME 18 (17') (RKB) | Section Origin | N 0.00, E 0.00 ft |
| Field Vertical Reference | Mean Sea Level | Section Azimuth | 268.13° |

Actual Wellpath Report

THORNTON I-29-30HN AWP

Page 2 of 10



| REFERENCE WELLPATH IDENTIFICATION | | | |
|-----------------------------------|--------------------------------|----------|--|
| Operator | BAYSWATER E & P LLC | Slot | SLOT#03 THORNTON I-29-30HN (1674'FNL & 355'FWL SEC 28) |
| Area | COLORADO | Well | THORNTON I-29-30HN |
| Field | WELD COUNTY (NAD83/TRUE NORTH) | Wellbore | THORNTON I-29-30HN AWP |
| Facility | SEC.28-T07N-R66W | | |

| WELLPATH DATA (194 stations) † = interpolated/extrapolated station | | | | | | | | |
|--|--------------------|----------------|-------------|-------------------|---------------|--------------|------------------|----------|
| MD [ft] | Inclination [°] | Azimuth [°] | TVD [ft] | Vert Sect [ft] | North [ft] | East [ft] | DLS [°/100ft] | Comments |
| 0.00† | 0.000 | 32.420 | 0.00 | 0.00 | 0.00 | 0.00 | 0.00 | |
| 17.00 | 0.000 | 32.420 | 17.00 | 0.00 | 0.00 | 0.00 | 0.00 | |
| 145.00 | 0.700 | 32.420 | 145.00 | -0.44 | 0.66 | 0.42 | 0.55 | |
| 236.00 | 0.960 | 347.690 | 235.99 | -0.62 | 1.87 | 0.55 | 0.74 | |
| 329.00 | 0.940 | 295.290 | 328.98 | 0.20 | 2.96 | -0.30 | 0.90 | |
| 421.00 | 0.770 | 327.660 | 420.97 | 1.19 | 3.81 | -1.31 | 0.55 | |
| 513.00 | 0.810 | 203.190 | 512.96 | 1.78 | 3.73 | -1.90 | 1.52 | |
| 605.00 | 1.310 | 208.760 | 604.95 | 2.59 | 2.21 | -2.66 | 0.55 | |
| 696.00 | 0.610 | 239.360 | 695.93 | 3.54 | 1.05 | -3.58 | 0.93 | |
| 788.00 | 0.830 | 251.700 | 787.93 | 4.61 | 0.59 | -4.63 | 0.29 | |
| 879.00 | 0.600 | 246.930 | 878.92 | 5.69 | 0.20 | -5.70 | 0.26 | |
| 971.00 | 0.030 | 120.950 | 970.92 | 6.12 | 0.00 | -6.12 | 0.67 | |
| 1062.00 | 0.700 | 66.600 | 1061.92 | 5.58 | 0.21 | -5.59 | 0.75 | |
| 1154.00 | 1.120 | 78.530 | 1153.90 | 4.17 | 0.61 | -4.19 | 0.50 | |
| 1244.00 | 0.640 | 123.590 | 1243.89 | 2.89 | 0.51 | -2.91 | 0.90 | |
| 1335.00 | 0.460 | 143.650 | 1334.89 | 2.27 | -0.07 | -2.27 | 0.29 | |
| 1424.00 | 0.380 | 139.540 | 1423.89 | 1.89 | -0.58 | -1.87 | 0.10 | |
| 1503.00 | 0.590 | 127.020 | 1502.88 | 1.41 | -1.03 | -1.37 | 0.30 | |
| 1604.00 | 0.350 | 92.530 | 1603.88 | 0.70 | -1.35 | -0.65 | 0.36 | |
| 1699.00 | 1.390 | 313.120 | 1698.87 | 1.22 | -0.58 | -1.20 | 1.76 | |
| 1794.00 | 3.830 | 315.610 | 1793.77 | 4.18 | 2.48 | -4.26 | 2.57 | |
| 1889.00 | 4.780 | 269.730 | 1888.53 | 10.28 | 4.73 | -10.44 | 3.65 | |
| 1984.00 | 4.450 | 193.490 | 1983.30 | 15.22 | 1.12 | -15.27 | 6.00 | |
| 2079.00 | 3.230 | 175.890 | 2078.08 | 16.09 | -5.13 | -15.93 | 1.77 | |
| 2175.00 | 3.280 | 213.230 | 2173.94 | 17.57 | -10.13 | -17.24 | 2.17 | |
| 2270.00 | 3.240 | 242.000 | 2268.79 | 21.54 | -13.66 | -21.10 | 1.70 | |
| 2365.00 | 3.640 | 254.160 | 2363.62 | 26.88 | -15.75 | -26.38 | 0.87 | |
| 2459.00 | 3.710 | 255.440 | 2457.43 | 32.74 | -17.32 | -32.19 | 0.11 | |
| 2554.00 | 3.620 | 239.180 | 2552.24 | 38.36 | -19.63 | -37.74 | 1.09 | |
| 2649.00 | 3.640 | 238.020 | 2647.05 | 43.60 | -22.77 | -42.87 | 0.08 | |

Actual Wellpath Report

THORNTON I-29-30HN AWP

Page 3 of 10



| REFERENCE WELLPATH IDENTIFICATION | | | |
|-----------------------------------|--------------------------------|----------|--|
| Operator | BAYSWATER E & P LLC | Slot | SLOT#03 THORNTON I-29-30HN (1674'FNL & 355'FWL SEC 28) |
| Area | COLORADO | Well | THORNTON I-29-30HN |
| Field | WELD COUNTY (NAD83/TRUE NORTH) | Wellbore | THORNTON I-29-30HN AWB |
| Facility | SEC.28-T07N-R66W | | |

| WELLPATH DATA (194 stations) | | | | | | | | |
|------------------------------|--------------------|----------------|-------------|-------------------|---------------|--------------|------------------|----------|
| MD [ft] | Inclination [°] | Azimuth [°] | TVD [ft] | Vert Sect [ft] | North [ft] | East [ft] | DLS [°/100ft] | Comments |
| 2744.00 | 3.730 | 238.870 | 2741.85 | 48.90 | -25.96 | -48.08 | 0.11 | |
| 2839.00 | 3.830 | 239.320 | 2836.64 | 54.38 | -29.18 | -53.45 | 0.11 | |
| 2933.00 | 3.740 | 244.540 | 2930.44 | 59.94 | -32.10 | -58.92 | 0.38 | |
| 3028.00 | 3.750 | 255.440 | 3025.24 | 65.81 | -34.21 | -64.72 | 0.75 | |
| 3123.00 | 3.650 | 246.110 | 3120.04 | 71.64 | -36.22 | -70.50 | 0.64 | |
| 3218.00 | 3.790 | 230.260 | 3214.84 | 76.92 | -39.45 | -75.67 | 1.09 | |
| 3312.00 | 3.790 | 218.290 | 3308.64 | 81.38 | -43.87 | -79.99 | 0.84 | |
| 3407.00 | 3.230 | 229.390 | 3403.46 | 85.49 | -48.08 | -83.97 | 0.92 | |
| 3501.00 | 3.370 | 251.130 | 3497.31 | 90.20 | -50.70 | -88.59 | 1.33 | |
| 3597.00 | 3.250 | 254.980 | 3593.15 | 95.55 | -52.32 | -93.89 | 0.26 | |
| 3692.00 | 3.270 | 239.610 | 3688.00 | 100.55 | -54.38 | -98.83 | 0.92 | |
| 3787.00 | 3.360 | 233.260 | 3782.84 | 105.22 | -57.42 | -103.40 | 0.40 | |
| 3882.00 | 3.310 | 249.830 | 3877.68 | 110.10 | -60.03 | -108.20 | 1.01 | |
| 3976.00 | 3.300 | 269.400 | 3971.53 | 115.39 | -60.99 | -113.45 | 1.19 | |
| 4071.00 | 3.130 | 263.470 | 4066.38 | 120.70 | -61.32 | -118.76 | 0.39 | |
| 4166.00 | 3.400 | 251.950 | 4161.22 | 126.00 | -62.49 | -124.02 | 0.75 | |
| 4261.00 | 3.810 | 240.410 | 4256.04 | 131.49 | -64.92 | -129.44 | 0.88 | |
| 4356.00 | 3.810 | 235.830 | 4350.83 | 136.96 | -68.25 | -134.80 | 0.32 | |
| 4452.00 | 3.850 | 242.660 | 4446.61 | 142.56 | -71.52 | -140.30 | 0.48 | |
| 4548.00 | 3.730 | 246.500 | 4542.40 | 148.38 | -74.25 | -146.03 | 0.29 | |
| 4642.00 | 3.380 | 255.100 | 4636.22 | 153.92 | -76.18 | -151.51 | 0.68 | |
| 4738.00 | 3.260 | 258.930 | 4732.06 | 159.37 | -77.43 | -156.92 | 0.26 | |
| 4833.00 | 3.400 | 263.620 | 4826.90 | 164.84 | -78.26 | -162.37 | 0.32 | |
| 4928.00 | 3.360 | 254.880 | 4921.74 | 170.36 | -79.30 | -167.86 | 0.54 | |
| 5023.00 | 3.460 | 249.670 | 5016.57 | 175.79 | -81.02 | -173.24 | 0.34 | |
| 5118.00 | 3.450 | 242.130 | 5111.40 | 181.08 | -83.35 | -178.45 | 0.48 | |
| 5308.00 | 3.290 | 243.210 | 5301.07 | 191.16 | -88.48 | -188.37 | 0.09 | |
| 5403.00 | 3.300 | 240.950 | 5395.91 | 196.07 | -91.04 | -193.20 | 0.14 | |
| 5498.00 | 3.240 | 245.210 | 5490.76 | 200.97 | -93.49 | -198.02 | 0.26 | |
| 5593.00 | 3.210 | 264.130 | 5585.61 | 206.10 | -94.89 | -203.11 | 1.12 | |

Actual Wellpath Report

THORNTON I-29-30HN AWP

Page 4 of 10



| REFERENCE WELLPATH IDENTIFICATION | | | |
|-----------------------------------|--------------------------------|----------|--|
| Operator | BAYSWATER E & P LLC | Slot | SLOT#03 THORNTON I-29-30HN (1674'FNL & 355'FWL SEC 28) |
| Area | COLORADO | Well | THORNTON I-29-30HN |
| Field | WELD COUNTY (NAD83/TRUE NORTH) | Wellbore | THORNTON I-29-30HN AWB |
| Facility | SEC.28-T07N-R66W | | |

| WELLPATH DATA (194 stations) † = interpolated/extrapolated station | | | | | | | | |
|--|--------------------|----------------|-------------|-------------------|---------------|--------------|------------------|---|
| MD [ft] | Inclination [°] | Azimuth [°] | TVD [ft] | Vert Sect [ft] | North [ft] | East [ft] | DLS [°/100ft] | Comments |
| 5688.00 | 3.030 | 266.120 | 5680.47 | 211.26 | -95.33 | -208.26 | 0.22 | |
| 5783.00 | 3.180 | 246.330 | 5775.33 | 216.22 | -96.56 | -213.18 | 1.13 | |
| 5878.00 | 3.270 | 232.190 | 5870.18 | 220.86 | -99.28 | -217.73 | 0.84 | |
| 5973.00 | 3.210 | 227.780 | 5965.03 | 225.08 | -102.73 | -221.84 | 0.27 | |
| 6069.00 | 3.180 | 235.640 | 6060.88 | 229.37 | -106.04 | -226.03 | 0.46 | |
| 6164.00 | 3.220 | 247.490 | 6155.73 | 234.09 | -108.55 | -230.67 | 0.70 | |
| 6259.00 | 3.220 | 251.150 | 6250.58 | 239.14 | -110.43 | -235.66 | 0.22 | |
| 6353.00 | 3.230 | 251.100 | 6344.44 | 244.20 | -112.14 | -240.66 | 0.01 | |
| 6447.00 | 3.300 | 250.300 | 6438.28 | 249.31 | -113.91 | -245.72 | 0.09 | |
| 6542.00 | 3.300 | 241.950 | 6533.13 | 254.36 | -116.12 | -250.70 | 0.51 | |
| 6636.00 | 3.360 | 240.530 | 6626.97 | 259.23 | -118.75 | -255.49 | 0.11 | |
| 6732.00 | 4.470 | 250.490 | 6722.74 | 265.29 | -121.38 | -261.46 | 1.35 | |
| 6826.00 | 12.480 | 254.400 | 6815.64 | 278.67 | -125.34 | -274.72 | 8.54 | |
| 6921.00 | 22.530 | 263.820 | 6906.14 | 306.87 | -130.07 | -302.78 | 10.96 | |
| 7016.00 | 31.820 | 266.070 | 6990.57 | 350.14 | -133.76 | -345.96 | 9.84 | |
| 7111.00 | 42.120 | 266.030 | 7066.36 | 407.16 | -137.69 | -402.88 | 10.84 | |
| 7205.00 | 52.490 | 269.290 | 7130.03 | 476.13 | -140.34 | -471.80 | 11.32 | |
| 7300.00 | 62.110 | 270.060 | 7181.29 | 555.95 | -140.77 | -551.65 | 10.15 | |
| 7394.00 | 71.230 | 268.490 | 7218.48 | 642.16 | -141.90 | -637.86 | 9.82 | |
| 7488.00 | 79.500 | 267.780 | 7242.21 | 733.03 | -144.87 | -728.68 | 8.83 | |
| 7562.00† | 85.903 | 267.991 | 7251.60 | 806.39 | -147.57 | -801.99 | 8.66 | Crossed 460' setback (1822'FNL & 447'FEL, SEC.29) |
| 7568.00† | 86.422 | 268.008 | 7252.01 | 812.37 | -147.78 | -807.98 | 8.66 | Landing (1822'FNL & 453'FEL, SEC.29) |
| 7583.00 | 87.720 | 268.050 | 7252.77 | 827.35 | -148.30 | -822.95 | 8.66 | |
| 7679.00 | 89.970 | 271.820 | 7254.71 | 923.26 | -148.40 | -918.91 | 4.57 | |
| 7774.00 | 89.970 | 274.710 | 7254.76 | 1017.87 | -142.99 | -1013.74 | 3.04 | |
| 7866.00 | 90.030 | 273.660 | 7254.76 | 1109.36 | -136.28 | -1105.49 | 1.14 | |
| 7956.00 | 90.340 | 269.970 | 7254.47 | 1199.15 | -133.43 | -1195.43 | 4.11 | |
| 8046.00 | 90.310 | 267.830 | 7253.96 | 1289.14 | -135.16 | -1285.41 | 2.38 | |
| 8137.00 | 90.520 | 268.090 | 7253.30 | 1380.14 | -138.40 | -1376.35 | 0.37 | |
| 8229.00 | 90.340 | 267.400 | 7252.61 | 1472.13 | -142.02 | -1468.28 | 0.78 | |

Actual Wellpath Report

THORNTON I-29-30HN AWP

Page 5 of 10



REFERENCE WELLPATH IDENTIFICATION

| | | | |
|----------|--------------------------------|----------|--|
| Operator | BAYSWATER E & P LLC | Slot | SLOT#03 THORNTON I-29-30HN (1674'FNL & 355'FWL SEC 28) |
| Area | COLORADO | Well | THORNTON I-29-30HN |
| Field | WELD COUNTY (NAD83/TRUE NORTH) | Wellbore | THORNTON I-29-30HN AWB |
| Facility | SEC.28-T07N-R66W | | |

WELLPATH DATA (194 stations)

| MD [ft] | Inclination [°] | Azimuth [°] | TVD [ft] | Vert Sect [ft] | North [ft] | East [ft] | DLS [°/100ft] | Comments |
|------------|--------------------|----------------|-------------|-------------------|---------------|--------------|------------------|----------|
| 8318.00 | 90.400 | 267.080 | 7252.03 | 1561.12 | -146.30 | -1557.17 | 0.37 | |
| 8406.00 | 90.460 | 266.750 | 7251.37 | 1649.10 | -151.04 | -1645.04 | 0.38 | |
| 8498.00 | 90.370 | 267.310 | 7250.71 | 1741.08 | -155.80 | -1736.91 | 0.62 | |
| 8589.00 | 90.180 | 267.690 | 7250.27 | 1832.07 | -159.77 | -1827.83 | 0.47 | |
| 8681.00 | 90.180 | 268.580 | 7249.98 | 1924.07 | -162.77 | -1919.78 | 0.97 | |
| 8773.00 | 90.090 | 269.230 | 7249.76 | 2016.06 | -164.53 | -2011.76 | 0.71 | |
| 8863.00 | 90.220 | 269.040 | 7249.52 | 2106.05 | -165.88 | -2101.75 | 0.26 | |
| 8953.00 | 89.940 | 267.660 | 7249.39 | 2196.04 | -168.48 | -2191.71 | 1.56 | |
| 9044.00 | 90.120 | 267.230 | 7249.35 | 2287.04 | -172.53 | -2282.62 | 0.51 | |
| 9134.00 | 90.120 | 268.500 | 7249.16 | 2377.03 | -175.88 | -2372.55 | 1.41 | |
| 9224.00 | 89.970 | 266.850 | 7249.09 | 2467.03 | -179.54 | -2462.48 | 1.84 | |
| 9314.00 | 90.030 | 264.860 | 7249.09 | 2556.95 | -186.04 | -2552.24 | 2.21 | |
| 9405.00 | 90.060 | 265.050 | 7249.02 | 2647.81 | -194.04 | -2642.88 | 0.21 | |
| 9495.00 | 90.030 | 265.060 | 7248.95 | 2737.68 | -201.80 | -2732.55 | 0.04 | |
| 9585.00 | 90.150 | 266.560 | 7248.80 | 2827.61 | -208.38 | -2822.30 | 1.67 | |
| 9677.00 | 90.090 | 268.510 | 7248.61 | 2919.60 | -212.33 | -2914.22 | 2.12 | |
| 9769.00 | 90.180 | 269.770 | 7248.39 | 3011.58 | -213.71 | -3006.20 | 1.37 | |
| 9860.00 | 90.150 | 270.110 | 7248.13 | 3102.53 | -213.81 | -3097.20 | 0.38 | |
| 9951.00 | 90.180 | 271.140 | 7247.87 | 3193.45 | -212.82 | -3188.20 | 1.13 | |
| 10041.00 | 90.220 | 271.850 | 7247.56 | 3283.29 | -210.47 | -3278.16 | 0.79 | |
| 10131.00 | 90.120 | 271.810 | 7247.29 | 3373.10 | -207.59 | -3368.12 | 0.12 | |
| 10223.00 | 90.120 | 269.870 | 7247.10 | 3464.99 | -206.25 | -3460.10 | 2.11 | |
| 10313.00 | 90.150 | 268.740 | 7246.88 | 3554.97 | -207.34 | -3550.09 | 1.26 | |
| 10405.00 | 90.000 | 269.100 | 7246.76 | 3646.96 | -209.07 | -3642.08 | 0.42 | |
| 10497.00 | 90.060 | 269.750 | 7246.72 | 3738.94 | -209.99 | -3734.07 | 0.71 | |
| 10588.00 | 90.000 | 270.150 | 7246.67 | 3829.89 | -210.07 | -3825.07 | 0.44 | |
| 10678.00 | 90.150 | 269.720 | 7246.55 | 3919.85 | -210.18 | -3915.07 | 0.51 | |
| 10770.00 | 90.150 | 269.010 | 7246.31 | 4011.83 | -211.20 | -4007.07 | 0.77 | |
| 10862.00 | 90.180 | 269.300 | 7246.04 | 4103.81 | -212.55 | -4099.05 | 0.32 | |
| 10953.00 | 90.150 | 269.080 | 7245.78 | 4194.79 | -213.84 | -4190.05 | 0.24 | |

Actual Wellpath Report

THORNTON I-29-30HN AWP

Page 6 of 10



| REFERENCE WELLPATH IDENTIFICATION | | | |
|-----------------------------------|--------------------------------|----------|--|
| Operator | BAYSWATER E & P LLC | Slot | SLOT#03 THORNTON I-29-30HN (1674'FNL & 355'FWL SEC 28) |
| Area | COLORADO | Well | THORNTON I-29-30HN |
| Field | WELD COUNTY (NAD83/TRUE NORTH) | Wellbore | THORNTON I-29-30HN AWB |
| Facility | SEC.28-T07N-R66W | | |

| WELLPATH DATA (194 stations) | | | | | | | | |
|------------------------------|--------------------|----------------|-------------|-------------------|---------------|--------------|------------------|----------|
| MD [ft] | Inclination [°] | Azimuth [°] | TVD [ft] | Vert Sect [ft] | North [ft] | East [ft] | DLS [°/100ft] | Comments |
| 11045.00 | 90.150 | 269.110 | 7245.54 | 4286.78 | -215.29 | -4282.03 | 0.03 | |
| 11134.00 | 90.220 | 268.740 | 7245.25 | 4375.77 | -216.96 | -4371.02 | 0.42 | |
| 11223.00 | 90.060 | 268.460 | 7245.04 | 4464.77 | -219.14 | -4459.99 | 0.36 | |
| 11313.00 | 90.150 | 269.000 | 7244.87 | 4554.76 | -221.13 | -4549.97 | 0.61 | |
| 11404.00 | 90.180 | 269.240 | 7244.61 | 4645.75 | -222.53 | -4640.96 | 0.27 | |
| 11496.00 | 90.090 | 267.710 | 7244.39 | 4737.74 | -224.98 | -4732.92 | 1.67 | |
| 11588.00 | 90.580 | 269.060 | 7243.85 | 4829.74 | -227.57 | -4824.88 | 1.56 | |
| 11678.00 | 89.940 | 269.520 | 7243.45 | 4919.72 | -228.69 | -4914.87 | 0.88 | |
| 11770.00 | 90.060 | 269.430 | 7243.45 | 5011.69 | -229.53 | -5006.87 | 0.16 | |
| 11862.00 | 90.060 | 269.900 | 7243.35 | 5103.66 | -230.07 | -5098.87 | 0.51 | |
| 11954.00 | 89.940 | 269.280 | 7243.35 | 5195.63 | -230.72 | -5190.86 | 0.69 | |
| 12046.00 | 90.150 | 267.950 | 7243.28 | 5287.62 | -232.95 | -5282.83 | 1.46 | |
| 12136.00 | 90.030 | 267.090 | 7243.14 | 5377.62 | -236.84 | -5372.75 | 0.96 | |
| 12227.00 | 90.090 | 267.260 | 7243.04 | 5468.61 | -241.33 | -5463.64 | 0.20 | |
| 12319.00 | 90.060 | 269.510 | 7242.92 | 5560.60 | -243.92 | -5555.60 | 2.45 | |
| 12410.00 | 90.090 | 271.190 | 7242.80 | 5651.53 | -243.36 | -5646.59 | 1.85 | |
| 12500.00 | 90.090 | 270.150 | 7242.66 | 5741.44 | -242.31 | -5736.58 | 1.16 | |
| 12592.00 | 90.000 | 269.120 | 7242.59 | 5833.40 | -242.90 | -5828.58 | 1.12 | |
| 12684.00 | 89.970 | 267.200 | 7242.61 | 5925.40 | -245.85 | -5920.53 | 2.09 | |
| 12776.00 | 90.030 | 265.990 | 7242.61 | 6017.37 | -251.32 | -6012.36 | 1.32 | |
| 12866.00 | 90.060 | 265.220 | 7242.54 | 6107.28 | -258.21 | -6102.10 | 0.86 | |
| 12958.00 | 90.090 | 266.340 | 7242.42 | 6199.20 | -264.98 | -6193.85 | 1.22 | |
| 13048.00 | 90.000 | 266.690 | 7242.35 | 6289.16 | -270.45 | -6283.68 | 0.40 | |
| 13140.00 | 89.970 | 267.660 | 7242.37 | 6381.15 | -274.99 | -6375.57 | 1.05 | |
| 13232.00 | 89.940 | 268.900 | 7242.45 | 6473.15 | -277.75 | -6467.53 | 1.35 | |
| 13322.00 | 89.970 | 269.840 | 7242.52 | 6563.12 | -278.74 | -6557.52 | 1.04 | |
| 13411.00 | 89.970 | 270.230 | 7242.56 | 6652.07 | -278.68 | -6646.52 | 0.44 | |
| 13503.00 | 90.030 | 270.630 | 7242.56 | 6744.00 | -277.99 | -6738.52 | 0.44 | |
| 13591.00 | 90.030 | 270.460 | 7242.52 | 6831.92 | -277.16 | -6826.51 | 0.19 | |
| 13683.00 | 89.940 | 270.170 | 7242.54 | 6923.86 | -276.65 | -6918.51 | 0.33 | |

Actual Wellpath Report

THORNTON I-29-30HN AWP

Page 7 of 10



| REFERENCE WELLPATH IDENTIFICATION | | | |
|-----------------------------------|--------------------------------|----------|--|
| Operator | BAYSWATER E & P LLC | Slot | SLOT#03 THORNTON I-29-30HN (1674'FNL & 355'FWL SEC 28) |
| Area | COLORADO | Well | THORNTON I-29-30HN |
| Field | WELD COUNTY (NAD83/TRUE NORTH) | Wellbore | THORNTON I-29-30HN AWP |
| Facility | SEC.28-T07N-R66W | | |

| WELLPATH DATA (194 stations) | | | | | | | | |
|------------------------------|--------------------|----------------|-------------|-------------------|---------------|--------------|------------------|----------|
| MD [ft] | Inclination [°] | Azimuth [°] | TVD [ft] | Vert Sect [ft] | North [ft] | East [ft] | DLS [°/100ft] | Comments |
| 13775.00 | 90.000 | 269.660 | 7242.59 | 7015.81 | -276.79 | -7010.51 | 0.56 | |
| 13868.00 | 90.000 | 269.050 | 7242.59 | 7108.79 | -277.83 | -7103.50 | 0.66 | |
| 13959.00 | 89.940 | 268.510 | 7242.64 | 7199.78 | -279.77 | -7194.48 | 0.60 | |
| 14048.00 | 89.940 | 268.410 | 7242.73 | 7288.78 | -282.16 | -7283.45 | 0.11 | |
| 14140.00 | 90.000 | 268.710 | 7242.78 | 7380.78 | -284.48 | -7375.42 | 0.33 | |
| 14232.00 | 90.000 | 268.860 | 7242.78 | 7472.77 | -286.43 | -7467.40 | 0.16 | |
| 14324.00 | 90.030 | 269.440 | 7242.76 | 7564.76 | -287.79 | -7559.39 | 0.63 | |
| 14415.00 | 89.940 | 270.180 | 7242.78 | 7655.72 | -288.09 | -7650.39 | 0.82 | |
| 14505.00 | 90.060 | 269.960 | 7242.78 | 7745.66 | -287.98 | -7740.39 | 0.28 | |
| 14595.00 | 90.000 | 269.900 | 7242.73 | 7835.62 | -288.09 | -7830.39 | 0.09 | |
| 14685.00 | 90.000 | 269.920 | 7242.73 | 7925.58 | -288.23 | -7920.39 | 0.02 | |
| 14775.00 | 90.060 | 269.830 | 7242.68 | 8015.54 | -288.43 | -8010.39 | 0.12 | |
| 14866.00 | 89.940 | 270.030 | 7242.68 | 8106.49 | -288.54 | -8101.39 | 0.26 | |
| 14956.00 | 90.000 | 269.100 | 7242.73 | 8196.46 | -289.22 | -8191.38 | 1.04 | |
| 15046.00 | 90.000 | 267.420 | 7242.73 | 8286.46 | -291.96 | -8281.34 | 1.87 | |
| 15137.00 | 89.940 | 266.460 | 7242.78 | 8377.44 | -296.82 | -8372.21 | 1.06 | |
| 15228.00 | 90.030 | 267.820 | 7242.80 | 8468.42 | -301.36 | -8463.09 | 1.50 | |
| 15318.00 | 90.000 | 267.740 | 7242.78 | 8558.42 | -304.84 | -8553.03 | 0.09 | |
| 15409.00 | 89.910 | 268.390 | 7242.85 | 8649.42 | -307.91 | -8643.97 | 0.72 | |
| 15500.00 | 89.940 | 268.870 | 7242.97 | 8740.41 | -310.09 | -8734.95 | 0.53 | |
| 15592.00 | 89.910 | 268.820 | 7243.09 | 8832.41 | -311.94 | -8826.93 | 0.06 | |
| 15682.00 | 89.940 | 268.870 | 7243.21 | 8922.40 | -313.76 | -8916.91 | 0.06 | |
| 15774.00 | 89.940 | 268.260 | 7243.30 | 9014.40 | -316.06 | -9008.88 | 0.66 | |
| 15866.00 | 90.000 | 268.140 | 7243.35 | 9106.40 | -318.95 | -9100.83 | 0.15 | |
| 15957.00 | 89.910 | 267.920 | 7243.42 | 9197.40 | -322.08 | -9191.78 | 0.26 | |
| 16049.00 | 90.340 | 267.080 | 7243.22 | 9289.39 | -326.09 | -9283.69 | 1.03 | |
| 16140.00 | 90.400 | 267.240 | 7242.64 | 9380.38 | -330.60 | -9374.58 | 0.19 | |
| 16232.00 | 90.400 | 267.340 | 7241.99 | 9472.36 | -334.95 | -9466.47 | 0.11 | |
| 16322.00 | 90.280 | 267.220 | 7241.46 | 9562.35 | -339.22 | -9556.37 | 0.19 | |
| 16414.00 | 90.400 | 267.720 | 7240.91 | 9654.34 | -343.28 | -9648.28 | 0.56 | |

Actual Wellpath Report

THORNTON I-29-30HN AWP

Page 8 of 10



REFERENCE WELLPATH IDENTIFICATION

| | | | |
|----------|--------------------------------|----------|--|
| Operator | BAYSWATER E & P LLC | Slot | SLOT#03 THORNTON I-29-30HN (1674'FNL & 355'FWL SEC 28) |
| Area | COLORADO | Well | THORNTON I-29-30HN |
| Field | WELD COUNTY (NAD83/TRUE NORTH) | Wellbore | THORNTON I-29-30HN AWB |
| Facility | SEC.28-T07N-R66W | | |

WELLPATH DATA (194 stations)

| MD [ft] | Inclination [°] | Azimuth [°] | TVD [ft] | Vert Sect [ft] | North [ft] | East [ft] | DLS [°/100ft] | Comments |
|------------|--------------------|----------------|-------------|-------------------|---------------|--------------|------------------|--|
| 16506.00 | 90.370 | 268.700 | 7240.30 | 9746.34 | -346.16 | -9740.23 | 1.07 | |
| 16598.00 | 90.310 | 269.920 | 7239.75 | 9838.32 | -347.27 | -9832.22 | 1.33 | |
| 16687.00 | 90.310 | 269.350 | 7239.27 | 9927.28 | -347.83 | -9921.22 | 0.64 | |
| 16777.00 | 90.310 | 268.960 | 7238.78 | 10017.27 | -349.16 | -10011.21 | 0.43 | |
| 16868.00 | 90.340 | 270.890 | 7238.27 | 10108.22 | -349.28 | -10102.20 | 2.12 | |
| 16960.00 | 90.310 | 273.290 | 7237.74 | 10199.99 | -345.92 | -10194.13 | 2.61 | |
| 17051.00 | 90.250 | 272.260 | 7237.30 | 10290.69 | -341.52 | -10285.02 | 1.13 | |
| 17141.00 | 90.340 | 269.536 | 7236.83 | 10380.57 | -340.11 | -10375.00 | 3.03 | |
| 17232.00 | 90.370 | 269.980 | 7236.27 | 10471.54 | -340.49 | -10466.00 | 0.49 | |
| 17324.00 | 90.340 | 269.920 | 7235.70 | 10563.49 | -340.57 | -10558.00 | 0.07 | |
| 17414.00 | 90.370 | 265.980 | 7235.14 | 10653.47 | -343.79 | -10647.92 | 4.38 | |
| 17506.00 | 90.430 | 268.780 | 7234.50 | 10745.45 | -348.00 | -10739.81 | 3.04 | |
| 17515.00 | 90.340 | 269.180 | 7234.44 | 10754.45 | -348.16 | -10748.81 | 4.56 | Last BHI mwd survey (1806'FNL & 495'FWL, SEC.30) |
| 17539.00 | 90.340 | 269.180 | 7234.30 | 10778.44 | -348.50 | -10772.81 | 0.00 | Projection to bit (1806'FNL & 471'FWL, SEC.30) |

HOLE & CASING SECTIONS - Ref Wellbore: THORNTON I-29-30HN AWB Ref Wellpath: THORNTON I-29-30HN AWP

| String/Diameter | Start MD [ft] | End MD [ft] | Interval [ft] | Start TVD [ft] | End TVD [ft] | Start N/S [ft] | Start E/W [ft] | End N/S [ft] | End E/W [ft] |
|------------------------|------------------|----------------|------------------|-------------------|-----------------|-------------------|-------------------|-----------------|-----------------|
| 13.5in Open Hole | 97.00 | 1555.00 | 1458.00 | 97.00 | 1554.88 | 0.26 | 0.16 | -1.27 | -0.98 |
| 9.625in Casing Surface | 17.00 | 1545.00 | 1528.00 | 17.00 | 1544.88 | 0.00 | 0.00 | -1.23 | -1.05 |
| 8.5in Open Hole | 1555.00 | 17539.00 | 15984.00 | 1554.88 | 7234.30 | -1.27 | -0.98 | -348.50 | -10772.81 |

Actual Wellpath Report

THORNTON I-29-30HN AWP

Page 9 of 10



| REFERENCE WELLPATH IDENTIFICATION | | | |
|-----------------------------------|--------------------------------|----------|--|
| Operator | BAYSWATER E & P LLC | Slot | SLOT#03 THORNTON I-29-30HN (1674'FNL & 355'FWL SEC 28) |
| Area | COLORADO | Well | THORNTON I-29-30HN |
| Field | WELD COUNTY (NAD83/TRUE NORTH) | Wellbore | THORNTON I-29-30HN AWB |
| Facility | SEC.28-T07N-R66W | | |

| TARGETS | | | | | | | | |
|--|-------------|---------------|--------------|----------------------|-----------------------|----------------|-----------------|---------|
| Name | TVD [ft] | North [ft] | East [ft] | Grid East [US ft] | Grid North [US ft] | Latitude | Longitude | Shape |
| SEC.28-T07N-R66W | -7.00 | 29.85 | 1.16 | 3196881.86 | 1443491.05 | 40°32'55.046"N | 104°47'29.504"W | polygon |
| SEC.29-T07N-R66W | -7.00 | 29.85 | 1.16 | 3196881.86 | 1443491.05 | 40°32'55.046"N | 104°47'29.504"W | polygon |
| SEC.30-T07N-R66W | -7.00 | 29.85 | 1.16 | 3196881.86 | 1443491.05 | 40°32'55.046"N | 104°47'29.504"W | polygon |
| THORNTON I-29-30HN BHL REV-1 ON PLAT (1810'FNL & 470'FWL SEC.30) | 7222.00 | -352.15 | -10773.52 | 3186110.91 | 1443022.99 | 40°32'51.248"N | 104°49'49.076"W | point |
| THORNTON I-29-30HN LP REV-1 ON PLAT (1810'FNL & 470'FEL SEC.29) | 7252.00 | -145.71 | -830.95 | 3196051.20 | 1443308.85 | 40°32'53.311"N | 104°47'40.283"W | point |
| SEC.29-T07N-R66W 460' SETBACKS | 7338.00 | 29.85 | 1.16 | 3196881.86 | 1443491.05 | 40°32'55.046"N | 104°47'29.504"W | polygon |
| SEC.30-T07N-R66W 460' SETBACKS | 7338.00 | 29.85 | 1.16 | 3196881.86 | 1443491.05 | 40°32'55.046"N | 104°47'29.504"W | polygon |

| WELLPATH COMPOSITION - Ref Wellbore: THORNTON I-29-30HN AWB | | | | | Ref Wellpath: THORNTON I-29-30HN AWP | |
|---|----------------|---|--|--|--------------------------------------|------------------------|
| Start MD [ft] | End MD [ft] | Positional Uncertainty Model | | Log Name/Comment | | Wellbore |
| 17.00 | 1503.00 | Custom BHI NaviTrak (Standard Rotating+Axial Corr) (Rockies 0.03Gt model) | | BHI MWD/NAVITRAK (STD) 13.5" HOLE <145-1503> | | THORNTON I-29-30HN AWB |
| 1503.00 | 17515.00 | Custom BHI AutoTrak Curve (Short) (Rockies 0.03Gt model) | | BHI ATC MWD SHORT ROCKIES GT <1604-17515> | | THORNTON I-29-30HN AWB |
| 17515.00 | 17539.00 | Blind Drilling (std) | | Projection to bit | | THORNTON I-29-30HN AWB |

Actual Wellpath Report

THORNTON I-29-30HN AWP

Page 10 of 10



| REFERENCE WELLPATH IDENTIFICATION | | | |
|-----------------------------------|--------------------------------|----------|--|
| Operator | BAYSWATER E & P LLC | Slot | SLOT#03 THORNTON I-29-30HN (1674'FNL & 355'FWL SEC 28) |
| Area | COLORADO | Well | THORNTON I-29-30HN |
| Field | WELD COUNTY (NAD83/TRUE NORTH) | Wellbore | THORNTON I-29-30HN AWB |
| Facility | SEC.28-T07N-R66W | | |

| WELLPATH COMMENTS | | | | |
|-------------------|--------------------|----------------|-------------|---|
| MD [ft] | Inclination [°] | Azimuth [°] | TVD [ft] | Comment |
| 7562.00 | 85.903 | 267.991 | 7251.60 | Crossed 460' setback (1822'FNL & 447'FEL, SEC.29) |
| 7568.00 | 86.422 | 268.008 | 7252.01 | Landing (1822'FNL & 453'FEL, SEC.29) |
| 17515.00 | 90.340 | 269.180 | 7234.44 | Last BHI mwd survey (1806'FNL & 495'FWL, SEC.30) |
| 17539.00 | 90.340 | 269.180 | 7234.30 | Projection to bit (1806'FNL & 471'FWL, SEC.30) |