



January 1, 2017

Mr. Matt Lepore, Director  
Colorado Oil and Gas Conservation Commission  
1120 Lincoln Street, Suite 801  
Denver, Colorado 80203

**RE: COGCC Rule 318A.e.: Proposed Spacing Unit  
MLD 9 Well: NWNW Section 22, Township 4 North, Range 68 West  
Weld County, Colorado**

Dear Mr. Lepore:

Extraction Oil and Gas, Inc. (Extraction) is planning to drill the above referenced well in accordance with the provisions set out in Colorado Oil and Gas Conservation Commission (COGCC) Rule 318A.e. Extraction's Proposed Spacing Unit consists of:

N $\frac{1}{2}$ N $\frac{1}{2}$  of Section 22, Township 4 North, Range 68 West  
Containing 160.00 acres more or less

Extraction is not the only owner within the Proposed Spacing Unit and has provided notice to the remaining owners, as required by COGCC Rule 318A.e.(5). Copies of the required notification letters are on file at Extraction's office. The required thirty (30) day notice period has elapsed absent the receipt by Extraction of any objection to their proposal by the owners within the Proposed Spacing Unit for the subject well.

Enclosed is the Proposed Spacing Unit Exhibit to assist in your review and approval of Extraction's proposed Application for Permit to Drill for the MLD 9 Well. Many thanks for your attention to this matter.

Respectfully,

A handwritten signature in blue ink, appearing to read "Jeff Annable", is written over a light blue circular stamp.

Jeff Annable  
Regulatory Analyst  
Agent for Extraction Oil and Gas, Inc.

:ja

Enclosure: Proposed Spacing Unit Exhibit

# PROPOSED 318A.e. SPACING UNIT

## SECTION 22, TOWNSHIP 4 NORTH, RANGE 68 WEST, 6TH P.M.

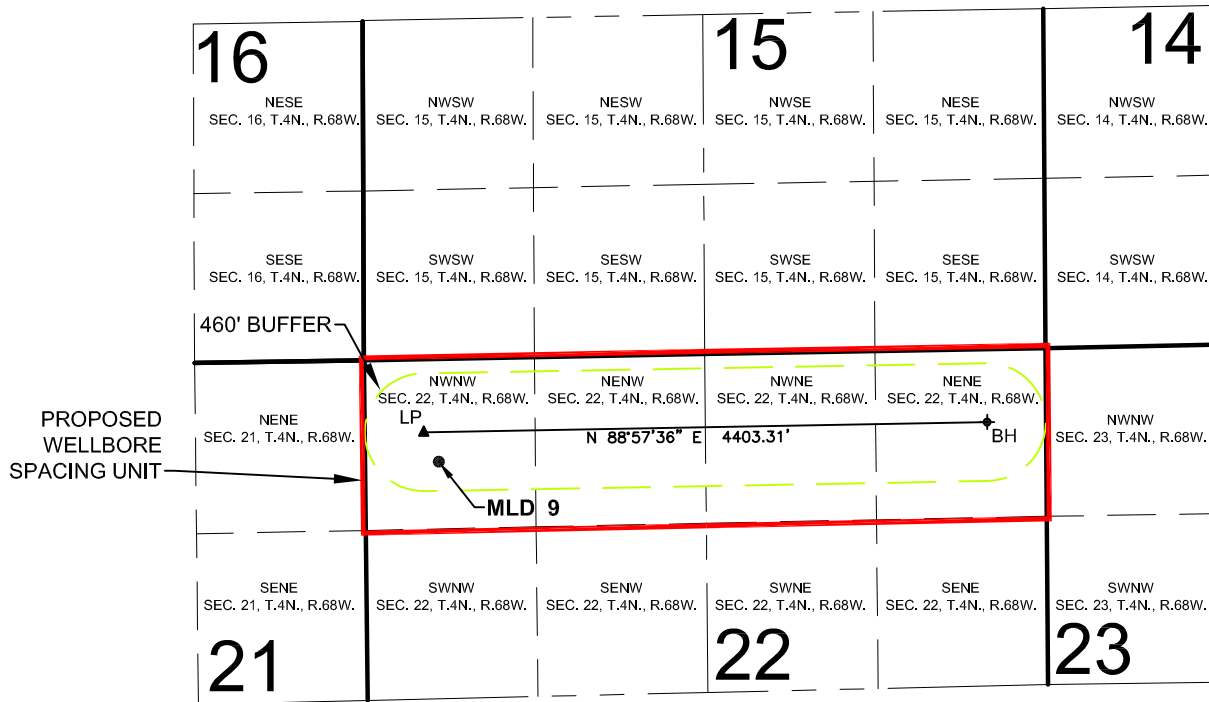

WELL **MLD 9** TO BE LOCATED 802' FNL AND 576' FWL, SEC. 22, T4N, R68W

### SURFACE LOCATION

NAD83  
LATITUDE= 40.303971°  
LONGITUDE= 104.996768°

### LANDING POINT LOCATION

NAD83  
LATITUDE= 40.304604°  
LONGITUDE= 104.997188°

### BOTTOM HOLE LOCATION

NAD83  
LATITUDE= 40.304753°  
LONGITUDE= 104.981401°

### LEGEND

- = PROPOSED WELL
- ▲ = LANDING POINT
- ◆ = BOTTOM HOLE
- LP = LANDING POINT
- BH = BOTTOM HOLE

SHEET 9 OF 14

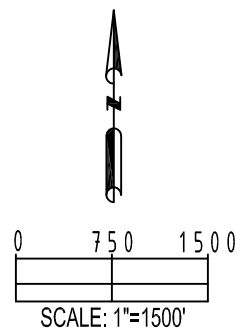

PREPARED BY: <b>PFS</b> Petroleum Field Services, LLC 7535 Hilltop Circle Denver, CO 80221	FIELD DATE: 07-12-14	SURFACE LOCATION: NW 1/4 NW 1/4, SEC. 22, T4N, R68W, 6TH P.M. WELD COUNTY, COLORADO
	DRAWING DATE: 07-16-14	
BY: SNC	CHECKED: WDW	