



January 1, 2017

Mr. Matt Lepore, Director
Colorado Oil and Gas Conservation Commission
1120 Lincoln Street, Suite 801
Denver, Colorado 80203

**RE: COGCC Rule 318A.e.: Proposed Spacing Unit
MLD 4 Well: NWNW Section 22, Township 4 North, Range 68 West
Weld County, Colorado**

Dear Mr. Lepore:

Extraction Oil and Gas, Inc. (Extraction) is planning to drill the above referenced well in accordance with the provisions set out in Colorado Oil and Gas Conservation Commission (COGCC) Rule 318A.e. Extraction's Proposed Spacing Unit consists of:

N½S½ & S½N½ of Section 22, Township 4 North, Range 68 West
Containing 320.00 acres more or less

Extraction is not the only owner within the Proposed Spacing Unit and has provided notice to the remaining owners, as required by COGCC Rule 318A.e.(5). Copies of the required notification letters are on file at Extraction's office. The required thirty (30) day notice period has elapsed absent the receipt by Extraction of any objection to their proposal by the owners within the Proposed Spacing Unit for the subject well.

Enclosed is the Proposed Spacing Unit Exhibit to assist in your review and approval of Extraction's proposed Application for Permit to Drill for the MLD 4 Well. Many thanks for your attention to this matter.

Respectfully,

A handwritten signature in blue ink, appearing to read "Jeff Annable", is written over a light blue circular stamp.

Jeff Annable
Regulatory Analyst
Agent for Extraction Oil and Gas, Inc.

:ja

Enclosure: Proposed Spacing Unit Exhibit

PROPOSED 318A.e. SPACING UNIT

SECTION 22, TOWNSHIP 4 NORTH, RANGE 68 WEST, 6TH P.M.

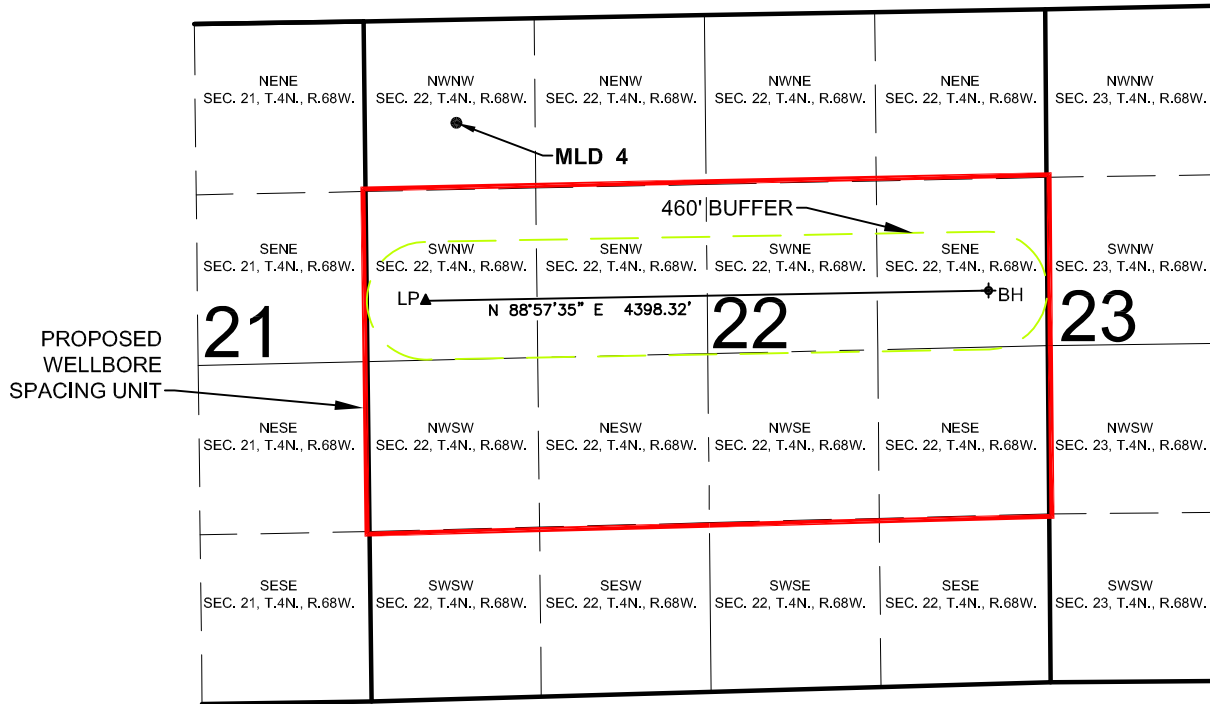

WELL **MLD 4** TO BE LOCATED 805' FNL AND 716' FWL, SEC. 22, T4N, R68W

SURFACE LOCATION

NAD83
LATITUDE= 40.303969°
LONGITUDE= 104.996266°

LANDING POINT LOCATION

NAD83
LATITUDE= 40.300157°
LONGITUDE= 104.997154°

BOTTOM HOLE LOCATION

NAD83
LATITUDE= 40.300306°
LONGITUDE= 104.981386°

LEGEND

- = PROPOSED WELL
- ▲ = LANDING POINT
- ◆ = BOTTOM HOLE
- LP = LANDING POINT
- BH = BOTTOM HOLE

SHEET 4 OF 14

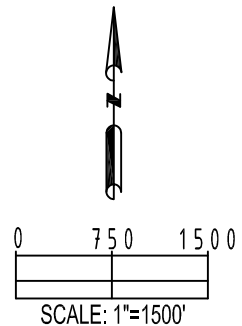

PREPARED BY: PFS Petroleum Field Services, LLC 7535 Hilltop Circle Denver, CO 80221	FIELD DATE: 07-12-14	SURFACE LOCATION: NW 1/4 NW 1/4, SEC. 22, T4N, R68W, 6TH P.M. WELD COUNTY, COLORADO
	DRAWING DATE: 07-16-14	
BY: SNC	CHECKED: WDW	